

PROJ. REFERENCE NO. B-5123	SHEET NO. TMP-17
HDR Engineering, Inc. of the Carolinas 555 Fayetteville St., Suite 900 Raleigh, N.C. 27601 N.C.B.E.L.S. License Number: F-0116	

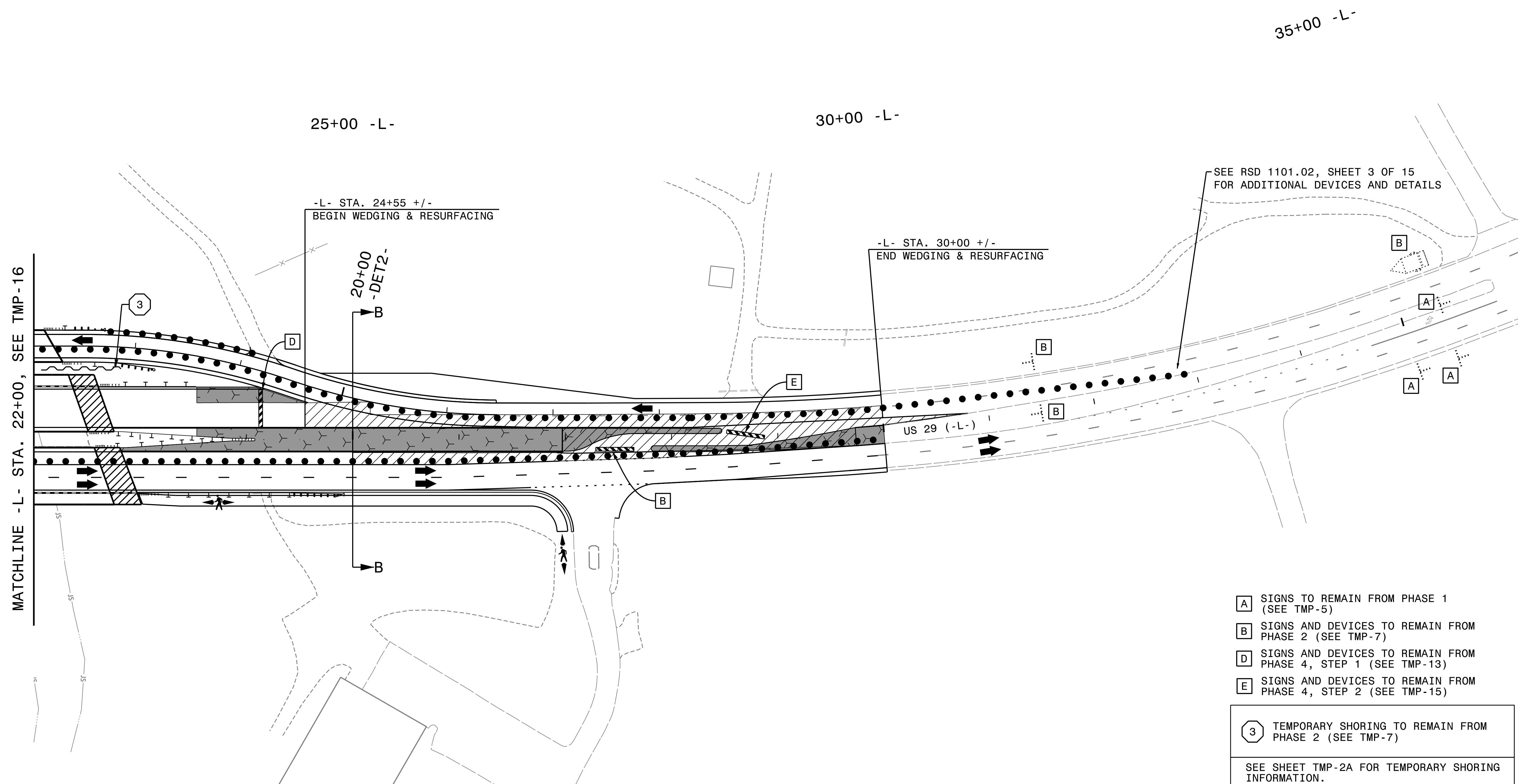
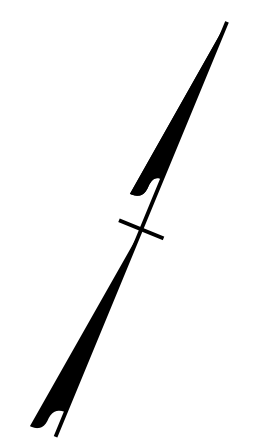

- A** SIGNS TO REMAIN FROM PHASE 1 (SEE TMP-5)
 - B** SIGNS AND DEVICES TO REMAIN FROM PHASE 2 (SEE TMP-7)
 - D** SIGNS AND DEVICES TO REMAIN FROM PHASE 4, STEP 1 (SEE TMP-13)
 - E** SIGNS AND DEVICES TO REMAIN FROM PHASE 4, STEP 2 (SEE TMP-15)
 - 3** TEMPORARY SHORING TO REMAIN FROM PHASE 2 (SEE TMP-7)
- SEE SHEET TMP-2A FOR TEMPORARY SHORING INFORMATION.

PLOT DRIVER: NCDOT_color_eng_50.pht
 USER: CHARNDEN
 DATE: 1/29/2016
 TIME: 9:45:11 AM
 FILE: p:\WPAPP\TPA01\SouthEast\Tampa\Documents\000166\CON0079159\CON0104476\000000000272555\6.0.CAD.BIM\6.2.Work.In.Progress\TrafficControl\TCP\B-5123_TC_TMP_17-Phase4c-2.dgn

APPROVED: *Ben Schoenauer*
 DATE: 1/29/2016

**DOCUMENT NOT CONSIDERED FINAL
UNLESS ALL SIGNATURES COMPLETED**



PHASE 4
STEP 3