

**This electronic collection of documents is provided
for the convenience of the user
and is Not a Certified Document –**

**The documents contained herein were originally issued
and sealed by the individuals whose names and license
numbers appear on each page, on the dates appearing
with their signature on that page.**

**This file or an individual page
shall not be considered a certified document.**

TIP PROJECT: B-4766

STATE OF NORTH CAROLINA
DIVISION OF HIGHWAYS

STATE PROJECT REFERENCE NO.	SHEET NO.
B-4766	UO-1

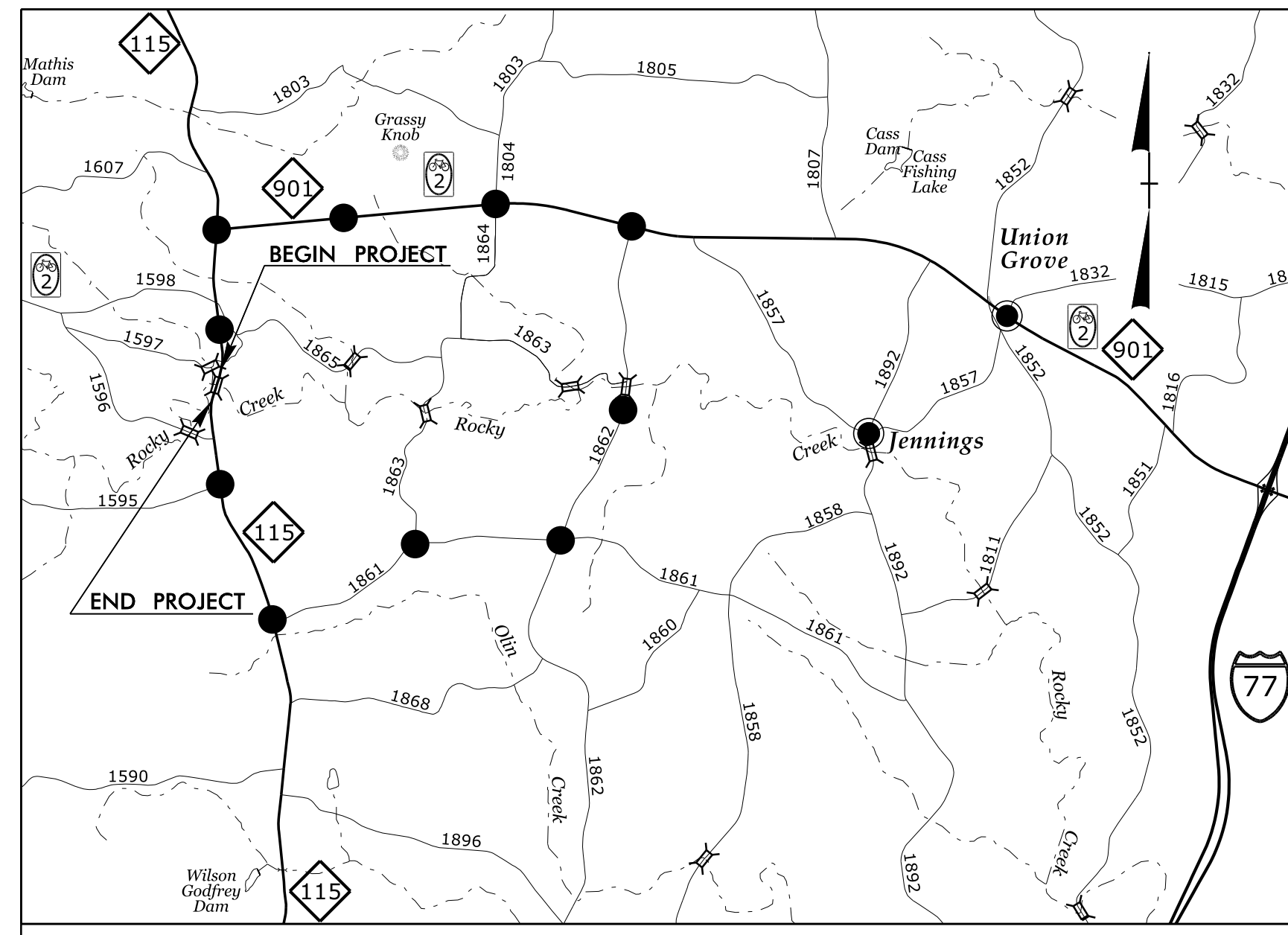

VICINITY MAP

●—●—● OFF-SITE DETOUR

**UTILITIES BY OTHERS PLAN
IREDELL COUNTY**

LOCATION: BRIDGE No. 69 OVER ROCKY CREEK ON NC 115
TYPE OF WORK: POWER DISTRIBUTION AND TELEPHONE RELOCATION

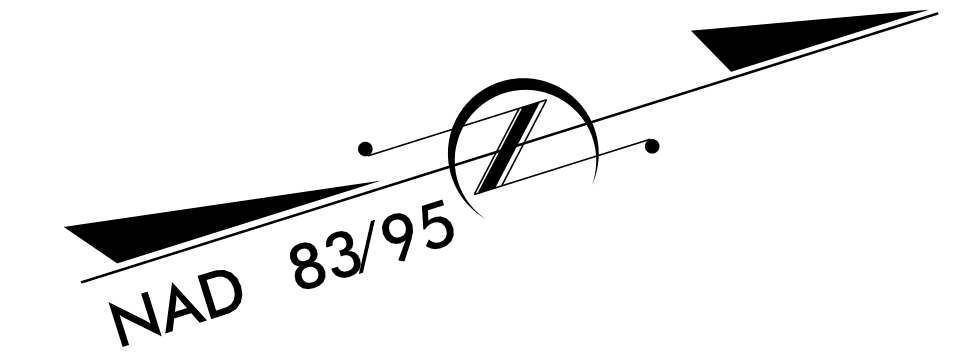
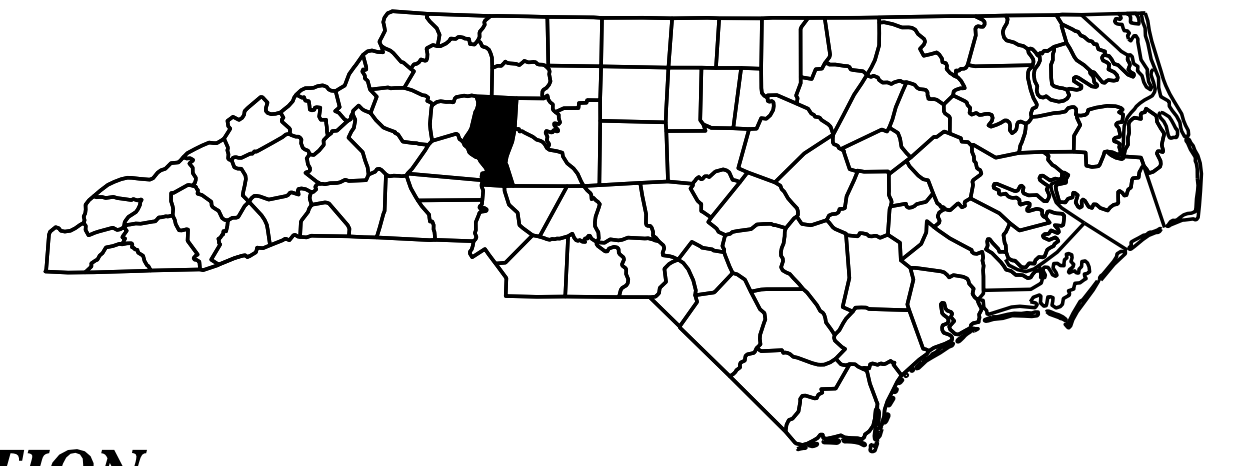

BEGIN TIP PROJECT B-4766
-L- POT STA. 13 + 32.00

END TIP PROJECT B-4766
-L- POC STA. 21 + 00.00

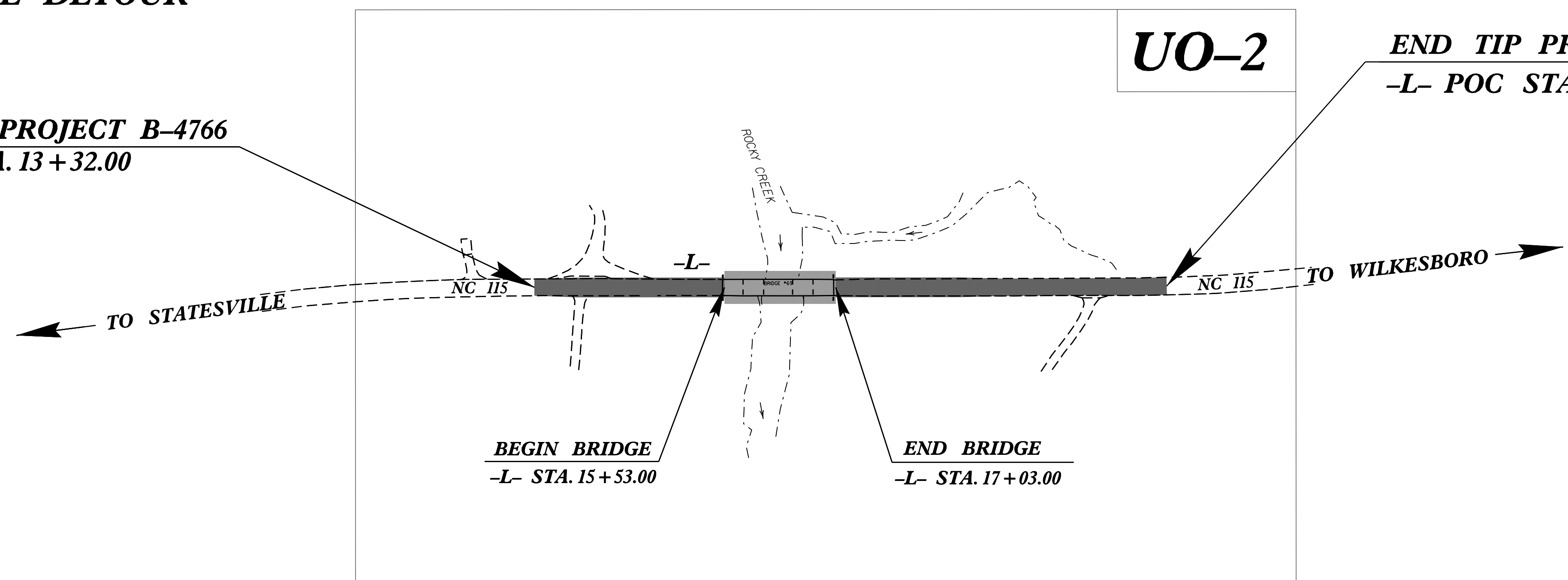

Michael Baker

INTERNATIONAL

Michael Baker Engineering, Inc.
8000 Regency Parkway, Suite 600
Cary, NC 27518
919-463-5488

UTILITIES COORDINATION
CONSULTANT

Brandy Creech

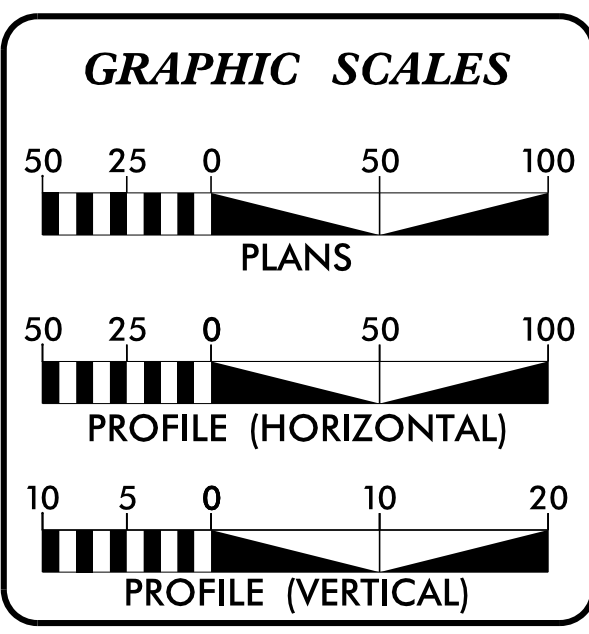

INDEX OF SHEETS

SHEET NO.	DESCRIPTION
UO-1	TITLE SHEET
UO-2	UTILITIES BY OTHERS PLAN SHEET

UTILITY OWNERS ON PROJECT

(A) ENERGY UNITED (POWER DISTRIBUTION)
(B) YADKIN TELEPHONE (TELEPHONE)
(C) AT&T (TELEPHONE)

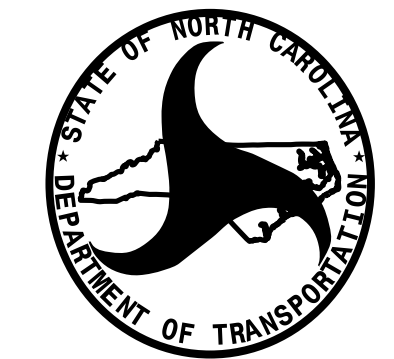

PREPARED IN THE OFFICE OF:
**DIVISION OF HIGHWAYS
UTILITIES UNIT
UTILITIES ENGINEERING**

1555 MAIL SERVICES CENTER
RALEIGH, NC 27699-1555
PHONE (919) 707-6690
FAX (919) 250-4119

<i>Roger Worthington, P.E.</i>	UTILITIES SECTION ENGINEER
<i>Carl Barclay, P.E.</i>	UTILITIES SQUAD LEADER PROJECT ENGINEER
<i>James E. Swinson</i>	UTILITIES PROJECT DESIGNER

UTILITIES BY OTHERS

NOTE:
ALL PROPOSED UTILITY WORK SHOWN ON THIS SHEET WILL BE DONE BY OTHERS

-L-		
PI Sta 11+49.47	PI Sta 20+59.03	PI Sta 21+82.80
$\Delta = 7^{\circ}07'38.4"$ (RT)	$\Delta = 1^{\circ}52'17.5"$ (LT)	$\Delta = 3^{\circ}54'51.2"$ (LT)
$D = 2^{\circ}23'14.4"$	$D = 1^{\circ}54'35.5"$	$D = 3^{\circ}49'11.0"$
$L = 298.55'$	$L = 97.99'$	$L = 102.47'$
$T = 149.47'$	$T = 49.00'$	$T = 51.26'$
$R = 2,400.00'$	$R = 3,000.00'$	$R = 1,500.00'$

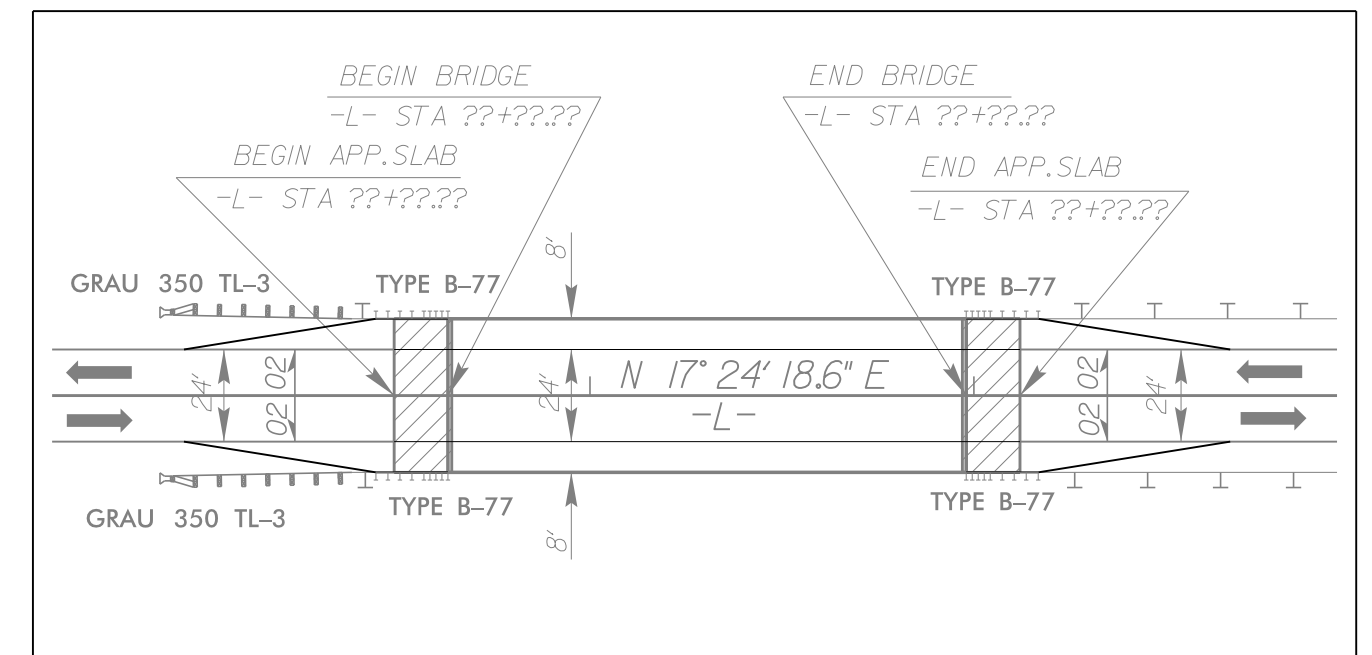
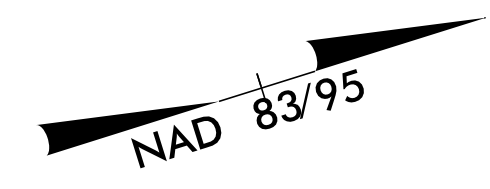

SKETCH SHOWING BRIDGE/ROADWAY RELATIONSHIP

REVISIONS

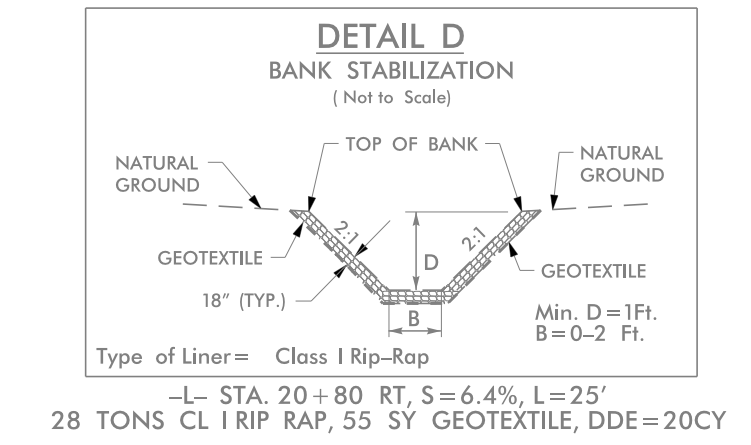
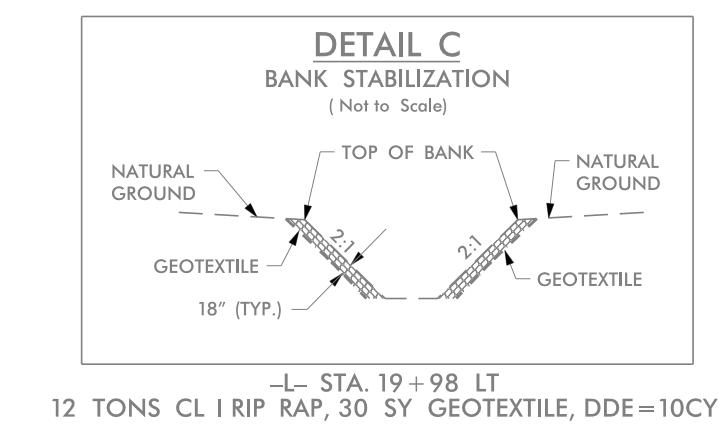
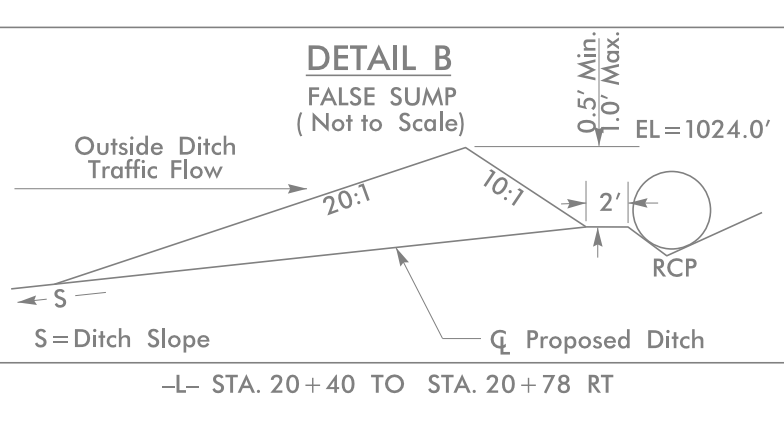
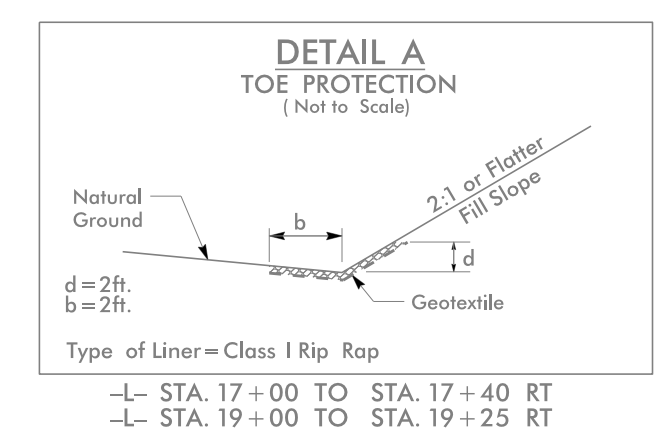
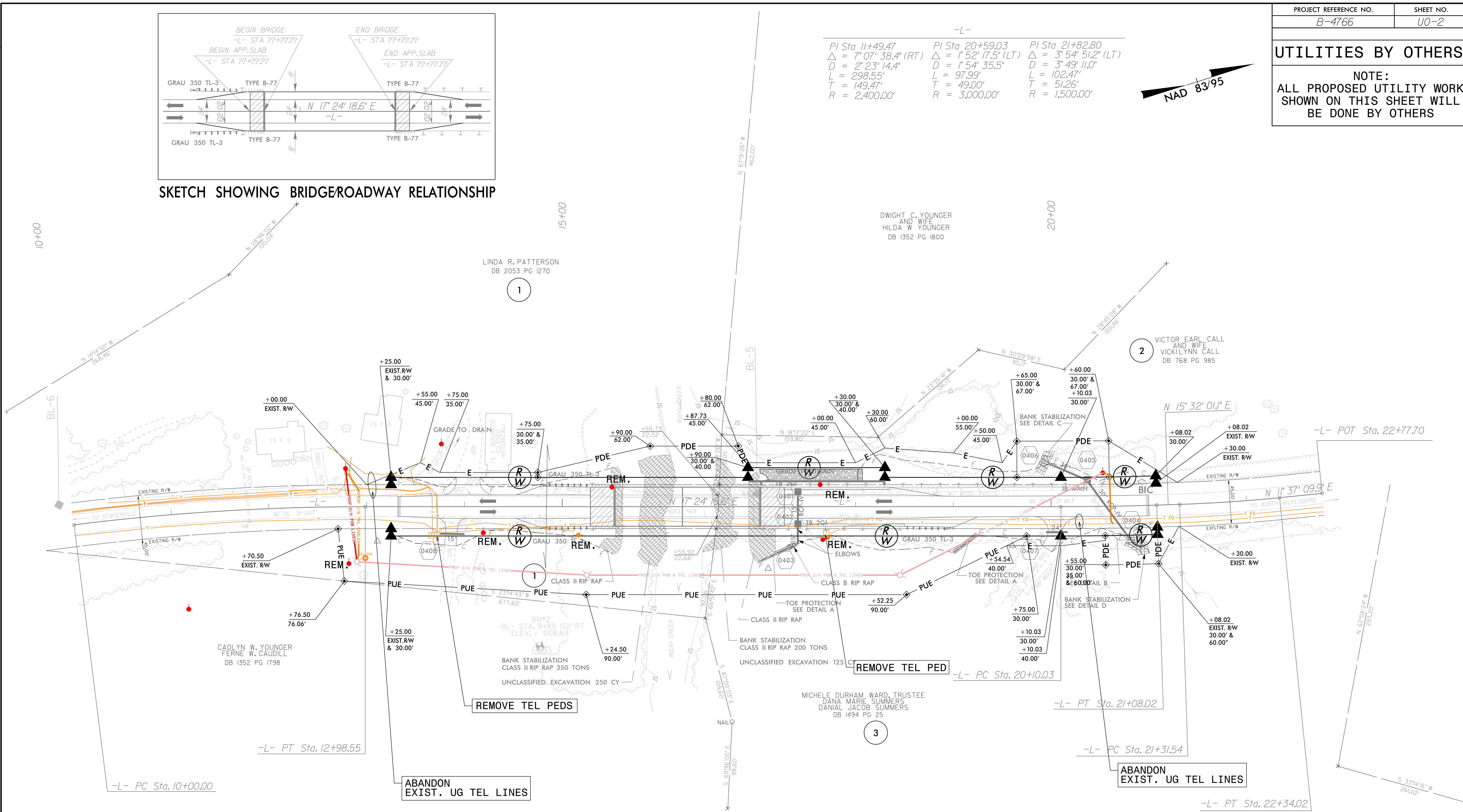

I:\MAR-2016 16:21
 P:\Projects\NCDDOT_Utilities\On-Call Contractors\B-4766-ut-r-dy4_U02_psh.dgn
 AT: CARY\MKC\KODS

Michael Baker
INTERNATIONAL
Michael Baker Engineering, Inc.
8000 Regency Parkway, Suite 600
Cary, NC 27518
919-463-5488