

**PLAN OF SPAN B**

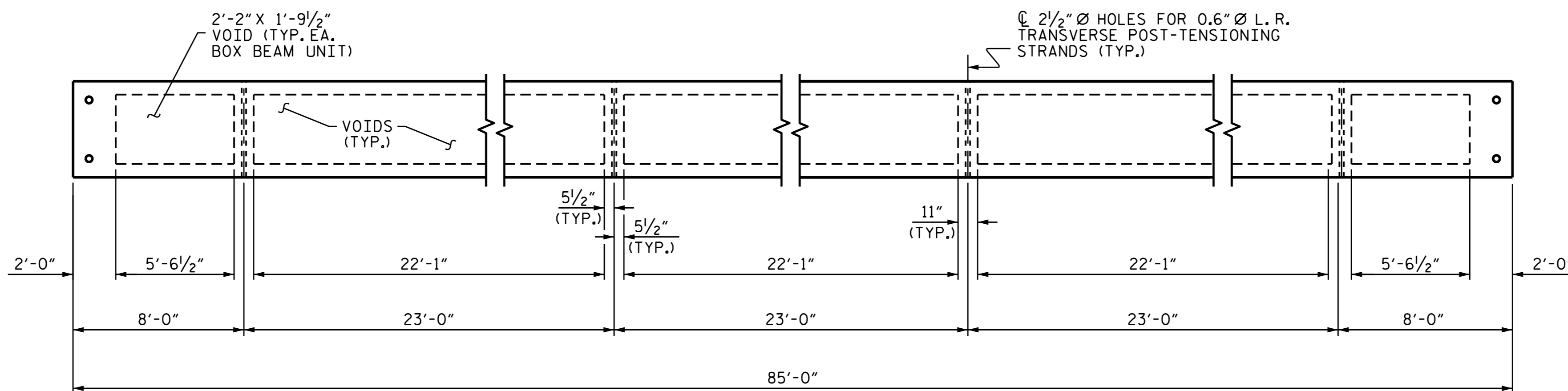

**DIAPHRAGM AND VOID LAYOUT**

PROJECT NO. B-4967  
 SCOTLAND & HOKE COUNTY  
 STATION: 16+74.50 -L-

SHEET 3 OF 6



STATE OF NORTH CAROLINA  
 DEPARTMENT OF TRANSPORTATION  
 RALEIGH  
**PLAN OF 85' UNIT  
 30'-6" CLEAR ROADWAY  
 90° SKEW**  
**SPAN B**

ASSEMBLED BY : E.I. OMILE DATE : 02/23/15  
 CHECKED BY : A. SORENGINH DATE : 5-18-15  
 DRAWN BY : DGE 8/II REV. 8/14 MAA/TMG  
 CHECKED BY : TMG II/II

DocuSigned by:  
 Ting Fang  
 5/10/2016

DOCUMENT NOT CONSIDERED  
 FINAL UNLESS ALL  
 SIGNATURES COMPLETED

REVISIONS						SHEET NO.
NO.	BY:	DATE:	NO.	BY:	DATE:	S-7
1			3			TOTAL SHEETS 23
2			4			