

PROJECT REFERENCE NO. U-3308		SHEET NO. RR-7DET	
RW SHEET NO.		HYDRAULICS ENGINEER	
RAIL DESIGN ENGINEER		SEAL 28479 ENGINEER KEVIN G. BAILEY	
4/20/2016		4/20/2016	

# DETOUR TRACK PLANS

FOR -NSD2- PROFILE SEE SHEETS RR-22 THROUGH RR-24  
FOR -EXCSX- PROFILE SEE SHEET RR-20

DOCUMENT NOT CONSIDERED FINAL  
UNLESS ALL SIGNATURES COMPLETED

NSR BRIDGE MP H-56.10  
CSXT BRIDGE MP SB-154.61

SOUTHERN REPAIR SERVICE INC.  
DB 372 PG 215

MATCH LINE SHEET RR-6DET

MATCH LINE SHEET RR-8DET

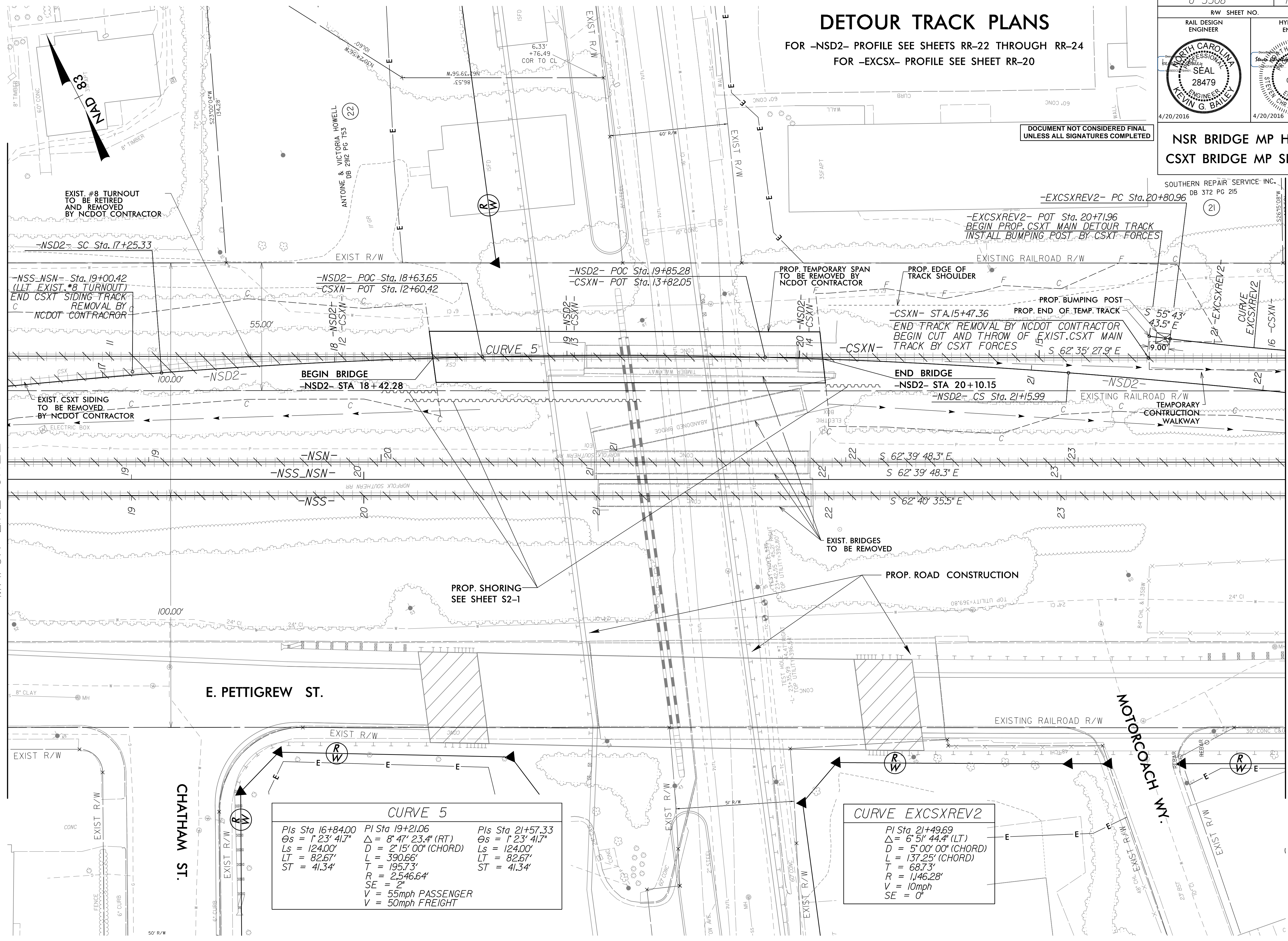

EXIST. #8 TURNOUT  
TO BE RETIRED  
AND REMOVED  
BY NCDOT CONTRACTOR

-NSS\_NSN- Sta. 19+00.42  
(LLT EXIST. #8 TURNOUT)  
END CSXT SIDING TRACK  
REMOVAL BY  
NCDOT CONTRACTOR

EXIST. CSXT SIDING  
TO BE REMOVED  
BY NCDOT CONTRACTOR

ANTOINE & VICTORIA HOWELL  
DB 2912 PG T53

PROP. SHORING  
SEE SHEET S2-1

PROP. ROAD CONSTRUCTION

EXIST. BRIDGES  
TO BE REMOVED

EXISTING RAILROAD R/W  
TEMPORARY  
CONSTRUCTION  
WALKWAY

CURVE 5		
PIs Sta 16+84.00	PI Sta 19+21.06	PIs Sta 21+57.33
$\Theta_s = 1^\circ 23' 41.7''$	$\Delta = 8^\circ 47' 23.4''$ (RT)	$\Theta_s = 1^\circ 23' 41.7''$
$L_s = 124.00'$	$D = 2^\circ 15' 00''$ (CHORD)	$L_s = 124.00'$
$LT = 82.67'$	$L = 390.66'$	$LT = 82.67'$
$ST = 41.34'$	$T = 195.73'$	$ST = 41.34'$
	$R = 2,546.64'$	
	$SE = 2^\circ$	
	$V = 55\text{mph}$ PASSENGER	
	$V = 50\text{mph}$ FREIGHT	

CURVE EXCSXREV2	
PI Sta. 21+49.69	$\Delta = 6^\circ 51' 44.4''$ (LT)
$D = 5^\circ 00' 00''$ (CHORD)	$L = 137.25'$ (CHORD)
$T = 68.73'$	$R = 1,146.28'$
$V = 10\text{mph}$	$SE = 0^\circ$

CHATHAM ST.

E. PETTIGREW ST.

MOTORCOACH WY.