

DETAIL OF -LALT- AND -R3-/R4- INTERSECTION & -LALT- AND -Y3-/R5- INTERSECTION

See Sheets 2C-1 Thru 2C-4 for Curb Ramp Details
See Plan Sheet 4

SCALE 1" = 20'

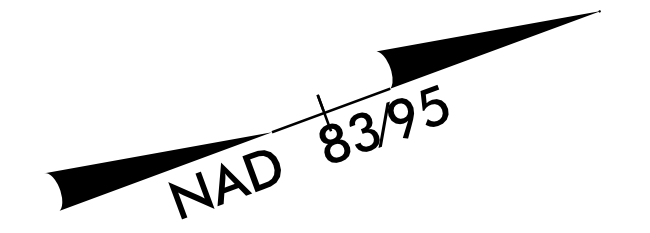

-LALT-
 PI Sta 18+92.86
 $\Delta = 1^\circ 56' 11.5" (LT)$
 $D = 0^\circ 42' 58.3"$
 $L = 270.39'$
 $T = 135.21'$
 $R = 8,000.00'$
 $SE = NC$

Proposed Approach Slab
 Concrete Island or Sidewalk

★ RETAIN AND UPGRADE EXISTING TRAFFIC SIGNAL

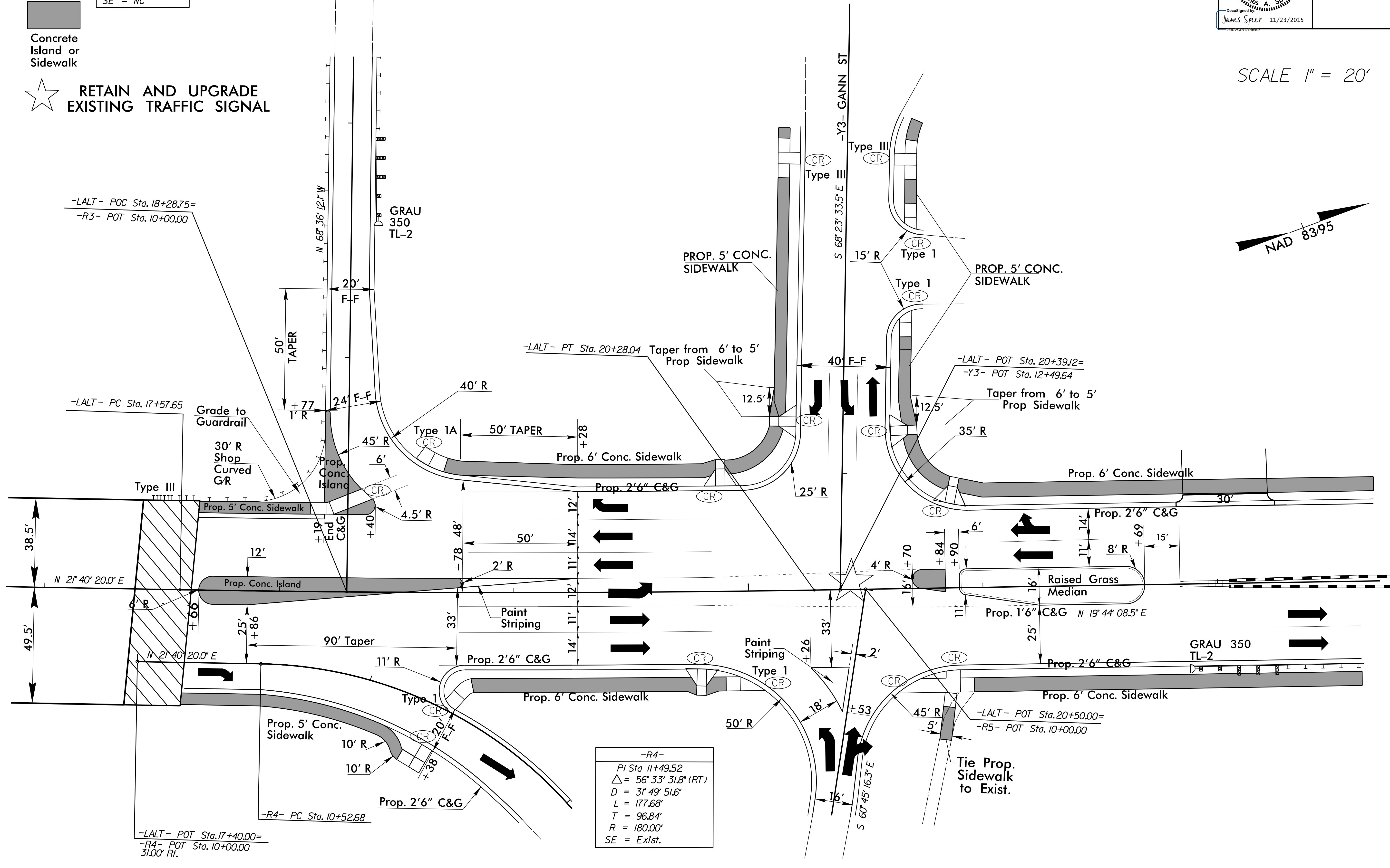

-R4-
 PI Sta 11+49.52
 $\Delta = 56^\circ 33' 31.8" (RT)$
 $D = 31^\circ 49' 51.6"$
 $L = 177.68'$
 $T = 96.84'$
 $R = 180.00'$
 $SE = Exlst.$

REVISIONS

8/17/99
 07-MAY-2015 13:50 U:\3308-Rd\2B-1\Intersection.dwg
 5:58 PM JAW/5/15