

SURVEY CONTROL SHEET U-3308 DURHAM COUNTY

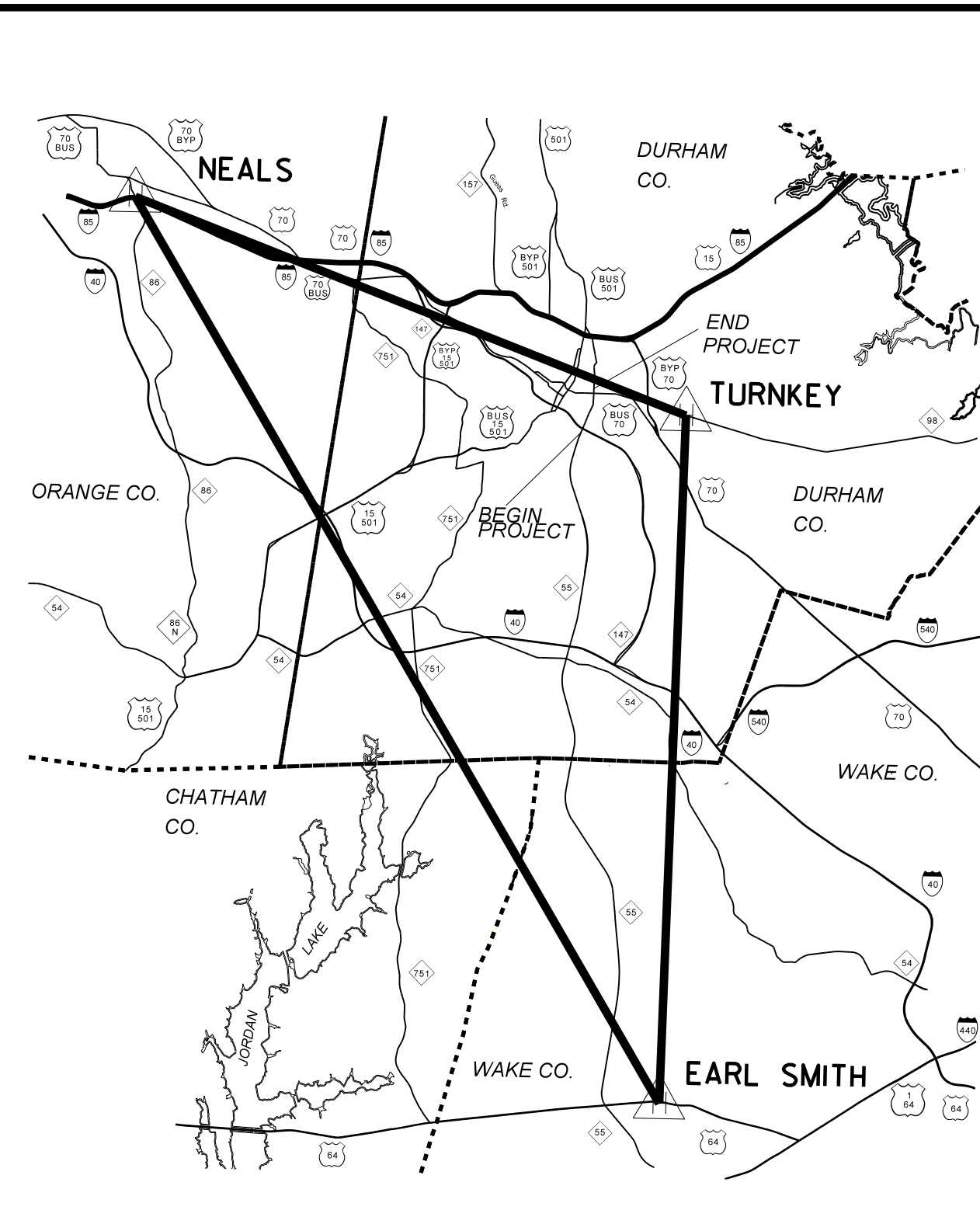

GPS CONTROL NETWORK
NOT TO SCALE

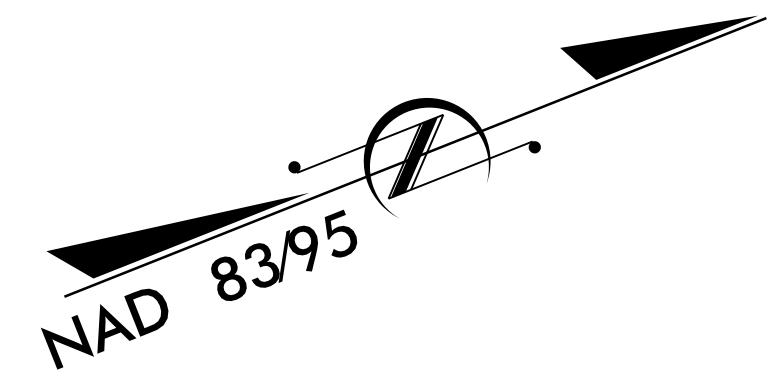

NCDOT GPS STATION U3308-3
LOCALIZED PROJECT COORDINATES
N = 817149.540
E = 2033713.454

NCDOT GPS STATION U3308-4
LOCALIZED PROJECT COORDINATES
N = 817906.554
E = 2033766.807

NCDOT GPS STATION U3308-2
LOCALIZED PROJECT COORDINATES
N = 812643.307
E = 2031954.013

BEGIN TIP PROJECT U-3308
Sta. 13+50.00 -LALT-

END TIP PROJECT U-3308
Sta. 66+10.00 -LALT-

NCDOT GPS STATION U3308-1
LOCALIZED PROJECT COORDINATES
N = 812119.157
E = 2032940.698

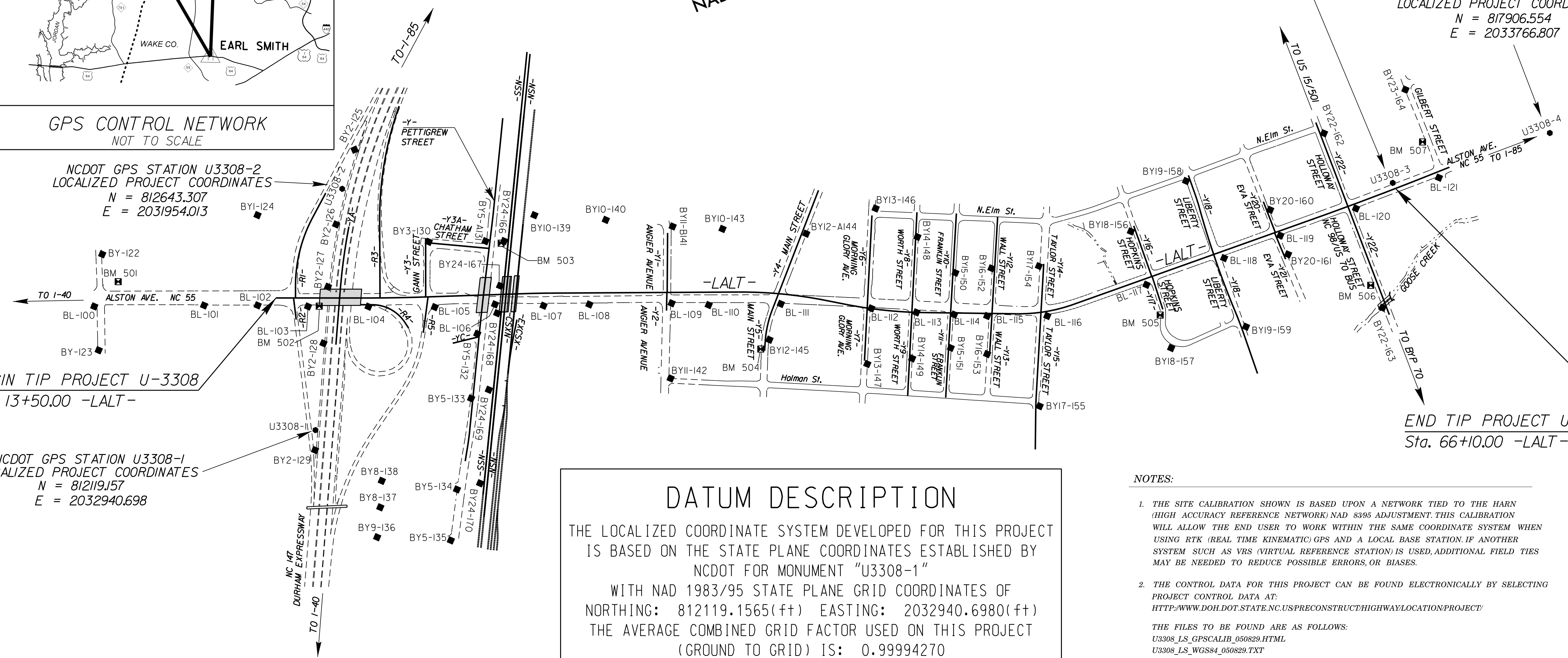

DATUM DESCRIPTION

THE LOCALIZED COORDINATE SYSTEM DEVELOPED FOR THIS PROJECT IS BASED ON THE STATE PLANE COORDINATES ESTABLISHED BY NCDOT FOR MONUMENT "U3308-1" WITH NAD 1983/95 STATE PLANE GRID COORDINATES OF NORTHING: 812119.1565(ft) EASTING: 2032940.6980(ft) THE AVERAGE COMBINED GRID FACTOR USED ON THIS PROJECT (GROUND TO GRID) IS: 0.99994270 THE N.C. LAMBERT GRID BEARING AND LOCALIZED HORIZONTAL GROUND DISTANCE FROM "U3308-1" TO -LALT- STATION 13+50.00 IS N 84° 58' 17.0" W 634.7202 (ft) ALL LINEAR DIMENSIONS ARE LOCALIZED HORIZONTAL DISTANCES VERTICAL DATUM USED IS NAVD 88

- NOTES:**
- THE SITE CALIBRATION SHOWN IS BASED UPON A NETWORK TIED TO THE HARN (HIGH ACCURACY REFERENCE NETWORK) NAD 8395 ADJUSTMENT. THIS CALIBRATION WILL ALLOW THE END USER TO WORK WITHIN THE SAME COORDINATE SYSTEM WHEN USING RTK (REAL TIME KINEMATIC) GPS AND A LOCAL BASE STATION. IF ANOTHER SYSTEM SUCH AS VRS (VIRTUAL REFERENCE STATION) IS USED, ADDITIONAL FIELD TIES MAY BE NEEDED TO REDUCE POSSIBLE ERRORS, OR BIASES.
 - THE CONTROL DATA FOR THIS PROJECT CAN BE FOUND ELECTRONICALLY BY SELECTING PROJECT CONTROL DATA AT:
[HTTP://WWW.DO.H.DOT.STATE.NC.US/PRECONSTRUCT/HIGHWAY/LOCATION/PROJECT/](http://www.doh.dot.state.nc.us/preconstruct/highway/location/project/)
THE FILES TO BE FOUND ARE AS FOLLOWS:
U3308_LS_GPSCALIB_050829.HTML
U3308_LS_WGS84_050829.TXT
U3308_LS_LOCAL_050829.TXT
U3308_LS_CONTROL.TXT

THE WGS84 AND LOCAL FILES ARE COMMA DELIMITED AND CAN BE USED TO REPRODUCE THE SITE CALIBRATION FOR THE END USER'S GPS EQUIPMENT. IF FURTHER INFORMATION IS NEEDED, PLEASE CONTACT THE LOCATION AND SURVEYS UNIT.
- INDICATES GEODETIC CONTROL MONUMENTS USED OR SET FOR HORIZONTAL PROJECT CONTROL BY THE NCDOT LOCATION AND SURVEYS UNIT.
PROJECT CONTROL ESTABLISHED USING GLOBAL POSITIONING SYSTEM NETWORK ESTABLISHED FROM EXISTING HARN MONUMENTATION
SEE GPS CALIBRATION SHEET FOR HORIZONTAL AND VERTICAL COORDINATE VALUES.

NOTE: DRAWING NOT TO SCALE