

**This electronic collection of documents is provided  
for the convenience of the user  
and is Not a Certified Document –**

**The documents contained herein were originally issued  
and sealed by the individuals whose names and license  
numbers appear on each page, on the dates appearing  
with their signature on that page.**

**This file or an individual page  
shall not be considered a certified document.**

**TIP PROJECT: B-4461**

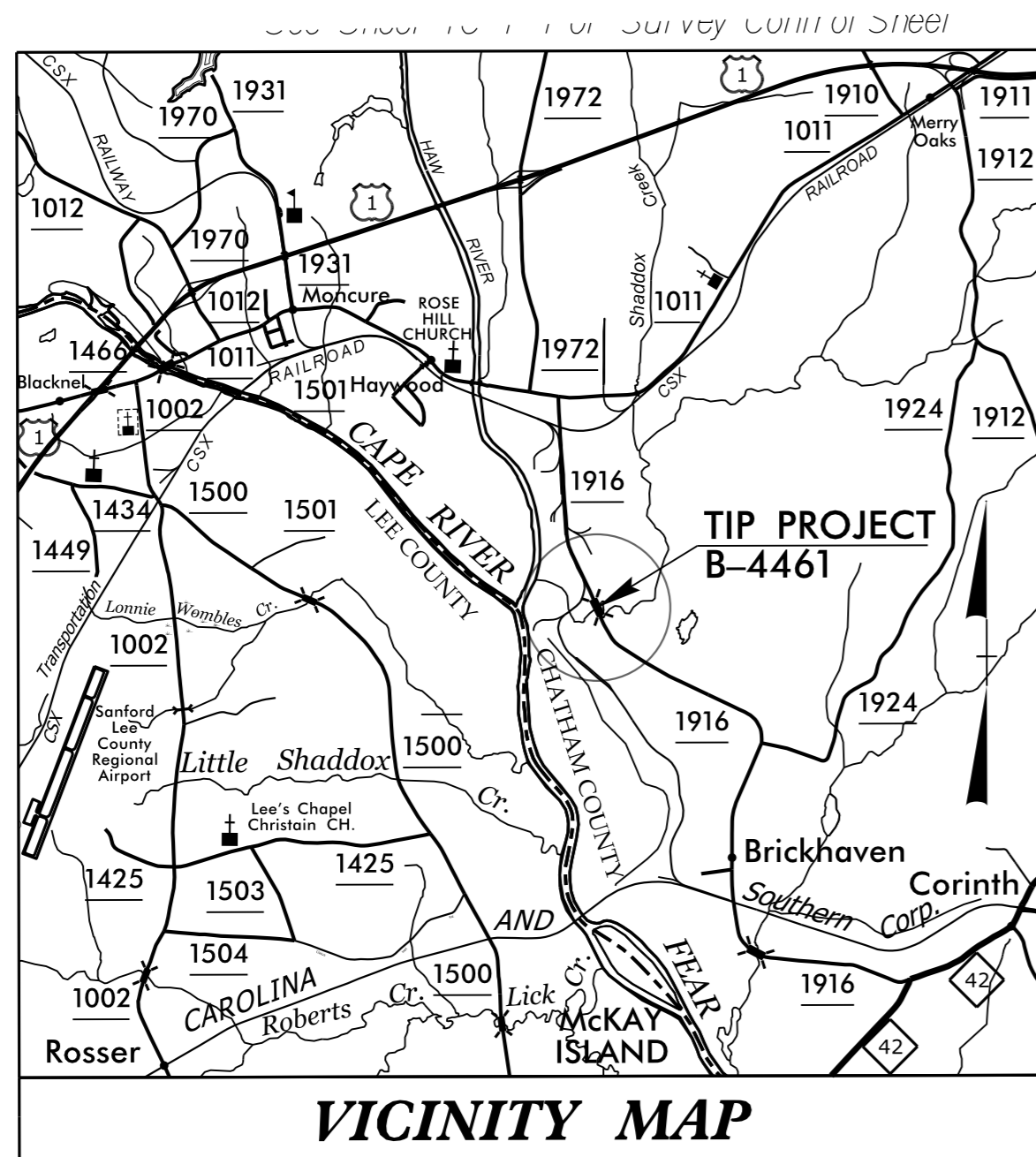

STATE OF NORTH CAROLINA  
DIVISION OF HIGHWAYS

**UTILITIES BY OTHERS PLANS  
CHATHAM COUNTY**

**LOCATION: BRIDGE 10 OVER SHADDOX CREEK ON SR 1916  
TYPE OF WORK: UTILITY RELOCATION**

T.I.P. NO. <b>B-4461</b>	SHEET NO. <b>UO-1</b>
-----------------------------	--------------------------

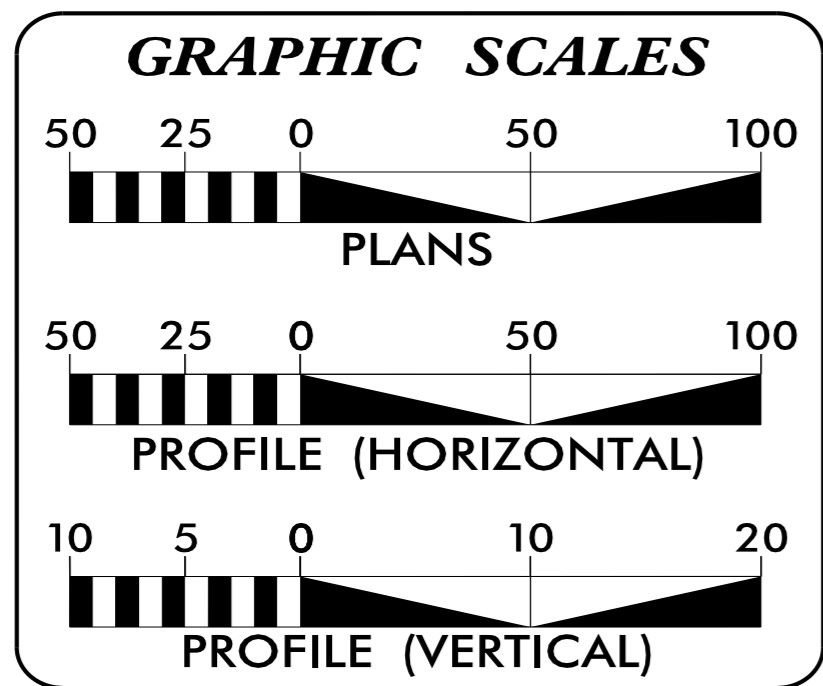
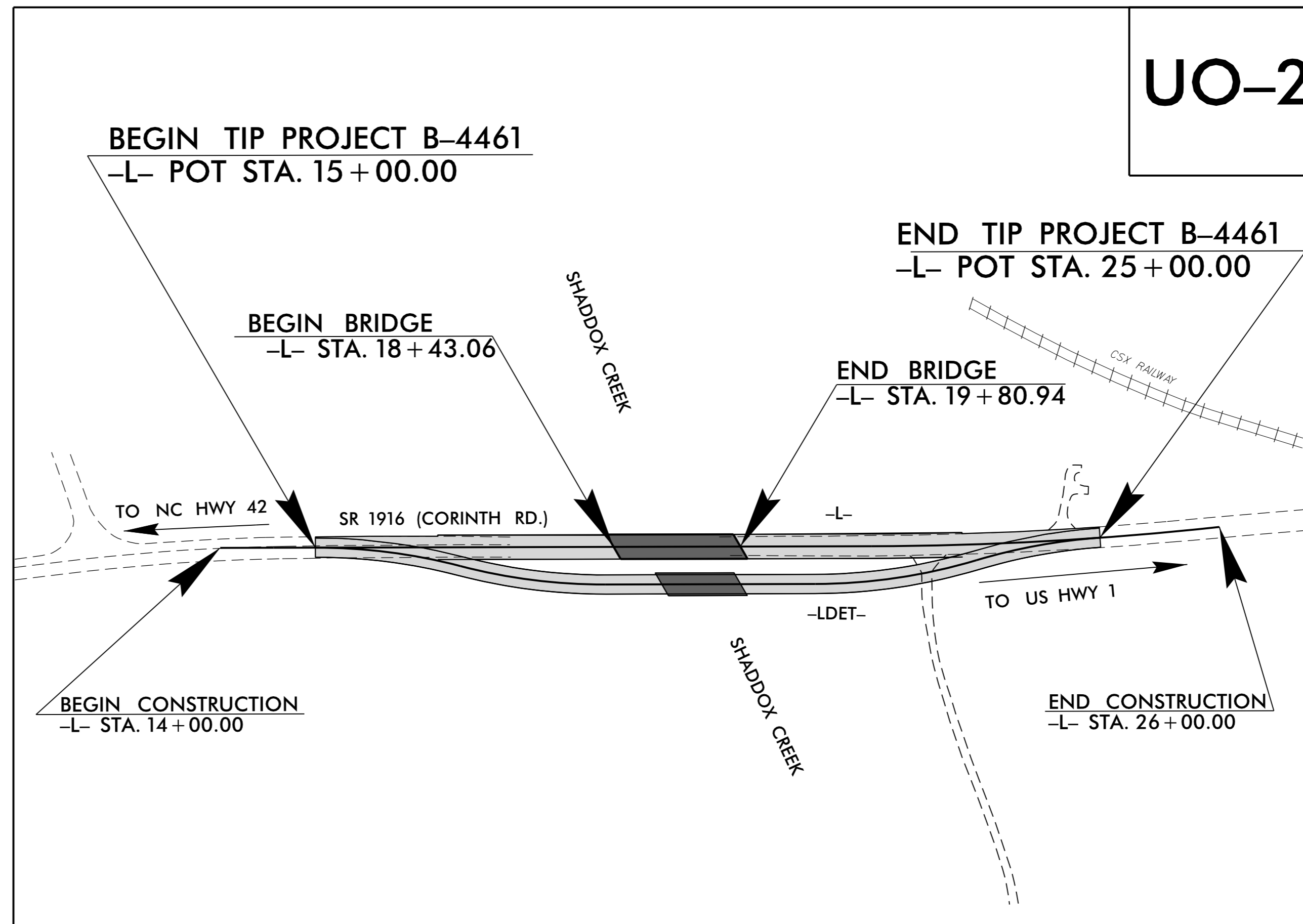
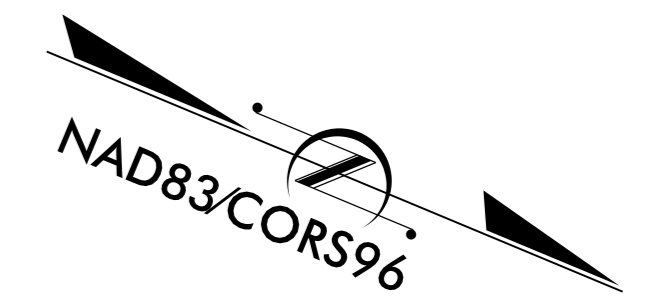

SHEET NO.	INDEX OF SHEETS DESCRIPTION
UO-1	TITLE SHEET
UO-2	UTILITY BY OTHERS PLAN SHEET

UTILITY OWNERS ON PROJECT	
(A)	DUKE ENERGY - POWER
(B)	PSNC - GAS
(C)	AT&T - TELEPHONE
(D)	CENTURYLINK - TELEPHONE
(E)	WINDSTREAM - TELEPHONE

PREPARED IN THE OFFICE OF:  
**DIVISION OF HIGHWAYS  
UTILITIES UNIT  
UTILITIES ENGINEERING**

1555 MAIL SERVICES CENTER  
RALEIGH, NC 27699-1555  
PHONE (919) 707-6690  
FAX (919) 250-4151

<u>Roger Worthington, P.E.</u>	UTILITIES SECTION ENGINEER
<u>Steve McKee, P.E.</u>	UTILITIES SQUAD LEADER PROJECT ENGINEER
<u>Donald Proper</u>	UTILITIES PROJECT DESIGN ENGINEER

**UTILITIES BY OTHERS**

NOTE:  
ALL PROPOSED UTILITY WORK SHOWN ON THIS SHEET WILL BE DONE BY OTHERS. NO PAYMENT WILL BE MADE TO THE CONTRACTOR FOR PROPOSED UTILITY WORK SHOWN ON THIS SHEET.

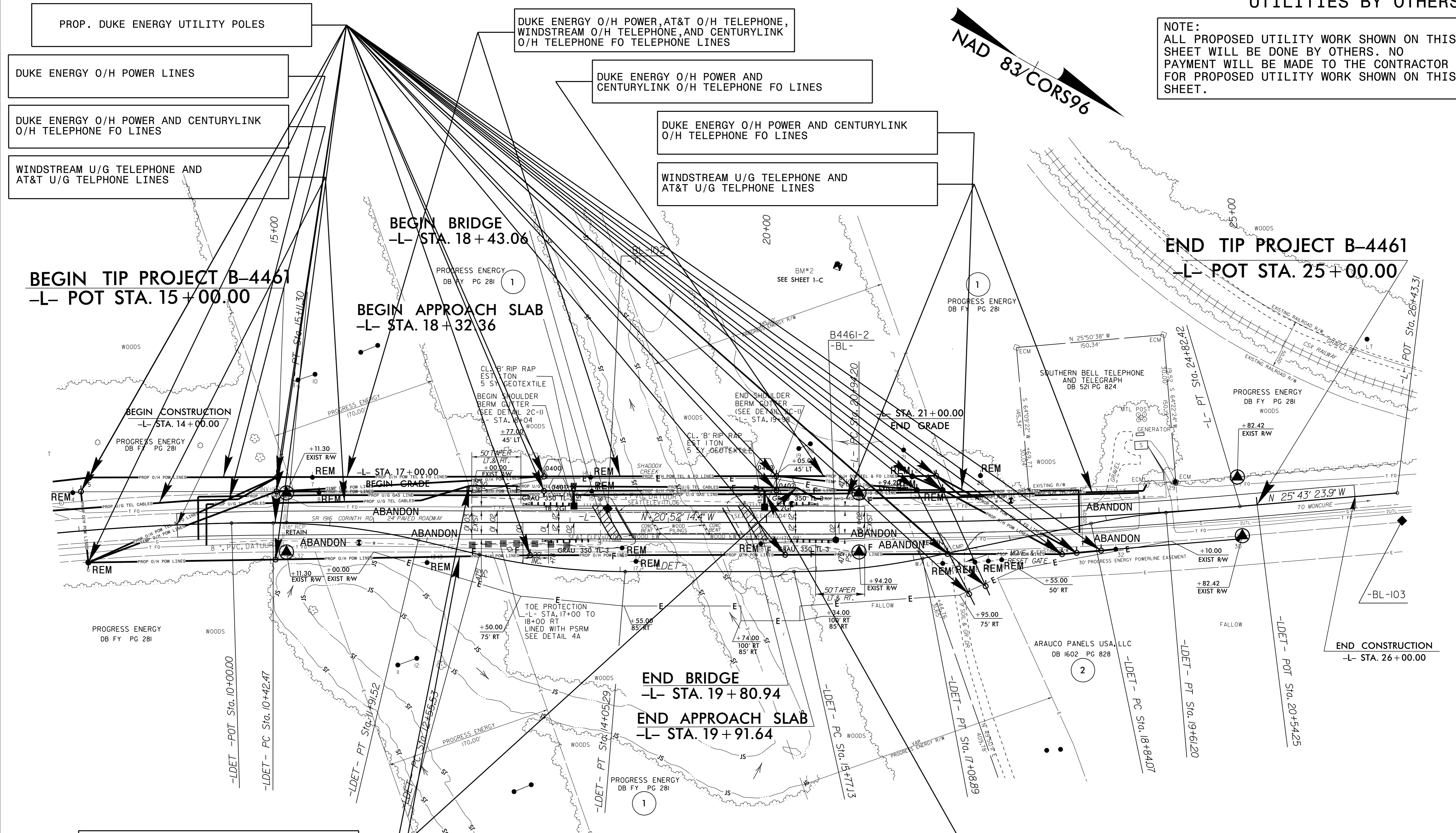
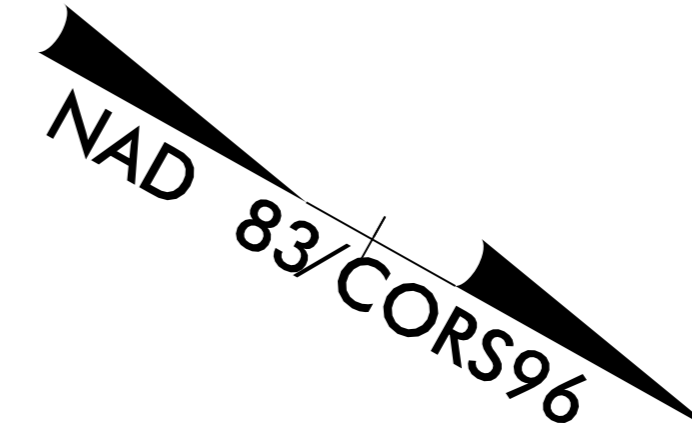

PROP. DUKE ENERGY UTILITY POLES

DUKE ENERGY O/H POWER LINES

DUKE ENERGY O/H POWER AND CENTURYLINK O/H TELEPHONE FO LINES

WINDSTREAM U/G TELEPHONE AND AT&T U/G TELEPHONE LINES

DUKE ENERGY O/H POWER, AT&T O/H TELEPHONE, WINDSTREAM O/H TELEPHONE, AND CENTURYLINK O/H TELEPHONE FO TELEPHONE LINES

DUKE ENERGY O/H POWER AND CENTURYLINK O/H TELEPHONE FO LINES

DUKE ENERGY O/H POWER AND CENTURYLINK O/H TELEPHONE FO LINES

WINDSTREAM U/G TELEPHONE AND AT&T U/G TELEPHONE LINES

**BEGIN TIP PROJECT B-4461**  
-L- POT STA. 15+00.00

**BEGIN BRIDGE**  
-L- STA. 18+43.06

**BEGIN APPROACH SLAB**  
-L- STA. 18+32.36

**END TIP PROJECT B-4461**  
-L- POT STA. 25+00.00

**BEGIN CONSTRUCTION**  
-L- STA. 14+00.00

**BEGIN GRADE**  
-L- STA. 17+00.00

**END GRADE**  
STA. 21+00.00

**END BRIDGE**  
-L- STA. 19+80.94

**END APPROACH SLAB**  
-L- STA. 19+91.64

**END CONSTRUCTION**  
-L- STA. 26+00.00

AT&T U/G TELEPHONE LINES INSTALLED BY TRENCHLESS INSTALLATION APPROXIMATELY 2' OUTSIDE EXISTING R/W WITHIN THIS AREA

DUKE ENERGY O/H POWER UTILITY POLES TO BE INSTALLED AFTER BRIDGE CONSTRUCTION IS COMPLETE

ALL O/H FACILITIES ON E/S OF PROPOSED BRIDGE SHALL BE TEMPORARILY RELOCATED TO THE FURTHEST DUKE ENERGY UTILITY POLES ON W/S OF BRIDGE FOR CLEARANCE PURPOSES TO CONSTRUCT THE DETOUR AND PERMANENT BRIDGES. AFTER BRIDGE CONSTRUCTION IS COMPLETE AND THE DETOUR BRIDGE IS REMOVED, DUKE ENERGY SHALL INSTALL ADDITIONAL UTILITY POLES AND O/H FACILITIES ON BOTH THE W/S (DUAL DISTRIBUTION) AND E/S ADJACENT TO THE PROPOSED BRIDGE.

PSNC U/G GAS MAIN BY TRENCHLESS INSTALLATION