

UTILITIES BY OTHERS

NOTE:
ALL PROPOSED UTILITY WORK SHOWN ON THIS SHEET WILL BE DONE BY OTHERS. NO PAYMENT WILL BE MADE TO THE CONTRACTOR FOR PROPOSED UTILITY WORK SHOWN ON THIS SHEET.

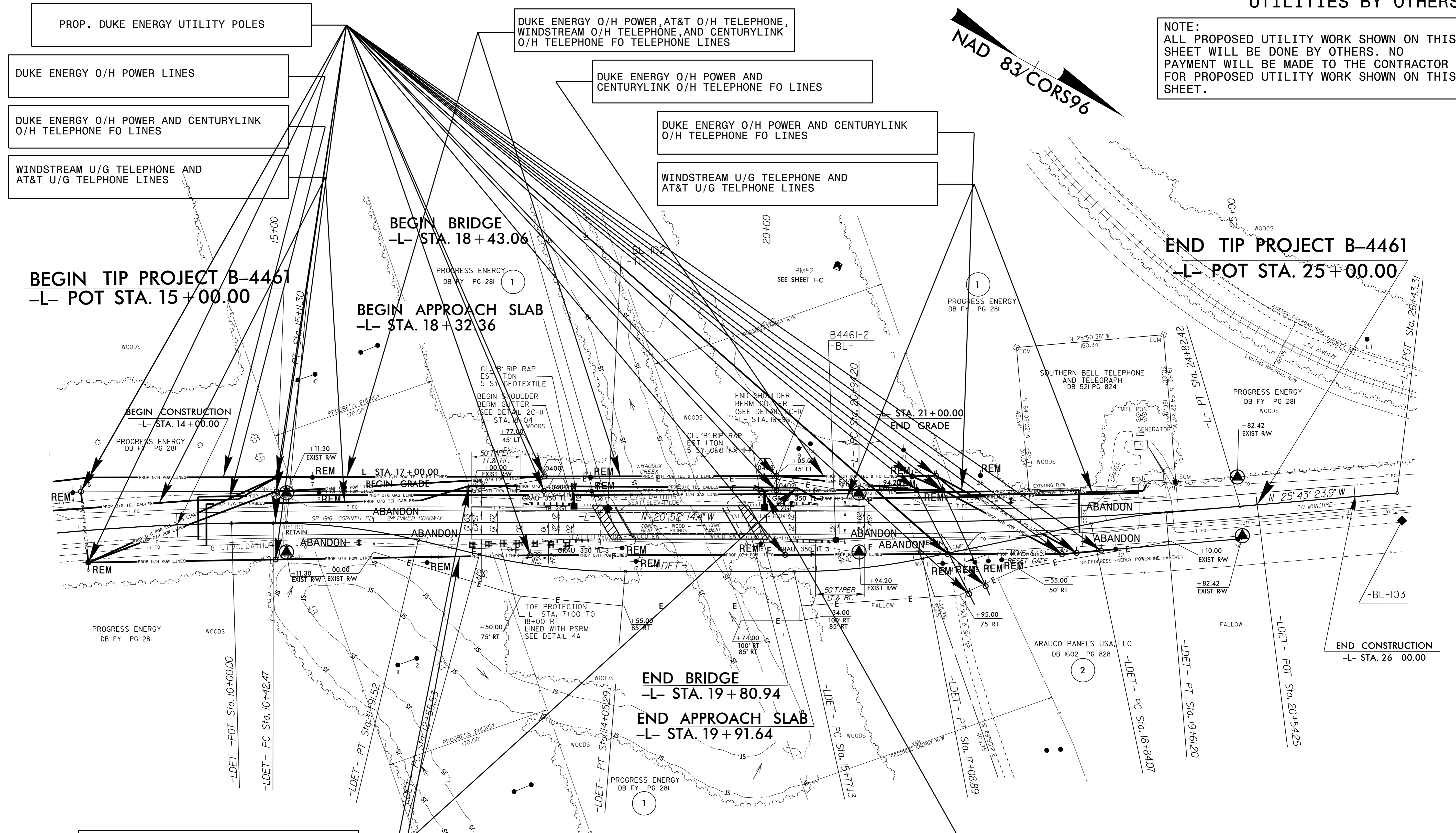
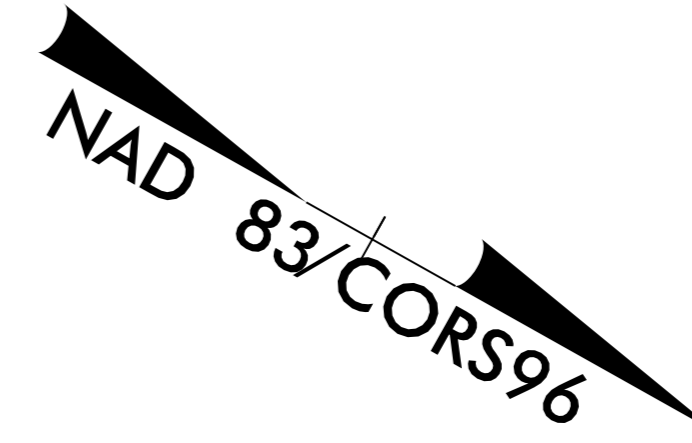

PROP. DUKE ENERGY UTILITY POLES

DUKE ENERGY O/H POWER LINES

DUKE ENERGY O/H POWER AND CENTURYLINK O/H TELEPHONE FO LINES

WINDSTREAM U/G TELEPHONE AND AT&T U/G TELEPHONE LINES

DUKE ENERGY O/H POWER, AT&T O/H TELEPHONE, WINDSTREAM O/H TELEPHONE, AND CENTURYLINK O/H TELEPHONE FO TELEPHONE LINES

DUKE ENERGY O/H POWER AND CENTURYLINK O/H TELEPHONE FO LINES

DUKE ENERGY O/H POWER AND CENTURYLINK O/H TELEPHONE FO LINES

WINDSTREAM U/G TELEPHONE AND AT&T U/G TELEPHONE LINES

BEGIN TIP PROJECT B-4461
-L- POT STA. 15+00.00

BEGIN APPROACH SLAB
-L- STA. 18+32.36

BEGIN BRIDGE
-L- STA. 18+43.06

END BRIDGE
-L- STA. 19+80.94

END APPROACH SLAB
-L- STA. 19+91.64

END TIP PROJECT B-4461
-L- POT STA. 25+00.00

END CONSTRUCTION
-L- STA. 26+00.00

AT&T U/G TELEPHONE LINES INSTALLED BY TRENCHLESS INSTALLATION APPROXIMATELY 2' OUTSIDE EXISTING R/W WITHIN THIS AREA

DUKE ENERGY O/H POWER UTILITY POLES TO BE INSTALLED AFTER BRIDGE CONSTRUCTION IS COMPLETE

ALL O/H FACILITIES ON E/S OF PROPOSED BRIDGE SHALL BE TEMPORARILY RELOCATED TO THE FURTHEST DUKE ENERGY UTILITY POLES ON W/S OF BRIDGE FOR CLEARANCE PURPOSES TO CONSTRUCT THE DETOUR AND PERMANENT BRIDGES. AFTER BRIDGE CONSTRUCTION IS COMPLETE AND THE DETOUR BRIDGE IS REMOVED, DUKE ENERGY SHALL INSTALL ADDITIONAL UTILITY POLES AND O/H FACILITIES ON BOTH THE W/S (DUAL DISTRIBUTION) AND E/S ADJACENT TO THE PROPOSED BRIDGE.

PSNC U/G GAS MAIN BY TRENCHLESS INSTALLATION