

EXISTING JOINT

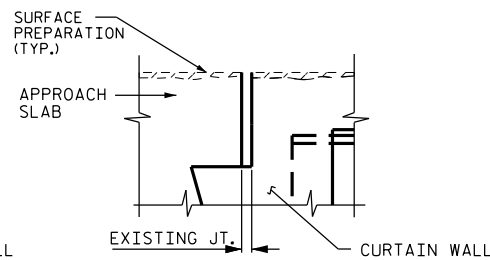

MINIMUM EXISTING JOINT DEMOLITION

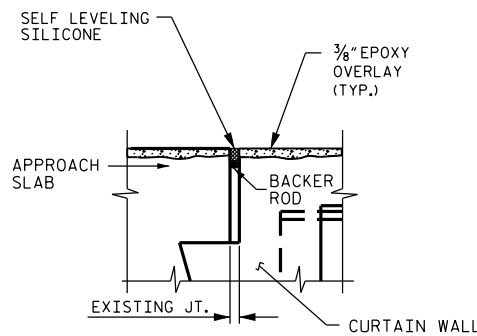

PROPOSED JOINT

JOINT INSTALLATION SEQUENCE AT END BENTS

SECTION A-A

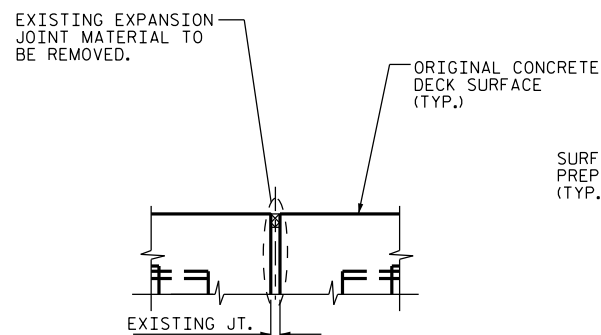

EXISTING JOINT

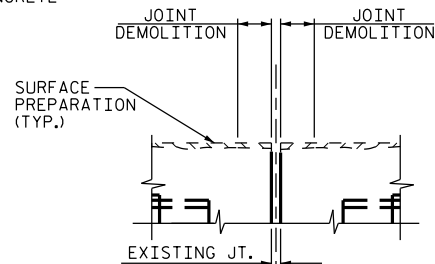

MINIMUM EXISTING JOINT DEMOLITION

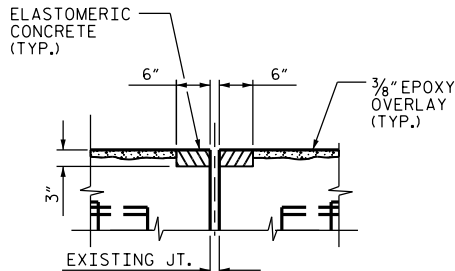

PROPOSED JOINT PRE-SAWED DIMENSIONS

JOINT INSTALLATION SEQUENCE AT BENTS

SECTION B-B

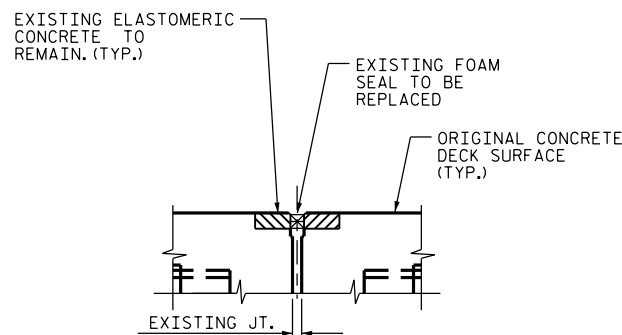

EXISTING JOINT

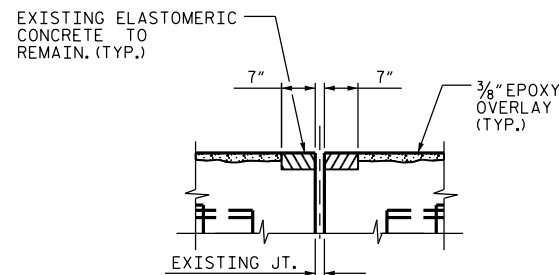

EXISTING FOAM JOINT SEAL REMOVED

JOINT INSTALLATION SEQUENCE AT BENT

SECTION C-C

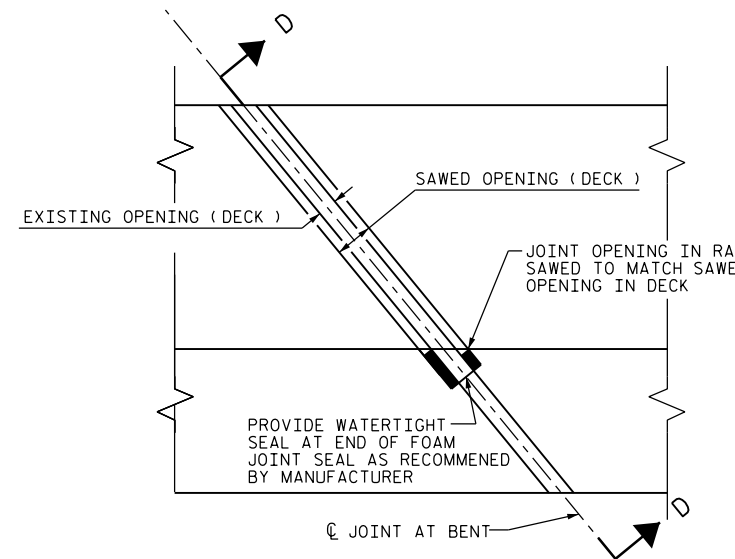

PLAN

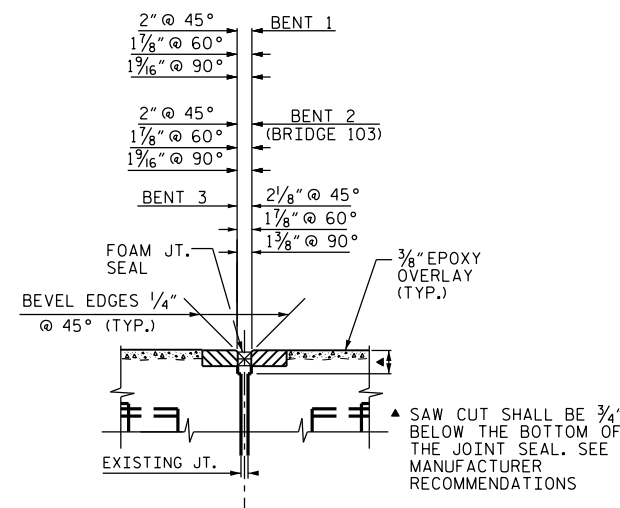

PROPOSED FOAM JOINT SEAL EXPANSION

BENT #1 (BRIDGES 99 & 103)
 BENT #2 (BRIDGE 103)
 BENT #3 (BRIDGES 99 & 103)

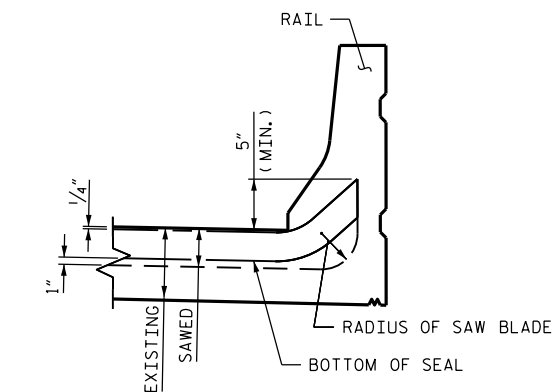

SECTION D-D

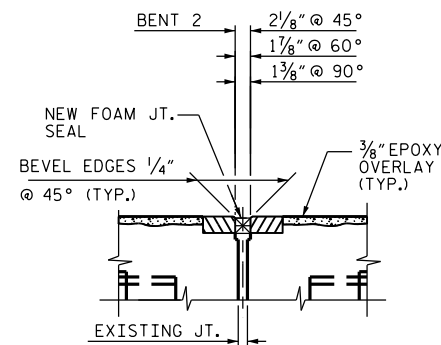

PROPOSED FOAM JOINT SEAL INSTALLATION

BENT #2 (BRIDGE 99)

DocuSigned by:
 Farzin Asefnia
 PROFESSIONAL ENGINEER
 SEAL 20103
 FARZIN ASEFNIA
 4/14/2016

PROJECT NO. I-5731
 CUMBERLAND COUNTY
 BRIDGE NO.: 99 & 103

STATE OF NORTH CAROLINA
 DEPARTMENT OF TRANSPORTATION
 RALEIGH
 SUPERSTRUCTURE
 JOINT DETAILS

DRAWN BY : D.V. JOYNER DATE : 1/2016
 CHECKED BY : F. ASEFNIA DATE : 1/2016

14-APR-2016 17:01
 R:\Structures\DCN\403.017_I5731_SMU.S24_JT99_103.DGN
 fosefnic

DOCUMENT NOT CONSIDERED
 FINAL UNLESS ALL
 SIGNATURES COMPLETED

REVISIONS						SHEET NO.
NO.	BY:	DATE:	NO.	BY:	DATE:	
1			3			S-24
2			4			TOTAL SHEETS 37