

EXIT 52 LOOP C - I-95

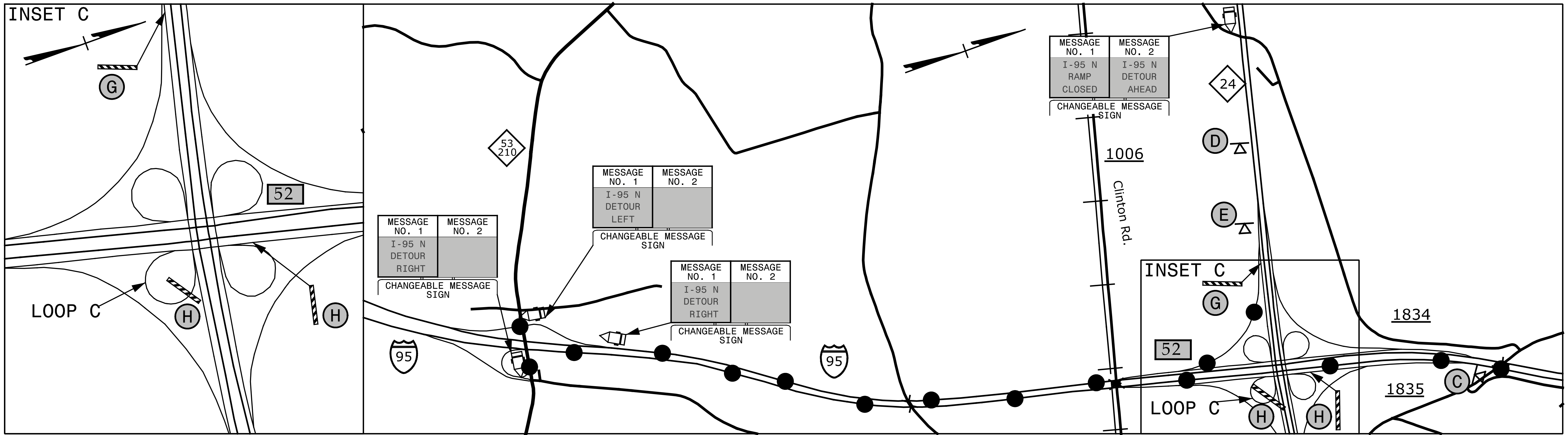

EXIT 52 LOOP D - I-95

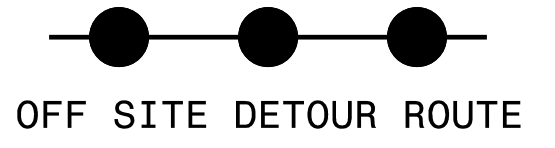
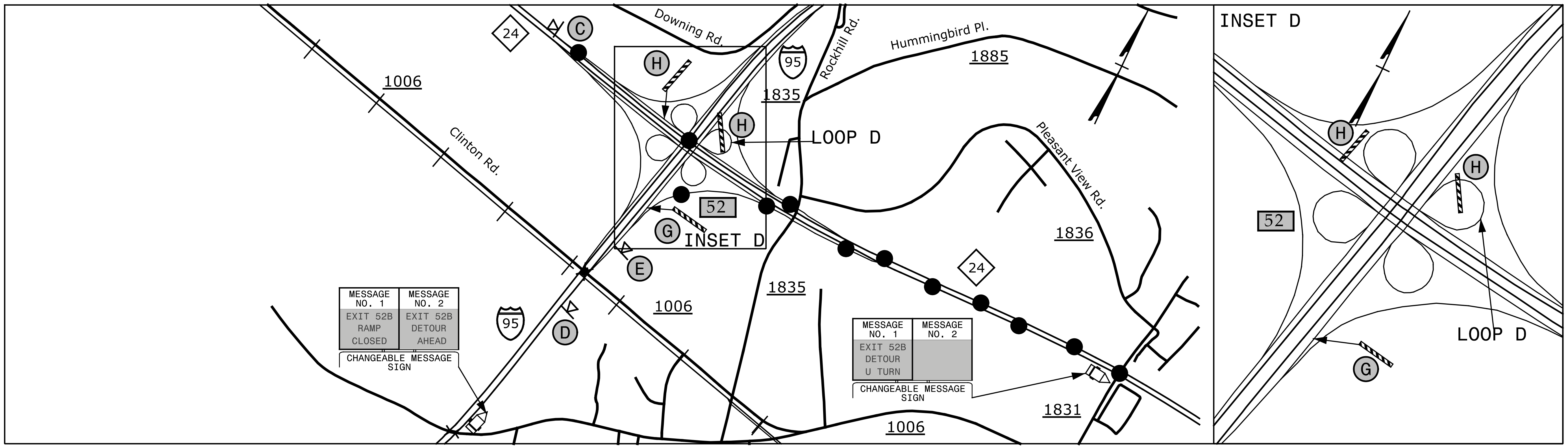

NOTE: 1. SEE TMP-2B FOR SIGN LEGEND
2. SEE TMP-3 FOR RAMP CLOSURE

SEPI
ENGINEERING & CONSTRUCTION
1025 Wade Avenue
Raleigh, NC 27605
Tel: 919-789-9977
Fax: 919-789-9591
License: C-2197

APPROVED: *Steve Miller*
DATE: 2/29/2016
SEAL
DOCUMENT NOT CONSIDERED FINAL
UNLESS ALL SIGNATURES COMPLETED

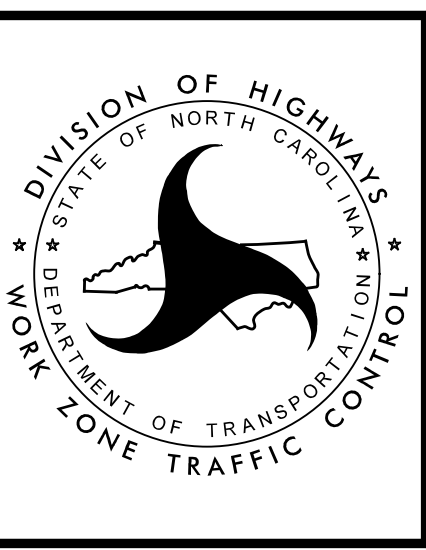

NC 24 DETOUR
DIVISION OF HIGHWAYS
STATE OF NORTH CAROLINA
DEPARTMENT OF TRANSPORTATION
WORK ZONE TRAFFIC CONTROL

2/8/2016 G:\Transportation\TR13.017.00 NCDOT 2012 Traffic LSA\TR13.017.17 (I-5731)\TMP\I-5731 TMP-19.dgn