

# EXIT 44 RAMP C - I-95

|                     |           |
|---------------------|-----------|
| PROJ. REFERENCE NO. | SHEET NO. |
| I-5731              | TMP-8     |

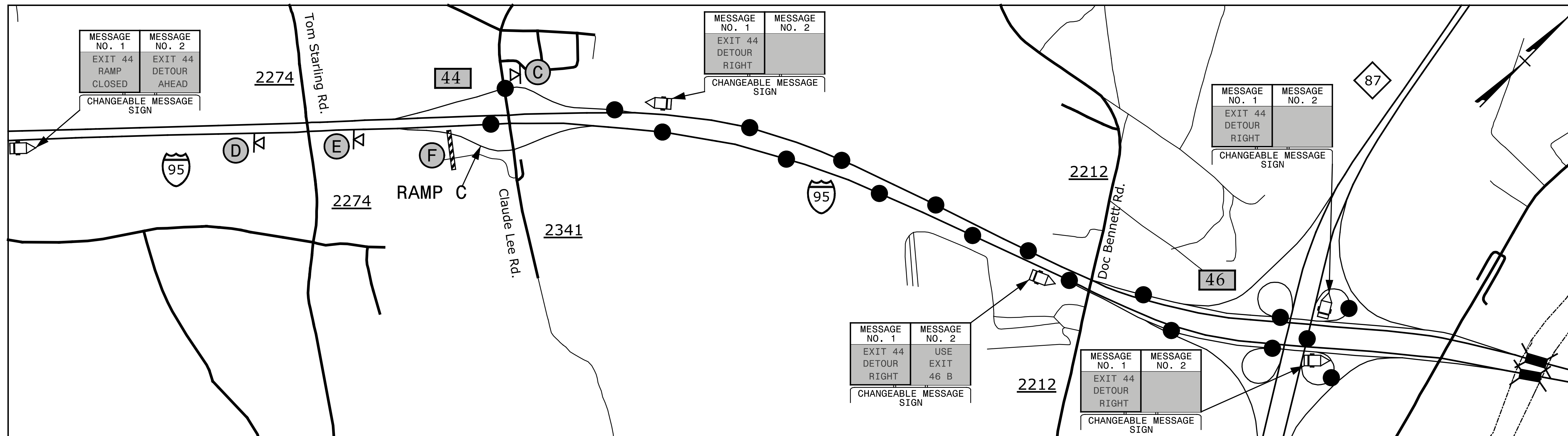

# EXIT 44 RAMP D - I-95

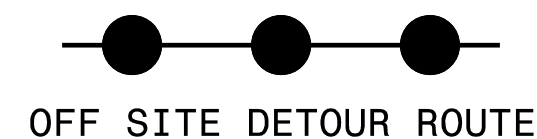
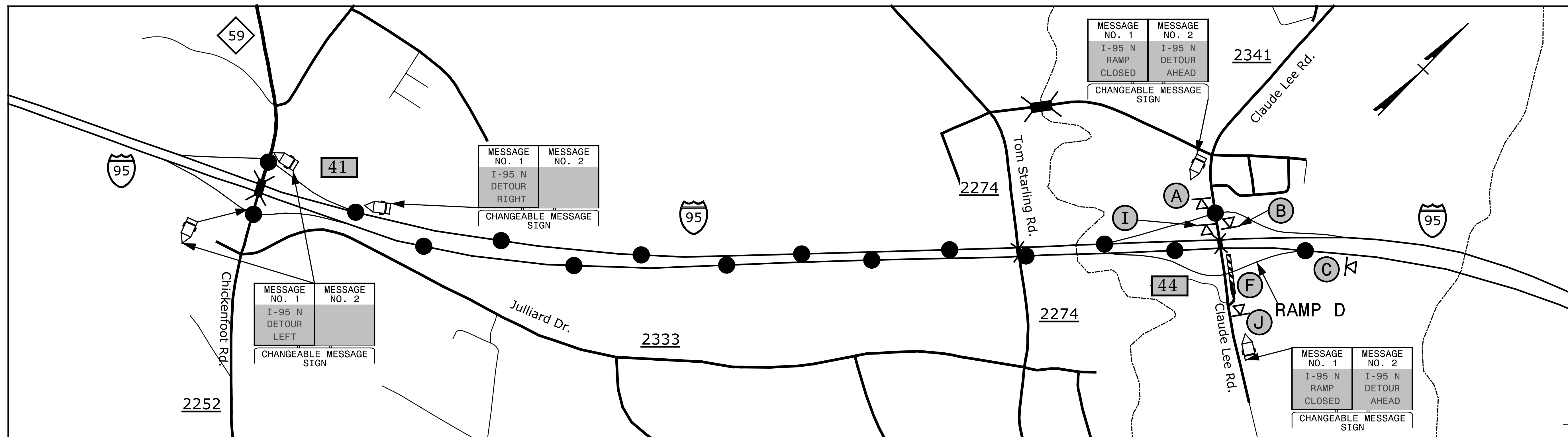

NOTE: 1. SEE TMP-2B FOR SIGN LEGEND  
2. SEE TMP-3 FOR RAMP CLOSURE

**SEPI**  
ENGINEERING & CONSTRUCTION  
1025 Wade Avenue  
Raleigh, NC 27605  
Tel: 919-789-9977  
Fax: 919-789-9591  
License: C-2197

APPROVED: *Steve Miller*  
DATE: 2/29/2016

SEAL

**DOCUMENT NOT CONSIDERED FINAL UNLESS ALL SIGNATURES COMPLETED**

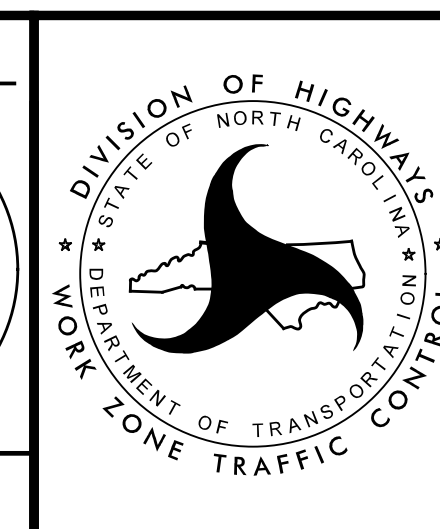

**CLAUDE LEE RD. DETOUR**

2/8/2016 G:\Transportation\TR13.017.00 NCDOT 2012 Traffic LSA\TR13.017.00 I-5731\TMP\I-5731-TMP-8.dgn