

PROJECT REFERENCE NO. R-4416	SHEET NO. 26
ROADWAY DESIGN ENGINEER NORTH CAROLINA PROFESSIONAL SEAL 034367 FOOD, H. BUCKNER 2/18/2016	HYDRAULICS ENGINEER NORTH CAROLINA PROFESSIONAL SEAL 20870 MARC T. SHOWN 2/18/2016
Michael Baker Engineering, Inc. 8000 Regency Park Suite 600 Cary, NC 27518 INTERNATIONAL NC License: P-11084	NC DEPARTMENT OF TRANSPORTATION HYDRAULICS UNIT 1500 MAIL SERVICE CENTER RALEIGH, NC 27699-1500
<b>DOCUMENT NOT CONSIDERED FINAL UNLESS ALL SIGNATURES COMPLETED</b>	

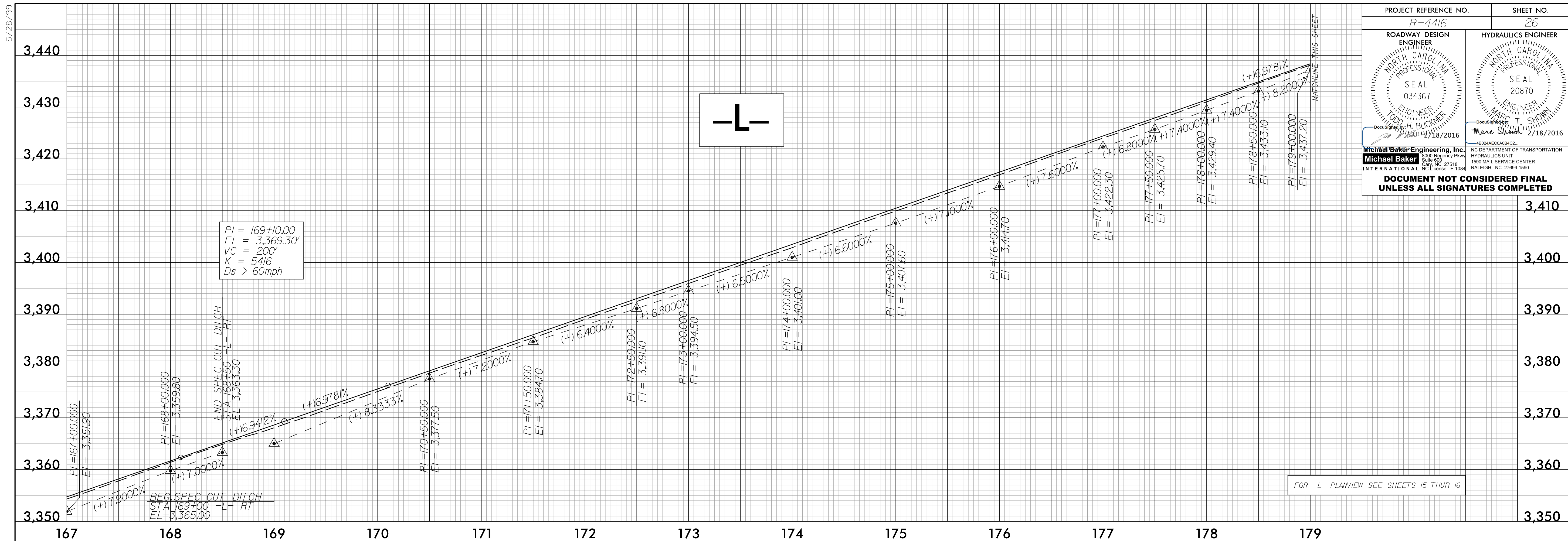

PI = 169+00.00  
EL = 3,369.30'  
VC = 200'  
K = 5416  
Ds > 60mph

FOR -L- PLANVIEW SEE SHEETS 15 THRU 16

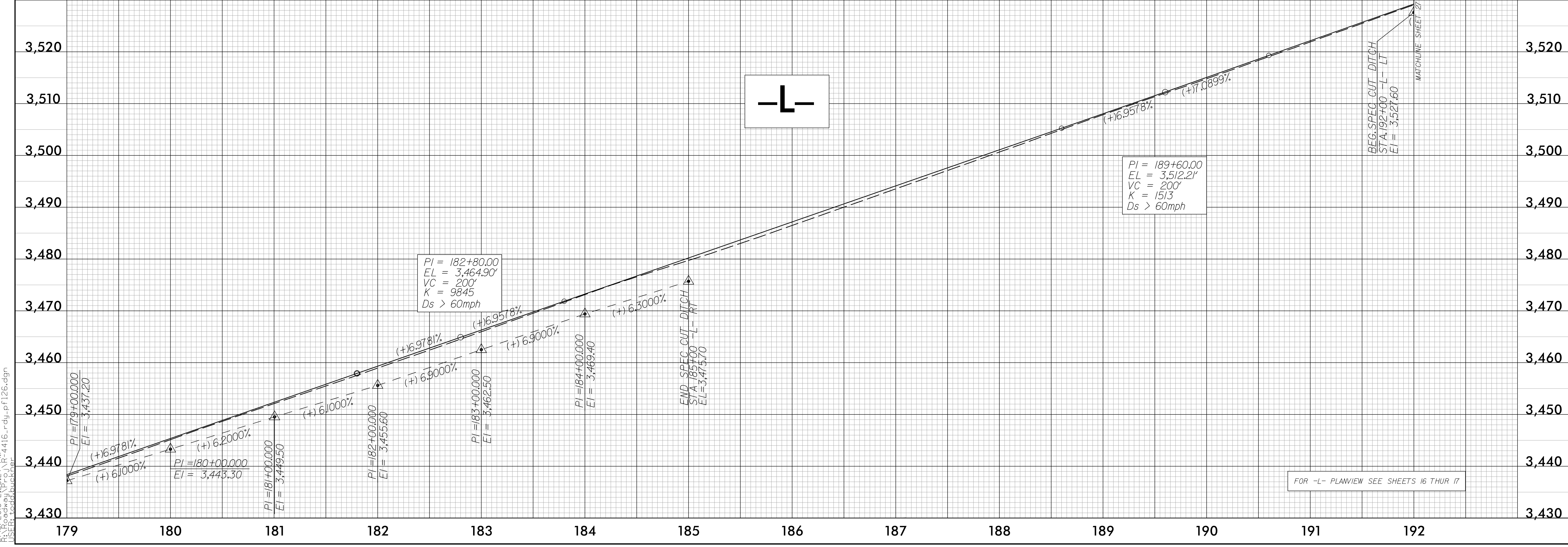

PI = 182+80.00  
EL = 3,464.90'  
VC = 200'  
K = 9845  
Ds > 60mph

PI = 189+60.00  
EL = 3,512.21'  
VC = 200'  
K = 1513  
Ds > 60mph

FOR -L- PLANVIEW SEE SHEETS 16 THRU 17

2/18/2016 2:08:27 PM R:\4416\_rdy\_pf126.dgn  
USER: foodh.buckner