

PROJECT REFERENCE NO. R-4416		SHEET NO. 8	
RW SHEET NO.			
ROADWAY DESIGN ENGINEER NORTH CAROLINA PROFESSIONAL ENGINEER SEAL 034367 LODD H. BUCKNER		HYDRAULICS ENGINEER NORTH CAROLINA PROFESSIONAL ENGINEER SEAL 20870 MARC T. SHOWN	
DocuSigned by: 2/18/2016		DocuSigned by: Marc Shown 2/18/2016	
Michael Baker Engineering, Inc. 1500 Regency Park Suite 600 Raleigh, NC 27618 INTERNATIONAL NC License: F-1084		NC DEPARTMENT OF TRANSPORTATION HYDRAULICS UNIT 1590 MAIL SERVICE CENTER RALEIGH, NC 27699-1590	
<b>DOCUMENT NOT CONSIDERED FINAL UNLESS ALL SIGNATURES COMPLETED</b>			

-L- LINE				
PI Sta 59+44.52 $\Delta = 76^{\circ} 05' 26.1''$ (LT) D = 5' 52' 35.4" L = 1,294.83' T = 763.00' R = 975.00' Ds = 50mph SE = .08	PIs Sta 65+25.79 $\Theta_s = 1^{\circ} 05' 03.4''$ Os = 3' 31' 33.9" Ls = 120.00' LT = 70.62' ST = 49.44'	PI Sta 70+44.18 $\Delta = 16^{\circ} 04' 55.0''$ (LT) D = 1' 48' 26.8" L = 889.76' T = 447.83' R = 3,170.00' Ds = 60mph SE = .05	PIs Sta 75+55.15 $\Theta_s = 1^{\circ} 05' 03.7''$ Os = 2' 51' 53.6" Ls = 120.00' LT = 69.04' ST = 51.01'	PI Sta 81+32.59 $\Delta = 47^{\circ} 22' 36.4''$ (LT) D = 4' 46' 28.7" L = 992.26' T = 526.47' R = 1,200.00' Ds = 60mph SE = .08

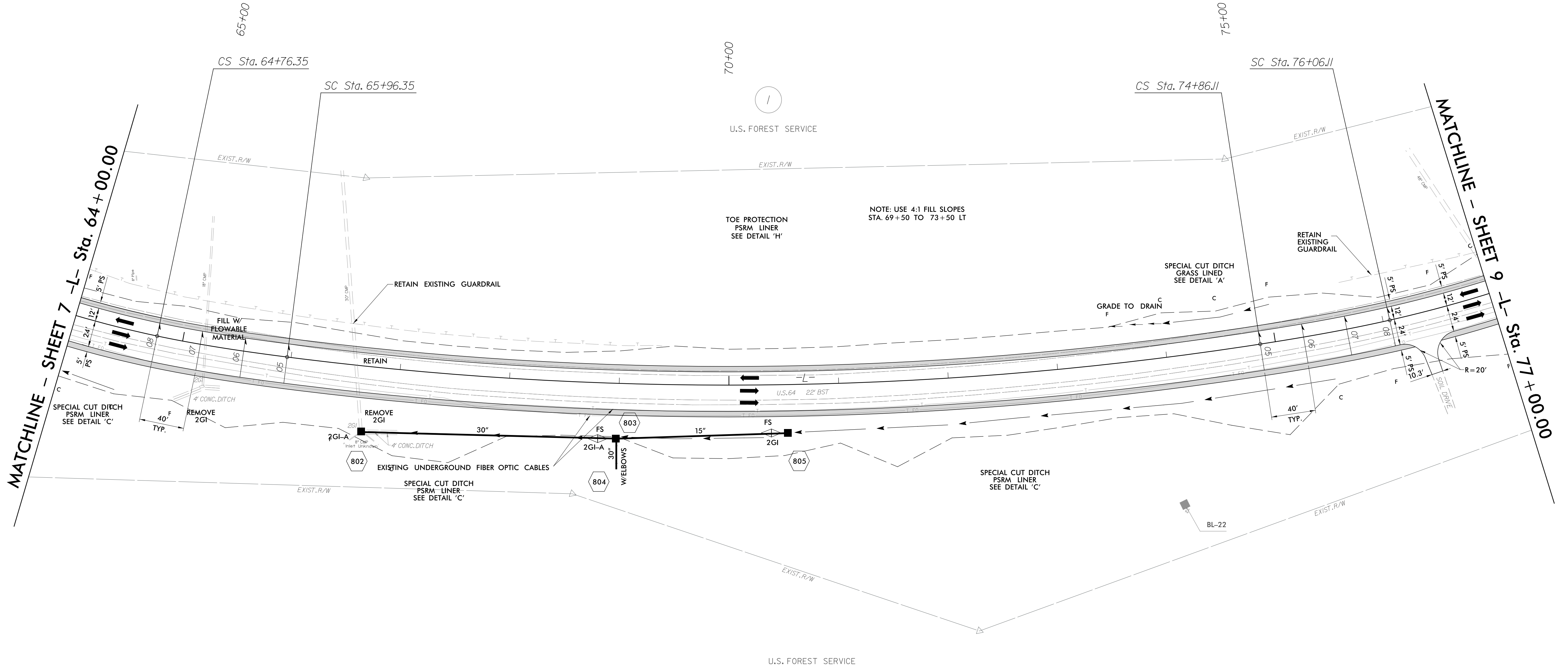
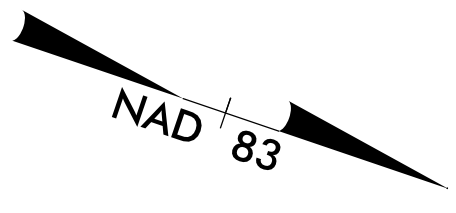
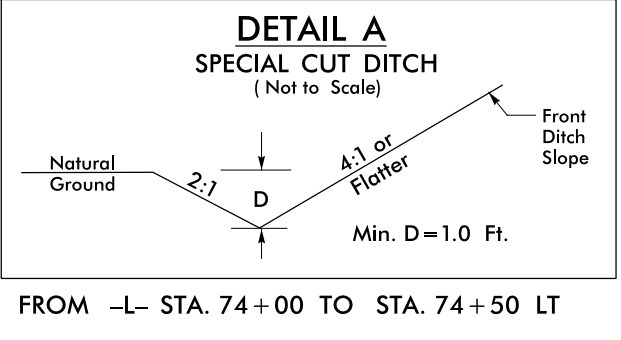
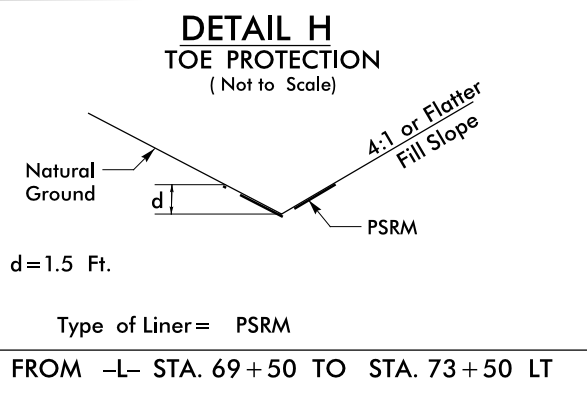
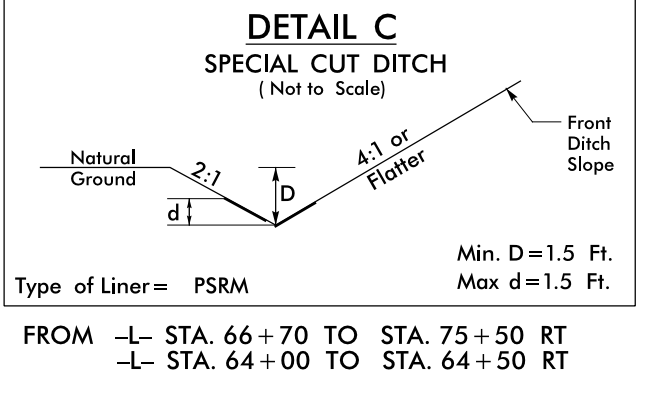

REVISIONS

2/18/2016 2:28:12 PM R:\4416.rdy\_psh08.dgn  
USER: todd.buckner

FOR -L- PROFILE SEE SHEET 22