

PROJECT REFERENCE NO. R-4416		SHEET NO. 5	
RW SHEET NO.			
ROADWAY DESIGN ENGINEER NORTH CAROLINA PROFESSIONAL SEAL 034367 LODD H. BUCKNER		HYDRAULICS ENGINEER NORTH CAROLINA PROFESSIONAL SEAL 20870 MARC T. SHOWN	
DocuSigned by: 2/18/2016		DocuSigned by: Marc Shown 2/18/2016	
Michael Baker Engineering, Inc. 1500 Regency Park Suite 800 27518 INTERNATIONAL NC License: F-1084		NC DEPARTMENT OF TRANSPORTATION HYDRAULICS UNIT 1500 MAIL SERVICE CENTER RALEIGH, NC 27699-1590	
DOCUMENT NOT CONSIDERED FINAL UNLESS ALL SIGNATURES COMPLETED			

-L- LINE

Pls Sta 23+78.58
 $\Theta_s = 3^\circ 29' 15.2''$
 $L_s = 280.00'$
 $LT = 186.70'$
 $ST = 93.37'$

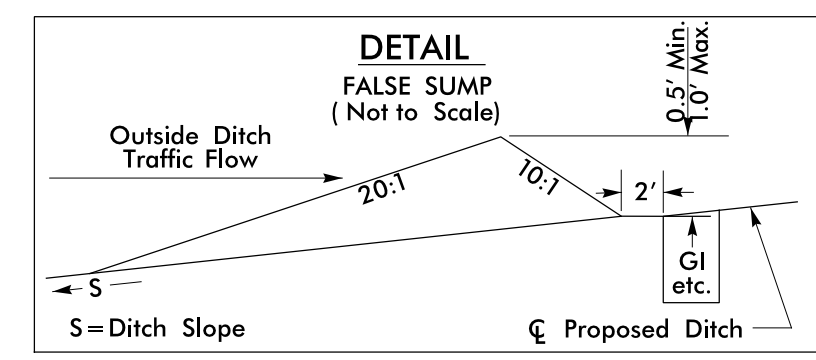

-L- LINE

Pls Sta 28+58.55
 $\Theta_s = 1^\circ 54' 35.5''$
 $L_s = 200.00'$
 $LT = 133.34'$
 $ST = 66.67'$

Pls Sta 31+48.78
 $\Delta = 8^\circ 31' 25.9'' (LT)$
 $D = 1^\circ 54' 35.5''$
 $L = 446.31'$
 $T = 223.57'$
 $R = 3,000.00'$
 $D_s = 60\text{mph}$
 $SE = .05$

Pls Sta 34+38.19
 $\Theta_s = 1^\circ 54' 35.5''$
 $L_s = 200.00'$
 $LT = 133.34'$
 $ST = 66.67'$

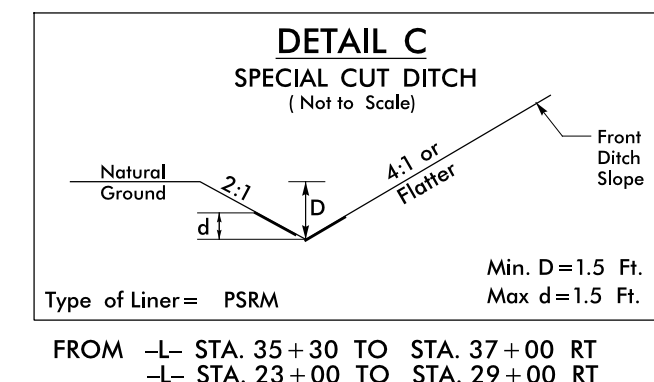
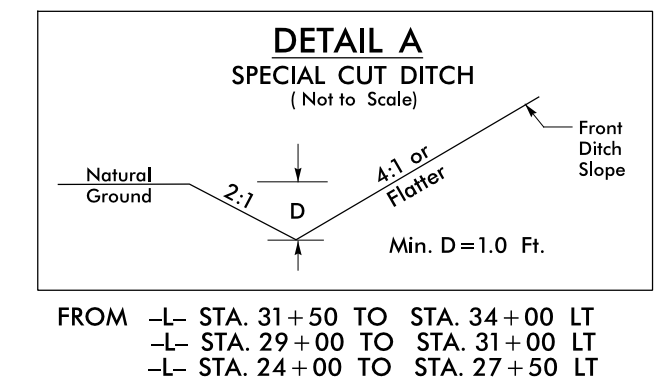

FROM -L- STA. 31+50 TO STA. 34+00 LT
 -L- STA. 29+00 TO STA. 31+00 LT
 -L- STA. 24+00 TO STA. 27+50 LT

FROM -L- STA. 35+30 TO STA. 37+00 RT
 -L- STA. 23+00 TO STA. 29+00 RT

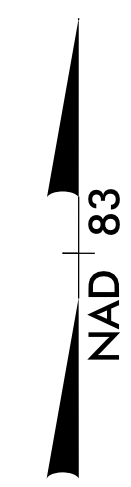

REVISIONS

MATCHLINE - SHEET 4 -L- Sta. 23+00.00

MATCHLINE - SHEET 6 -L- Sta. 37+00.00

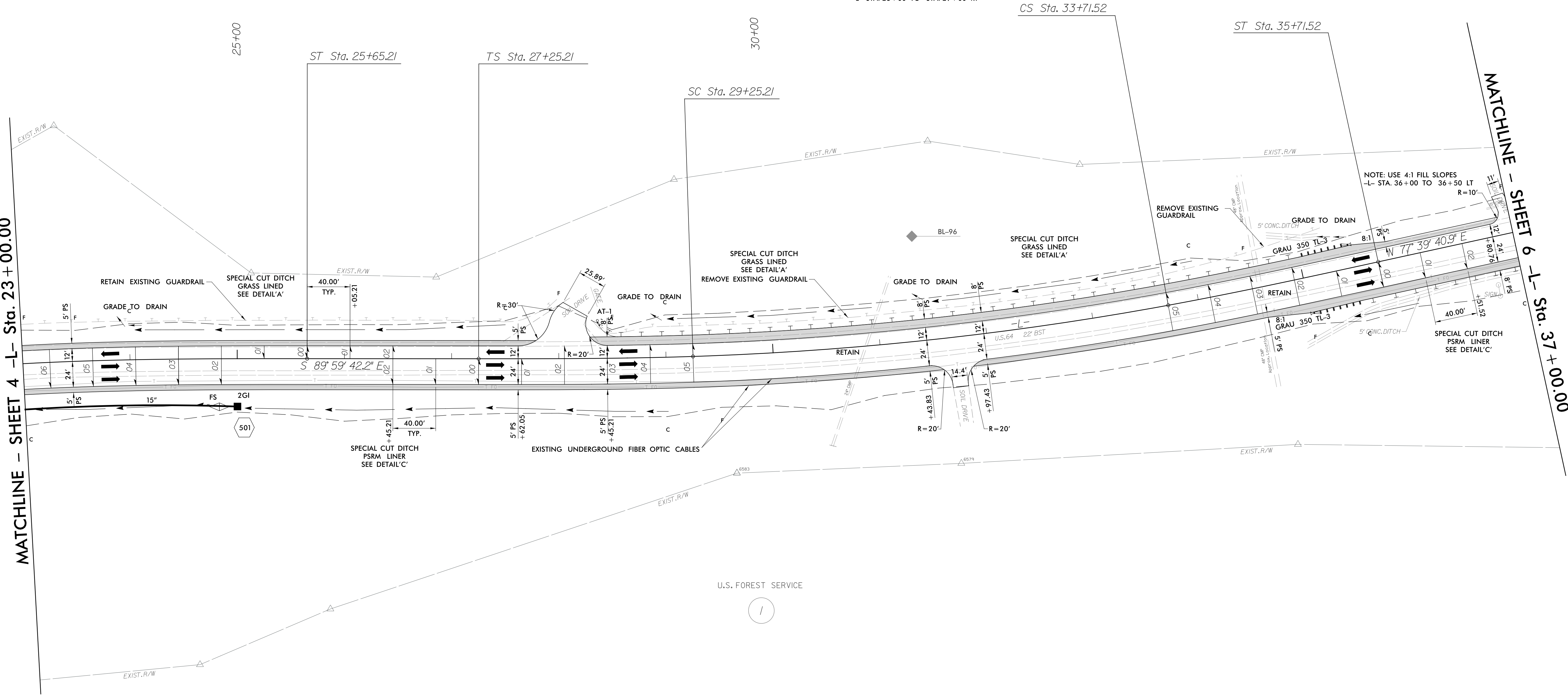

2/18/2016 2:28:10 PM 4416.rdy_psh05.dgn
USER: loddh.buckner

FOR -L- PROFILE SEE SHEET 20