

PHASE I

STEP 1: - INSTALL WORK ZONE ADVANCE WARNING SIGNS ON -L- AND -Y1- AS SHOWN IN ROADWAY STANDARD DRAWING NO. 1101.01

STEP 2: - USING RSD 1101.02, SHEET 1 OF 15 AS NECESSARY, INSTALL TEMPORARY SIGNALS AND SIGNING AS SHOWN ON SIGNAL PLANS AND ACTIVATE ALL SIGNALS TO FLASH MODE.

STEP 3: - USING RSD 1101.02, SHEET 1 OF 15 AS NECESSARY, PLACE PORTABLE CONCRETE BARRIER (PCB) AND CRASH CUSHIONS FROM STA. 15+80 -L- TO STA. 16+97+-L- AND FROM STA. 17+38+-L- TO STA. 18+10 -L- AND ANCHORED PCB FROM STA. 16+97+-L- TO STA. 17+38+-L- (LIMITS OF EXISTING BRIDGE).
 - OBLITERATE EXISTING PAVEMENT MARKING FROM STA. 14+55 -L- +- TO STA 18+00 -L- +-. PLACE TEMPORARY PAVEMENT MARKING FROM STA. 14+55 -L- TO STA 18+00 -L- AS SHOWN. PLACE STOP BAR PAVEMENT MARKING IN THREE PLACES AS SHOWN.
 - PLACE ADVANCE SIGNING AS SHOWN ON SHEET TMP-4.
 - ACTIVATE SIGNALS AND SHIFT TRAFFIC TO ONE LANE TWO WAY PATTERN ON -L- (DAVIS CREEK ROAD).

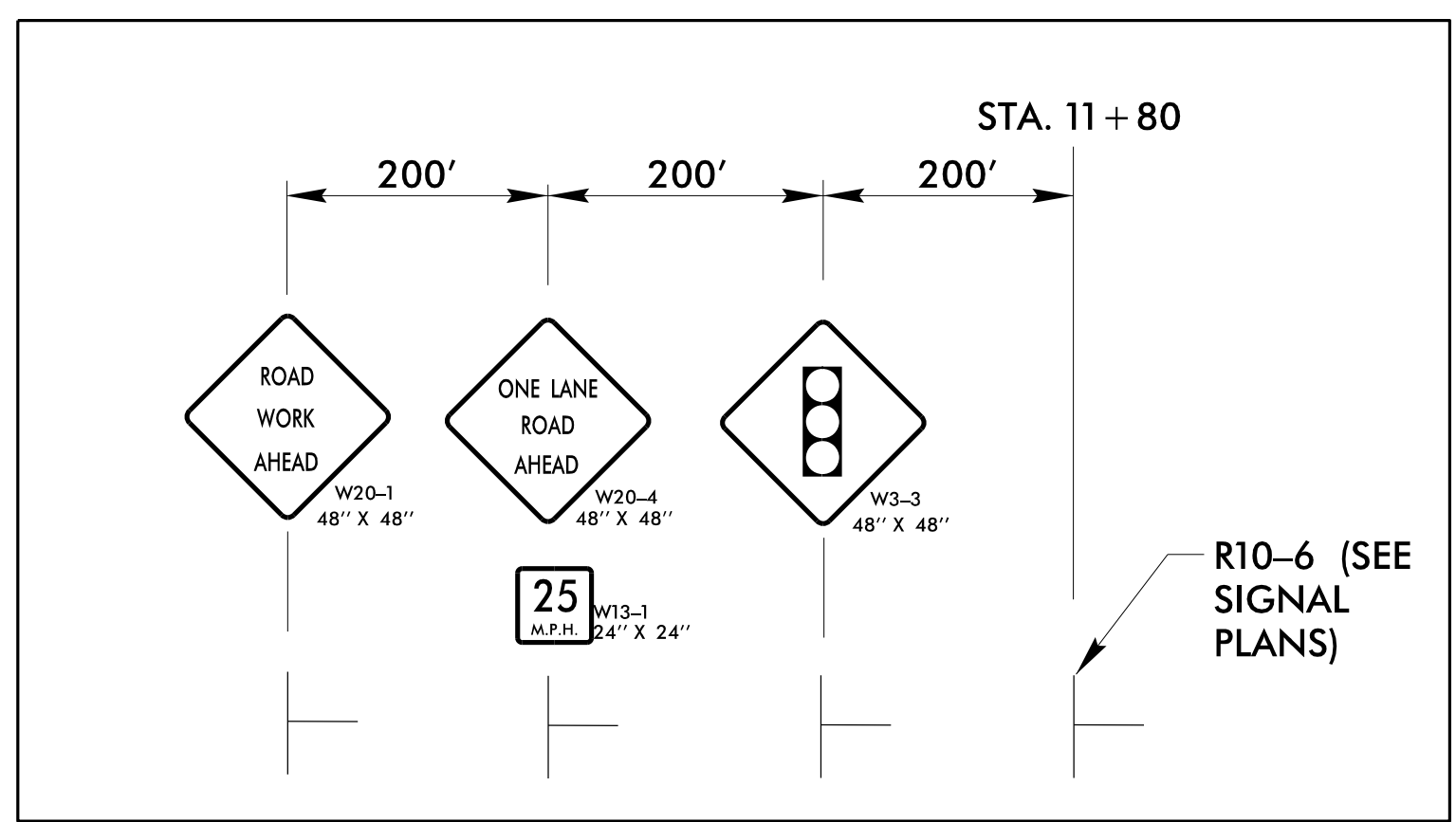
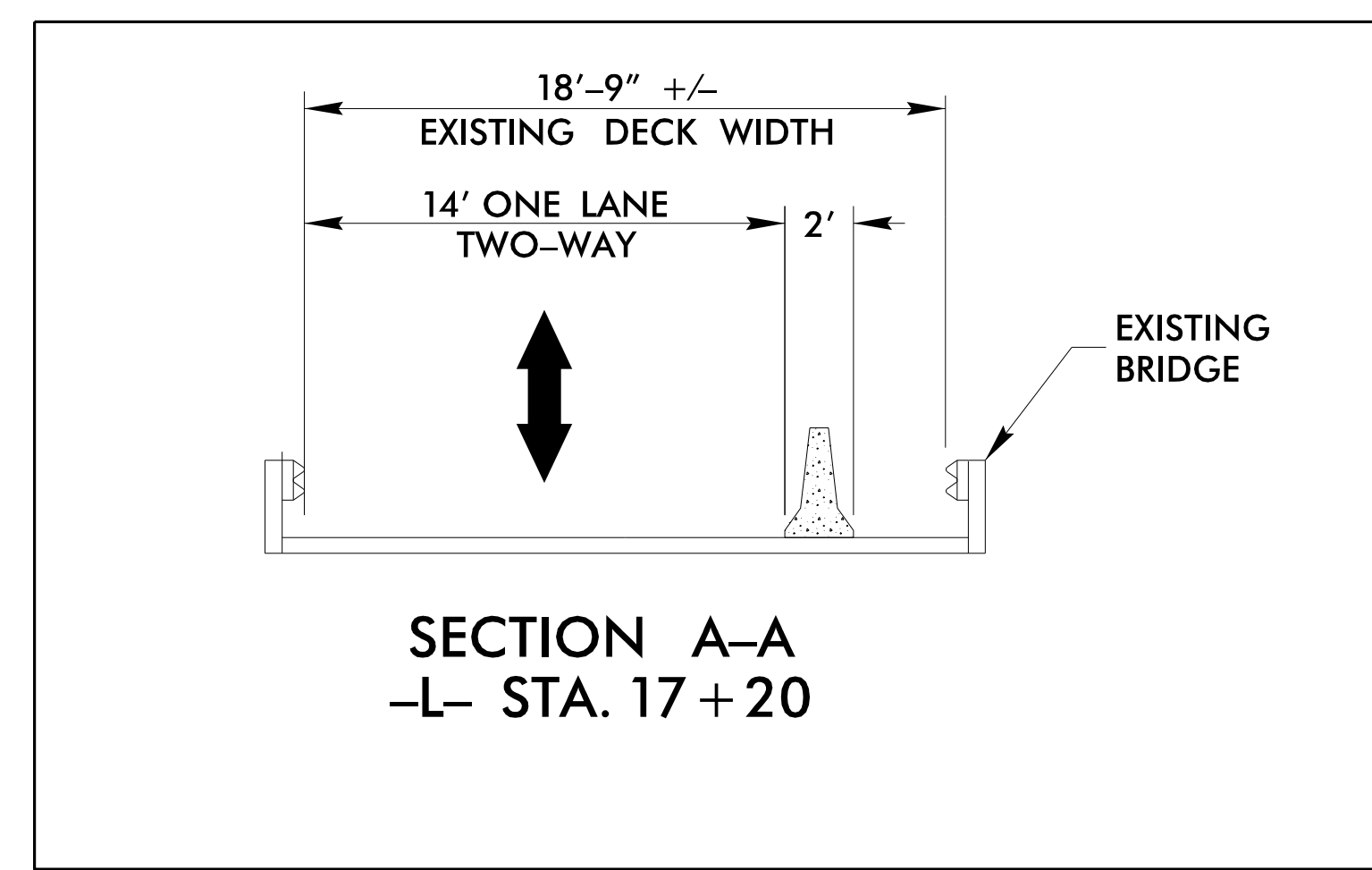
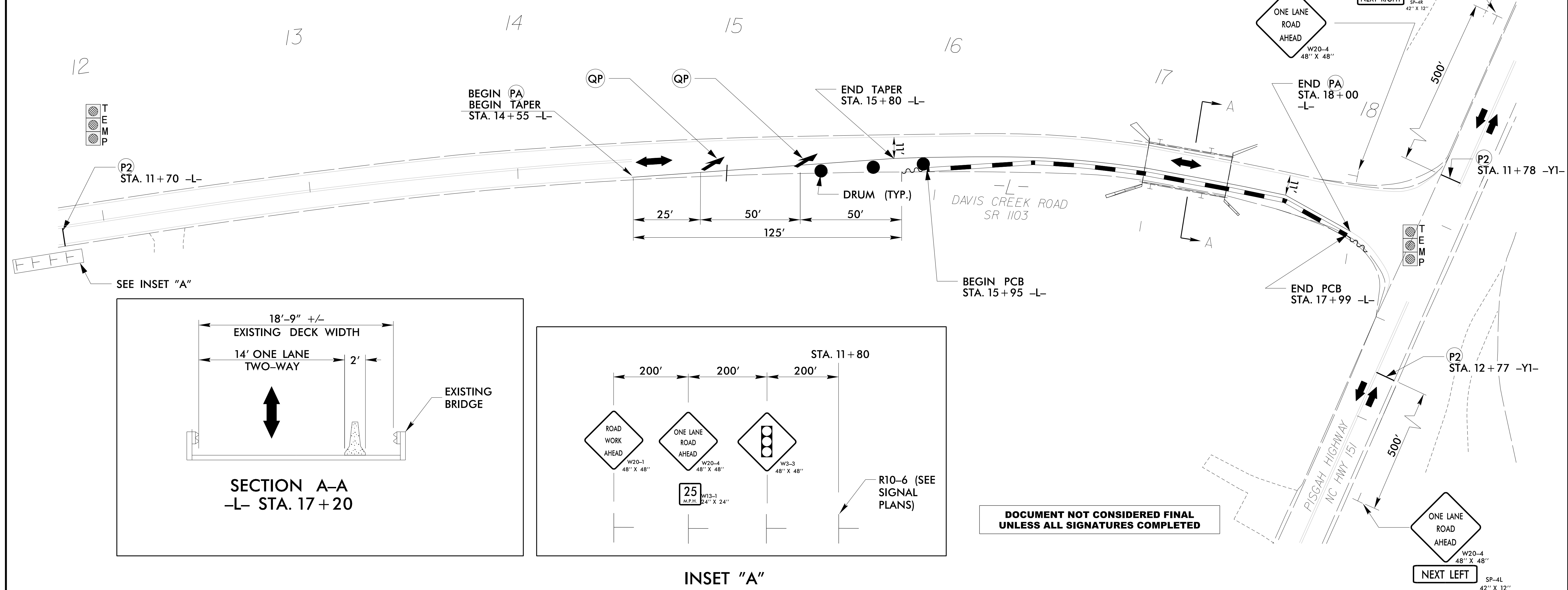

DOCUMENT NOT CONSIDERED FINAL UNLESS ALL SIGNATURES COMPLETED

12/18/2015 T:\2014\114001\00_B-5396_Buncombe\TrafficControl\TCP\B5396_Tc_TCP_PHASEI.dgn User:druggles

STEWART

Firm License No. C-1051
 421 Fayetteville St., Suite 400
 Raleigh, NC 27601
 T 919.380.8750
 www.stewartinc.com

APPROVED: *David Ruggles* DATE: 12/18/2015

SEAL: NORTH CAROLINA PROFESSIONAL ENGINEER DAVID R. RUGGLES SEAL 11725

DIVISION OF HIGHWAYS
 STATE OF NORTH CAROLINA
 DEPARTMENT OF TRANSPORTATION
 WORK ZONE TRAFFIC CONTROL

TRANSPORTATION MANAGEMENT PLAN PHASE I