

SURVEY CONTROL SHEET B-5396

PROJECT REFERENCE NO.	SHEET NO.
B-5396	1C-1
Location and Surveys	

POINT	DESC.	NORTH	EAST	ELEVATION	L STATION	OFFSET
GPS1	B5396-1	650007.4550	885611.3950	2401.38	OUTSIDE PROJECT LIMITS	
1	BL-1	650128.1825	885780.7911	2392.89	OUTSIDE PROJECT LIMITS	
2	BL-2	650361.6617	886167.9475	2385.57	14+36.46	20.11 LT
GPS2	B5396-2	650393.4190	886286.4090	2385.90	15+57.18	6.85 LT
3	BL-3	650507.0405	886538.2142	2384.45	18+29.42	48.99 LT

.....
 BM1 ELEVATION = 2394.43
 N 650195 E 885747
 LOCATED N 27°07'50" W DIST 75' FROM BL-1
 8" SPIKE SET IN ROOT OF A 24" WALNUT
 TREE

.....
 BM2 ELEVATION = 2373.91
 N 650868 E 886441
 L STATION 18+29.00 423 LEFT
 8" SPIKE SET IN ROOT OF A 20" DOUBLE
 PRONG LOCUST TREE

.....
 BM3 ELEVATION = 2393.04
 N 650054 E 886578
 L STATION 17+51.00 399 RIGHT
 CONCRETE NAIL SET IN CENTER OF CONCRETE
 HEADWALL

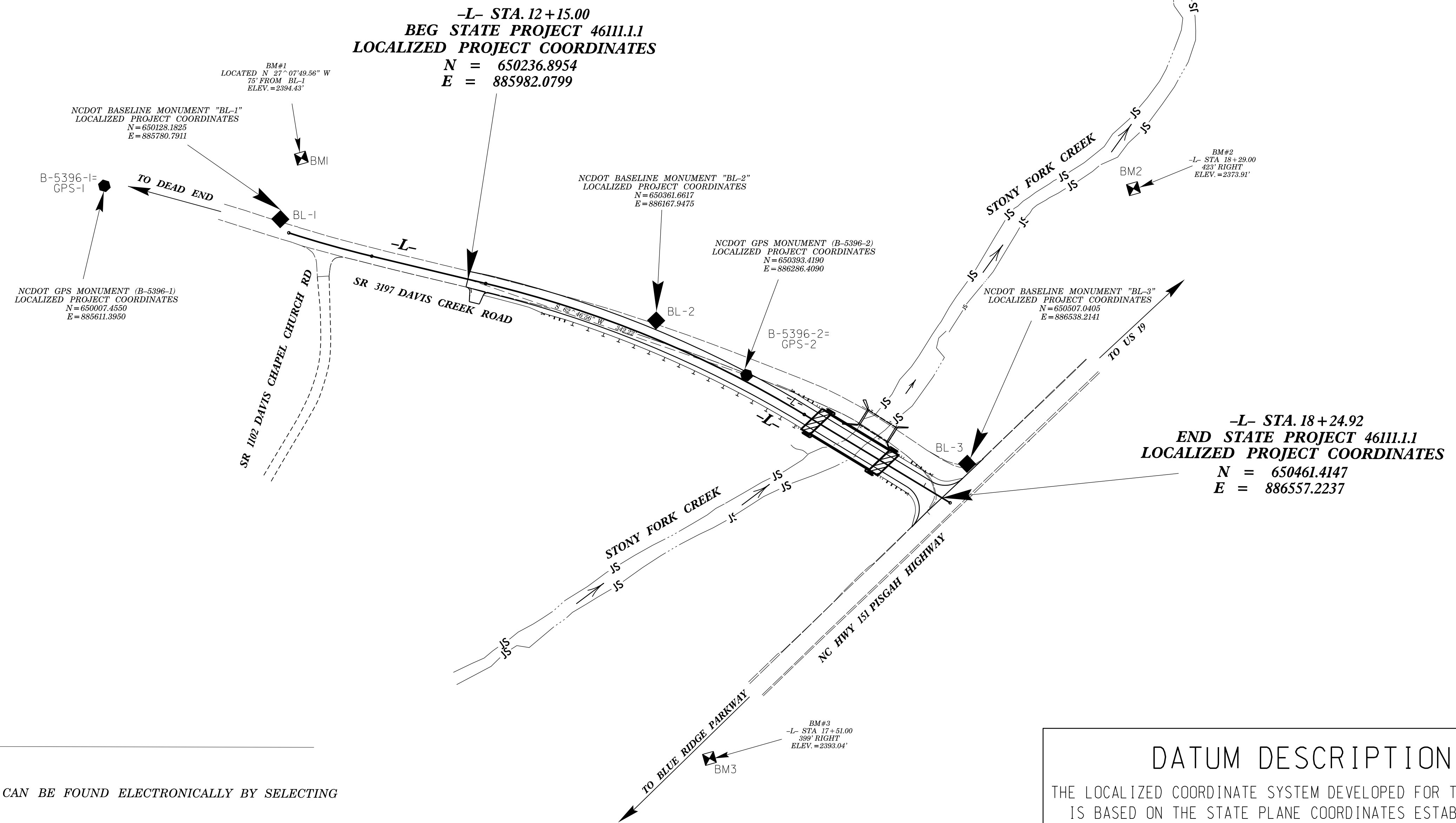

NOTES:

1. THE CONTROL DATA FOR THIS PROJECT CAN BE FOUND ELECTRONICALLY BY SELECTING PROJECT CONTROL DATA AT:
[HTTP://WWW.DOH.DOT.STATE.NC.US/PRECONSTRUCT/HIGHWAY/LOCATION/PROJECT/](http://www.doh.dot.state.nc.us/preconstruct/highway/location/project/)

THE FILES TO BE FOUND ARE AS FOLLOWS:
 B5396_LS_CONTROL.TXT

SITE CALIBRATION INFORMATION HAS NOT BEEN PROVIDED FOR THIS PROJECT. IF FURTHER INFORMATION IS NEEDED, PLEASE CONTACT THE LOCATION AND SURVEYS UNIT.

- INDICATES GEODETIC CONTROL MONUMENTS USED OR SET FOR HORIZONTAL PROJECT CONTROL BY THE NCDOT LOCATION AND SURVEYS UNIT.
- PROJECT CONTROL ESTABLISHED USING GLOBAL POSITIONING SYSTEM.
- NETWORK ESTABLISHED FROM NGS ONLINE POSITIONING SERVICE (OPUS)

DATUM DESCRIPTION

THE LOCALIZED COORDINATE SYSTEM DEVELOPED FOR THIS PROJECT IS BASED ON THE STATE PLANE COORDINATES ESTABLISHED BY NCDOT FOR MONUMENT "B-5396-2=GPS-2" WITH NAD 83/NSRS 2007 STATE PLANE GRID COORDINATES OF NORTHING: 650393.4190(++) EASTING: 886286.4090(++) ELEVATION: 2385.90(++)

THE AVERAGE COMBINED GRID FACTOR USED ON THIS PROJECT (GROUND TO GRID) IS: 0.999668088

THE N.C. LAMBERT GRID BEARING AND LOCALIZED HORIZONTAL GROUND DISTANCE FROM "B-5396-2=GPS-2" TO -L- STATION 12+15.00 IS S62°46'56"W 342.22'

ALL LINEAR DIMENSIONS ARE LOCALIZED HORIZONTAL DISTANCES
 VERTICAL DATUM USED IS NAVD 88

NOTE: DRAWING NOT TO SCALE