

UTILITIES BY OTHERS

NOTE:
ALL PROPOSED UTILITY WORK SHOWN
ON THIS SHEET WILL BE DONE BY OTHERS.

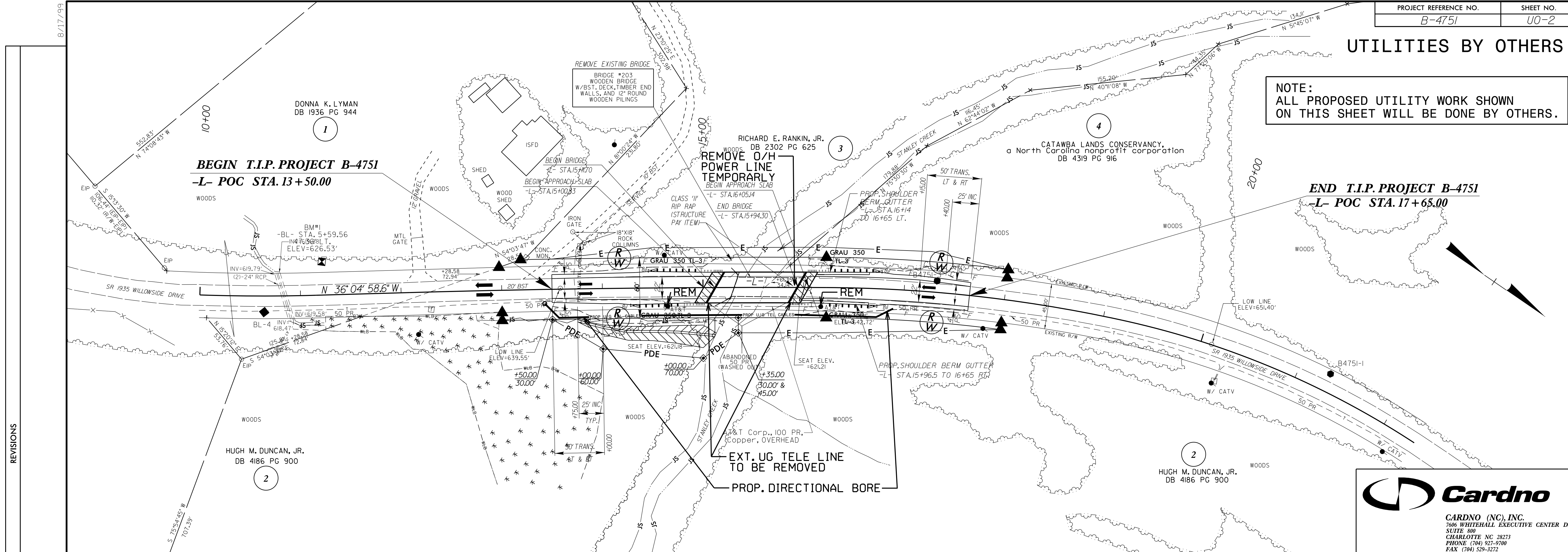

Cardno
CARDNO (NC), INC.
7606 WHITEHALL EXECUTIVE CENTER DR
SUITE 800
CHARLOTTE NC 28273
PHONE (704) 927-9700
FAX (704) 529-3272

-L- SR 1935 WILLOWSIDE DR.

BM#1 ELEV. = 626.53'
-L- STA. 11+22.13
33.12' LEFT
RR SPIKE IN 30" BEECH

PI = 14+30.00
EL = 624.02'
VC = 160'
K = 364
V_d = 75MPH

PI = 17+00.00
EL = 623.17'
VC = 130'
K = 98
V_d = 50MPH

BEGIN GRADE
-L- STA. 13+50.00
ELEV. = 623.92'

END GRADE
-L- STA. 17+65.00
ELEV. = 623.83'

BEGIN BRIDGE
-L- STA. 15+16.00

END BRIDGE
-L- STA. 16+16.00

BRIDGE HYDRAULIC DATA

DESIGN DISCHARGE	= 2000	CFS
DESIGN FREQUENCY	= 25	YRS
DESIGN HW ELEVATION	= 619J	FT
BASE DISCHARGE	= 3559	CFS
BASE FREQUENCY	= 100	YRS
BASE HW ELEVATION	= 621.26	FT
OVERTOPPING DISCHARGE	= 4668	CFS
OVERTOPPING FREQUENCY	= 500+	YRS
OVERTOPPING ELEVATION	= 623.3	FT
	=	FT
DATE OF SURVEY	= 05/28/14	
W.S. ELEVATION AT DATE OF SURVEY	= 610.2	FT

DITCH LEGEND

RIGHT DITCH	-----
-------------	-------

25-N01-2015_05151...@cardno 11-24-15\B-4751-U0-2-ph.dgn

REVISIONS