

**This electronic collection of documents is provided
for the convenience of the user
and is Not a Certified Document –**

**The documents contained herein were originally issued
and sealed by the individuals whose names and license
numbers appear on each page, on the dates appearing
with their signature on that page.**

**This file or an individual page
shall not be considered a certified document.**

5/14/99

STATE OF NORTH CAROLINA DIVISION OF HIGHWAYS

PROJ. REFERENCE NO. R-5605	SHEET NO. X-1A
-------------------------------	-------------------

Quantities are approximate only. The Resident Engineer will recross-section the work accurately when the project is staked out. These cross-section notes will be used in computing the final quantities for which the contractor will be paid.

NOTE: EMBANKMENT COLUMN INCLUDES BACKFILL FOR UNDERCUT

CROSS-SECTION SUMMARY

Station	Uncl. Exc.	Undercut	Embt	Station	Uncl. Exc.	Undercut	Embt	Station	Uncl. Exc.	Undercut	Embt	Station	Uncl. Exc.	Undercut	Embt
-L-	(cu. yd.)	(cu. yd.)	(cu. yd.)	-L-	(cu. yd.)	(cu. yd.)	(cu. yd.)	-L-	(cu. yd.)	(cu. yd.)	(cu. yd.)	-Y2-	(cu. yd.)	(cu. yd.)	(cu. yd.)
10+01.61	0	0	0	31+00.00	44	0	417	51+00.00	0	0	0	14+00.00	0	0	0
10+50.00	14	0	240	31+50.00	55	0	512	51+50.00	135	0	510	14+50.00	271	0	78
11+00.00	21	0	276	32+00.00	122	0	534	51+72.36	0	0	226	15+00.00	136	0	44
11+50.00	59	0	210	32+50.00	102	0	972					15+50.00	120	0	28
12+00.00	295	0	60	33+00.00	76	0	1357	Station	Uncl. Exc.	Undercut	Embt	16+00.00	88	0	21
12+50.00	731	0	0	33+50.00	90	0	1319	-Y1-	(cu. yd.)	(cu. yd.)	(cu. yd.)	16+16.57	27	0	7
13+00.00	648	386	416	34+00.00	104	0	1360	10+00.00	0	0	0	Station	Uncl. Exc.	Undercut	Embt
13+50.00	384	386	421	34+50.00	125	0	1374	10+50.00	0	0	0	-Y3-	(cu. yd.)	(cu. yd.)	(cu. yd.)
14+00.00	369	386	398	35+00.00	185	0	1322	11+00.00	0	0	0	11+16.77	0	0	0
14+50.00	205	386	463	35+50.00	239	0	1305	11+50.00	0	0	0	11+50.00	0	0	0
15+00.00	181	386	491	36+00.00	257	0	668	12+00.00	0	0	0	12+00.00	15	0	30
15+50.00	192	0	80	36+13.00	70	0	3	12+50.00	21	0	3	12+50.00	19	0	118
16+00.00	66	0	388					13+00.00	83	0	12	13+00.00	16	0	152
16+50.00	39	0	623	37+33.00	0	0	0	13+50.00	490	0	9	13+50.00	12	0	130
17+00.00	190	0	561	37+50.00	8	0	0	14+00.00	455	0	0	14+00.00	11	0	128
17+50.00	365	0	656	38+00.00	11	0	192	14+50.00	52	0	0	14+50.00	13	0	163
18+00.00	325	0	390	38+50.00	320	0	192	15+00.00	37	0	0	15+00.00	0	0	80
18+50.00	178	0	85	39+00.00	787	0	0	15+50.00	41	0	0	15+50.00	0	0	80
19+00.00	80	0	152	39+50.00	988	0	0	16+00.00	45	0	0	16+00.00	39	0	349
19+50.00	58	0	110	40+00.00	1035	0	0	16+50.00	43	0	0	16+50.00	12	0	31
20+00.00	127	0	38	40+50.00	1063	0	0	17+00.00	54	0	0	17+00.00	12	0	41
20+50.00	209	0	12	41+00.00	937	0	0	17+50.00	50	0	0	17+50.00	10	0	23
21+00.00	203	386	405	41+50.00	388	0	225	18+00.00	31	0	0	17+75.00	6	0	14
21+50.00	177	386	408	42+00.00	0	0	1172	18+50.00	31	0	2				
22+00.00	204	386	394	42+50.00	0	0	1385	19+00.00	26	0	3	Station	Uncl. Exc.	Undercut	Embt
22+50.00	212	386	392	43+00.00	25	0	556	19+50.00	27	0	3	-RND ABT-	(cu. yd.)	(cu. yd.)	(cu. yd.)
23+00.00	242	386	390	43+50.00	92	0	187	20+00.00	26	0	2	-L- & -Y2-	711	0	375
23+17.00	93	0	0	44+00.00	152	0	155	20+50.00	22	0	3				
				44+50.00	219	0	163	21+00.00	19	0	3				
24+83.00	0	0	0	45+00.00	192	0	197	21+50.00	16	0	4				
25+00.00	64	0	3	45+50.00	108	0	230	22+00.00	10	0	5				
25+50.00	129	0	37	46+00.00	155	0	201	22+29.73	2	0	2				
26+00.00	90	0	58	46+50.00	284	0	166								
26+50.00	142	0	248	47+00.00	415	0	151	Station	Uncl. Exc.	Undercut	Embt				
27+00.00	119	0	704	47+50.00	491	0	123	-Y2-	(cu. yd.)	(cu. yd.)	(cu. yd.)				
27+50.00	57	0	981	48+00.00	454	0	80	10+50.00	0	0	0				
28+00.00	39	0	968	48+50.00	443	0	37	11+00.00	111	0	21				
28+50.00	33	0	815	49+00.00	281	0	464	11+50.00	146	0	26				
29+00.00	47	0	557	49+50.00	38	0	1589	12+00.00	197	0	30				
29+50.00	65	0	346	50+00.00	0	0	2456	12+50.00	291	0	43				
30+00.00	75	0	261	50+36.00	0	0	1910								
30+50.00	82	0	301												

I:\DEC-2015-07-27\2014-Roadway\XSC\R5605-Rdwy-xpl-Sheet1A.dgn
 \$\$\$\$SHEET NUMBER\$\$\$\$

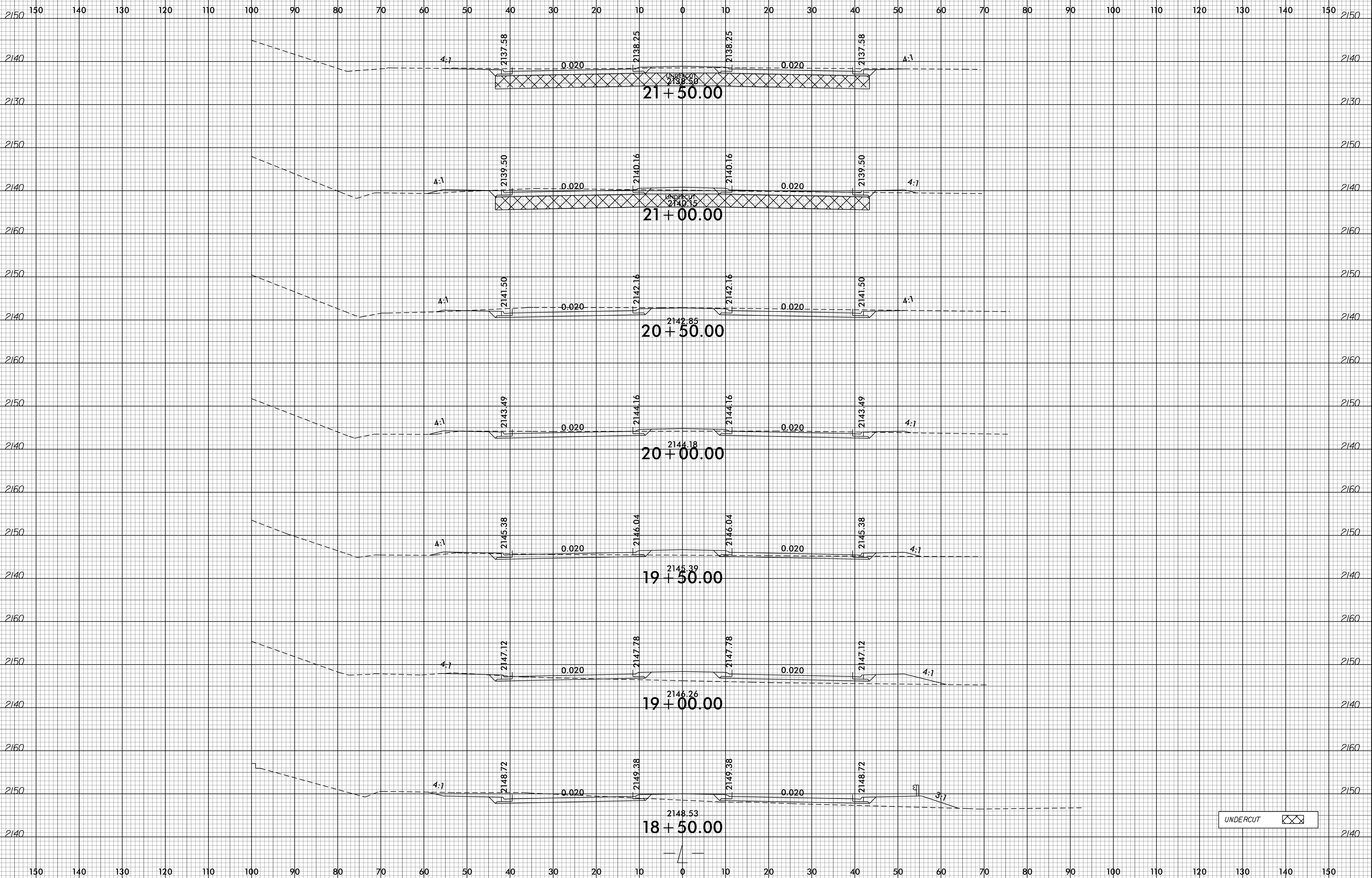
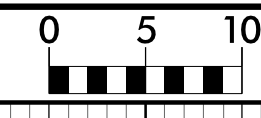

UNDERCUT

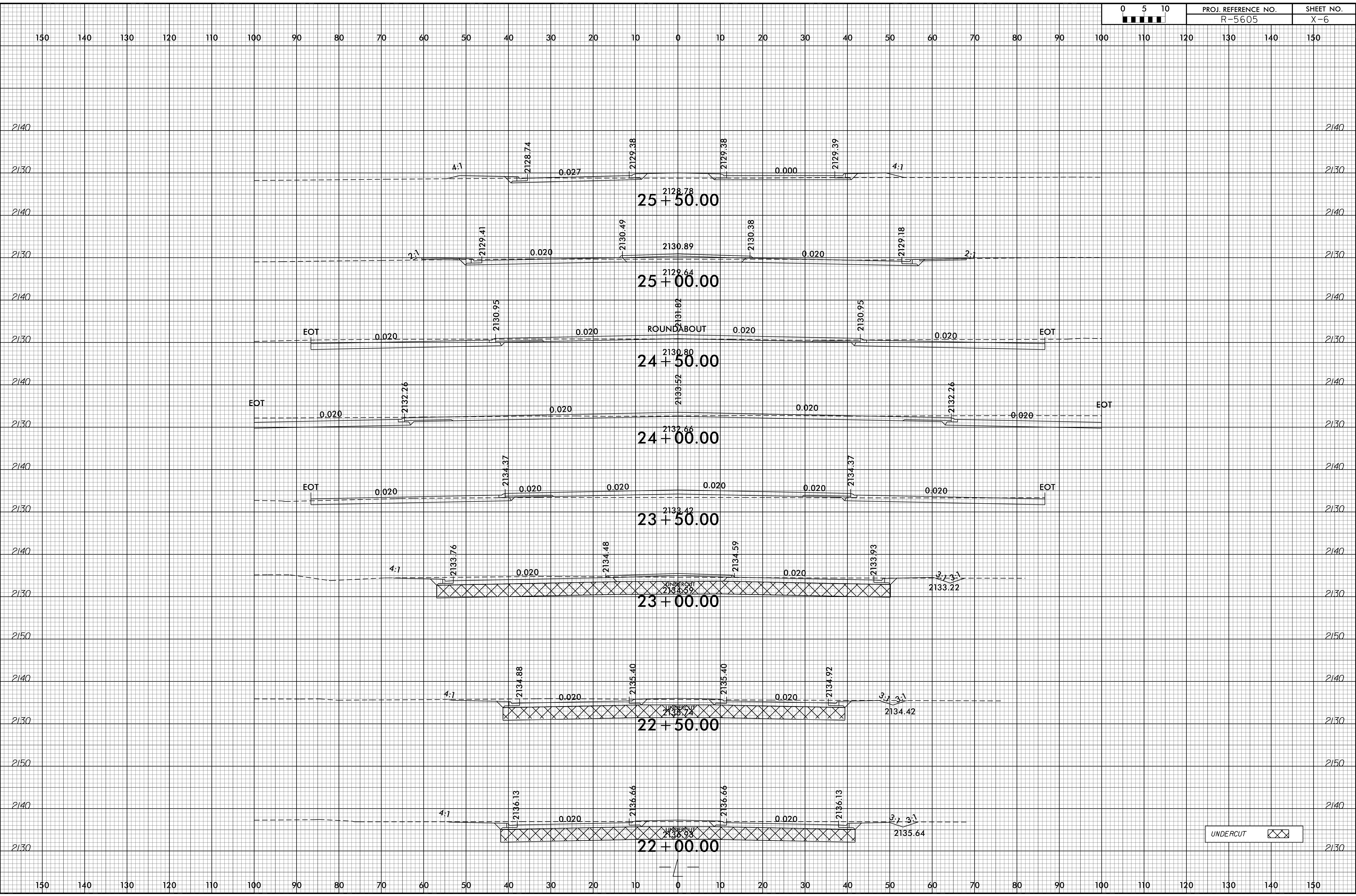
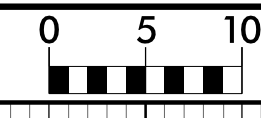

UNDERCUT

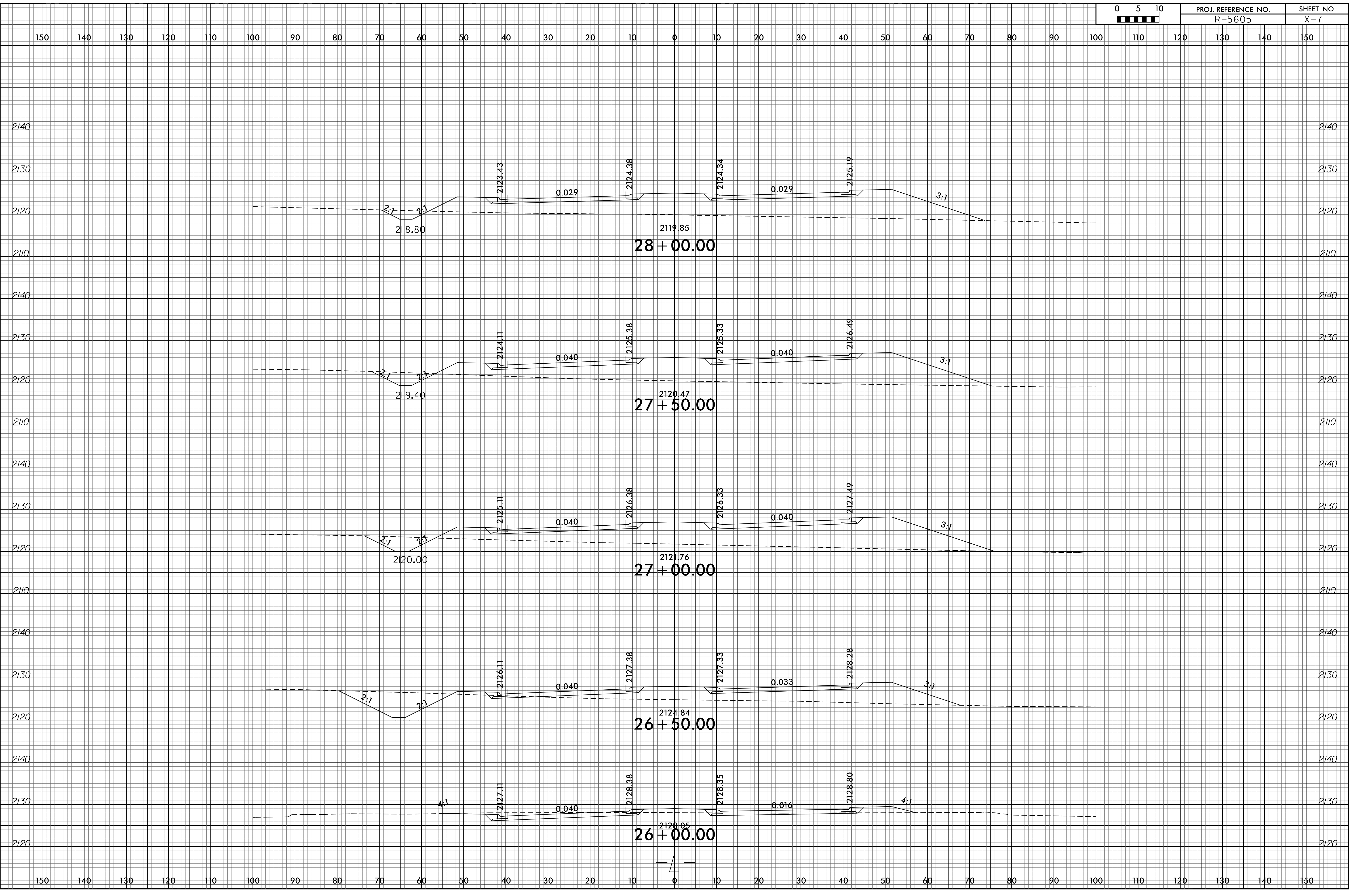
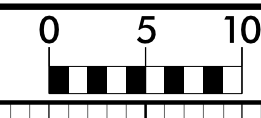

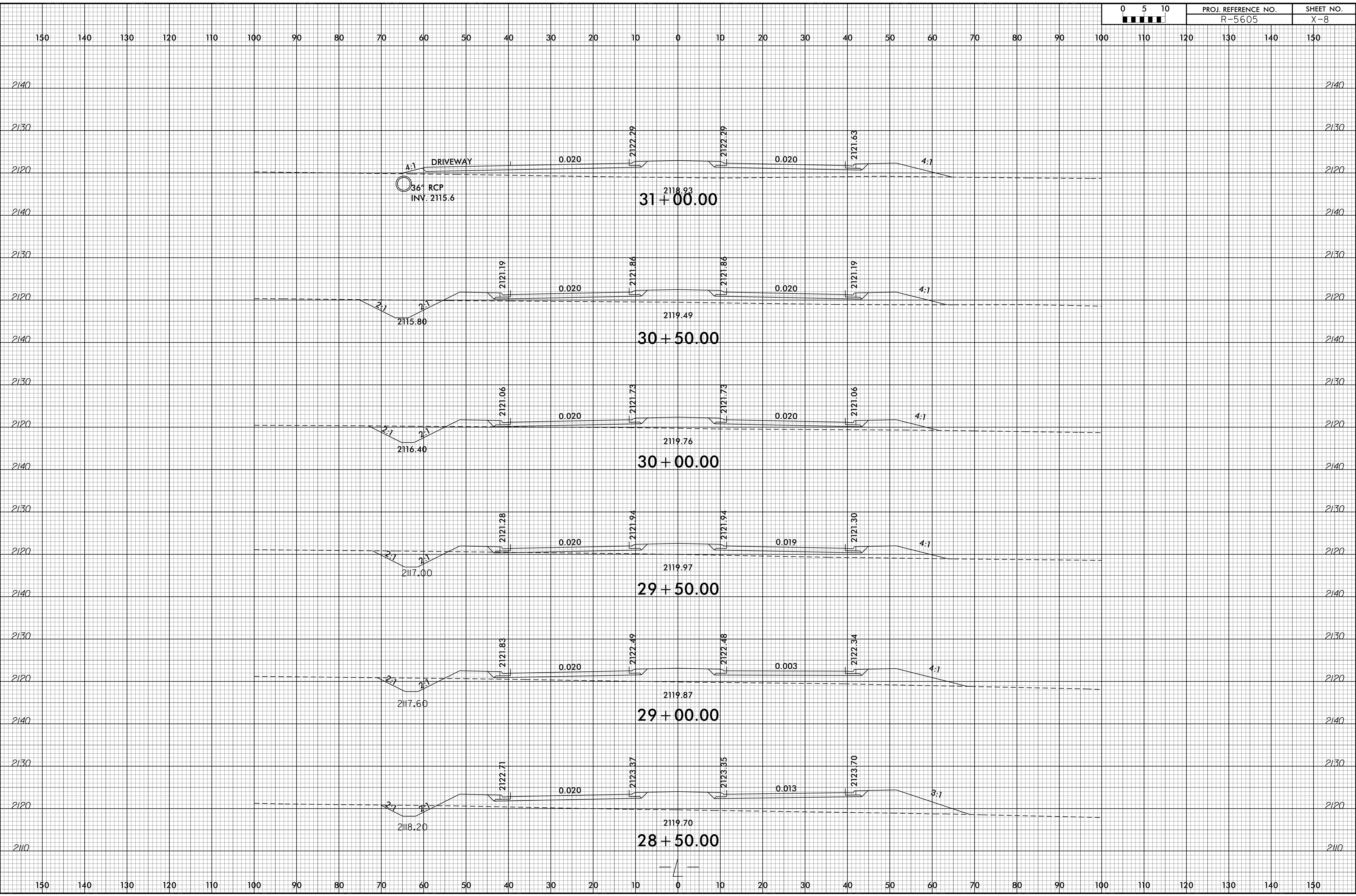
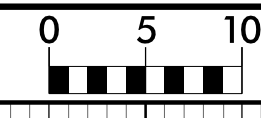

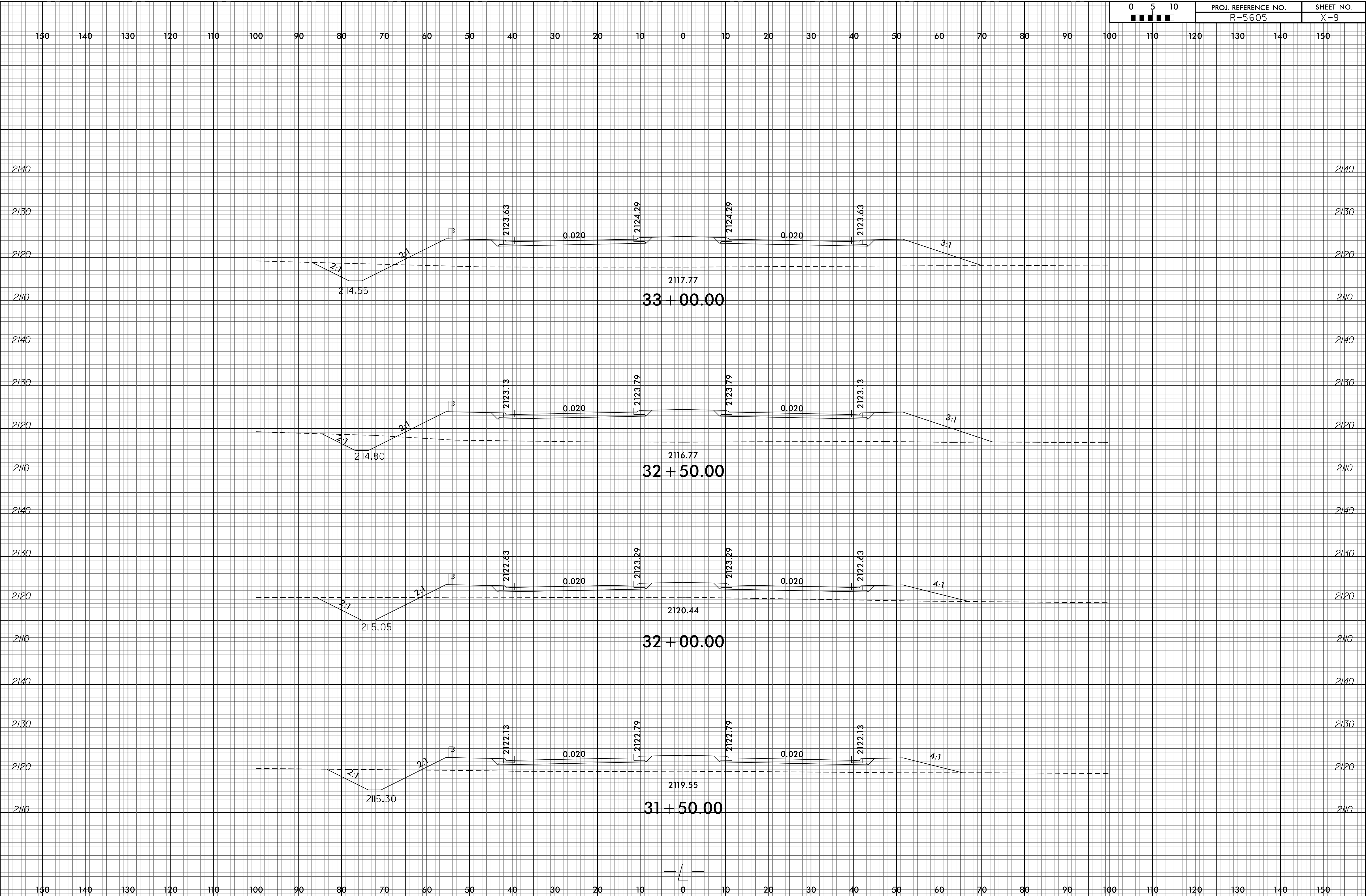
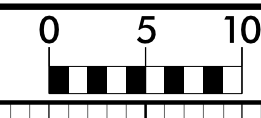

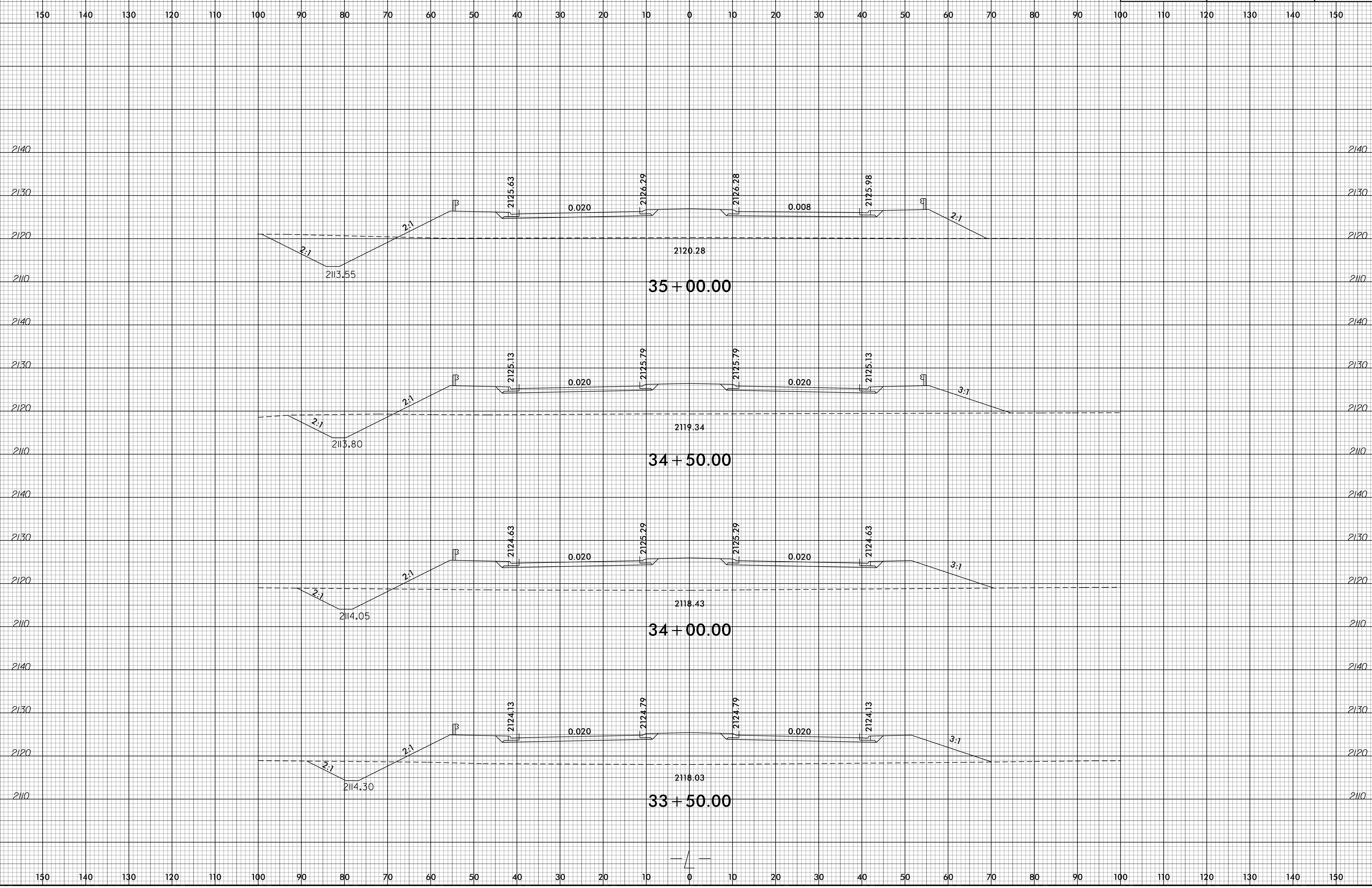

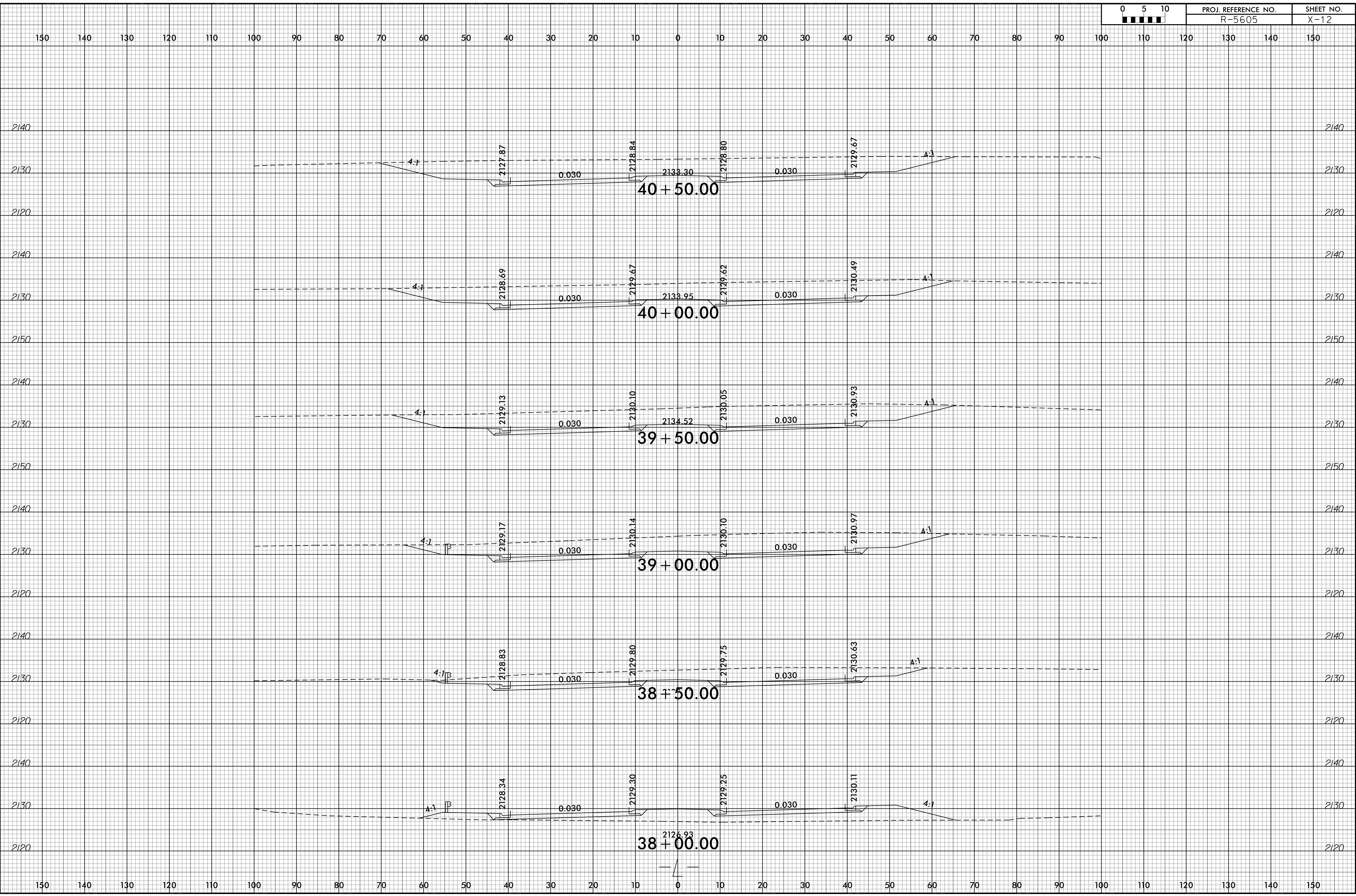

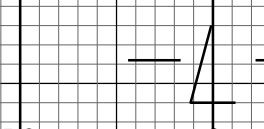
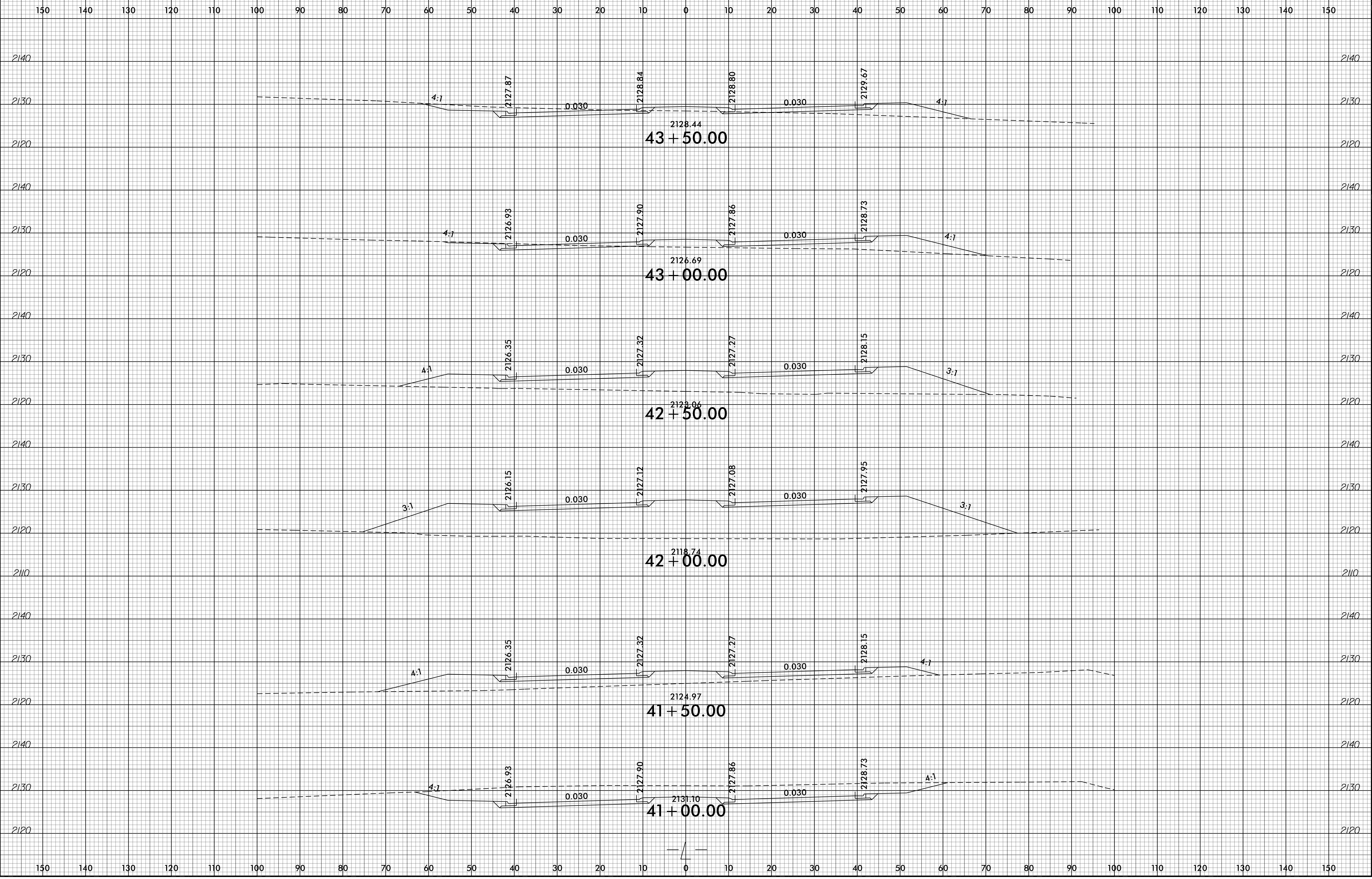
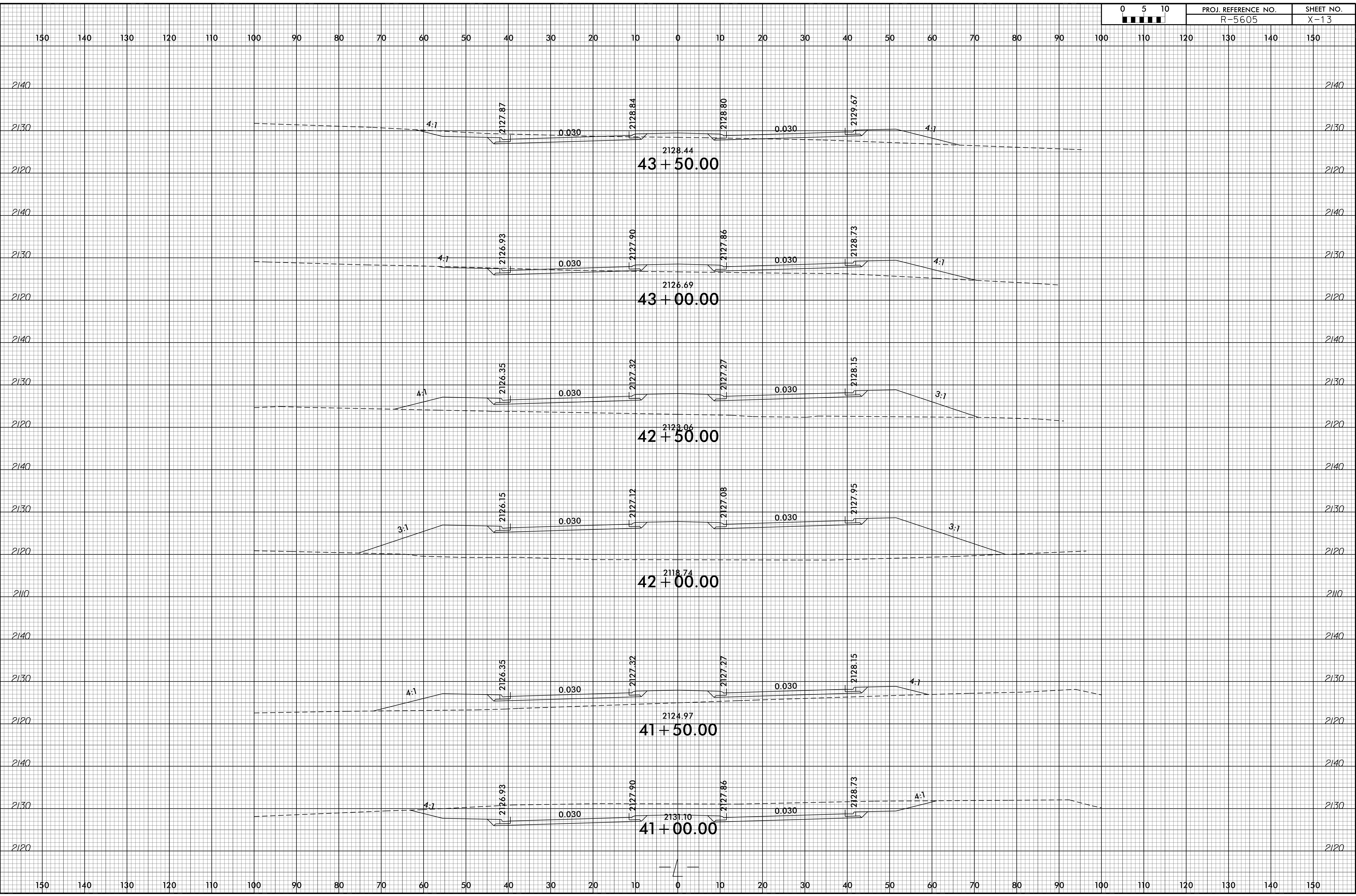
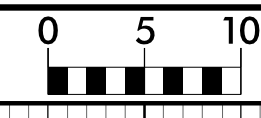

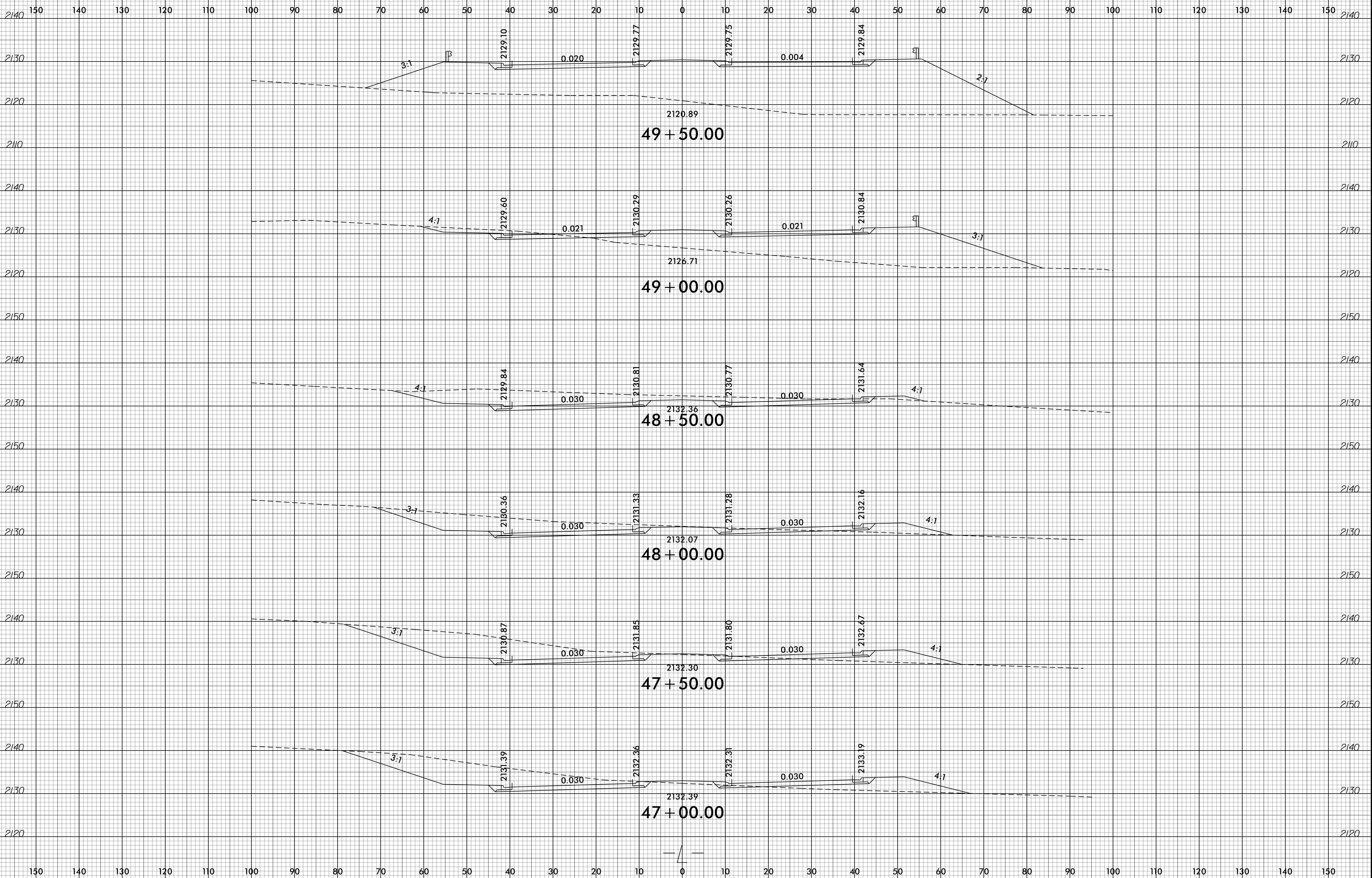

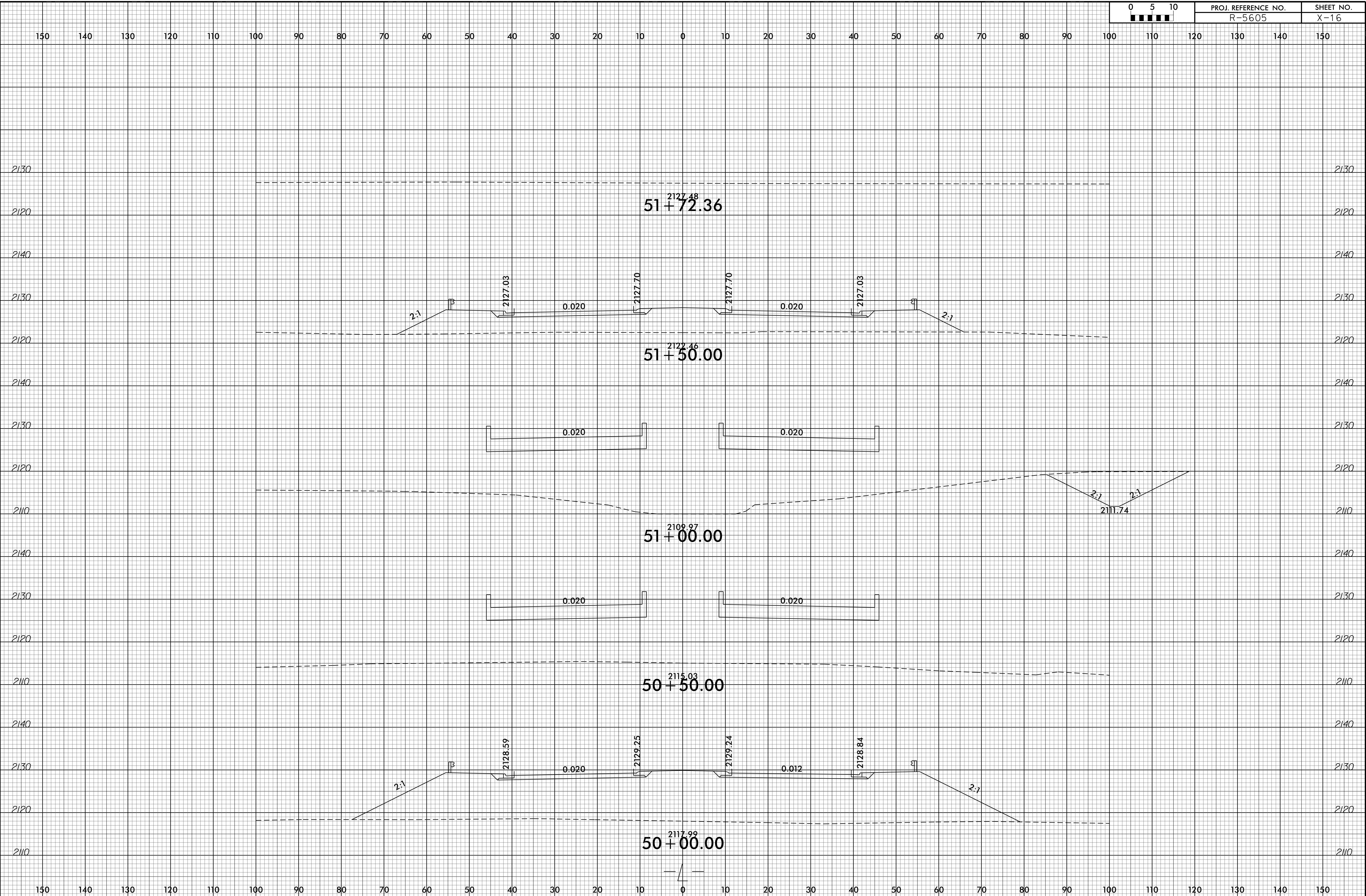
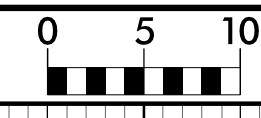

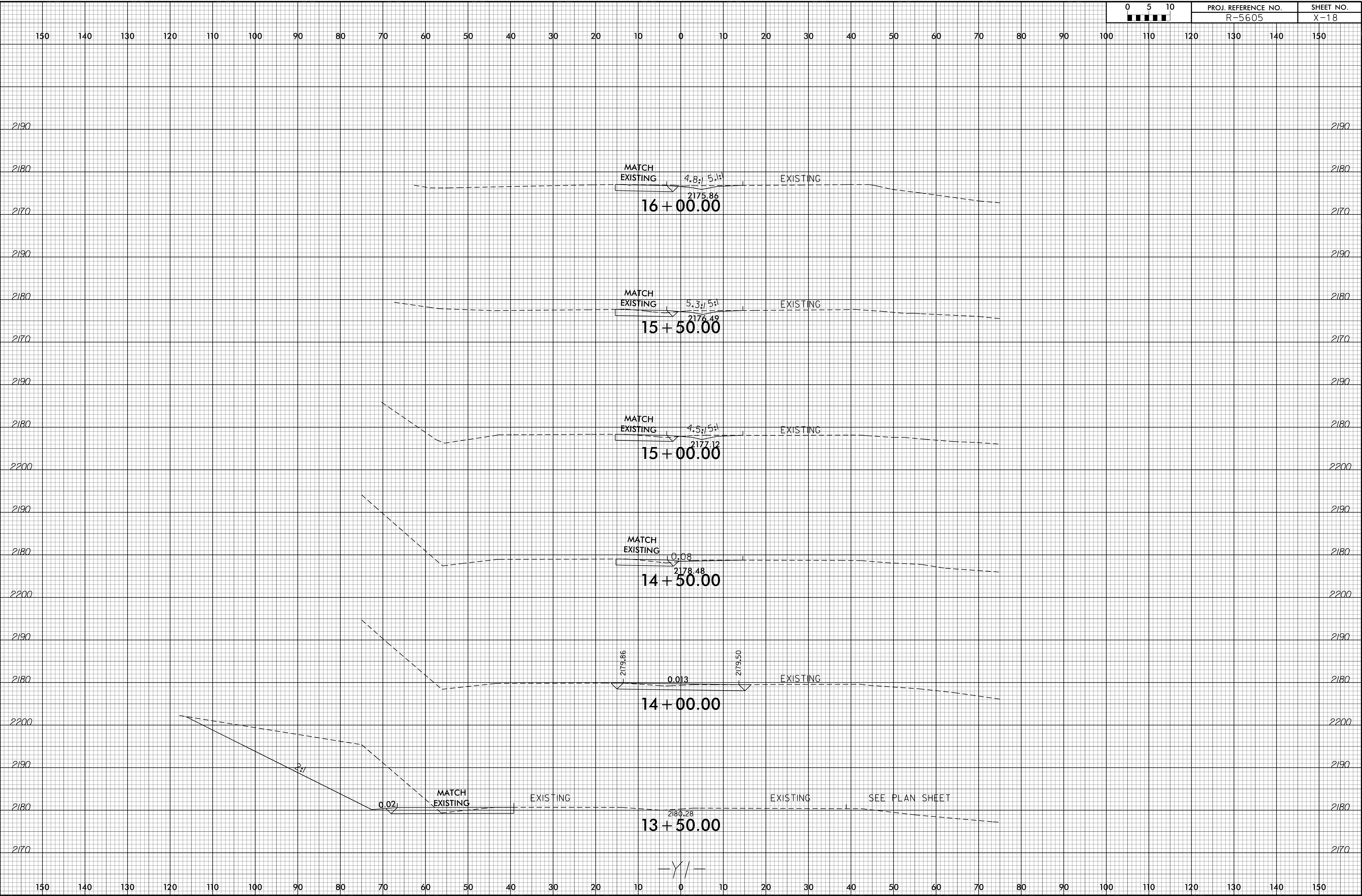

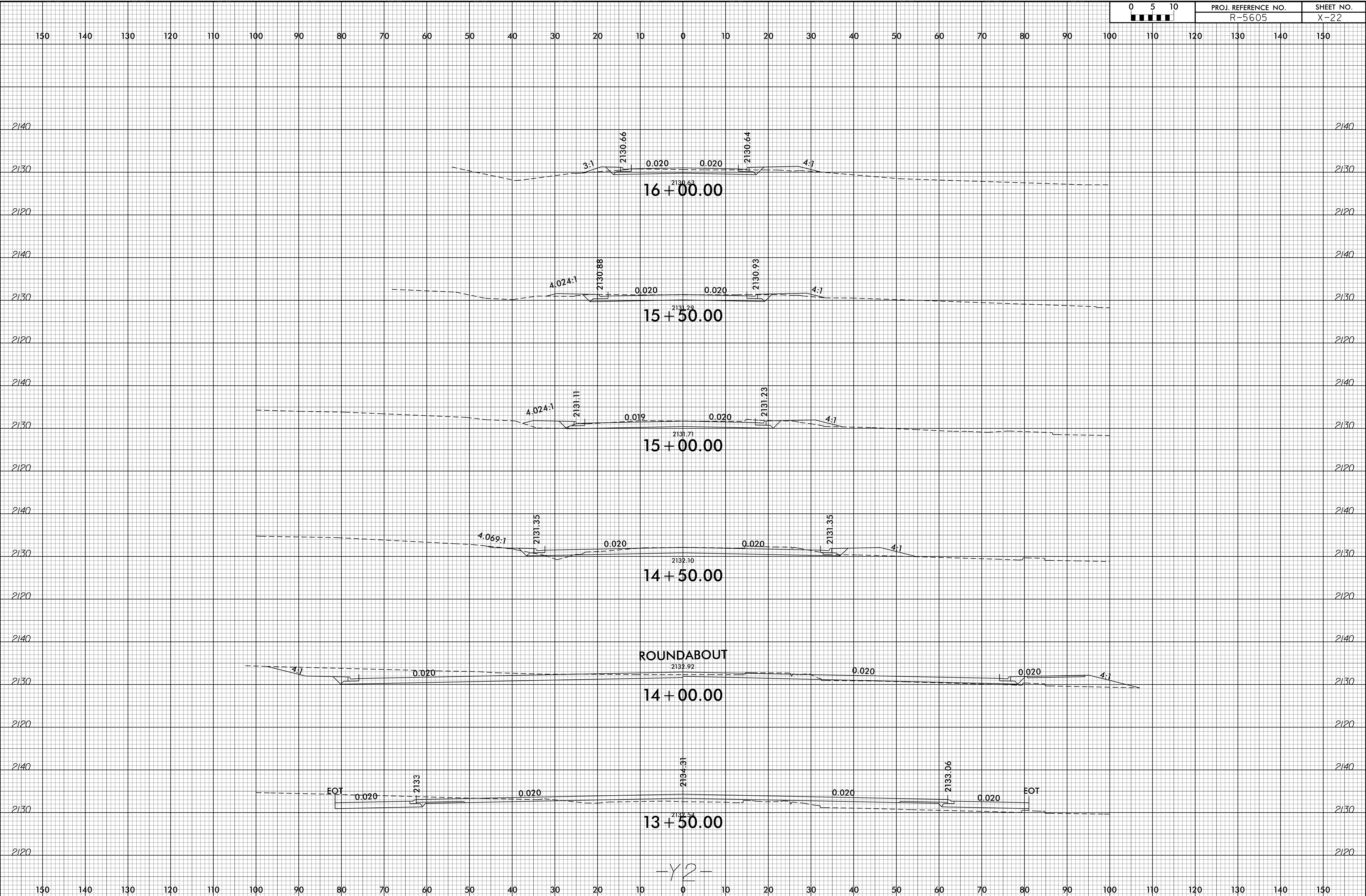

-Y2-

