

LOAD FACTORS:

DESIGN LOAD RATING FACTORS	LIMIT STATE	γ_{DC}	γ_{DW}
	STRENGTH I	1.25	1.50
	SERVICE III	1.00	1.00

LOAD AND RESISTANCE FACTOR RATING (LRFR) SUMMARY FOR PRESTRESSED CONCRETE GIRDERS																								
LEVEL	VEHICLE	WEIGHT (W) (TONS)	CONTROLLING LOAD RATING #	MINIMUM RATING FACTORS (RF)	TONS = W x RF	STRENGTH I LIMIT STATE										SERVICE III LIMIT STATE						COMMENT NUMBER		
						LIVE-LOAD FACTORS (γ_{LL})	MOMENT					SHEAR					LIVE-LOAD FACTORS (γ_{LL})	MOMENT						
							DISTRIBUTION FACTORS (DF)	RATING FACTOR	SPAN	GIRDER LOCATION	DISTANCE FROM LEFT END OF SPAN (FF)	DISTRIBUTION FACTORS (DF)	RATING FACTOR	SPAN	GIRDER LOCATION	DISTANCE FROM LEFT END OF SPAN (FF)		DISTRIBUTION FACTORS (DF)	RATING FACTOR	SPAN	GIRDER LOCATION		DISTANCE FROM LEFT END OF SPAN (FF)	
DESIGN LOAD RATING	HL-93 (INVENTORY)	N/A	①	1.40	--	1.75	0.805	1.82	78.7'	ES	39.3	0.838	1.40	78.7'	I	11.2	0.80	0.805	1.69	78.7'	ES	39.3		
	HL-93 (OPERATING)	N/A		1.87	--	1.35	0.805	2.36	78.7'	ES	39.3	0.838	1.87	78.7'	I	11.2	N/A	--	--	--	--	--		
	HS-20 (INVENTORY)	36.000	②	1.80	64.800	1.75	0.805	2.42	78.7'	ES	39.3	0.838	1.82	78.7'	I	11.2	0.80	0.805	1.80	78.7'	ES	39.3		
	HS-20 (OPERATING)	36.000		2.36	85.061	1.35	0.805	3.14	78.7'	ES	39.3	0.838	2.36	78.7'	I	11.2	N/A	--	--	--	--	--		
LEGAL LOAD RATING	SINGLE VEHICLE (SV)	SN5H	13.500		5.15	69.525	1.40	0.805	6.93	78.7'	ES	39.3	0.838	5.44	78.7'	I	11.2	0.80	0.805	5.15	78.7'	ES	39.3	
		SNGARBS2	20.000		3.80	76.000	1.40	0.805	5.12	78.7'	ES	39.3	0.838	3.86	78.7'	I	11.2	0.80	0.805	3.80	78.7'	ES	39.3	
		SNAGRIS2	22.000		3.58	78.839	1.40	0.805	4.83	78.7'	ES	39.3	0.838	3.58	78.7'	I	11.2	0.80	0.805	3.59	78.7'	ES	39.3	
		SNCOTTS3	27.250		2.56	69.828	1.40	0.805	3.45	78.7'	ES	39.3	0.838	2.71	78.7'	I	11.2	0.80	0.805	2.56	78.7'	ES	39.3	
		SNAGGRS4	34.925		2.13	74.216	1.40	0.805	2.87	78.7'	ES	39.3	0.838	2.25	78.7'	I	11.2	0.80	0.805	2.13	78.7'	ES	39.3	
		SNS5A	35.550		2.08	73.766	1.40	0.805	2.81	78.7'	ES	39.3	0.838	2.28	78.7'	I	11.2	0.80	0.805	2.08	78.7'	ES	39.3	
		SNS6A	39.950		1.90	75.905	1.40	0.805	2.57	78.7'	ES	39.3	0.838	2.07	78.7'	I	11.2	0.80	0.805	1.90	78.7'	ES	39.3	
	SNS7B	42.000		1.81	76.125	1.40	0.805	2.44	78.7'	ES	39.3	0.838	2.03	78.7'	I	11.2	0.80	0.805	1.81	78.7'	ES	39.3		
	TRUCK TRACTOR SEMI-TRAILER (TTST)	TNAGRIT3	33.000		2.33	76.725	1.40	0.805	3.13	78.7'	ES	39.3	0.838	2.47	78.7'	I	11.2	0.80	0.805	2.33	78.7'	ES	39.3	
		TNT4A	33.075		2.33	76.899	1.40	0.805	3.14	78.7'	ES	39.3	0.838	2.40	78.7'	I	11.2	0.80	0.805	2.33	78.7'	ES	39.3	
		TNT6A	41.600		1.90	79.040	1.40	0.805	2.56	78.7'	ES	39.3	0.838	2.16	78.7'	I	11.2	0.80	0.805	1.90	78.7'	ES	39.3	
		TNT7A	42.000		1.90	79.800	1.40	0.805	2.57	78.7'	ES	39.3	0.838	2.12	78.7'	I	11.2	0.80	0.805	1.90	78.7'	ES	39.3	
		TNT7B	42.000		1.96	82.425	1.40	0.805	2.64	78.7'	ES	39.3	0.838	1.99	78.7'	I	11.2	0.80	0.805	1.96	78.7'	ES	39.3	
		TNAGRIT4	43.000		1.88	80.625	1.40	0.805	2.53	78.7'	ES	39.3	0.838	1.93	78.7'	I	11.2	0.80	0.805	1.88	78.7'	ES	39.3	
TNAGT5A		45.000		1.78	79.875	1.40	0.805	2.38	78.7'	ES	39.3	0.838	1.91	78.7'	I	11.2	0.80	0.805	1.78	78.7'	ES	39.3		
TNAGT5B	45.000	③	1.75	78.750	1.40	0.805	2.36	78.7'	ES	39.3	0.838	1.83	78.7'	I	11.2	0.80	0.805	1.75	78.7'	ES	39.3			

NOTES:

MINIMUM RATING FACTORS ARE BASED ON THE STRENGTH I AND SERVICE III LIMIT STATES.

ALLOWABLE STRESSES FOR SERVICE III LIMIT STATE ARE AS REQUIRED FOR DESIGN.

⊕	CONTROLLING LOAD RATING
①	DESIGN LOAD RATING (HL-93)
②	DESIGN LOAD RATING (HS-20)
③	LEGAL LOAD RATING **
** SEE CHART FOR VEHICLE TYPE	
GIRDER LOCATION	
I	INTERIOR GIRDER
EL	EXTERIOR LEFT GIRDER
ER	EXTERIOR RIGHT GIRDER
ES	EXTERIOR UNDER SIDEWALK GIRDER

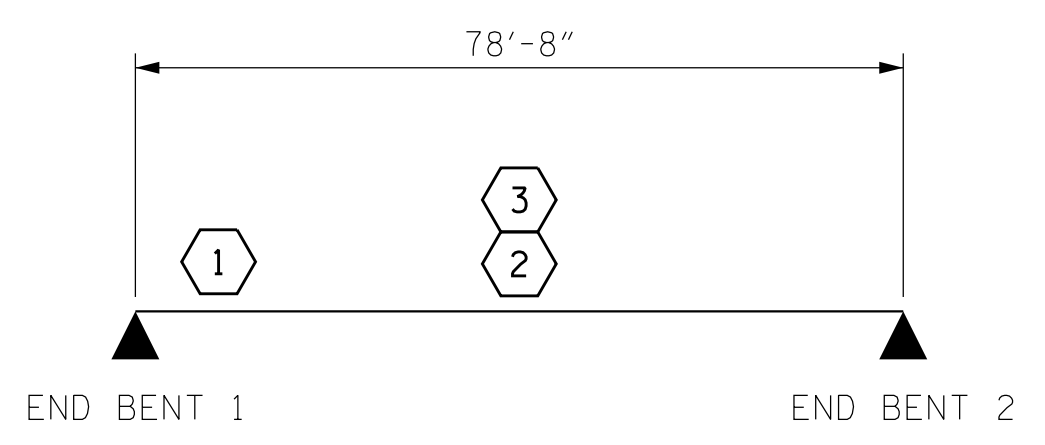

LRFR SUMMARY

PROJECT NO. R-5605
TRANSYLVANIA COUNTY
 STATION: 50+83.00 -L-

SHEET 4 OF 4

STATE OF NORTH CAROLINA
 DEPARTMENT OF TRANSPORTATION
 RALEIGH
 STANDARD
 LRFR SUMMARY FOR
 PRESTRESSED
 CONCRETE GIRDERS
 (NON-INTERSTATE TRAFFIC)

ASSEMBLED BY :	PFC	DATE :	8/15
CHECKED BY :	CMT	DATE :	8/15
DRAWN BY :	MAA	1/08	REV. 11/2/08RR
CHECKED BY :	GM/DI	2/08	REV. 10/1/11

Prepared in the Office of:

Mattern & Craig
 CONSULTING ENGINEERS & SURVEYORS
 FIRM LICENSE NO. G-1154
 12 BROAD STREET
 ASHEVILLE, NORTH CAROLINA 28801
 (828) 254-2201 • FAX (828) 254-4582

DocuSigned by:
Steven A. Campbell 12/21/2015

REVISIONS						SHEET NO.
NO.	BY:	DATE:	NO.	BY:	DATE:	S-29
1			3			TOTAL SHEETS
2			4			51

*****SYSTEM TIME*****
 *****DCN*****
 *****USERNAME*****

STD. NO. LRFR1