

# SURVEY CONTROL SHEET B-5173

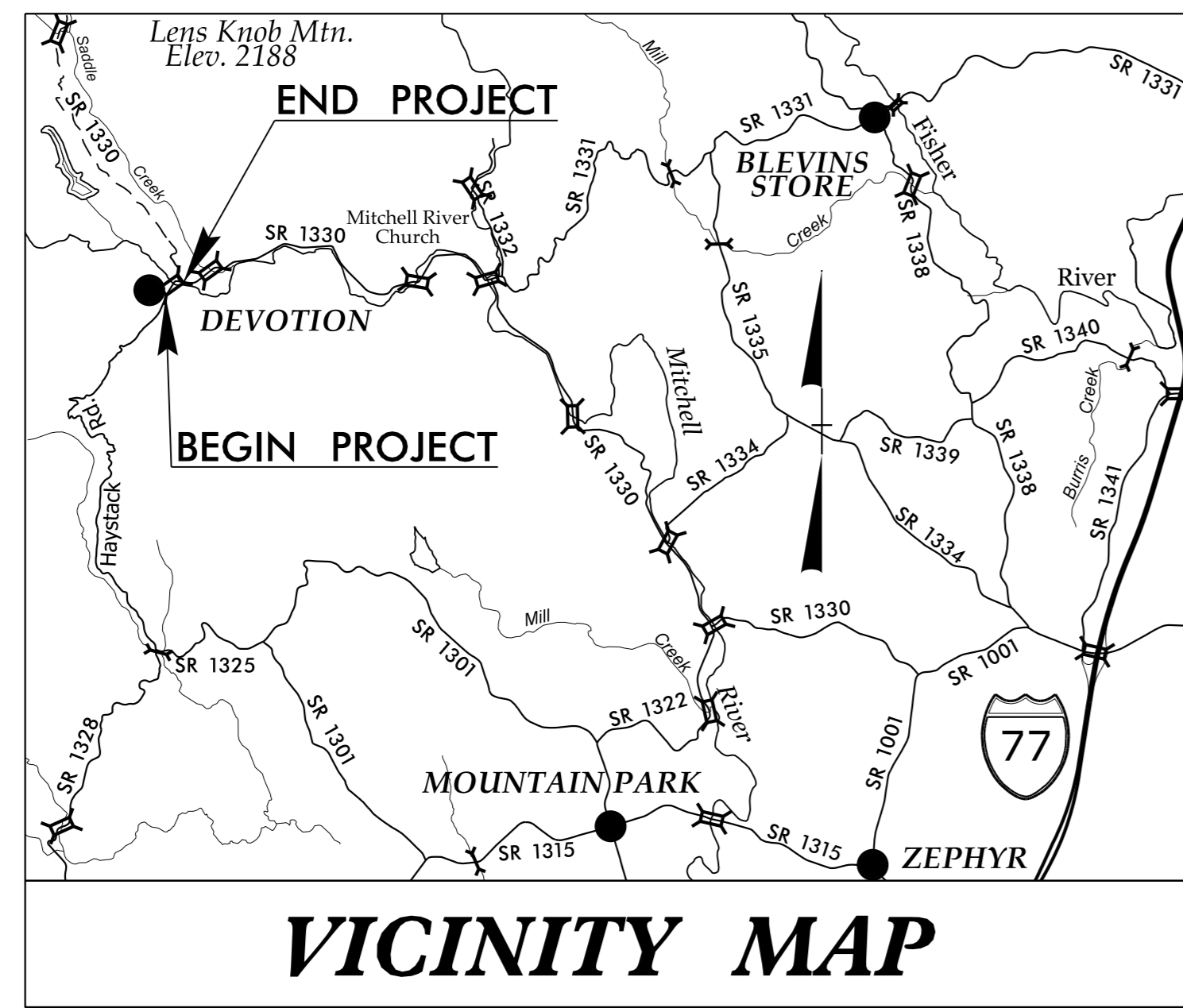

BL POINT	DESC.	NORTH	EAST	ELEVATION	L STATION	OFFSET
BL4	(BL-4)	981747.0533	1435840.7144	1363.38		OUTSIDE PROJECT LIMITS
BL5	(BL-5)	982442.5894	1436220.7860	1355.34	17+83.59	61.83 LT
BL6	(BL-6)	982407.7715	1436692.1013	1352.19		OUTSIDE PROJECT LIMITS

.....  
 BM\*1 ELEVATION = 1355.13'  
 N 982359. E 1436167.  
 L STATION 16+85.00 50' LEFT  
 DISK IN HEADWALL 145 HLZ 1969  
 .....

**NOTES:**

1. THE CONTROL DATA FOR THIS PROJECT CAN BE FOUND ELECTRONICALLY BY SELECTING PROJECT CONTROL DATA AT:  
[HTTP://WWW.NCDOT.ORG/DOH/PRECONSTRUCTHIGHWAYLOCATIONPROJECT/](http://www.ncdot.org/doh/preconstructhighwaylocationproject/)

THE FILES TO BE FOUND ARE AS FOLLOWS:  
 B5173\_LS\_CONTROL.TXT

SITE CALIBRATION INFORMATION HAS NOT BEEN PROVIDED FOR THIS PROJECT. IF FURTHER INFORMATION IS NEEDED, PLEASE CONTACT THE LOCATION AND SURVEYS UNIT.

© INDICATES GEODETIC CONTROL MONUMENTS USED OR SET FOR HORIZONTAL PROJECT CONTROL BY THE NCDOT LOCATION AND SURVEYS UNIT.  
 PROJECT CONTROL ESTABLISHED USING GLOBAL POSITIONING SYSTEM.  
 NETWORK ESTABLISHED FROM NGS ONLINE POSITIONING SERVICE (OPUS)  
 SEE GPS CALIBRATION SHEET FOR HORIZONTAL AND VERTICAL COORDINATE VALUES.

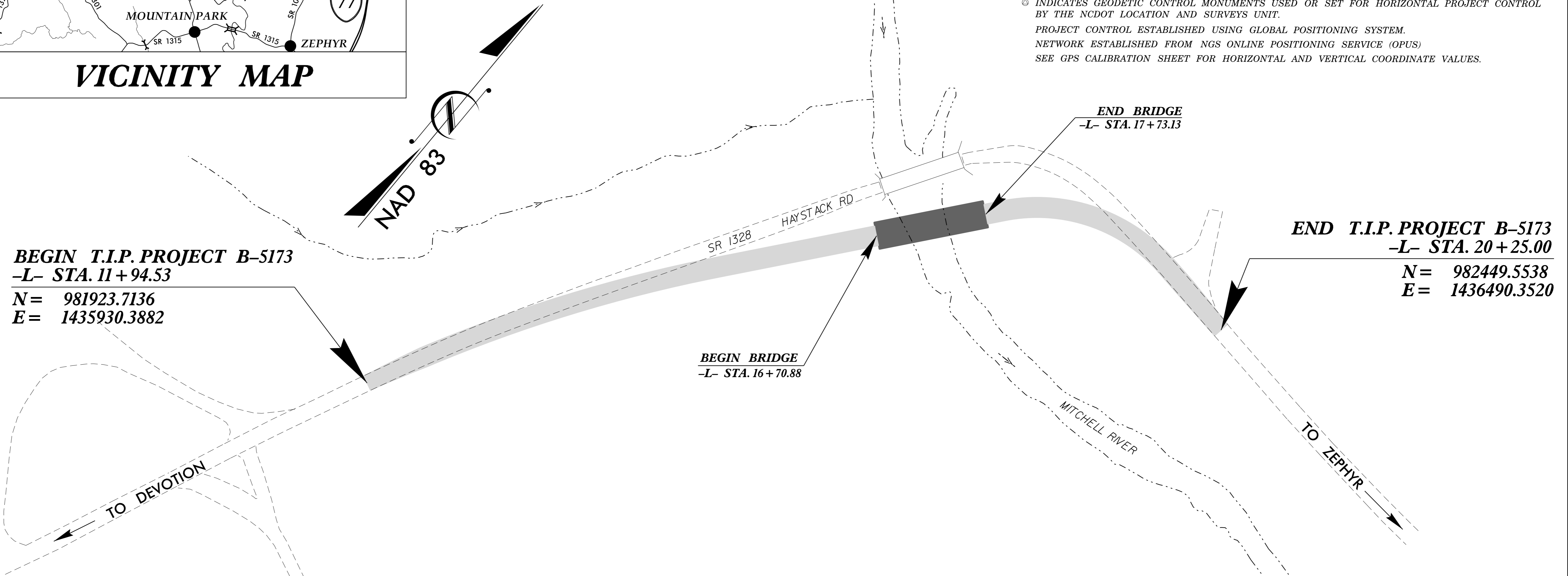

**BEGIN T.I.P. PROJECT B-5173**  
 -L- STA. 11+94.53  
 N = 981923.7136  
 E = 1435930.3882

**BEGIN BRIDGE**  
 -L- STA. 16+70.88

**END BRIDGE**  
 -L- STA. 17+73.13

**END T.I.P. PROJECT B-5173**  
 -L- STA. 20+25.00  
 N = 982449.5538  
 E = 1436490.3520

**DATUM DESCRIPTION**

THE LOCALIZED COORDINATE SYSTEM DEVELOPED FOR THIS PROJECT IS BASED ON THE STATE PLANE COORDINATES ESTABLISHED BY NCDOT FOR MONUMENT "B3911-2"

WITH NAD 83 STATE PLANE GRID COORDINATES OF  
 NORTHING: 983048.524(±) EASTING: 1437903.644(±)  
 ELEVATION: 1331.092 (±)

THE AVERAGE COMBINED GRID FACTOR USED ON THIS PROJECT (GROUND TO GRID) IS: 0.99997301

THE N.C. LAMBERT GRID BEARING AND LOCALIZED HORIZONTAL GROUND DISTANCE FROM "B3911-2" TO -L- STATION 11+94.53 IS  
 S 60°18'56" W 2271.33'

ALL LINEAR DIMENSIONS ARE LOCALIZED HORIZONTAL DISTANCES  
 VERTICAL DATUM USED IS NAVD88

**NC DOT GPS STATION B3911-1**  
**LOCALIZED PROJECT COORDINATES**  
 N = 982398.7585  
 E = 1437063.7887

**NC DOT GPS STATION B3911-2**  
**LOCALIZED PROJECT COORDINATES**  
 N = 983048.5240  
 E = 1437903.6440

NOTE: DRAWING NOT TO SCALE

6/2/99  
 24 NOV 2015 15:34  
 RA: P:\Road\RAMF\B5173.LS.LC.dgn  
 B5173.LS.LC.dgn