

POSITION OF PILE DURING WELDING.

PILE SPlice DETAILS

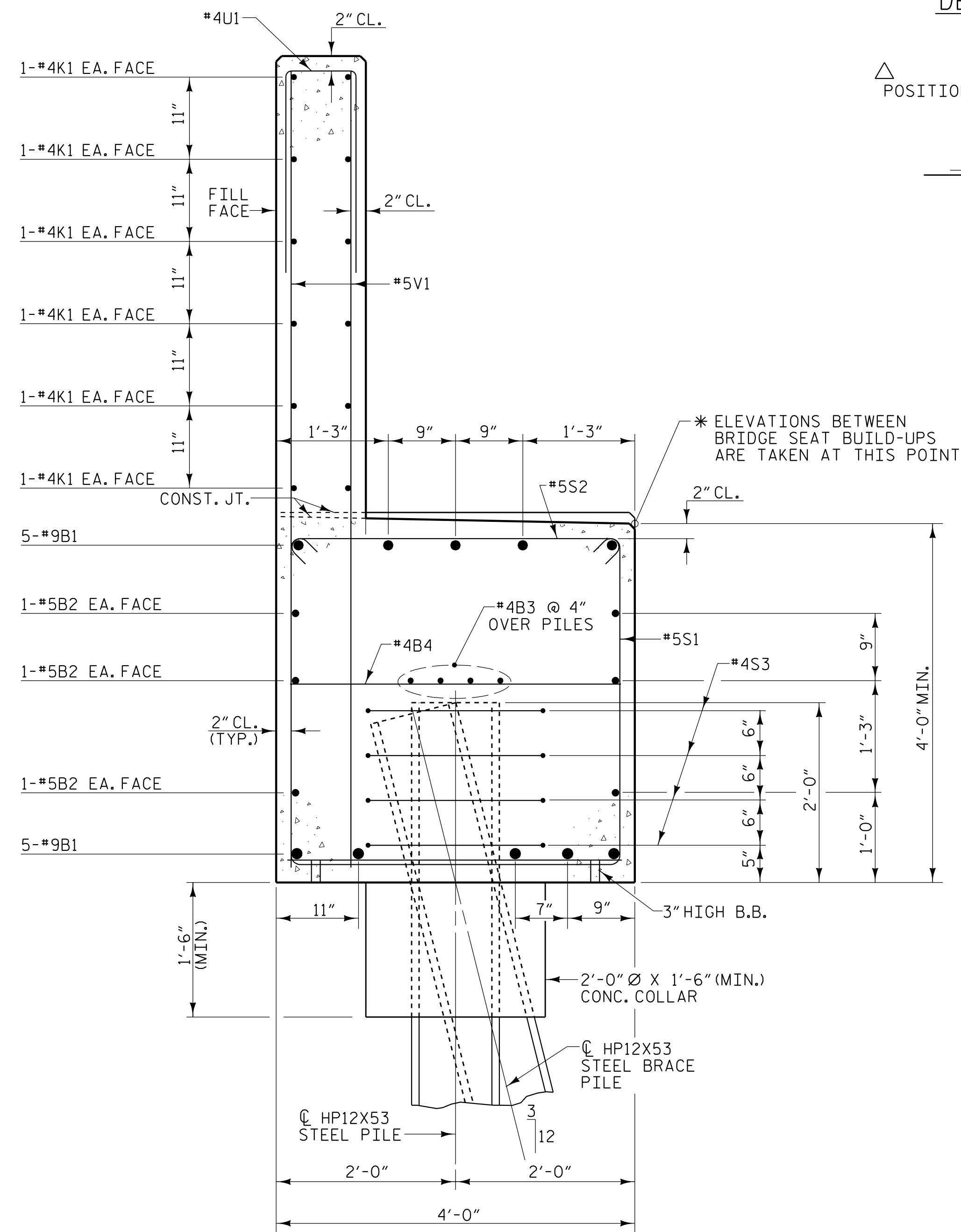

SECTION A-A

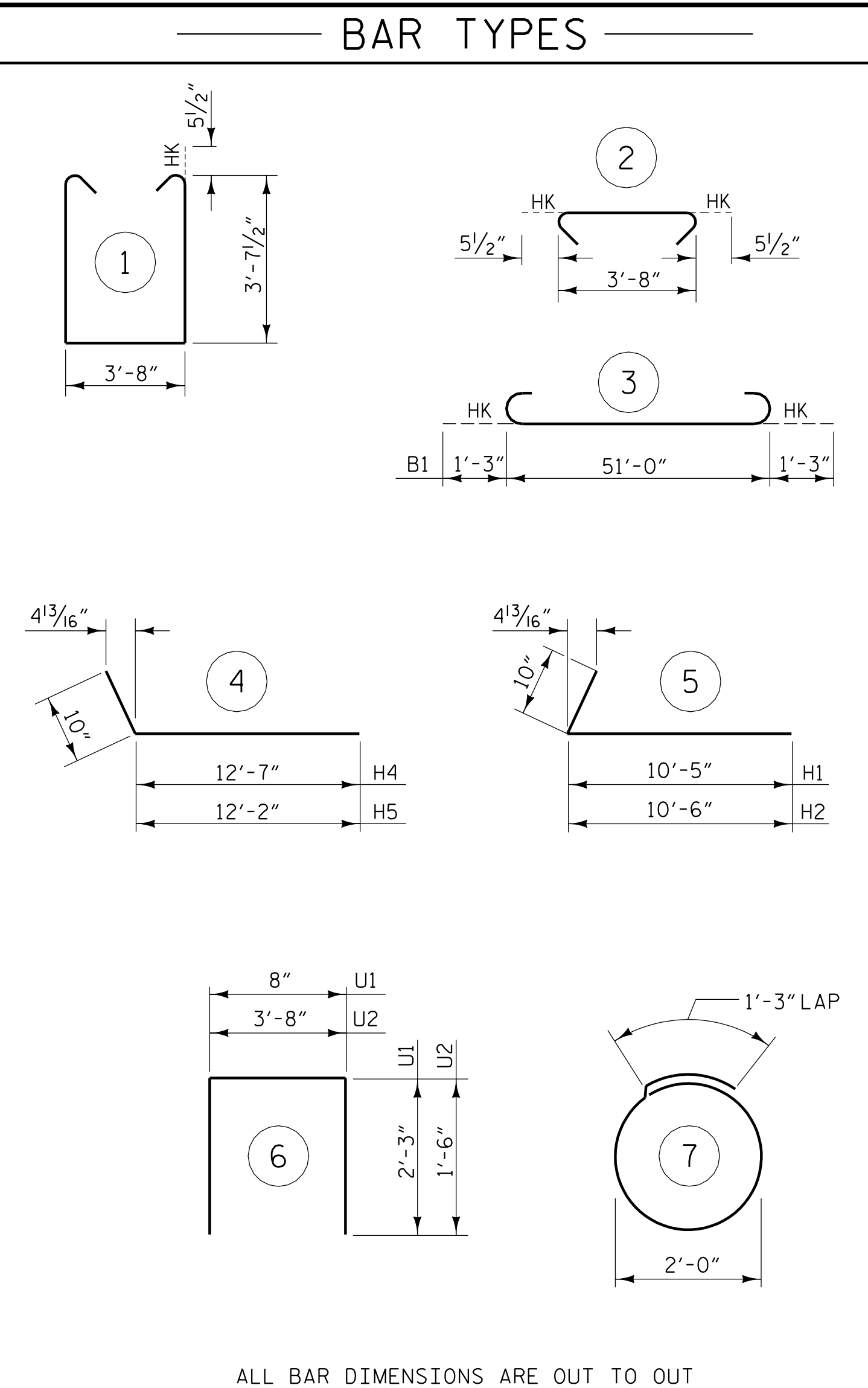

ALL BAR DIMENSIONS ARE OUT TO OUT

BILL OF MATERIAL					
END BENT 1					
BAR	NO.	SIZE	TYPE	LENGTH	WEIGHT
B1	10	#9		53'-6"	1819
B2	6	#5	STR	51'-0"	319
B3	8	#4	STR	26'-10"	143
B4	13	#4	STR	3'-8"	32
B5	15	#4	STR	3'-0"	30
H1	21	#5		11'-3"	246
H2	21	#5		11'-4"	248
H3	8	#4	STR	3'-7"	19
H4	21	#5		13'-5"	294
H5	21	#5		13'-0"	285
K1	24	#4	STR	26'-10"	430
S1	69	#5		11'-10"	852
S2	69	#5		4'-7"	330
S3	32	#4		7'-7"	162
U1	43	#4		5'-2"	148
U2	12	#4		6'-8"	53
V1	86	#5	STR	8'-10"	792
V2	30	#5	STR	10'-8"	334
V3	10	#5	STR	10'-6"	110
V4	48	#5	STR	6'-4"	317
TOTAL REINFORCING STEEL					6963 lbs.
CLASS "A" CONCRETE - CU. YARDS					
POUR 1 - CAP, COLLARS & LOWER WINGS					36.2 cu. yds.
POUR 2 - UPPER WINGS & BACKWALL					16.0 cu. yds.
TOTAL					52.2 cu. yds.
HP12X53 STEEL PILES					
8 PILES REQUIRED - LIN. FEET					600
PILE REDRIVES					4 EA.

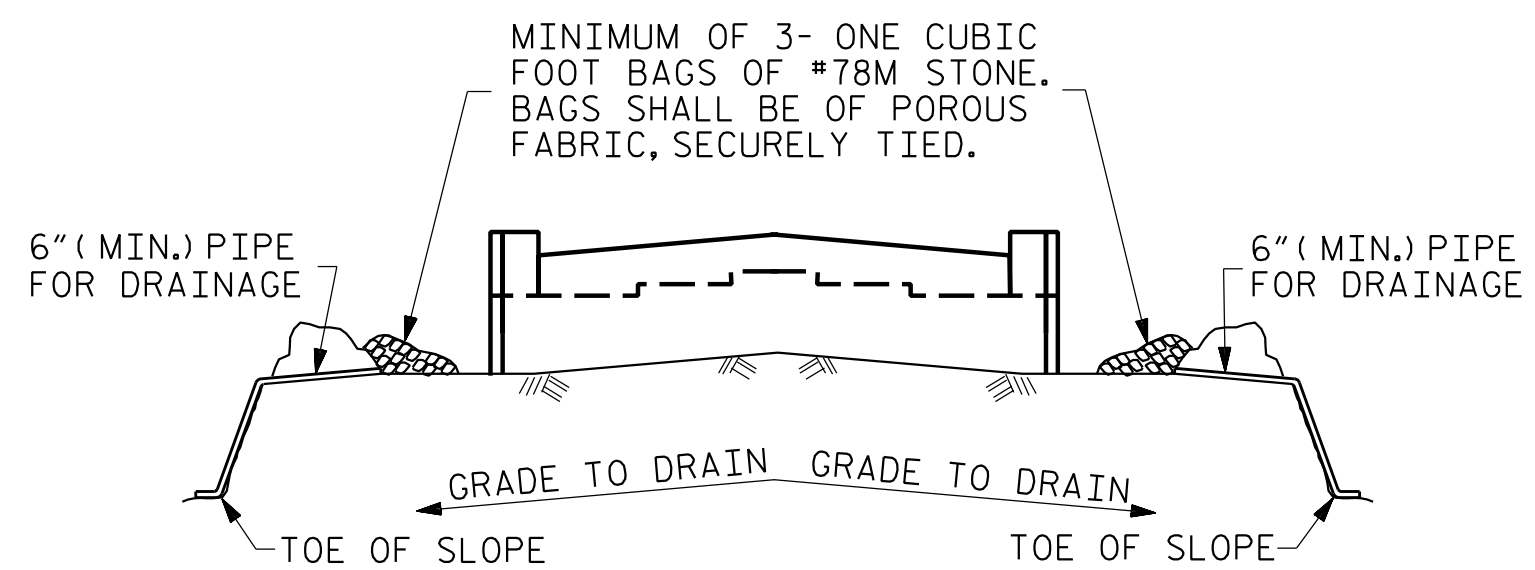

BAGGED STONE AND PIPE SHALL BE PLACED IMMEDIATELY AFTER COMPLETION OF END BENT EXCAVATION. PIPE MAY BE EITHER CONCRETE, CORRUGATED STEEL, CORRUGATED ALUMINUM ALLOY, OR CORRUGATED PLASTIC. PERFORATED PIPE WILL NOT BE ALLOWED.

BAGGED STONE SHALL REMAIN IN PLACE UNTIL THE ENGINEER DIRECTS THAT IT BE REMOVED. THE CONTRACTOR SHALL REMOVE AND DISPOSE OF SILT ACCUMULATIONS AT BAGGED STONE WHEN SO DIRECTED BY THE ENGINEER. BAGS SHALL BE REMOVED AND REPLACED WHENEVER THE ENGINEER DETERMINES THAT THEY HAVE DETERIORATED AND LOST THEIR EFFECTIVENESS.

NO SEPARATE PAYMENT WILL BE MADE FOR THIS WORK AND THE ENTIRE COST OF THIS WORK SHALL BE INCLUDED IN THE UNIT CONTRACT PRICE BID FOR THE SEVERAL PAY ITEMS.

TEMPORARY DRAINAGE AT END BENT



PROJECT NO. W-5518  
 COLUMBUS COUNTY  
 STATION: 24+06.36 -L- POT

SHEET 3 OF 3

STATE OF NORTH CAROLINA DEPARTMENT OF TRANSPORTATION RALEIGH					
SUBSTRUCTURE END BENT 1					
REVISIONS					
NO.	BY:	DATE:	NO.	BY:	DATE:
1			3		
2			4		
SHEET NO. S-24					TOTAL SHEETS 33

10/2/2015 14:43:47 PM RA\Structures\W5518\SMU\_EL\_03.dgn

DRAWN BY : W. B. ALLEN DATE : 2/15  
 CHECKED BY : Z. H. BROWN DATE : 3/15  
 DESIGN ENGINEER OF RECORD : L. K. AUSTIN DATE : 8/15