

- DEBONDING LEGEND**
- FULLY BONDED STRANDS
 - ◻ STRANDS DEBONDED FOR 2'-0" FROM END OF GIRDER
 - ◻ STRANDS DEBONDED FOR 4'-0" FROM END OF GIRDER

* FOR S7 BARS, SEE DETAIL 'C' OF PRESTRESSED CONCRETE GIRDER CONTINUOUS FOR LIVE LOAD DETAILS SHEET

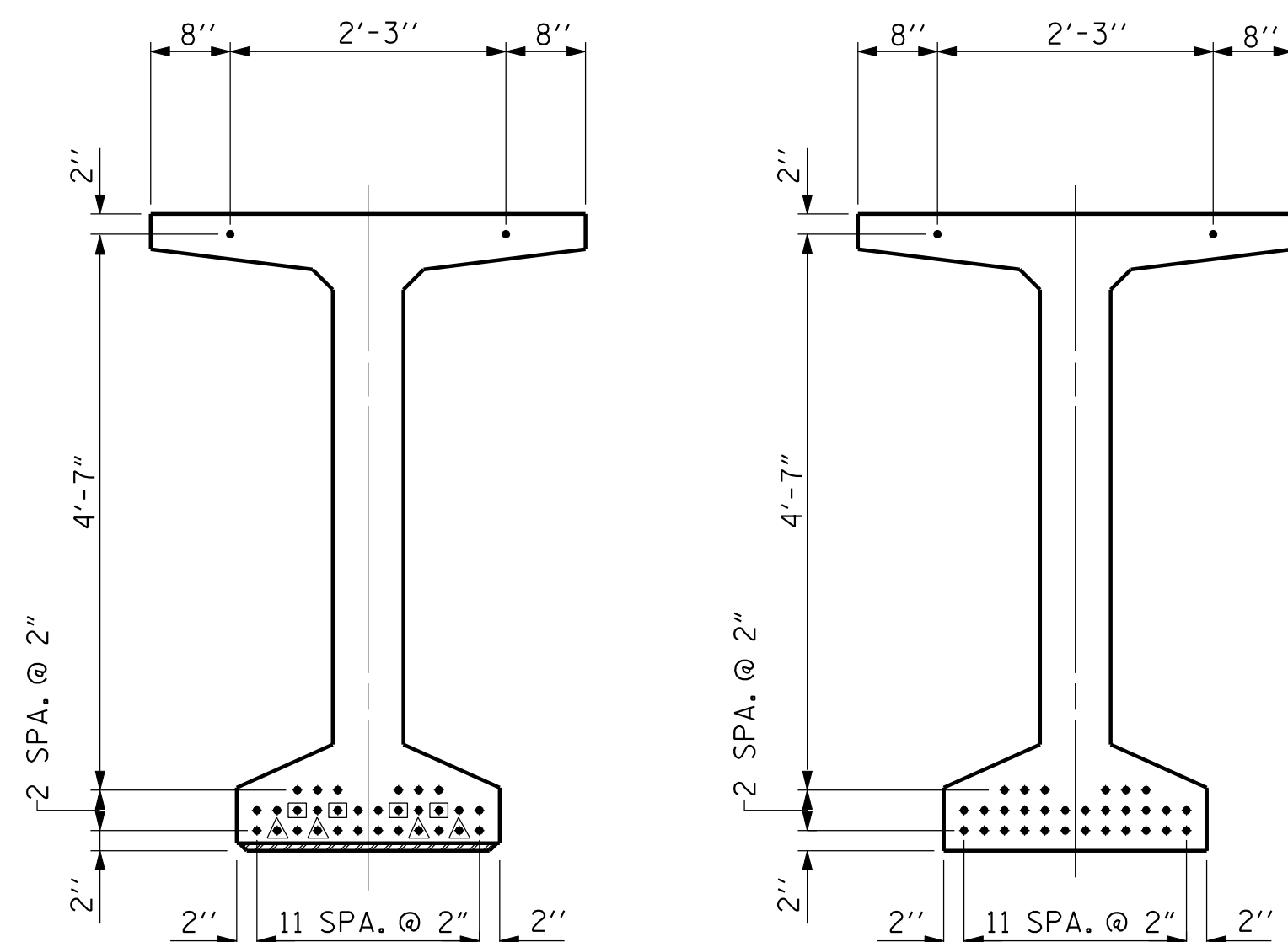

AT END OF GIRDER
AT C OF GIRDER
0.6" Ø LOW RELAXATION STRAND LAYOUT

** CUT OR BEND REINFORCING STEEL IN TOP FLANGE AS REQUIRED AT BLOCKOUT

** BLOCKOUT TOP FLANGE

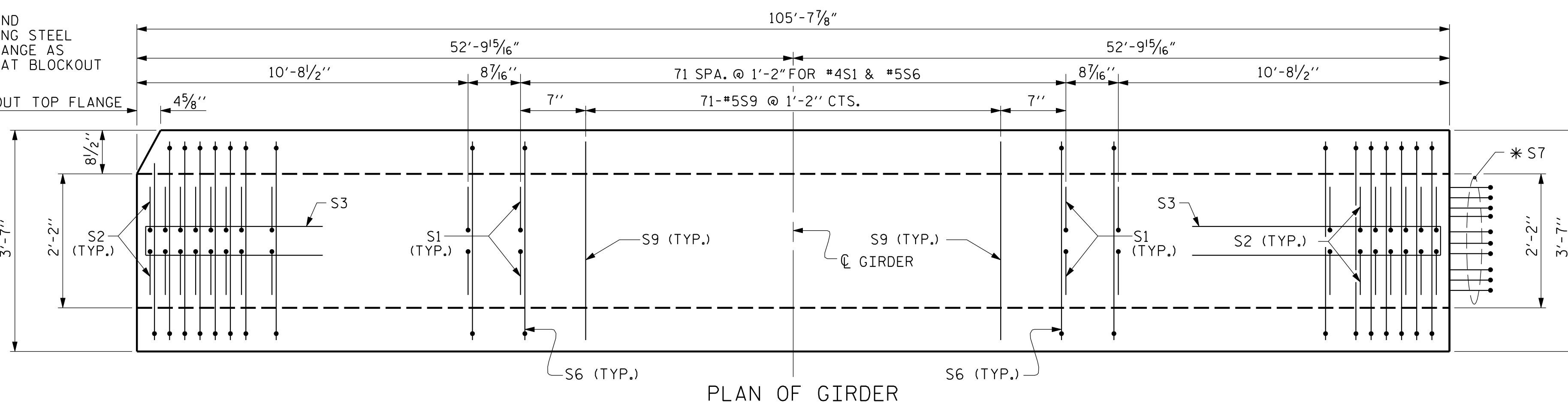

PLAN OF GIRDER

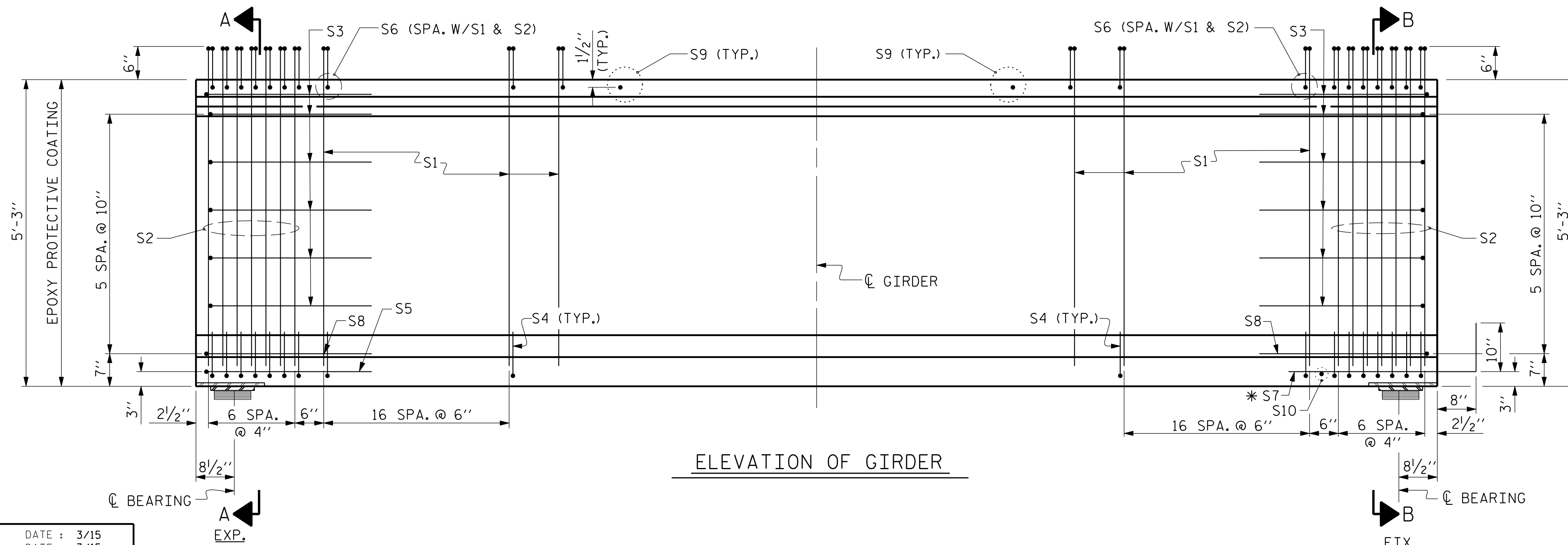

ELEVATION OF GIRDER

EXTERIOR GDR.
INTERIOR GDR.
EXTERIOR GDR.
INTERIOR GDR.

0.6" Ø L. R. GRADE 270 STRANDS		
AREA (SQUARE INCHES)	ULTIMATE STRENGTH (LBS. PER STRAND)	APPLIED PRESTRESS (LBS. PER STRAND)
0.217	58,600	43,950

REINFORCING STEEL FOR ONE GDR

BAR	NUMBER	SIZE	TYPE	LENGTH	WEIGHT
S1	212	#4	1	6'-1"	862
S2	28	#5	1	6'-1"	178
S3	12	#4	2	8'-5"	67
S4	96	#4	3	3'-0"	192
S5	1	#5	2	9'-10"	10
S6	236	#5	4	4'-4"	1067
* S7	10	#5	STR	3'-8"	38
S8	2	#5	2	9'-0"	19
S9	71	#5	STR	3'-3"	241
S10	1	#3	STR	1'-10"	1
S11	8	#5	5	10'-0"	83
S11	16	#5	5	10'-0"	167
S12	16	#4	STR	8'-0"	86
S13	16	#4	STR	13'-9"	147

* NOTE: S7 BARS SHALL BE BENT BEFORE SHIPMENT. HEAT BENDING SHALL NOT BE ALLOWED.

BAR TYPES

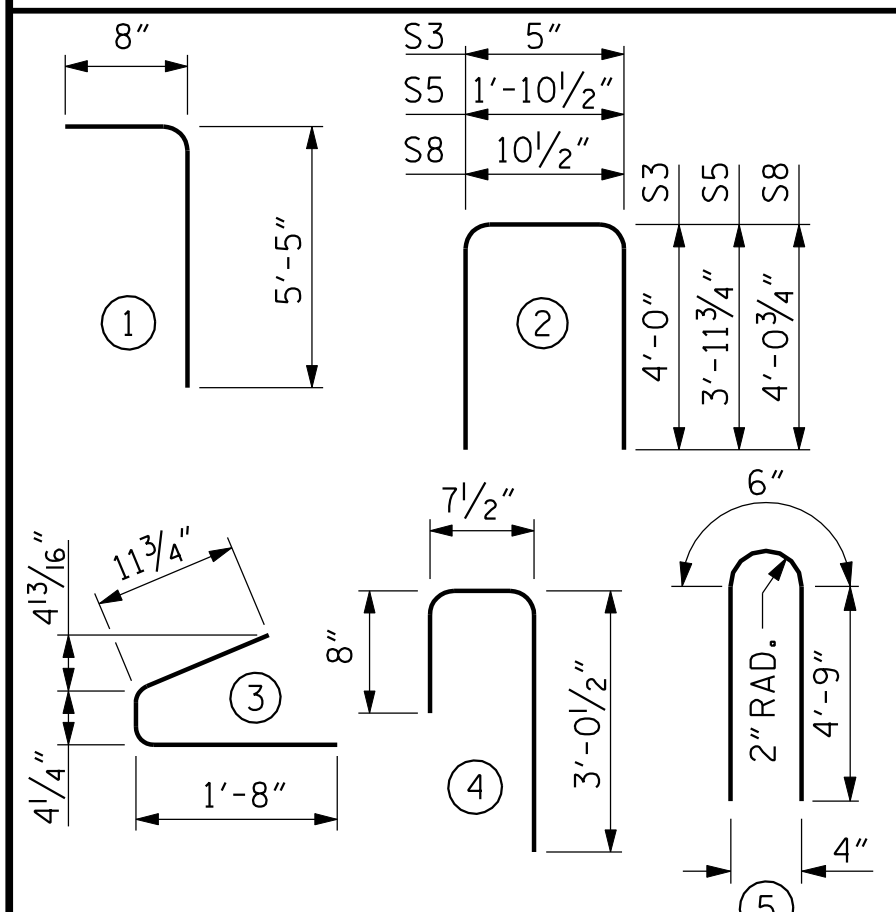

ALL BAR DIMENSIONS ARE OUT-TO-OUT

QUANTITIES FOR ONE GIRDER

	REINFORCING STEEL		10000 PSI CONCRETE		0.6" Ø L.R. STRANDS	
	LB.	C.Y.			No.	
EXTERIOR GIRDER	2844	20.9			32	
INTERIOR GIRDER	2989	20.9			32	

GIRDERS REQUIRED

NUMBER	LENGTH	TOTAL LENGTH
8	105'-7 7/8"	845'-3"

PROJECT NO. W-5518

COLUMBUS COUNTY

STATION: 24+06.36 -L- POT

SHEET 1 OF 4

STATE OF NORTH CAROLINA
DEPARTMENT OF TRANSPORTATION
RALEIGH

STANDARD
63" PRESTRESSED CONCRETE
MODIFIED BULB TEE
CONTINUOUS FOR LIVE LOAD

REVISIONS

NO.	BY:	DATE:	NO.	BY:	DATE:
1			3		
2			4		

SHEET NO.
S-10
TOTAL SHEETS
33



THIS STANDARD DRAWING REVIEWED & ADOPTED FOR USE AT THE REFERENCED LOCATION BY THE UNDERSIGNED:

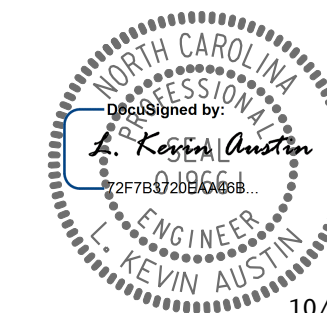

10/2/2015

ASSEMBLED BY : W. B. ALLEN	DATE : 3/15
CHECKED BY : Z. H. BROWN	DATE : 3/15
DRAWN BY : EEM 2/6/97	REV. 10/1/11 MAA/GM
CHECKED BY : VAP 2/6/97	REV. 6/13 MAA/GM
	REV. 1/15 MAA/TMG