

5/28/99

BM#1 ELEVATION = 691.33'  
N = 484.577 E = 1,498.275  
-BL- STATION 16+06 (O/S 44' LT)  
RR SPIKE IN 15' OAK TREE

**-L-**

BM#2 ELEVATION = 672.58  
N 484.966 E 1,498.831  
-BL- STATION 22+77 74 RIGHT  
RR SPIKE IN 20' OAK TREE

BM#3 ELEVATION = 682.14  
N 485.500 E 1,499.237  
-BL- STATION 29+45 88 RIGHT  
RR SPIKE IN 24' OAK TREE

PROJECT REFERENCE NO. <b>B-5243</b>	SHEET NO. <b>6</b>
ROADWAY DESIGN ENGINEER <b>Gregory E. Brien</b> Professional Seal 18903 10/20/2015	HYDRAULICS ENGINEER <b>Blayne M. Radakovic</b> Professional Seal 39249 10/19/2015
SEE SHEET 4 FOR PLANS	

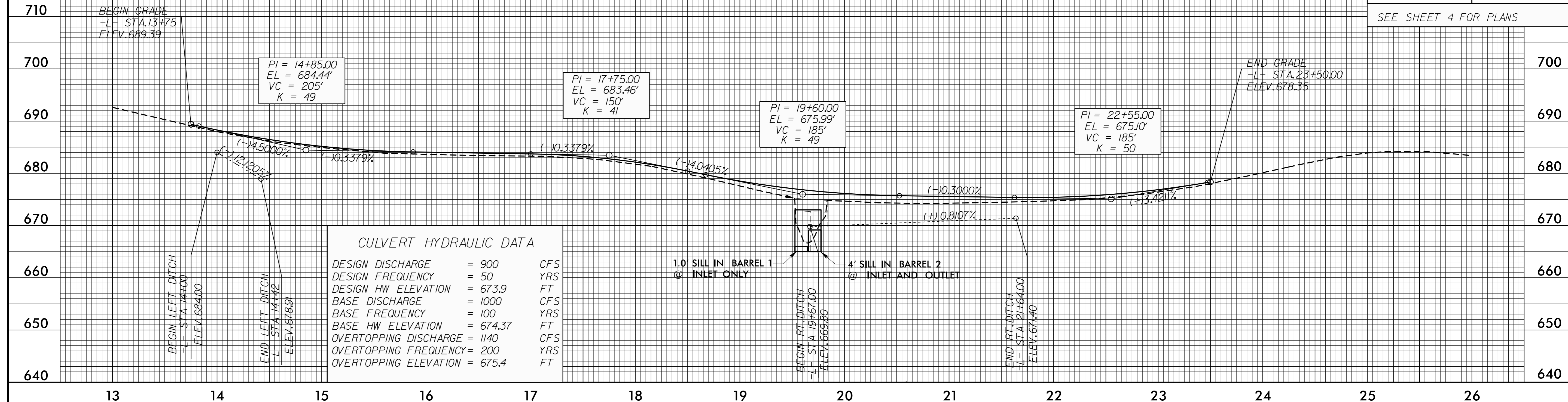

SEE SHEET 4 FOR PLANS

**-Y2-**

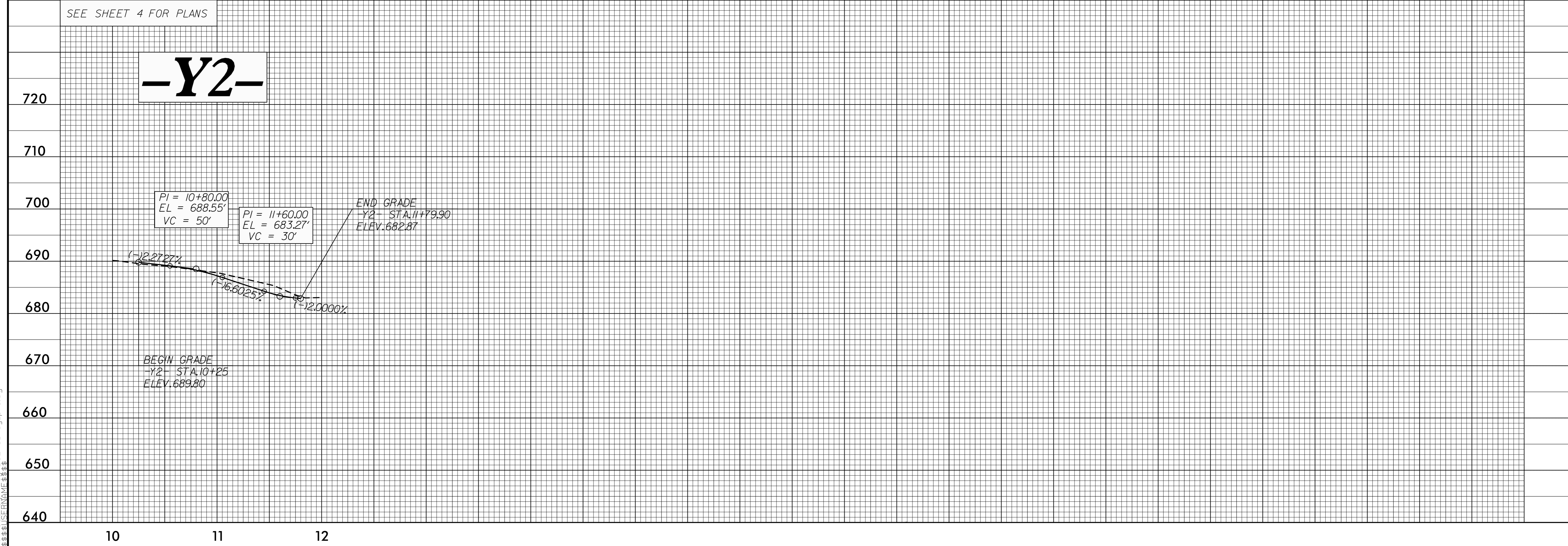

25-SEP-2015 10:24 AM B5243.Rdy-pf.dgn