

PROJECT REFERENCE NO. <b>B-4822</b>		SHEET NO. <b>4</b>	
RW SHEET NO.			
ROADWAY DESIGN ENGINEER 		HYDRAULICS ENGINEER 	
10/14/2015		10/14/2015	
KCI Engineers • Planners • Scientists • Construction Managers 4601 Six Forks Road, Landmark Center II, Suite 220 Raleigh, NC 27609-5210 Phone (919) 783-9214 • Fax (919) 783-9266			

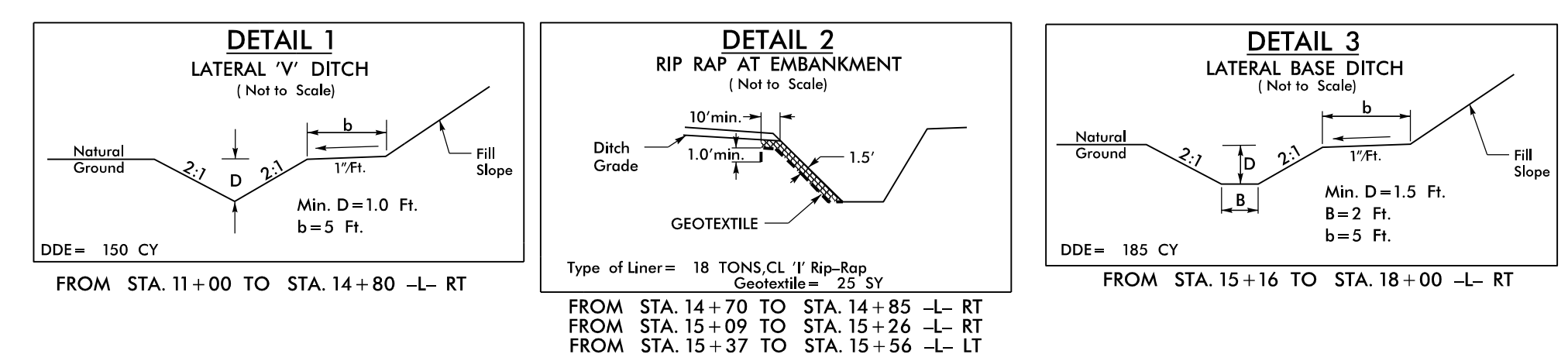

-L-

PI Sta 13+37.87	PI Sta 17+44.56
$\Delta = 26^\circ 50' 36.6''$ (LT)	$\Delta = 33^\circ 12' 56.0''$ (LT)
$D = 11' 48' 48.8''$	$D = 11' 01' 06.3''$
$L = 227.23'$	$L = 301.45'$
$T = 115.74'$	$T = 155.10'$
$R = 485.00'$	$R = 520.00'$
$SE = .06$	$SE = .06$
$RO = 103.5'$	$RO = 103.5'$

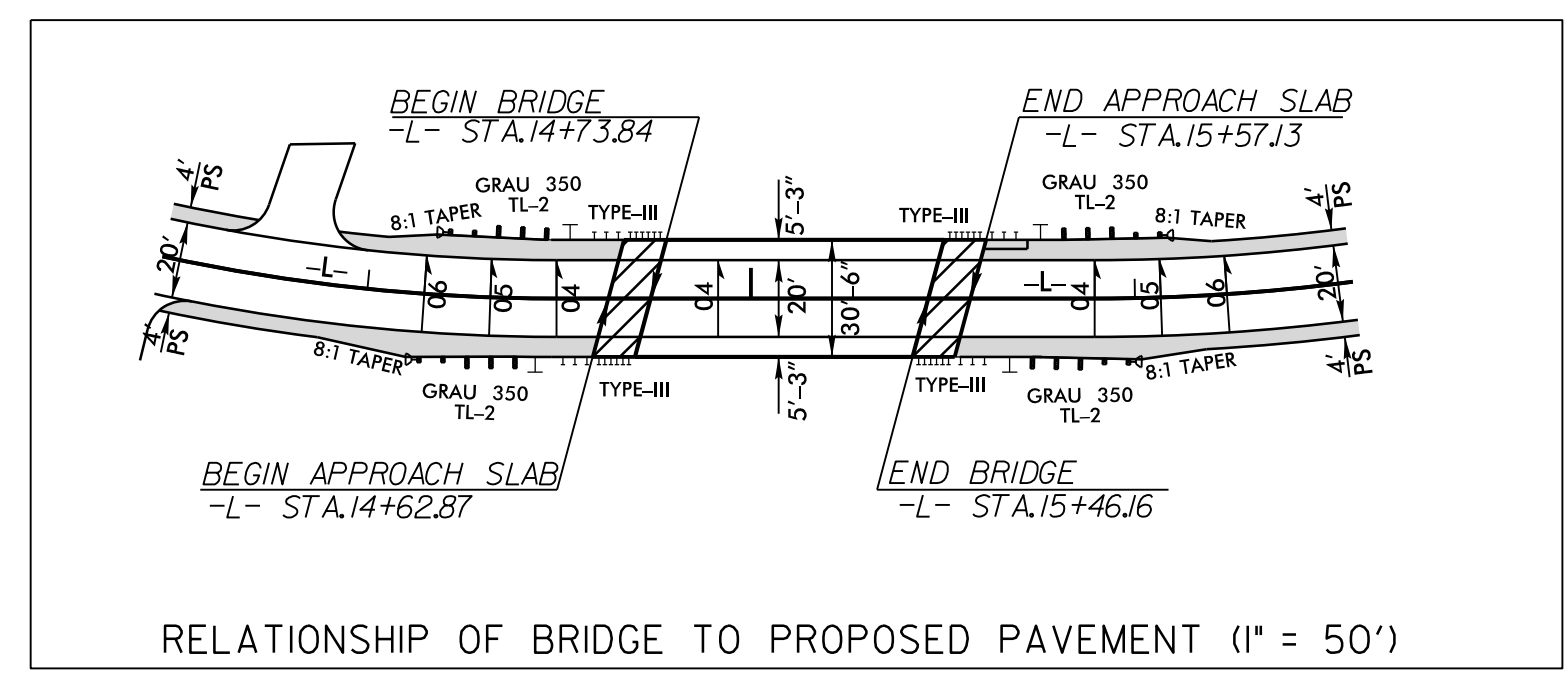
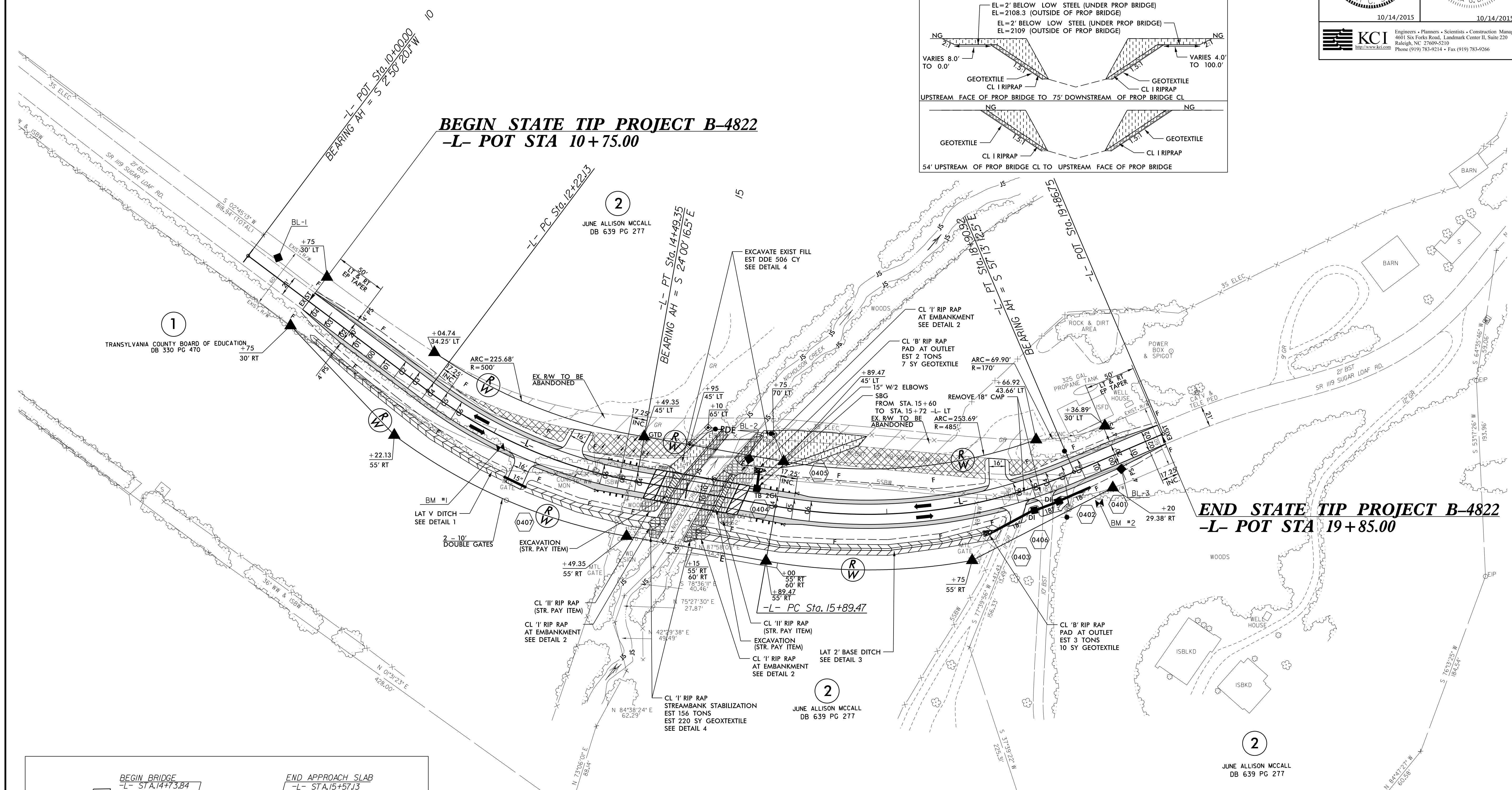
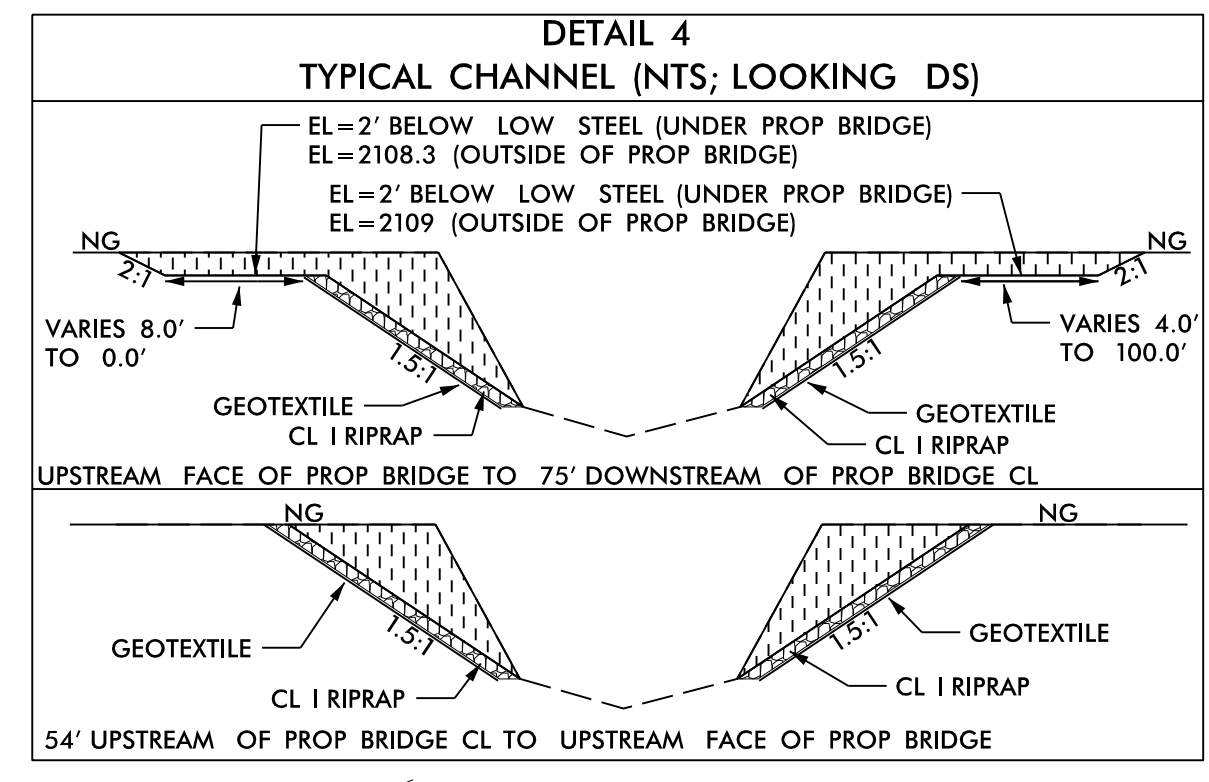
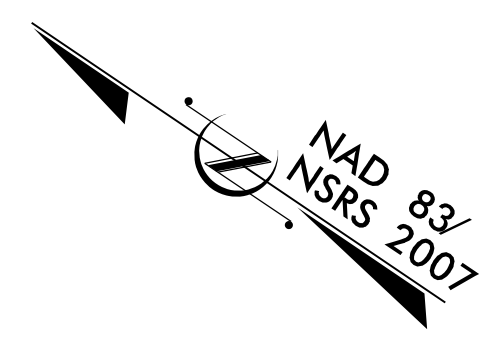

- BRIDGE APPROACH SLABS
- PAVEMENT REMOVAL
- EXCAVATION (STR. PAY ITEM)
- EXISTING FILL EXCAVATION (DETAIL 4)

FOR -L- PROFILE, SEE SHEET 5  
FOR STRUCTURE PLANS, SEE SHEETS S-1 TO S-18

NOTE: ALL DRIVEWAY RADII ARE 10' UNLESS OTHERWISE STATED.

**SUNGATE DESIGN GROUP, P.A.**

915 JONES FRANKLIN ROAD  
RALEIGH, NORTH CAROLINA 27606  
TEL (919) 855-2243 FAX (919) 855-8258  
ENG FIRM LICENSE NO. C-890

14-001-2015-1410  
 M:\2014\1410\141071A\_NCDOT\_B-4822\Roadway\Proj\B4822.Rdw\_psh\_4.dgn  
 8/17/09  
 8/17/09