

STATE OF NORTH CAROLINA
DIVISION OF HIGHWAYS

TRANSPORTATION MANAGEMENT PLAN

JACKSON COUNTY

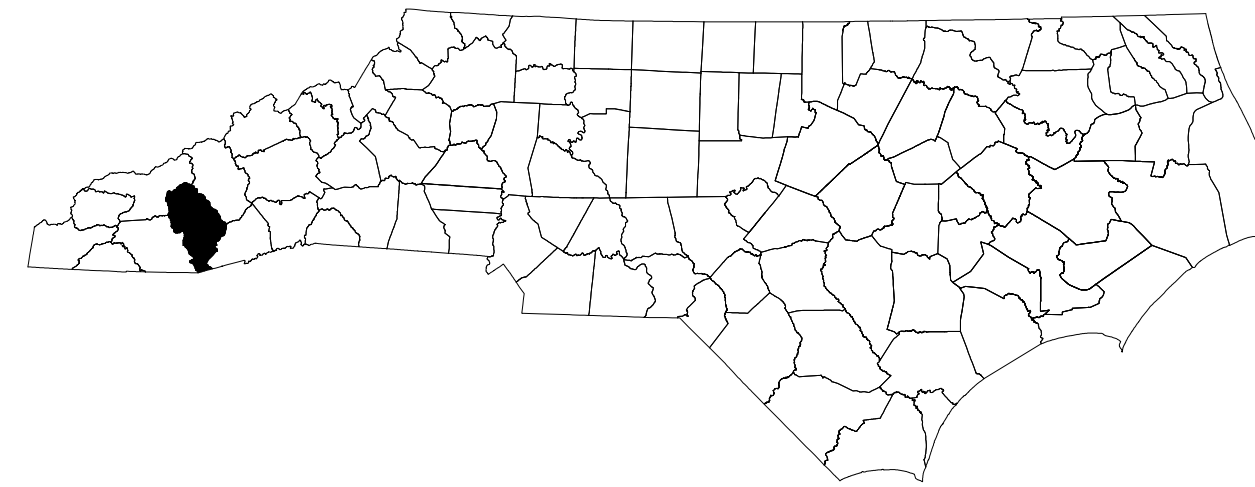

NAD 83/NSRS 2007

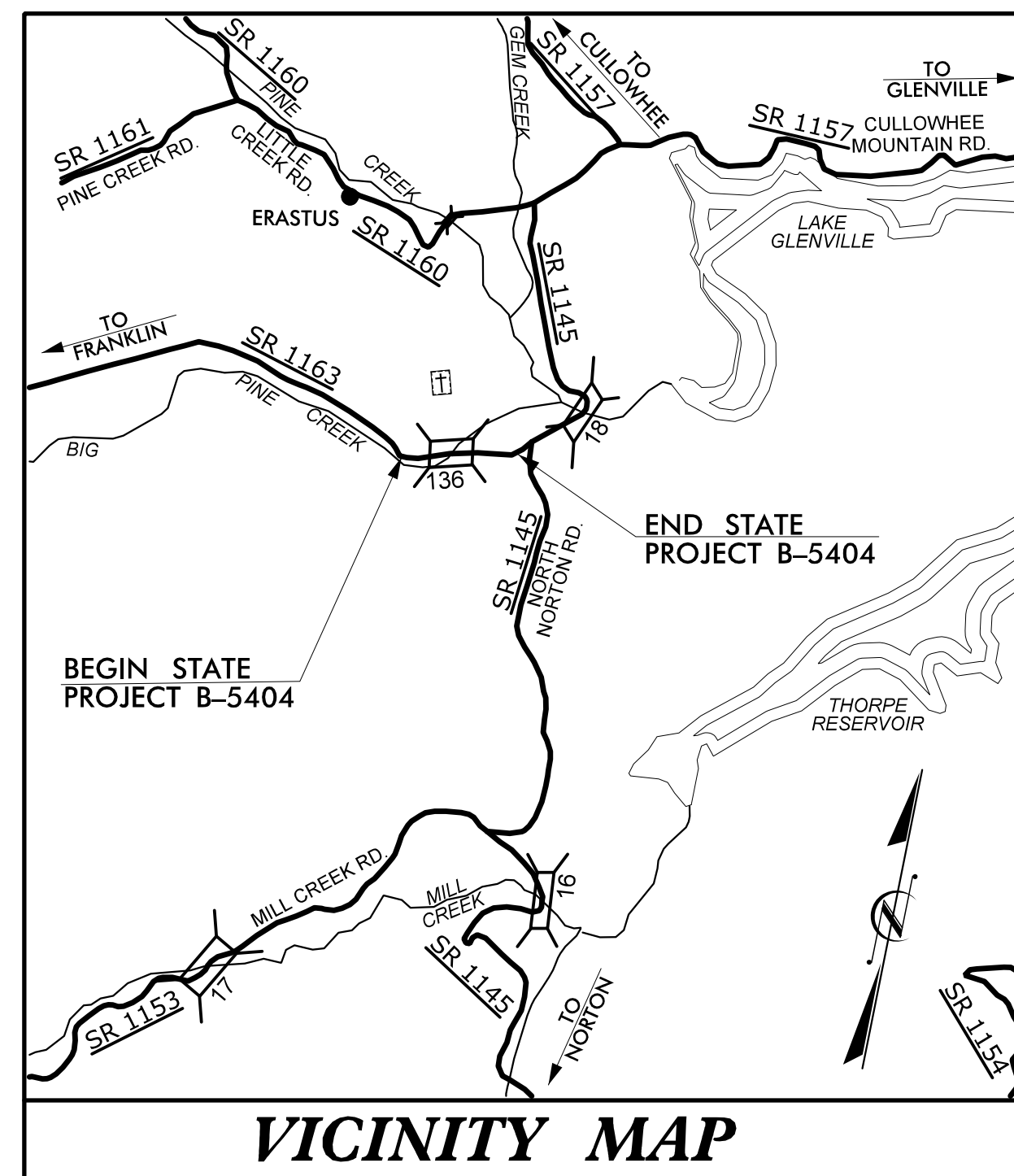

INDEX OF SHEETS	
<u>SHEET NO.</u>	<u>TITLE</u>
TMP-1	TITLE SHEET AND INDEX OF SHEETS
TMP-1A	LIST OF APPLICABLE ROADWAY STANDARD DRAWINGS, LEGEND AND TEMPORARY PAVEMENT MARKING
TMP-1B	TRANSPORTATION OPERATIONS PLAN: (MANAGEMENT STRATEGIES AND GENERAL NOTES)
TMP-2	PORT. CONC. BARRIER AT TEMP. SHORING LOCATIONS
TMP-2A	TEMP. SHORING NOTES
TMP-3	PHASING NOTES
TMP-4	TEMPORARY TRAFFIC CONTROL PHASE I DETAIL
TMP-5	TEMPORARY TRAFFIC CONTROL PHASE II DETAIL

SHEET NO.
TMP-1

MERRICK "TRE" DUGAL, III, P.E.
PROJECT ENGINEER
CLAUDETTE M.K. ROQUE, P.E.
PROJECT DESIGN ENGINEER

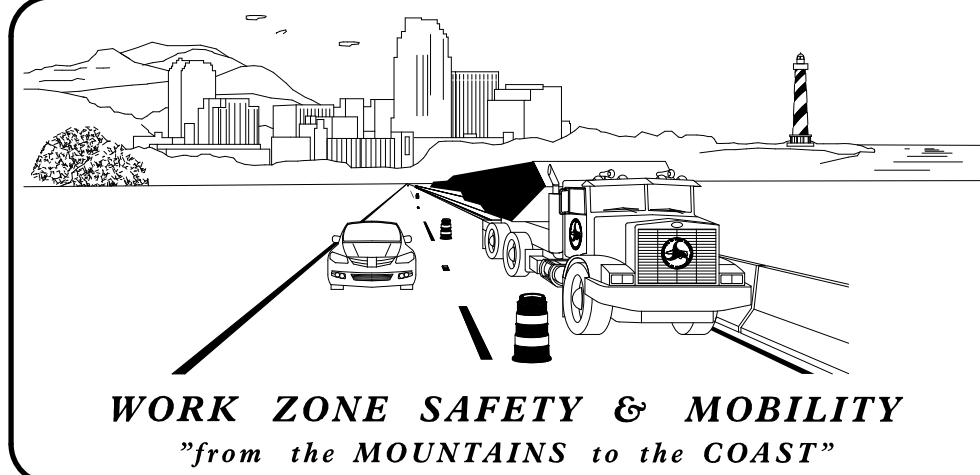

N.C.D.O.T. WORK ZONE TRAFFIC CONTROL
1561 MAIL SERVICE CENTER (MSC) RALEIGH, NC 27699-1561
750 N. GREENFIELD PARKWAY, GARNER, NC 27529 (DELIVERY)
PHONE: (919) 773-2800 FAX: (919) 771-2745

J. S. BOURNE, P.E. STATE TRAFFIC MANAGEMENT ENGINEER
J. W. WOOLARD, P.E. TRAFFIC CONTROL PROJECT ENGINEER
L. D. STOUCHKO, P.E. TRAFFIC CONTROL PROJECT DESIGN ENGINEER
TRAFFIC CONTROL DESIGN ENGINEER



Prepared in the Office of:
RAMEY KEMP ASSOCIATES, INC.
Transportation Engineers
5808 Faringdon Place, Suite 100
Raleigh, North Carolina 27609
919-872-5115 Tel. 919-878-5416 Fax.
www.rameykemp.com
NC License No. C-0910

APPROVED: Claudette M. K. Roque
DATE: 9/18/2015
SEAL
CLAUDETTE M. K. ROQUE
ENGINEER
PROFESSIONAL SEAL
17306

9/14/2015
...:\TC\B-5404_TC_TMP-1.dgn
User: croque

TIP PROJECT: B-5404