

-DETOUR 1-

PROJECT REFERENCE NO. R-2409C SHEET NO. EC-13/CONST 2E
 RW SHEET NO.
 ROADSIDE ENVIRONMENTAL PROJECT ENGINEER

LEVEL III CERTIFIED BY:
 STACEY H. BAILEY, PE
 CERTIFICATION NUMBER: 3074
 ISSUED: JUNE 25, 2014

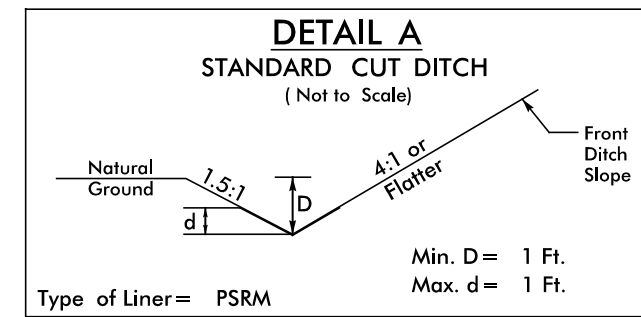

FROM STA. 11+25 TO STA. 20+00 -DETI- LT
 FROM STA. 17+00 TO STA. 20+00 -DETI- RT

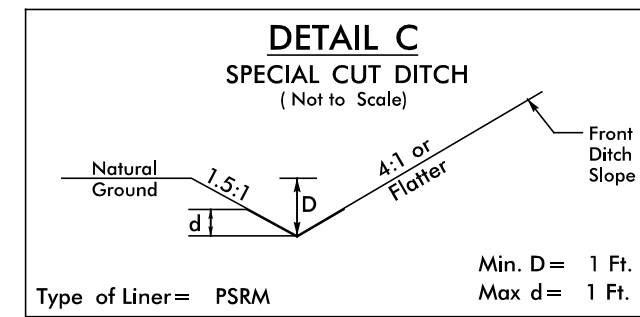

FROM STA. 20+00 TO STA. 21+50 -DETI- LT
 FROM STA. 20+00 TO STA. 20+50 -DETI- RT

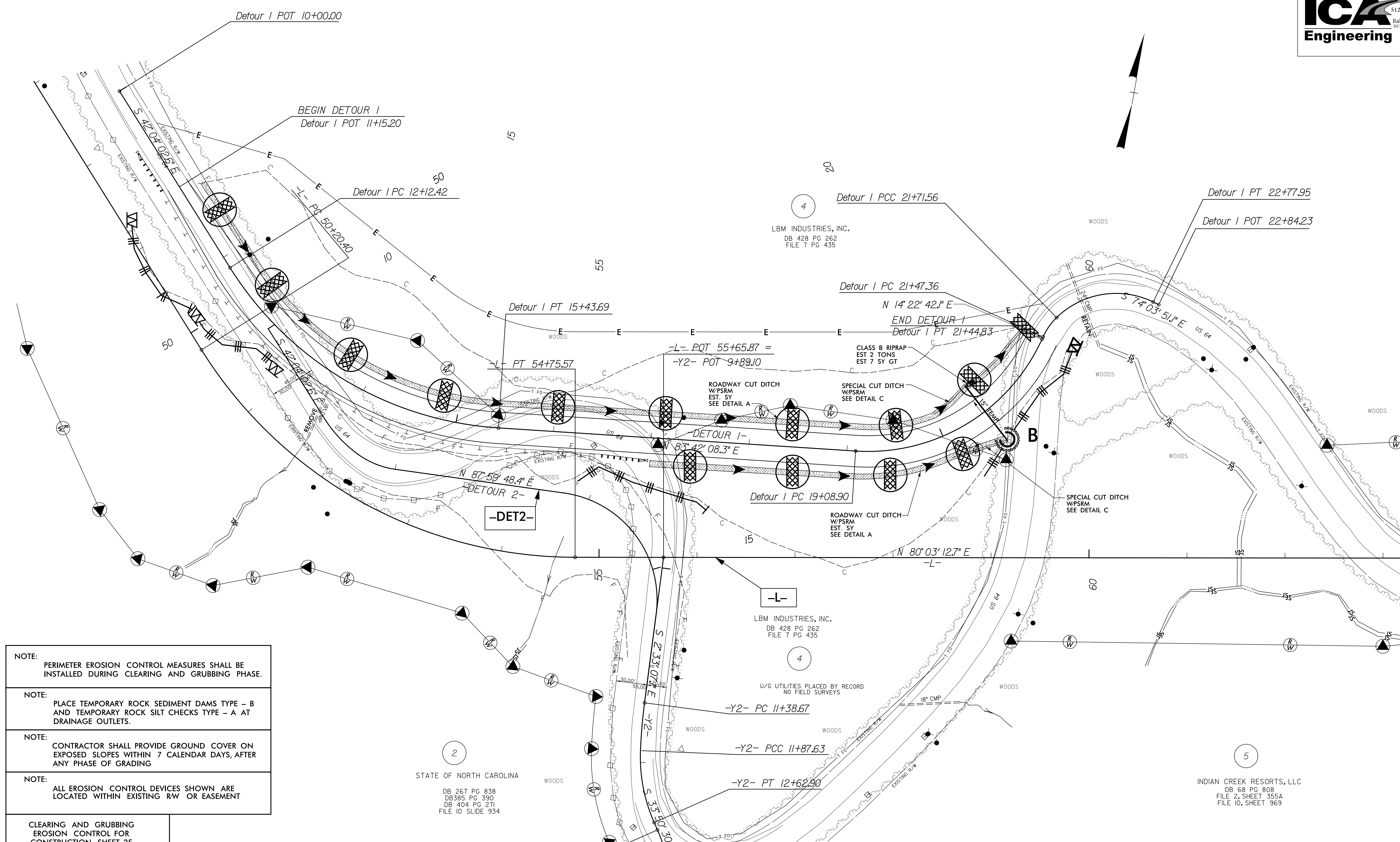

- NOTE: PERIMETER EROSION CONTROL MEASURES SHALL BE INSTALLED DURING CLEARING AND GRUBBING PHASE.
- NOTE: PLACE TEMPORARY ROCK SEDIMENT DAMS TYPE - B AND TEMPORARY ROCK SILT CHECKS TYPE - A AT DRAINAGE OUTLETS.
- NOTE: CONTRACTOR SHALL PROVIDE GROUND COVER ON EXPOSED SLOPES WITHIN 7 CALENDAR DAYS, AFTER ANY PHASE OF GRADING
- NOTE: ALL EROSION CONTROL DEVICES SHOWN ARE LOCATED WITHIN EXISTING RW OR EASEMENT

CLEARING AND GRUBBING
 EROSION CONTROL FOR
 CONSTRUCTION SHEET 2E

STATE OF NORTH CAROLINA
 DB 267 PG 838
 DB385 PG 390
 DB 404 PG 271
 FILE 10 SLIDE 934

INDIAN CREEK RESORTS, LLC
 DB 68 PG 808
 FILE 2, SHEET 355A
 FILE 10, SHEET 969

FOR -DETOUR 1- PROFILE SEE SHEET 16

REVISIONS

8/17/99
 6/25/2014
 I:\Projects\2014\2409C\Control\cadd\R2409C_hyd_final_detl.psh13.dgn
 ICA ENGINEERING, INC.