

09/08/09

See Sheet 1A For Index of Sheets
See Sheet 1B For Conventional Plan Sheet Symbols

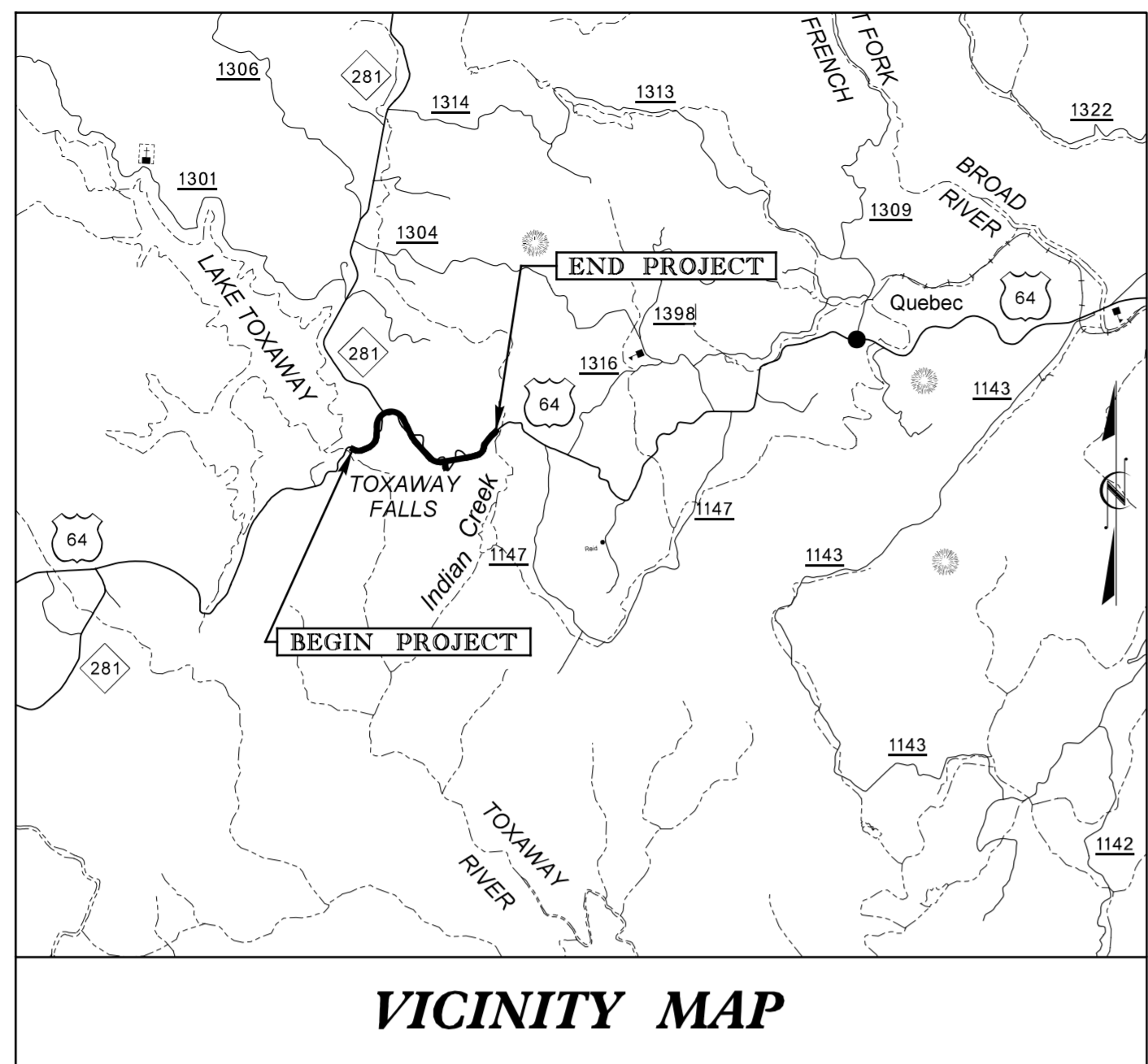

VICINITY MAP

STATE OF NORTH CAROLINA
DIVISION OF HIGHWAYS

TRANSYLVANIA COUNTY

LOCATION: US 64 from LAKE TOXAWAY to INDIAN CREEK

TYPE OF WORK: GRADING, DRAINAGE, PAVING & RETAINING WALLS

STATE	STATE PROJECT REFERENCE NO.	SHEET NO.	TOTAL SHEETS
N.C.	R-2409C	1	
STATE PROJ. NO.	F.A. PROJ. NO.	DESCRIPTION	
34428.1.2		P.E.	
34428.2.FR3	HPP-0064(115)	R/W	
34428.3.FR4	HPP-0064(115)	CONST.	

TIP PROJECT: R-2409C

CONTRACT: C202582

BEGIN PROJECT R-2409C
-L- POT 10+05.00

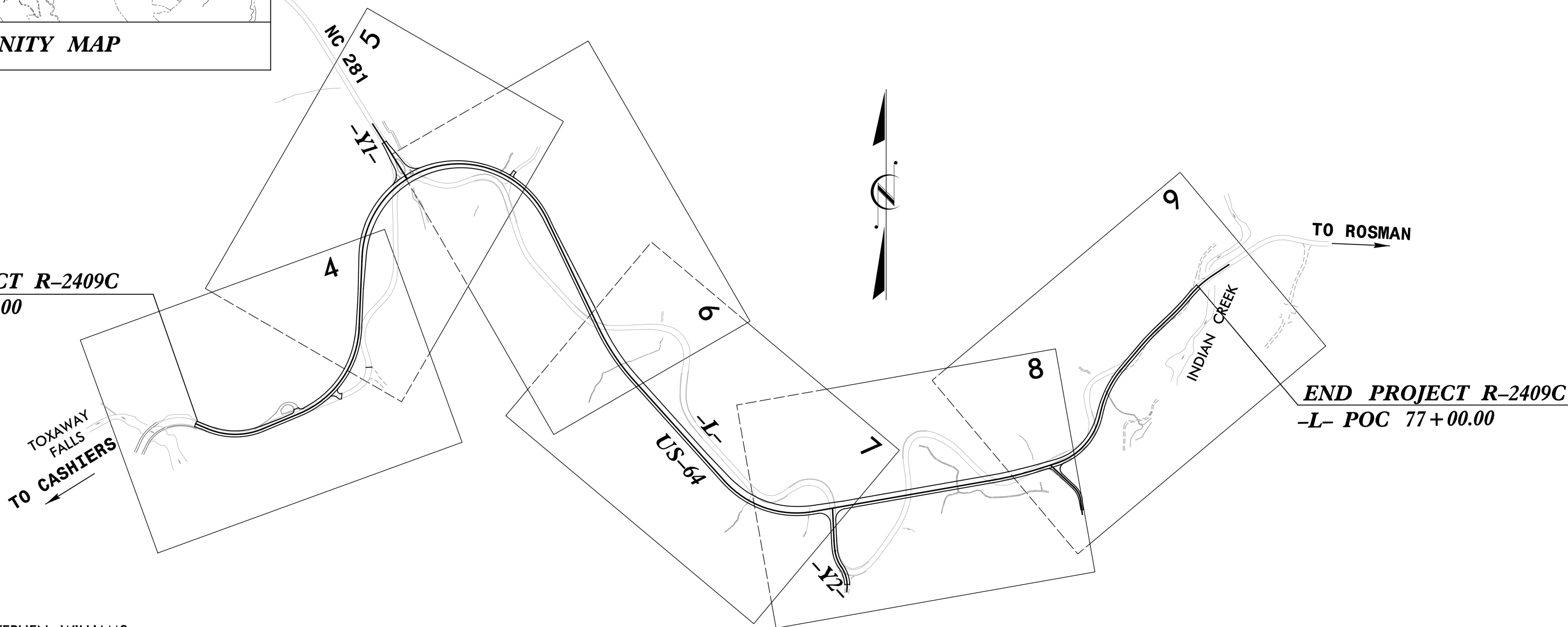

END PROJECT R-2409C
-L- POC 77+00.00

NCDOT CONTACT: STEPHEN WILLIAMS,
DIVISION DESIGN CONSTRUCTION ENGINEER

GRAPHIC SCALES

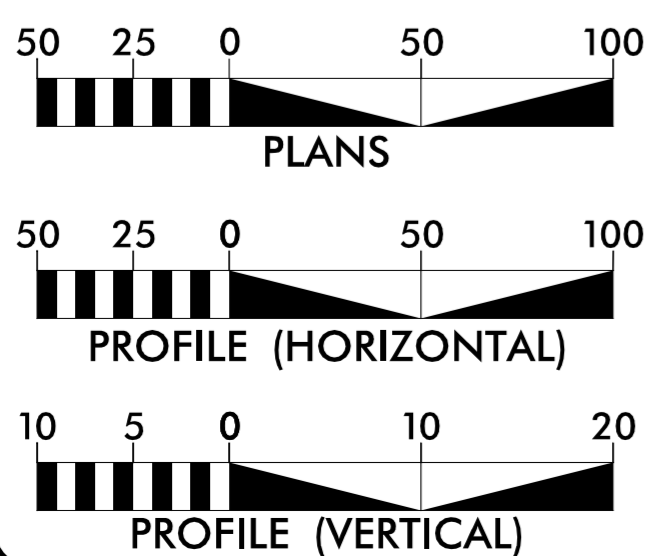

DESIGN DATA

ADT 2015 = 6,300
ADT 2035 = 10,100
DHV = 10 %
D = 60 %
T = 10 % *
V = 40 MPH
* TTST = 5% DUAL = 5%
FUNC CLASS = MINOR ARTERIAL REGIONAL TIER

PROJECT LENGTH

LENGTH ROADWAY TIP PROJECT R-2409C = 1.268 MI.
LENGTH STRUCTURES TIP PROJECT R-2409C = 0.000 MI.
TOTAL LENGTH OF TIP PROJECT R-2409C = 1.268 MI.

Prepared In the Office of:



For the North Carolina Department of Transportation

2012 STANDARD SPECIFICATIONS

RIGHT OF WAY DATE:
DECEMBER 20, 2013

LETTING DATE:
DECEMBER 15, 2015

DAVID C. WALLER, P.E.
PROJECT ENGINEER

ALEXANDER D. SNIDER, P.E.
PROJECT DESIGN ENGINEER

HYDRAULICS ENGINEER

STACEY H. BAILEY
10/23/2015
P.E.

ROADWAY DESIGN ENGINEER

DAVID C. WALLER
10/22/2015
P.E.

