

09/08/99

See Sheet 1A For Index of Sheets
See Sheet 1B For Conventional Symbols
See Sheet 1C-1 For Survey Control Sheet

STATE OF NORTH CAROLINA
DIVISION OF HIGHWAYS

MACON COUNTY

LOCATION: BRIDGE No. 172 OVER LITTLE
TENNESSEE RIVER ON SR 1456

TYPE OF WORK: DRAINAGE, GRADING, STRUCTURE, AND PAVING

STATE	STATE PROJECT REFERENCE NO.	SHEET NO.	TOTAL SHEETS
N.C.	B-3868	1	
STATE PROJ. NO.	F.A. PROJ. NO.	DESCRIPTION	
33313.1.1	BRZ-1456(6)	P.E.	
33313.2.FD2	BRZ-1456(6)	R/W, UTILITY	
33313.3.FD1	BRZ-1456(6)	CONSTRUCTION	

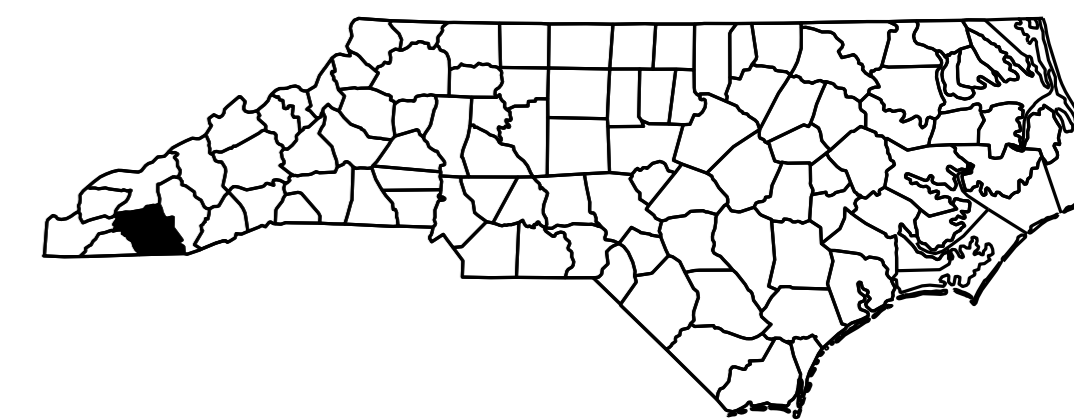

TIP PROJECT: B-3868

CONTRACT: C203656

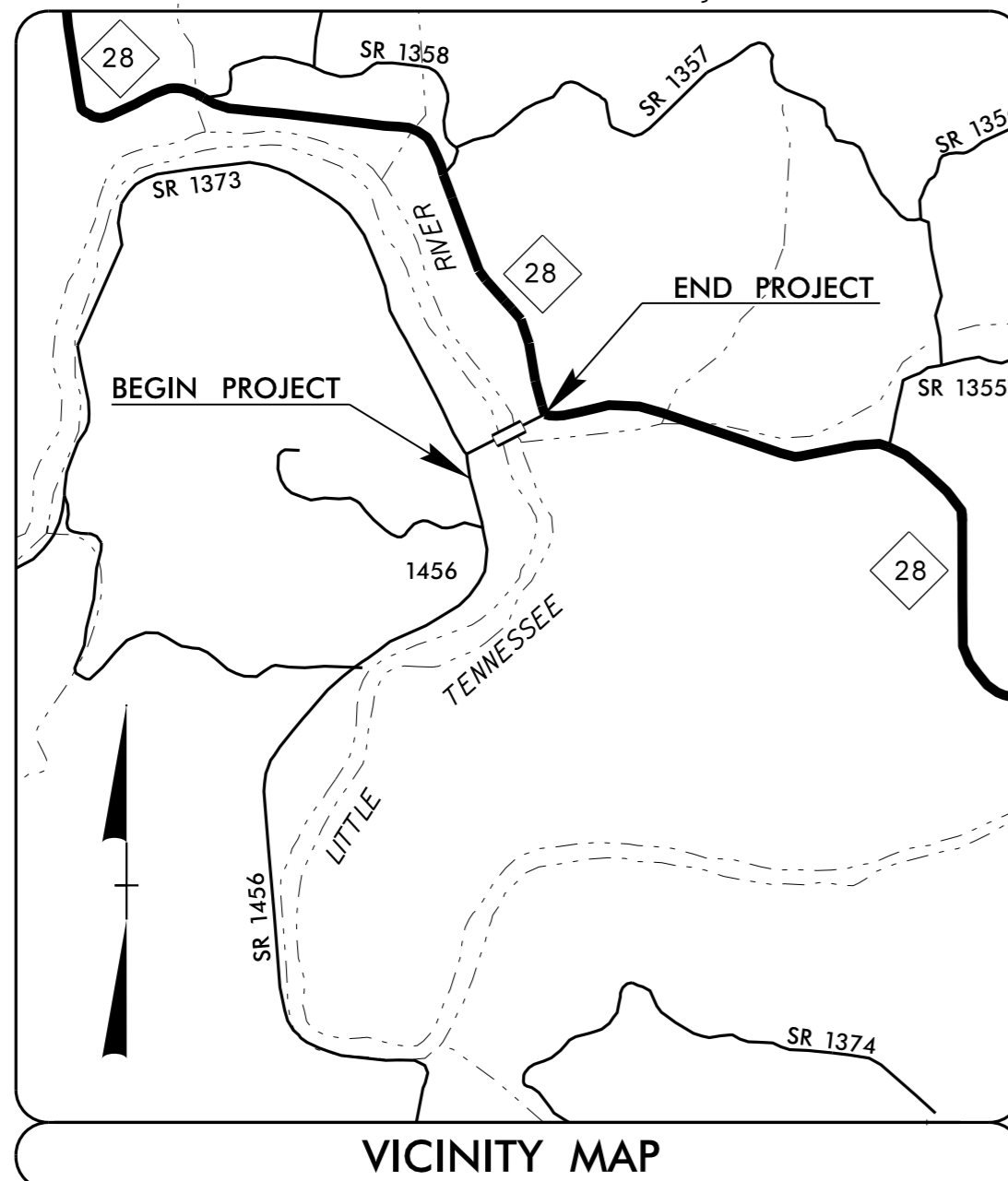

VICINITY MAP
SEE TMP-11 FOR OFF-SITE DETOUR

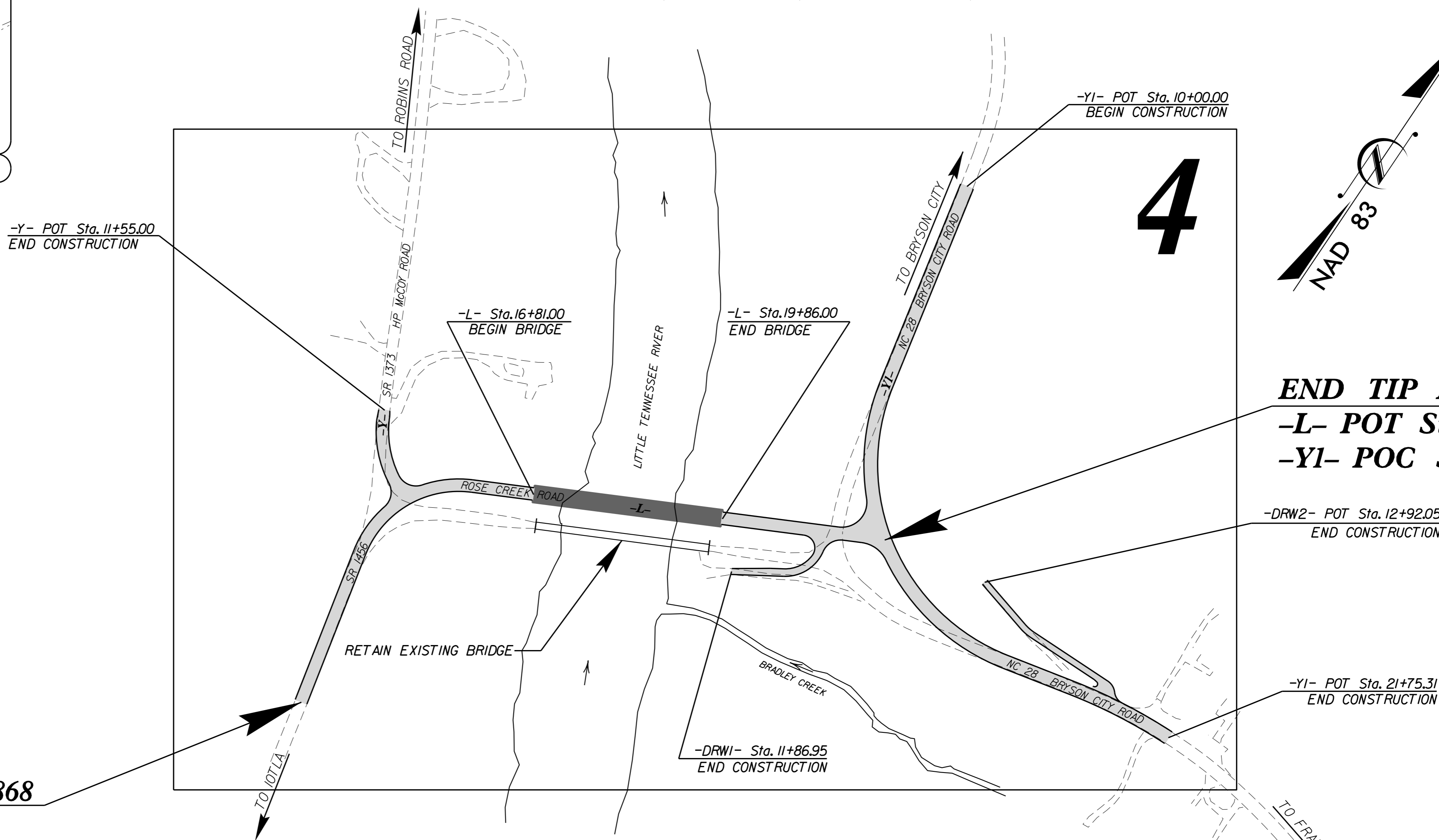

BEGIN TIP PROJECT B-3868
-L- POT Sta. 11+00.00

END TIP PROJECT B-3868
-L- POT Sta. 22+48.22 =
-YI- POC Sta. 15+96.49

THIS IS NOT A CONTROL OF ACCESS PROJECT

GRAPHIC SCALES

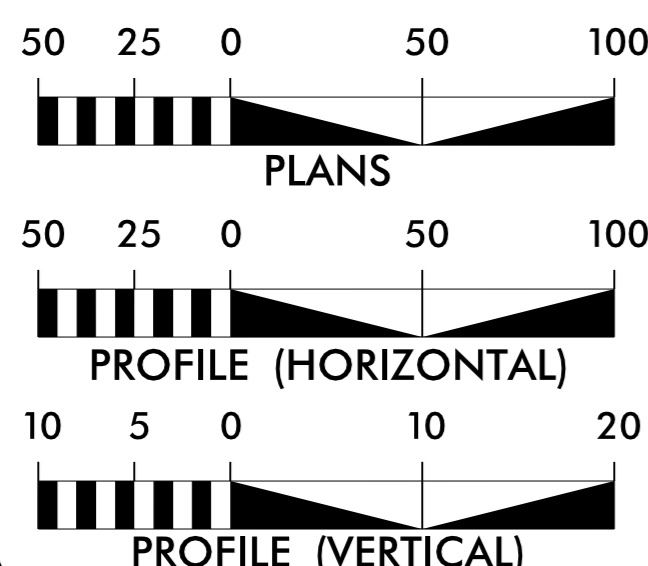

DESIGN DATA

ADT 2013 = 330
ADT 2035 = 500
DHV = 10 %
D = 65 %
T = 7 % *
V = 25 MPH
* TTST = 1% DUAL 6%
FUNC CLASS = LOCAL
SUBREGIONAL TIER

PROJECT LENGTH

LENGTH ROADWAY T.I.P. PROJECT B-3868 = 0.159 MI
LENGTH STRUCTURE T.I.P. PROJECT B-3868 = 0.058 MI
TOTAL LENGTH OF T.I.P. PROJECT B-3868 = 0.217 MI

Prepared in the Office of:
DIVISION OF HIGHWAYS
1000 Birch Ridge Dr., Raleigh NC, 27610

2012 STANDARD SPECIFICATIONS

RIGHT OF WAY DATE:
NOVEMBER 26, 2013

LETTING DATE:
DECEMBER 15, 2015

KEVIN E. MOORE, PE
PROJECT ENGINEER

STEVEN D. KENDALL, PE
PROJECT DESIGN ENGINEER

HYDRAULICS ENGINEER

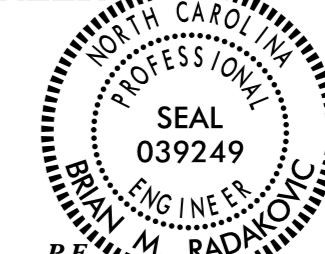

DocuSigned by:
Brian M. Radakovic
SIGNATURE: 11/19/2015

ROADWAY DESIGN ENGINEER



DocuSigned by:
Steven D. Kendall
SIGNATURE: 11/19/2015

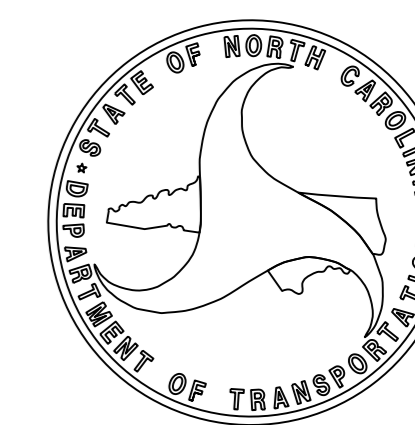

19-NOV-2015 07:36
R:\Roadway\Proj\B-3868_Rdy_Tsh.dgn
\$\$\$\$\$USERNAME\$\$\$\$\$