

PROJ. REFERENCE NO.	SHEET NO.
W-5519	PMP-23

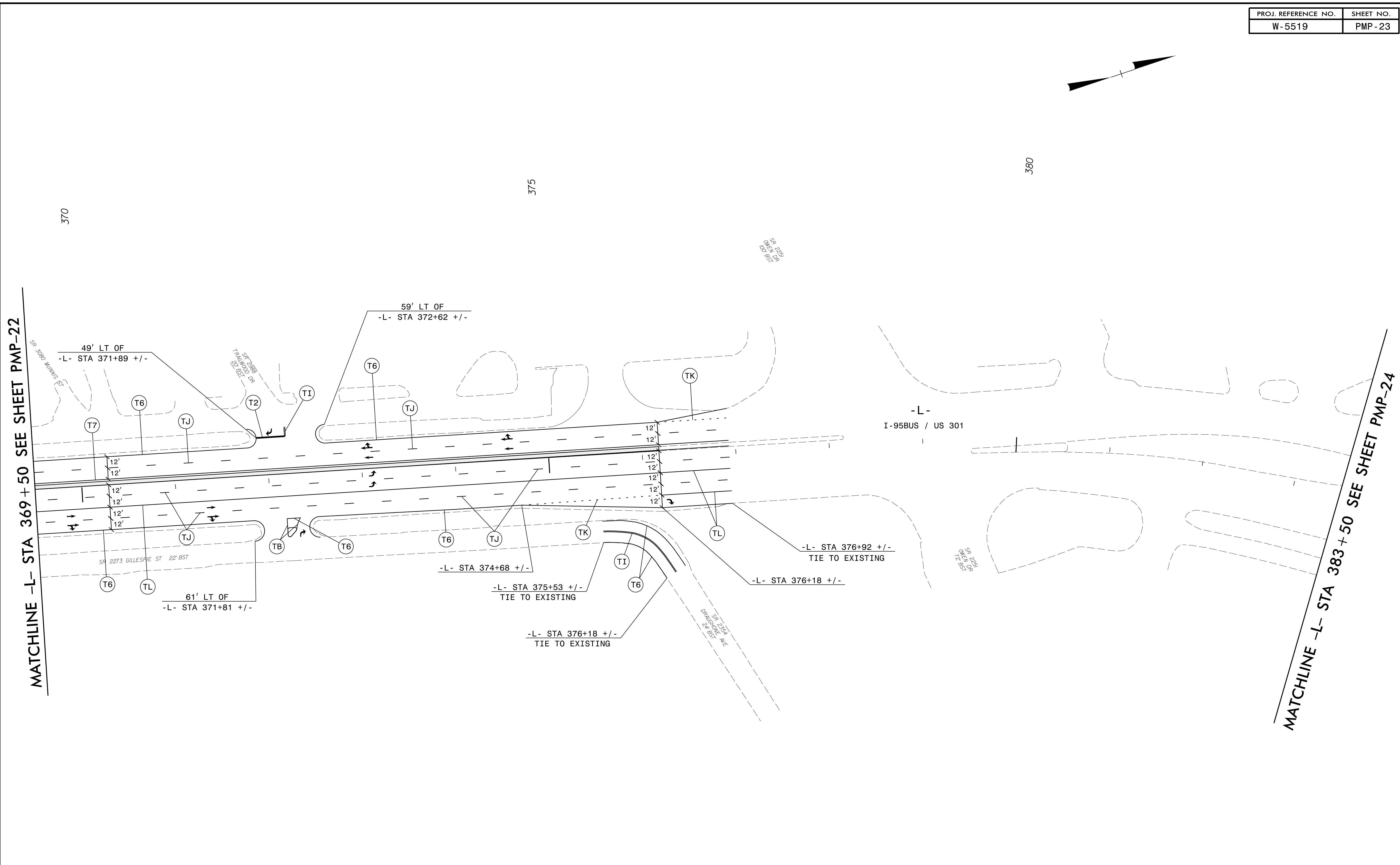
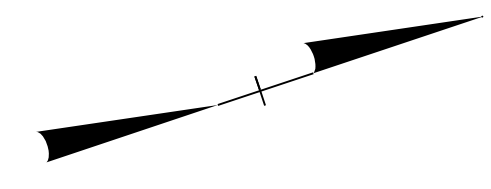

9/10/2015  
 P:\8467\Cadd\W5519\Traffic\Signing\CADD\W5519\_pmp.pmp-23.dgn  
 thufman

**mo** moffatt & nichol  
 1616 EAST MILLBROOK ROAD, SUITE 160  
 RALEIGH, NORTH CAROLINA 27609  
 (919) 781-4626 VOICE (919) 781-4869 FAX

APPROVED: DATE: 9/10/2015

SEAL:

**FINAL PAVEMENT MARKING PLANS**