

SECTION 3 200+25 +/- TO 229+50 +/-

PROJ. REFERENCE NO. W-5519	SHEET NO. TMP-12
<b style="font-size: 10px;">RAMEY KEMP ASSOCIATES, INC. <small>Transportation Engineers 5808 Farington Place, Suite 100 Raleigh, North Carolina 27609 919-872-5115 Tel. 919-878-5416 Fax. www.rameykemp.com NC License No. C-3910</small>	

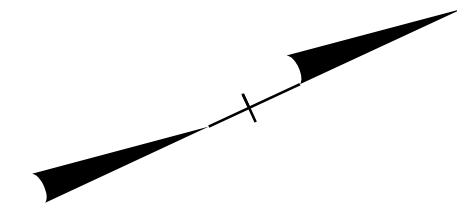

■ CONSTRUCTION

NOTE: MAINTAIN ACCESS TO NEARBY CROSSOVER WITHIN 1 MILE OF WORK AREA AT ALL TIMES.

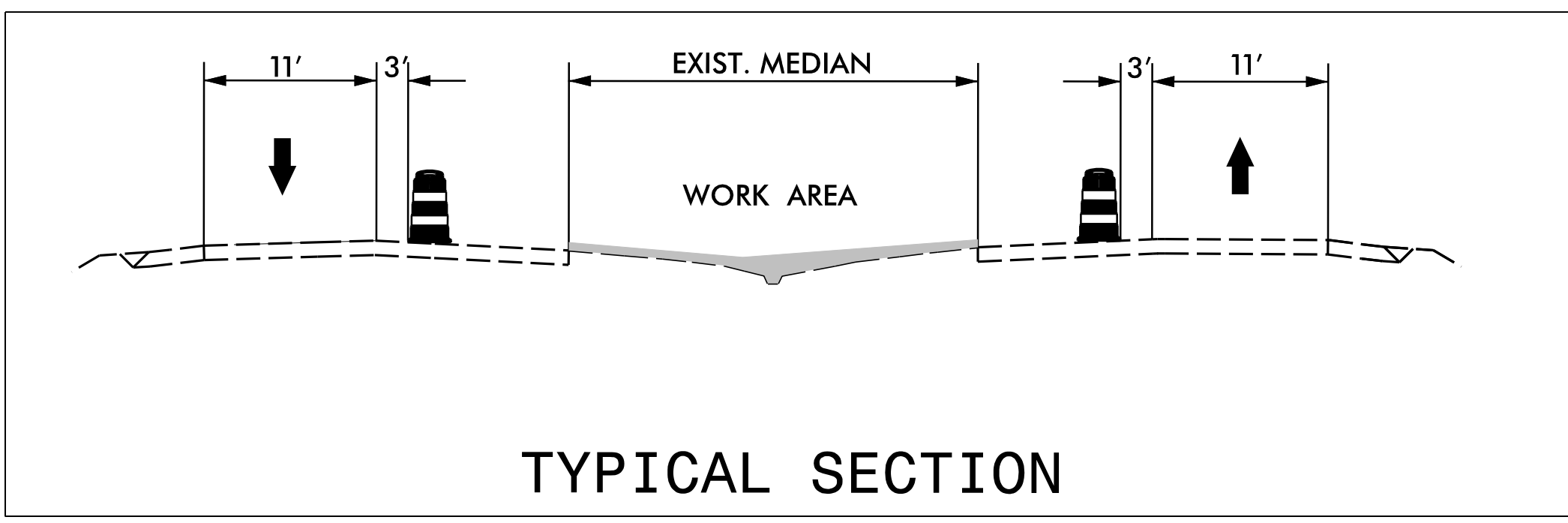
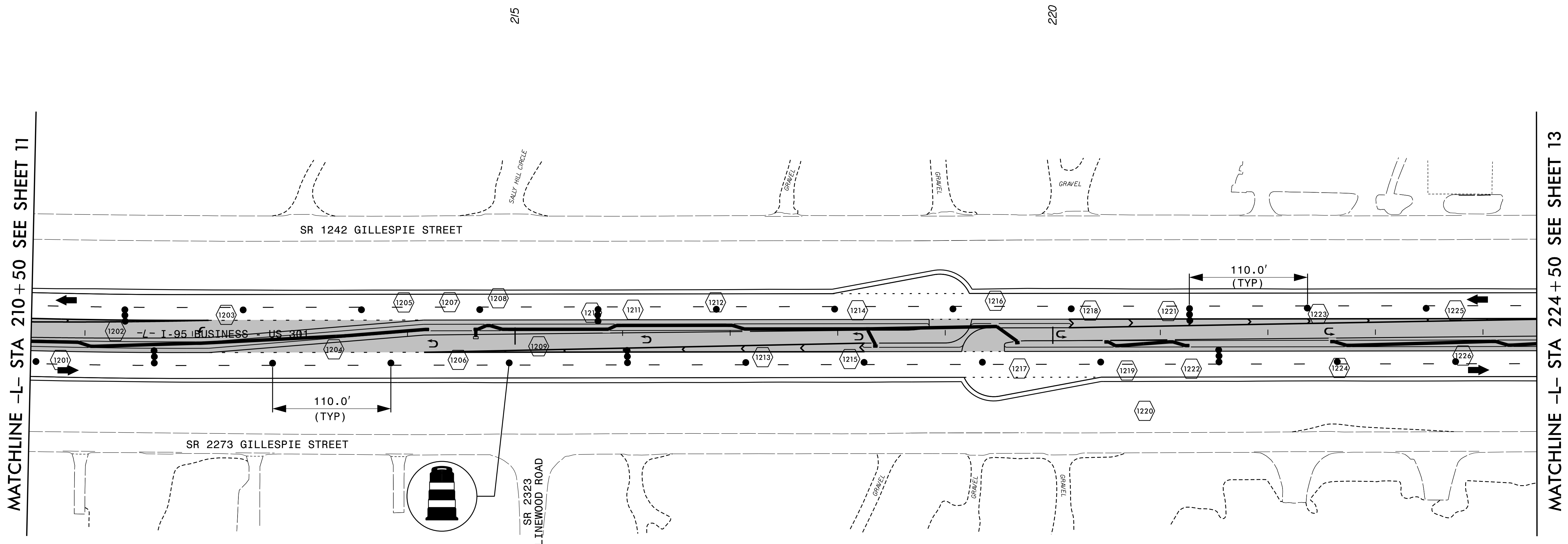

APPROVED: <i>Merrick A. Dugal</i> DATE: 9/9/2015	PHASE II	
	SCALE: 1"=50'	Prepared For:
	DATE:	REVISIONS
	DEVELOPED BY: DAJ	CADD FILE
	REVIEWED BY: MAD	RKA PROJ. #: 14071