

8/17/99

PROJECT REFERENCE NO. W-5519	SHEET NO. 13
RW SHEET NO.	
ROADWAY DESIGN ENGINEER T. R. REID SEAL 015869 9/9/2015	HYDRAULICS ENGINEER T. R. REID SEAL 026696 9/10/2015
 1616 EAST MILLBROOK ROAD, SUITE 160 RALEIGH, NORTH CAROLINA 27609 (919) 781-4626 VOICE (919) 781-4869 FAX	

-L-

PI Sta 229+66.62
 $\Delta = 1^{\circ}04'44.6" (LT)$
 $D = 1^{\circ}02'30.3"$
 $L = 103.58'$
 $T = 51.79'$
 $R = 5,500.00'$

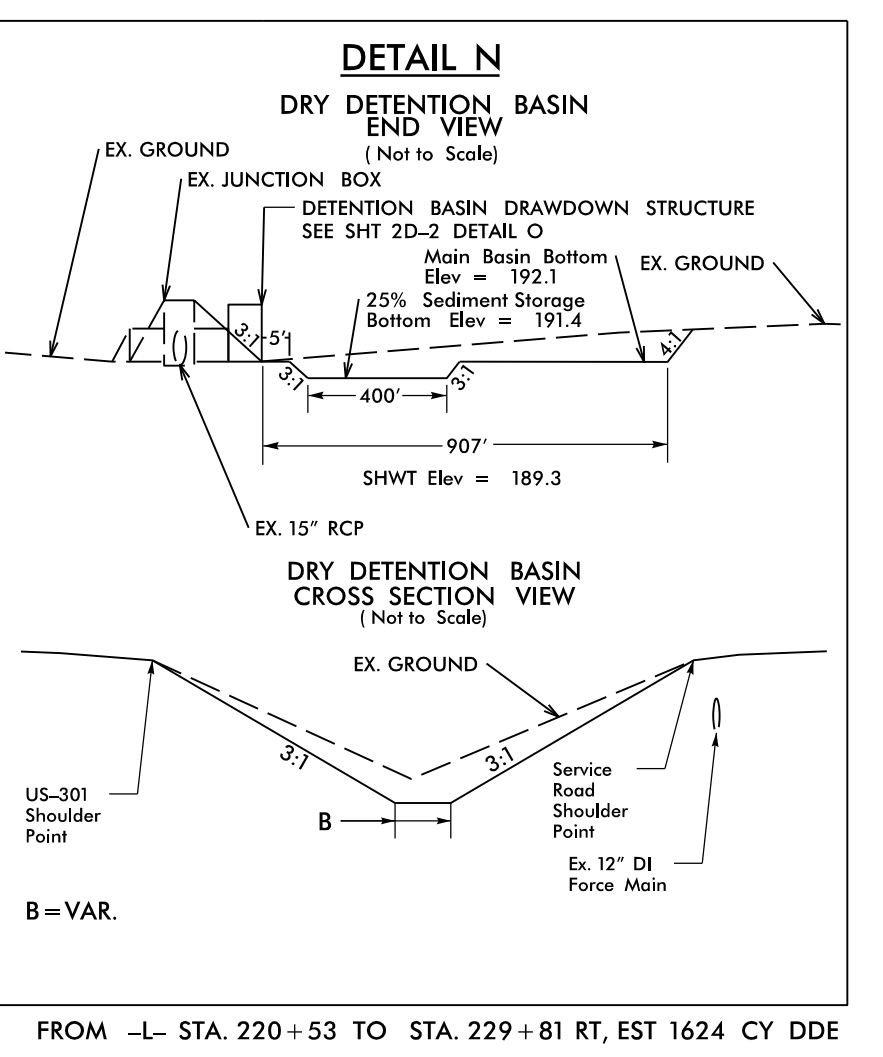
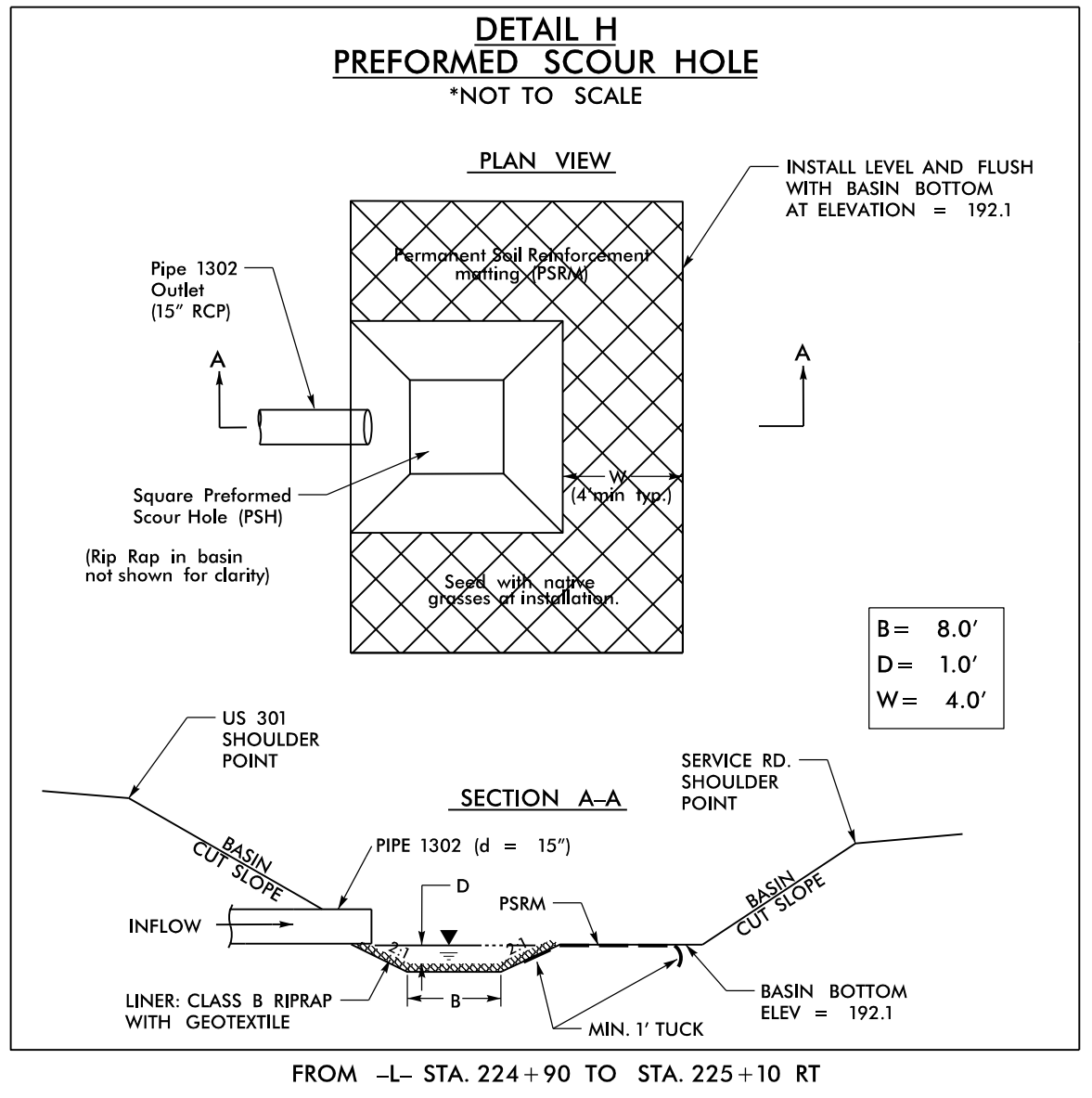
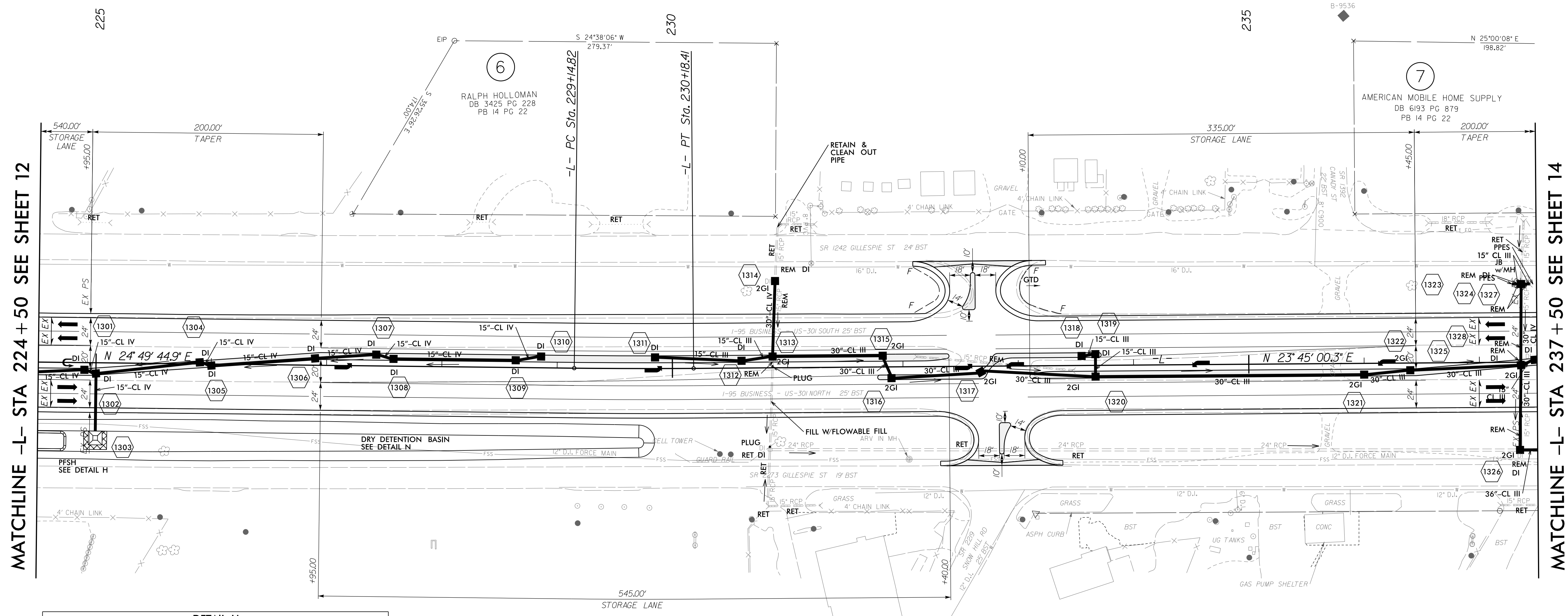
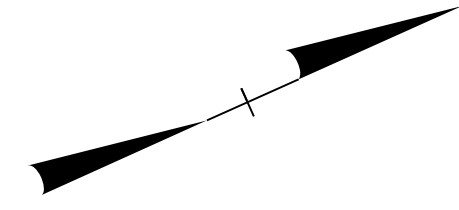

FOR -L- PROFILE SEE SHEETS 32 & 33 (FOR DITCH GRADES ONLY)
 FOR DIRECTIONAL CROSSOVER AND MEDIAN U-TURNS SEE DETAIL #8 ON SHEET 2B-2
 FOR PROPOSED CURB ELEVATIONS TABLE SEE SHEET 2D

9/3/2015
 P:\8467\Cadd\W5519\Roadway\Proj\W-5519_rdy_psh_s13.dgn
 c:\users\j\appdata\local\temp\msoffice\13