

8/17/99

-L-
 PI Sta 211+36.17
 $\Delta = 1' 20' 34.9" (LT)$
 $D = 1' 08' 45.3"$
 $L = 117.20'$
 $T = 58.60'$
 $R = 5,000.00'$

PROJECT REFERENCE NO. W-5519	SHEET NO. 12
RW SHEET NO.	
ROADWAY DESIGN ENGINEER T. R. REID SEAL 015869 9/29/2015	HYDRAULICS ENGINEER T. R. REID SEAL 026696 9/10/2015
 1616 EAST MILLBROOK ROAD, SUITE 160 RALEIGH, NORTH CAROLINA 27609 (919) 781-4626 VOICE (919) 781-4869 FAX	

MATCHLINE -L- STA 210+50 SEE SHEET 11

MATCHLINE -L- STA 224+50 SEE SHEET 13

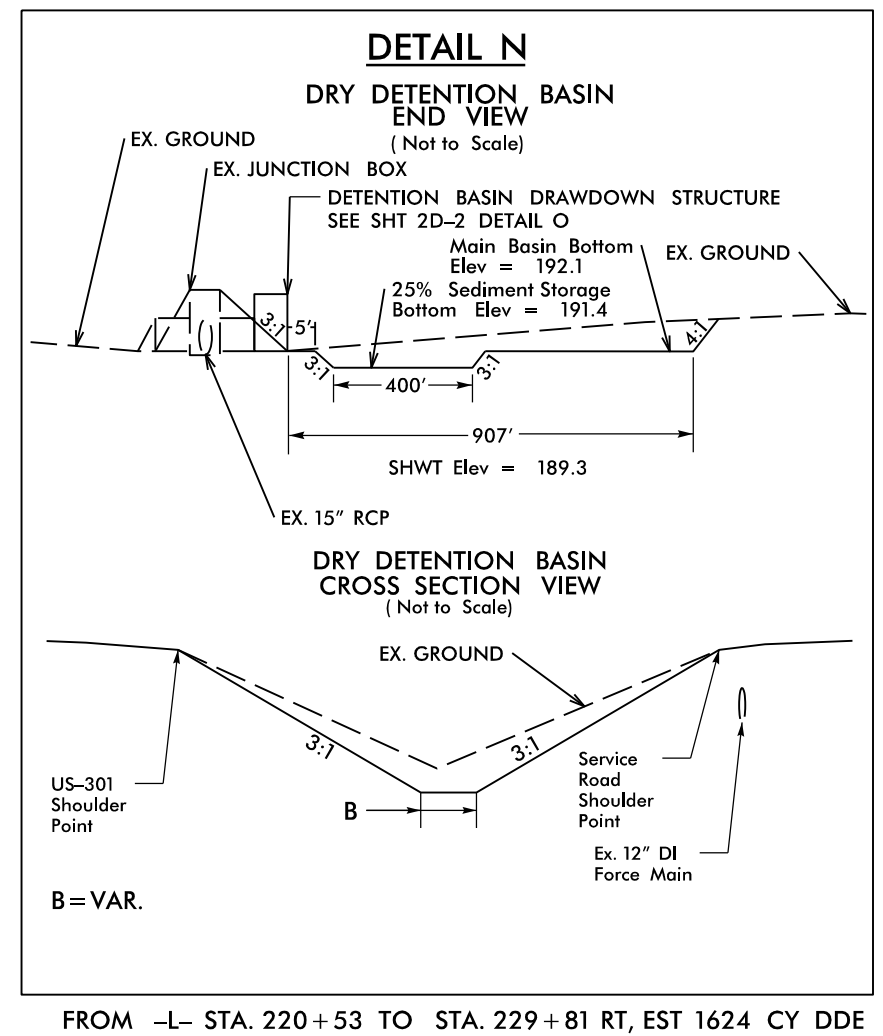
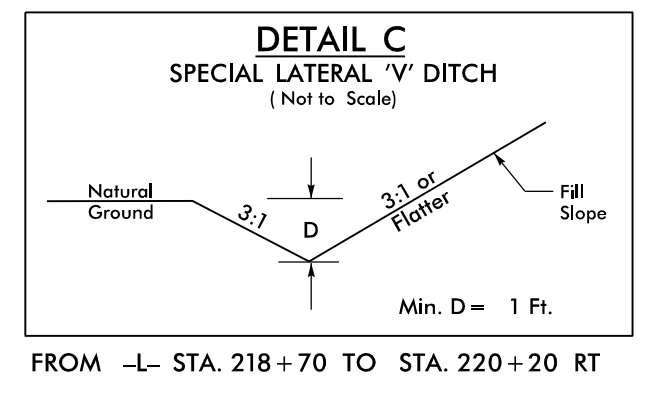
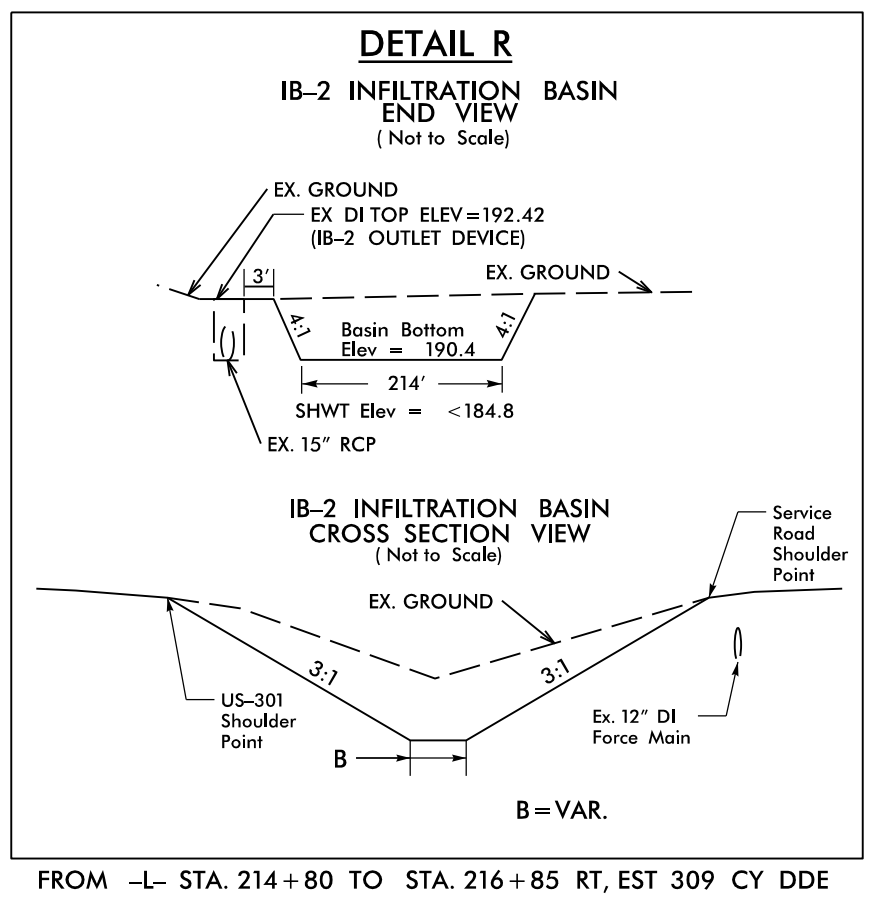
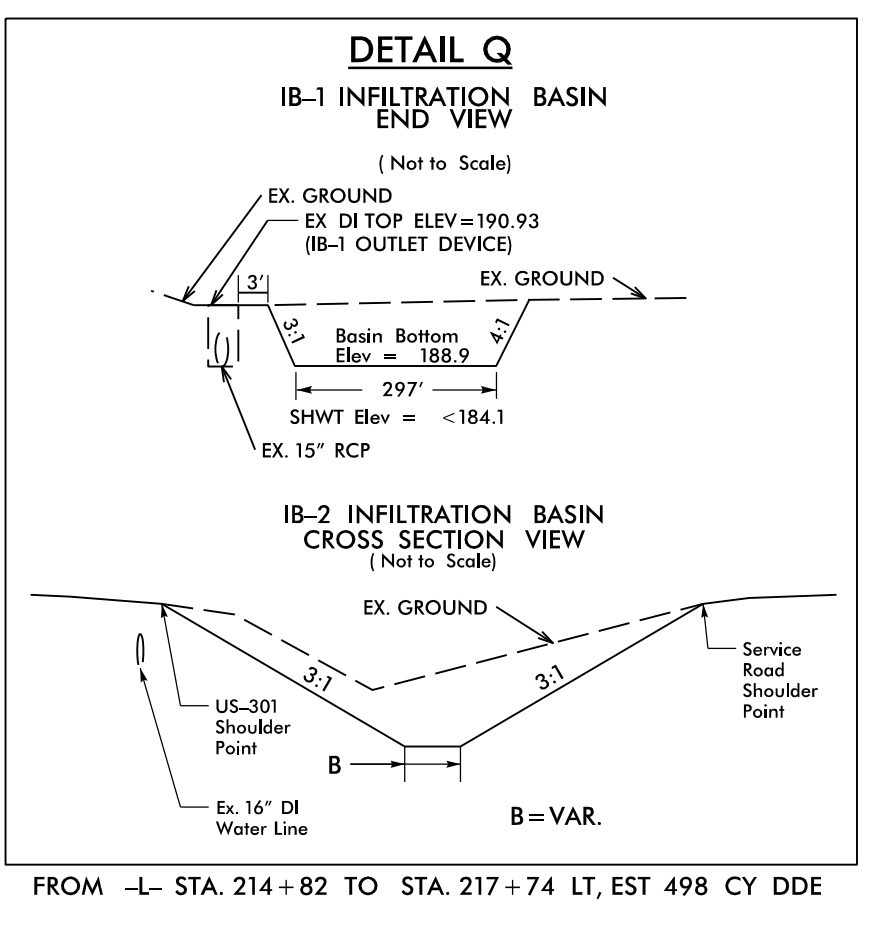
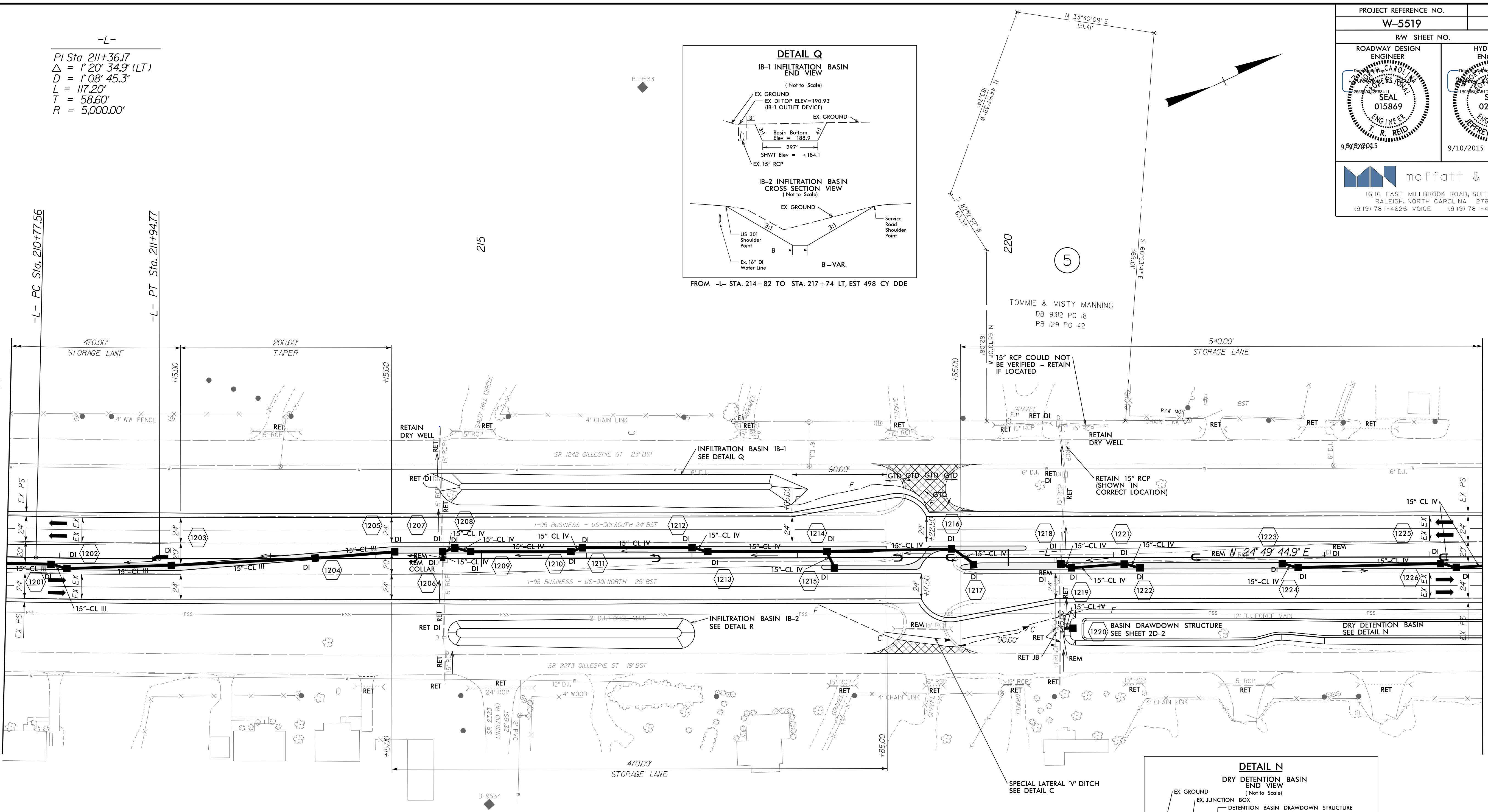

FOR -L- PROFILE SEE SHEET 32 (FOR DITCH GRADES ONLY)
 FOR DIRECTIONAL CROSSOVER AND MEDIAN U-TURNS
 SEE DETAIL #7 ON SHEET 2B-2
 FOR PROPOSED CURB ELEVATIONS TABLE SEE SHEET 2D

9/3/2015
 P:\3467\Cadd\W5519\Roadway\Proj\W-5519_rdy_psh_s12.dgn
 c:\cadd\cadd