

8/17/99

PROJECT REFERENCE NO. W-5519	SHEET NO. 11
RW SHEET NO.	
ROADWAY DESIGN ENGINEER SEAL 015869 T. REID	HYDRAULICS ENGINEER SEAL 026696 J. REID
9/9/2015	9/10/2015
1616 EAST MILLBROOK ROAD, SUITE 160 RALEIGH, NORTH CAROLINA 27609 (919) 781-4626 VOICE (919) 781-4869 FAX	

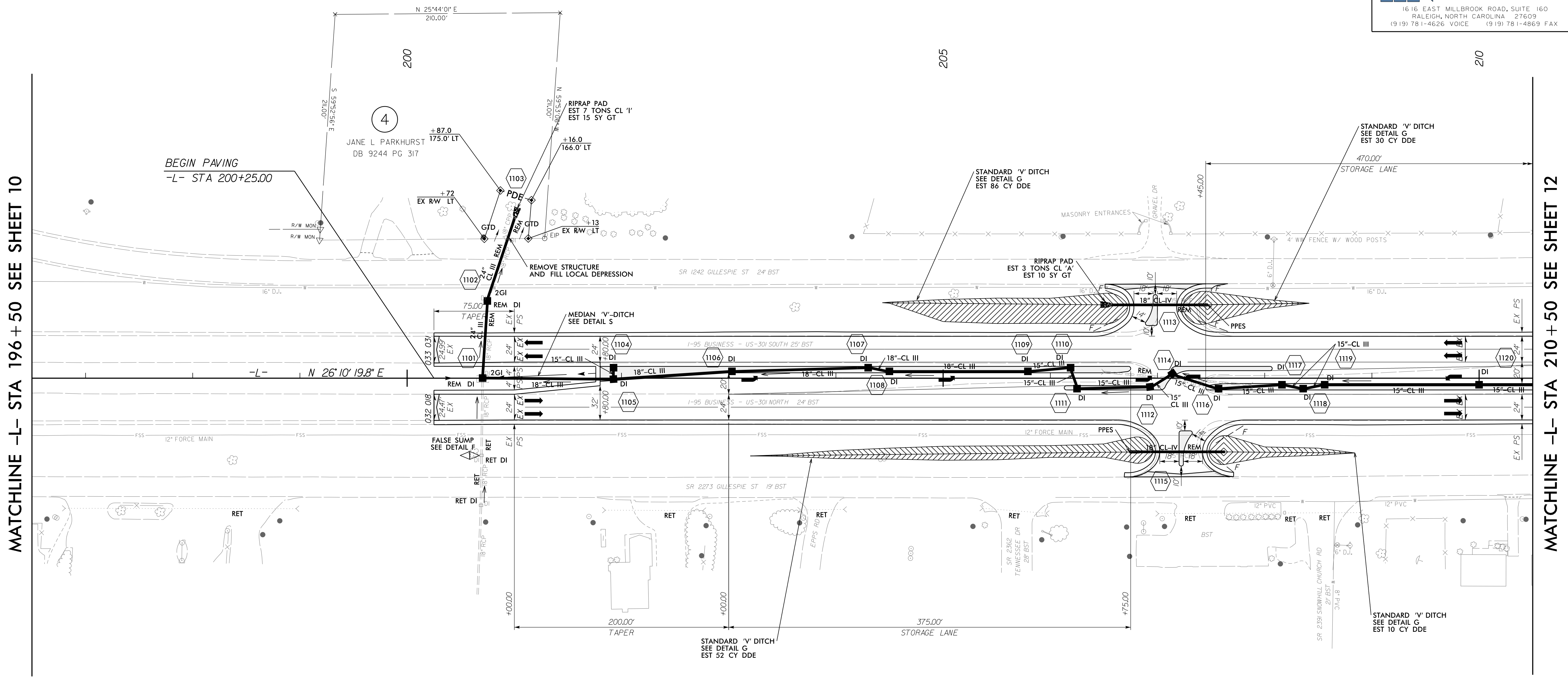
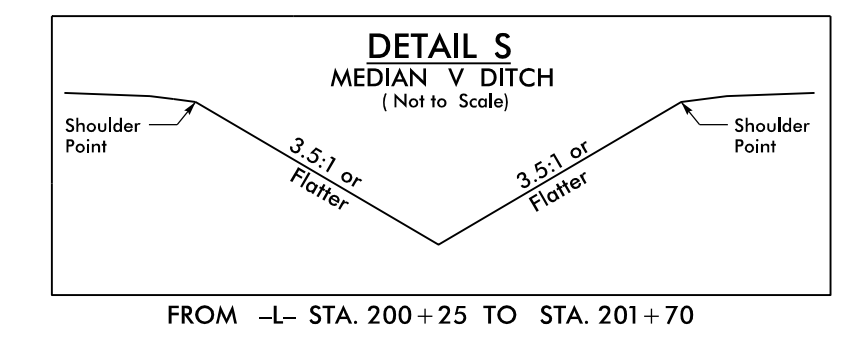
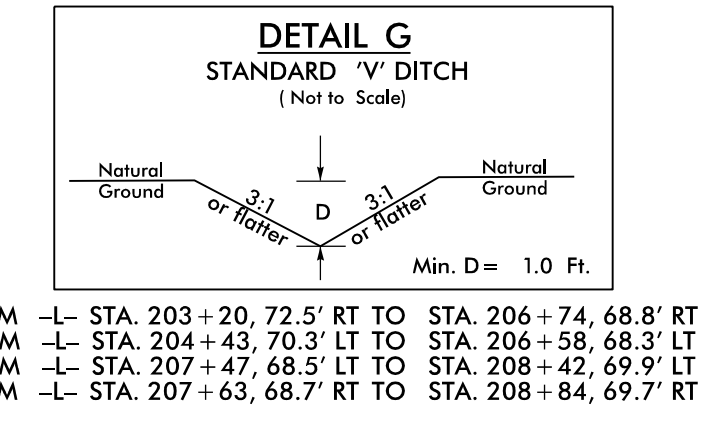
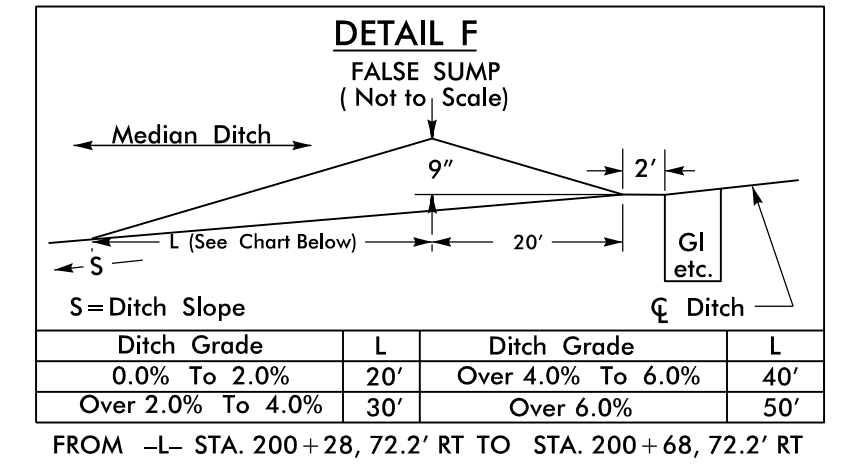

FOR -L- PROFILE SEE SHEETS 31 & 32 (FOR DITCH GRADES ONLY)
 FOR DIRECTIONAL CROSSOVER AND MEDIAN U-TURNS
 SEE DETAIL #6 ON SHEET 2B-2
 FOR PROPOSED CURB ELEVATIONS TABLE SEE SHEET 2D

P:\3\2015\Cadd\W5519\Roadway\Proc\W-5519_rdy_psh.s11.dgn
 8/17/99
 11