

W-5519 SURVEY CONTROL SHEET

BASELINE DATA

BL POINT	DESC.	NORTH	EAST	ELEVATION	L STATION	OFFSET
1	BL-9501	435297.9926	2020411.2960	169.60	OUTSIDE PROJECT LIMITS	
2	BL-9502	433424.2663	2022609.9660	159.80	OUTSIDE PROJECT LIMITS	
3	BL-9503	439447.4112	2022623.4240	116.14	129+30.61	511.68 LT.
4	BL-9504	439080.1125	2023100.6110	117.07	129+03.53	89.81 RT.
5	BL-9505	441454.1512	2024663.4940	89.51	157+66.08	92.51 LT.
6	BL-9506	441156.4491	2025333.4160	99.57	157+86.95	640.23 RT.
7	BL-9507	450267.5784	2028293.3840	177.60	253+50.14	436.38 LT.
8	BL-9508	450152.7080	2028900.9150	175.81	254+15.90	179.13 RT.
9	BL-9509	452377.3989	2029030.5550	176.89	276+18.87	111.22 LT.
10	BL-9510	452209.4921	2029218.2850	174.49	275+54.91	132.39 RT.
11	BL-9511	455271.9900	2029742.2320	186.77	306+68.19	387.25 LT.
12	BL-9512	454910.3045	2030489.3990	179.26	304+93.97	425.28 RT.
13	BL-9513	457392.9719	2029842.4890	196.95	327+51.17	441.11 LT.
14	BL-9514	457282.6950	2030382.2570	191.94	327+87.30	108.38 RT.
15	BL-9515	459104.6160	2030594.2180	201.98	346+40.85	148.55 LT.
16	BL-9516	458620.9378	2030866.7850	200.77	341+82.13	164.2 RT.
17	BL-9517	460753.7488	2031519.5380	210.17	364+20.67	614.03 RT.
18	BL-9518	460909.7246	2030823.1570	205.92	364+49.92	99.03 LT.
19	BL-9519	463326.1395	2031243.3400	190.06	386+29.42	581.52 LT.
20	BL-9520	462910.3915	2031827.8090	190.47	387+61.01	120.17 RT.
21	BL-9521	467092.6500	2036108.5470	95.96	OUTSIDE PROJECT LIMITS	
22	BL-9522	466340.6924	2036771.2780	92.05	OUTSIDE PROJECT LIMITS	
23	BL-9523	463568.1420	2033282.1350	151.27	403+19.87	485.73 RT.
24	BL-9524	464319.7819	2033295.2200	160.88	407+88.27	102.47 LT.
25	BL-9525	465286.1751	2034583.6580	114.46	423+98.64	83.72 LT.
26	BL-9526	464860.2623	2034632.5940	114.75	421+77.97	283.83 RT.
27	BL-9527	461902.3560	2031167.7350	200.24	374+90.64	5.83 LT.
28	BL-9528	456392.7317	2030320.3810	192.16	318+66.27	128.05 RT.
29	BL-9529	453449.4587	2030204.1430	176.82	290+15.14	581.63 RT.
30	BL-9530	453698.5150	2029531.1620	181.76	290+55.57	134.82 LT.
31	BL-9531	444485.6338	2026749.1920	176.59	194+11.12	580.53 RT.
32	BL-9532	444700.2026	2026088.1180	173.40	193+12.11	107.41 LT.
33	BL-9533	446947.1920	2026800.9060	191.40	216+53.72	446.77 LT.
34	BL-9534	446528.5492	2027356.6950	194.06	215+07.16	233.44 RT.
35	BL-9535	448028.6385	2028126.7120	195.43	231+86.19	306.56 RT.
36	BL-9536	448637.9467	2027730.6080	196.97	235+84.36	301.40 LT.
37	BL-9537	442887.5840	2025279.3990	92.43	173+32.33	66.25 LT.
38	BL-9538	440184.6350	2023970.5550	99.58	143+15.98	87.48 RT.
39	BL-9539	436410.5466	2021896.5730	156.70	OUTSIDE PROJECT LIMITS	
40	BL-9540	436700.1213	2021438.8100	157.32	100+08.71	216.15 LT.
41	BL-9541	437835.6525	2022298.9270	137.22	114+17.25	3.47 LT.
42	BL-9542	451147.9337	2028766.8030	151.35	263+69.17	12.46 LT.
43	BL-9543	459745.9641	2030855.3250	214.09	353+02.09	57.02 RT.
44	BL-9544	463665.5710	2031676.3200	190.57	391+05.83	569.85 LT.
300208	NCGS BAR	439347.0415	2023259.4160	114.83	132+17.70	54.56 RT.
30024	NCGS MILLAN	446968.6165	2027299.0480	194.58	218+82.31	3.67 LT.
30030	NCGS CORAL	449108.1078	2028354.5960	192.36	242+65.98	80.39 RT.
30033	NCGS CHARLES	434959.2372	2020580.7550	182.58	OUTSIDE PROJECT LIMITS	
30045	NCGS SYCAMORE	453870.6291	2029643.3450	181.83	292+53.00	78.14 LT.
30058	NCGS CITIZEN	459759.5616	2030743.2640	211.55	353+06.05	55.81 LT.
30077	NCGS CUM 107	466965.5954	2036727.3470	109.20	OUTSIDE PROJECT LIMITS	

BENCHMARK DATA

.....
 BM1 ELEVATION = 182.92
 N 454891 E 2029900
 L STATION 303+04.00 132 LEFT
 BM1

 BM2 ELEVATION = 199.60
 N 461881 E 2031066
 L STATION 374+44.00 98 LEFT
 BM2

 BM3 ELEVATION = 200.92
 N 461659 E 2031007
 L STATION 372+14.00 99 LEFT
 BM3

 BM4 ELEVATION = 151.29
 N 464009 E 2033252
 L STATION 405+64.00 118 RIGHT
 BM4

 BM5 ELEVATION = 207.96
 N 461384 E 2031137
 L STATION 369+82.00 97 RIGHT
 BM5

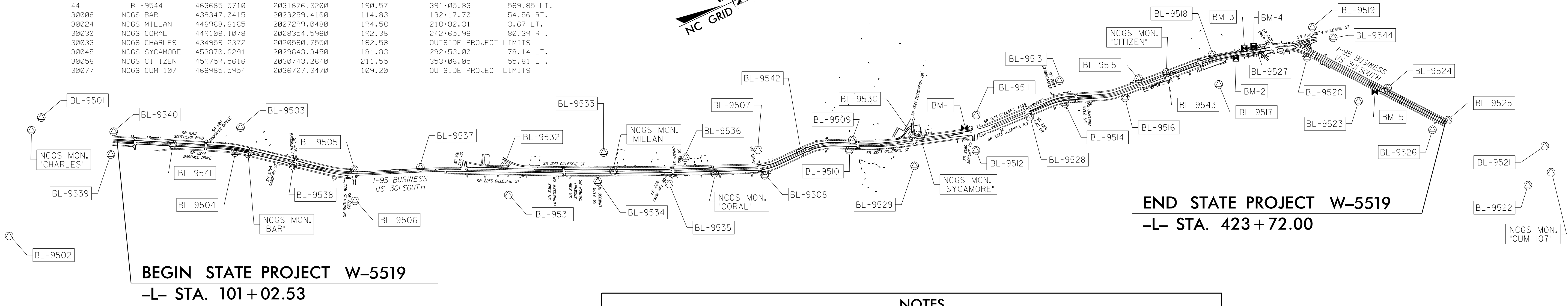
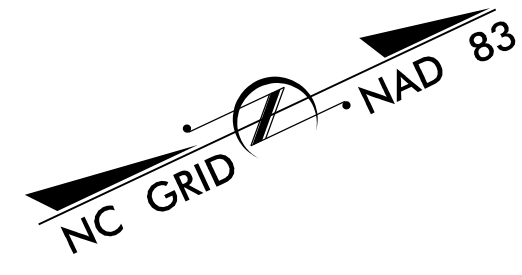

BEGIN STATE PROJECT W-5519
 -L- STA. 101+02.53

END STATE PROJECT W-5519
 -L- STA. 423+72.00

NOTES

- THE CONTROL DATA FOR THIS PROJECT CAN BE FOUND ELECTRONICALLY BY SELECTING PROJECT CONTROL DATA AT:
[HTTP://WWW.DOH.DOT.STATE.NC.US/PRECONSTRUCT/HIGHWAY/LOCATION/PROJECT/](http://www.doh.dot.state.nc.us/preconstruct/highway/location/project/)
 THE FILES TO BE FOUND ARE AS FOLLOWS:
w5519_ls_control_150820.txt
 SITE CALIBRATION INFORMATION HAS NOT BEEN PROVIDED FOR THIS PROJECT. IF FURTHER INFORMATION IS NEEDED, PLEASE CONTACT THE LOCATION AND SURVEYS UNIT.
- ⊙ INDICATES GEODETIC CONTROL MONUMENTS USED OR SET FOR HORIZONTAL PROJECT CONTROL BY THE NCDOT LOCATION AND SURVEYS UNIT.
 PROJECT CONTROL ESTABLISHED USING GLOBAL POSITIONING SYSTEM FROM EXISTING HARN MONUMENTATION.

DATUM DESCRIPTION
 THE LOCALIZED COORDINATE SYSTEM DEVELOPED FOR THIS PROJECT IS BASED ON THE STATE PLANE COORDINATES ESTABLISHED BY NC GS FOR MONUMENT "B-9501"
 WITH NAD 83/NA 2011 STATE PLANE GRID COORDINATES OF
 NORTHING: 435297.993(±) EASTING: 2020411.296(±)
 ELEVATION: 169.30(±)
 THE AVERAGE COMBINED GRID FACTOR USED ON THIS PROJECT (GROUND TO GRID) IS: 0.999881565
 THE N.C. LAMBERT GRID BEARING AND LOCALIZED HORIZONTAL GROUND DISTANCE FROM "B-9501" TO -L- STATION 101+02.53 IS
 1871.0874' N 42° 25' 21" E
 ALL LINEAR DIMENSIONS ARE LOCALIZED HORIZONTAL DISTANCES
 VERTICAL DATUM USED IS NAVD 88

12/01/2005
 8/10/2015
 P:\8467\Cadd\W5519\Roadway\Proj\W-5519_LL.PSH_1C.dgn
 thurman