

**This electronic collection of documents is provided
for the convenience of the user
and is Not a Certified Document –**

**The documents contained herein were originally issued
and sealed by the individuals whose names and license
numbers appear on each page, on the dates appearing
with their signature on that page.**

**This file or an individual page
shall not be considered a certified document.**

STATE OF NORTH CAROLINA
DIVISION OF HIGHWAYS

TRANSPORTATION MANAGEMENT PLAN

ALAMANCE COUNTY

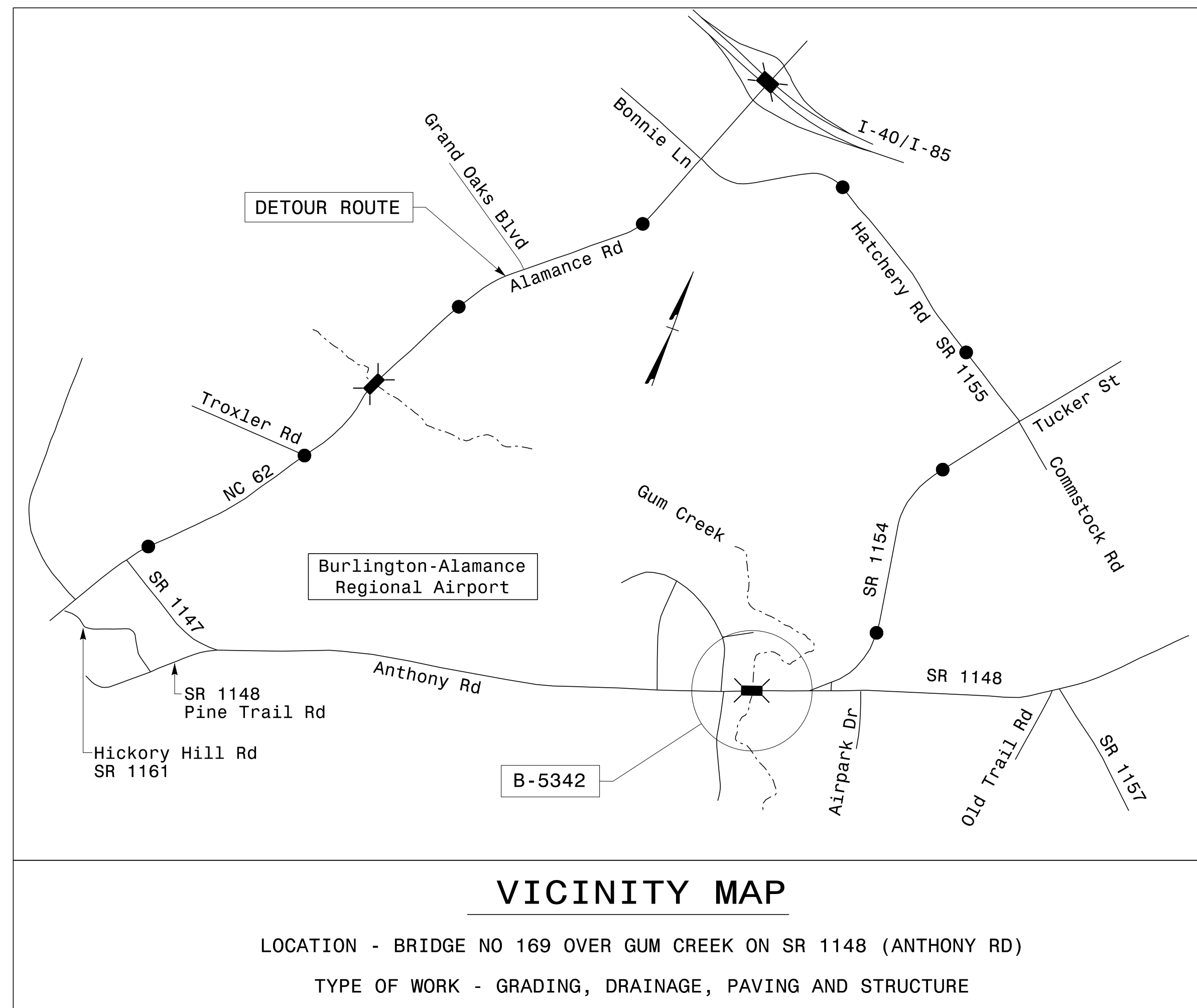
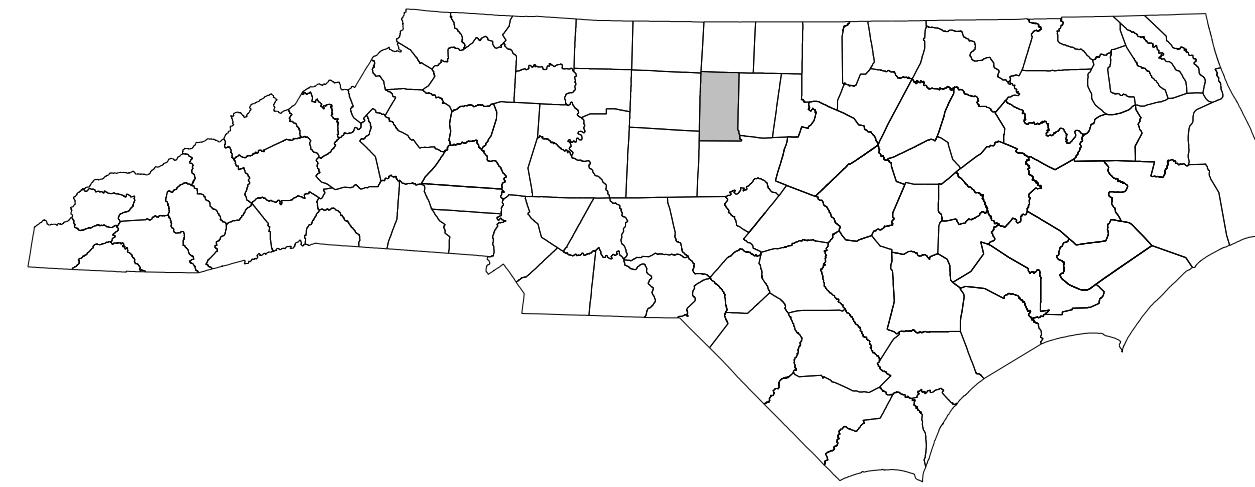

INDEX OF SHEETS	
SHEET NO.	TITLE
TMP-1	TITLE SHEET, VICINITY MAP, AND INDEX OF SHEETS
TMP-1A	LIST OF APPLICABLE ROADWAY STANDARD DRAWINGS AND LEGEND
TMP-1B	TRANSPORTATION OPERATIONS PLAN: (MANAGEMENT STRATEGIES, LOCAL NOTES, PHASING, AND GENERAL NOTES)
TMP-2	SPECIAL SIGN DESIGN
TMP-3	STEPS 2 AND 3
TMP-4	OFF SITE DETOUR ROUTE

8/20/2015 R:\TIP\Projects-B\B5342\TrafficControl\TCP\B5342_TC_TMP01.dgn User:derichardson

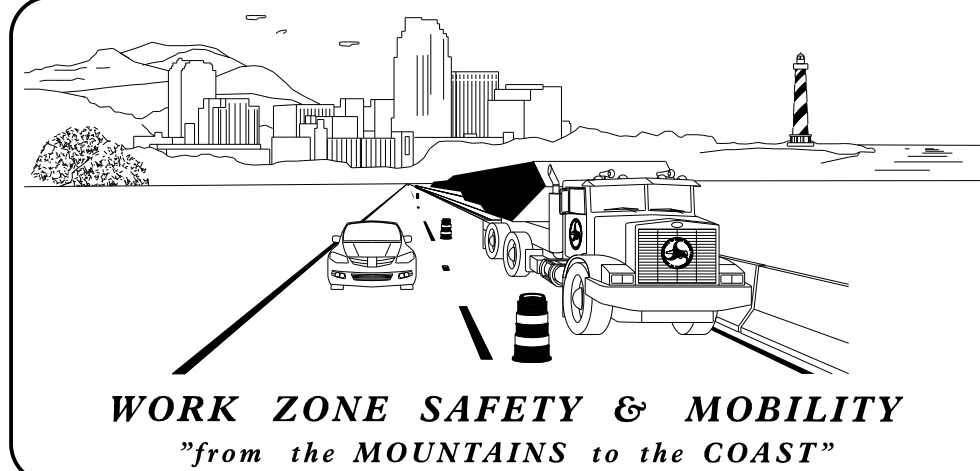

N.C.D.O.T. WORK ZONE TRAFFIC CONTROL
1561 MAIL SERVICE CENTER (MSC) RALEIGH, NC 27699-1561
750 N. GREENFIELD PARKWAY, GARNER, NC 27529 (DELIVERY)
PHONE: (919) 773-2800 FAX: (919) 771-2745

J. S. BOURNE, PE STATE TRAFFIC MANAGEMENT ENGINEER
D. W. BISSETTE, PE TRAFFIC CONTROL PROJECT ENGINEER 8/27/2015
H. SHYU, PE TRAFFIC CONTROL PROJECT DESIGN ENGINEER
D. E. RICHARDSON TRAFFIC CONTROL DESIGN ENGINEER

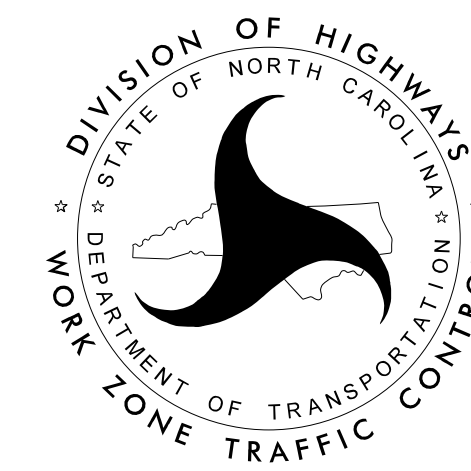

APPROVED: *David Bisette*
DATE: 8/27/2015

SEAL

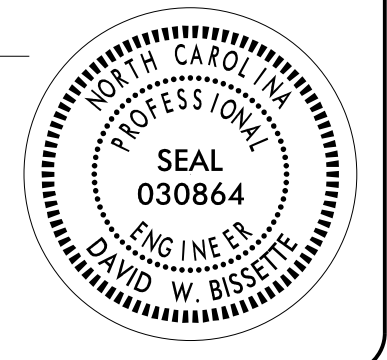

SHEET NO.
TMP-1

B-5342

TIP PROJECT:

ROADWAY STANDARD DRAWINGS

THE FOLLOWING ROADWAY STANDARDS AS SHOWN IN "ROADWAY STANDARD DRAWINGS" - PROJECT SERVICES UNIT - N.C. DEPARTMENT OF TRANSPORTATION - RALEIGH, N.C., DATED JANUARY 2012 ARE APPLICABLE TO THIS PROJECT AND BY REFERENCE HEREBY ARE CONSIDERED A PART OF THESE PLANS:

STD. NO.	TITLE
1101.01	WORK ZONE ADVANCE WARNING SIGNS
1101.02	TEMPORARY LANE CLOSURES
1101.03	TEMPORARY ROAD CLOSURES
1101.04	TEMPORARY SHOULDER CLOSURES
1101.05	WORK ZONE VEHICLE ACCESSES
1101.11	TRAFFIC CONTROL DESIGN TABLES
1110.01	STATIONARY WORK ZONE SIGNS
1110.02	PORTABLE WORK ZONE SIGNS
1130.01	DRUM
1145.01	BARRICADES
1150.01	FLAGGING DEVICES

LEGEND

GENERAL

- DIRECTION OF TRAFFIC FLOW
- DIRECTION OF PEDESTRIAN TRAFFIC FLOW
- EXIST. PVMT.
- NORTH ARROW
- PROPOSED PVMT.
- TEMP. SHORING (LOCATION PURPOSES ONLY)



SIGNALS

- EXISTING
- PROPOSED
- TEMPORARY

PAVEMENT MARKINGS

- EXISTING LINES
- TEMPORARY LINES

TRAFFIC CONTROL DEVICES

- BARRICADE (TYPE III)
- CONE
- DRUM
- SKINNY DRUM
- TUBULAR MARKER
- TEMPORARY CRASH CUSHION
- FLASHING ARROW BOARD
- FLAGGER
- LAW ENFORCEMENT
- TRUCK MOUNTED ATTENUATOR (TMA)
- CHANGEABLE MESSAGE SIGN

TEMPORARY SIGNING

- PORTABLE SIGN
- STATIONARY SIGN
- STATIONARY OR PORTABLE SIGN

PAVEMENT MARKERS

- CRYSTAL/CRYSTAL
- CRYSTAL/RED
- YELLOW/YELLOW

PAVEMENT MARKING SYMBOLS

- PAVEMENT MARKING SYMBOLS

8/20/2015
R:\p\Projects-B\B5342\TrafficControl\TCP\B5342_TC_TWP01A.dgn
User: dertcharadson

APPROVED: <i>David Bisette</i> <small>ECCDC080C875548C...</small> DATE: 8/27/2015 SEAL		
ROADWAY STANDARD DRAWINGS & LEGEND		

GENERAL NOTES

CHANGES MAY BE REQUIRED WHEN PHYSICAL DIMENSIONS IN THE DETAIL DRAWINGS, STANDARD DETAILS, AND ROADWAY DETAILS ARE NOT ATTAINABLE TO MEET FIELD CONDITIONS OR RESULT IN DUPLICATE OR UNDESIRE OVERLAPPING OF DEVICES. MODIFICATION MAY INCLUDE: MOVING, SUPPLEMENTING, COVERING, OR REMOVAL OF DEVICES AS DIRECTED BY THE ENGINEER.

THE FOLLOWING GENERAL NOTES APPLY AT ALL TIMES FOR THE DURATION OF THE CONSTRUCTION PROJECT EXCEPT WHEN OTHERWISE NOTED IN THE PLAN OR DIRECTED BY THE ENGINEER.

LANE AND SHOULDER CLOSURE REQUIREMENTS

- A) REMOVE LANE CLOSURE DEVICES FROM THE LANE WHEN WORK IS NOT BEING PERFORMED BEHIND THE LANE CLOSURE OR WHEN A LANE CLOSURE IS NO LONGER NEEDED OR AS DIRECTED BY THE ENGINEER.
- B) WHEN PERSONNEL AND/OR EQUIPMENT ARE WORKING WITHIN 15 FT OF AN OPEN TRAVEL LANE, CLOSE THE NEAREST OPEN SHOULDER USING ROADWAY STANDARD DRAWING NO. 1101.04 UNLESS THE WORK AREA IS PROTECTED BY BARRIER OR GUARDRAIL OR A LANE CLOSURE IS INSTALLED.
- C) WHEN PERSONNEL AND/OR EQUIPMENT ARE WORKING ON THE SHOULDER ADJACENT TO AN UNDIVIDED FACILITY AND WITHIN 5 FT OF AN OPEN TRAVEL LANE, CLOSE THE NEAREST OPEN TRAVEL LANE USING ROADWAY STANDARD DRAWING NO. 1101.02 UNLESS THE WORK AREA IS PROTECTED BY BARRIER OR GUARDRAIL.
- D) WHEN PERSONNEL AND/OR EQUIPMENT ARE WORKING WITHIN A LANE OF TRAVEL OF AN UNDIVIDED OR DIVIDED FACILITY, CLOSE THE LANE ACCORDING TO THE TRAFFIC CONTROL PLANS, ROADWAY STANDARD DRAWINGS, OR AS DIRECTED BY THE ENGINEER. CONDUCT THE WORK SO THAT ALL PERSONNEL AND/OR EQUIPMENT REMAIN WITHIN THE CLOSED TRAVEL LANE.
- E) DO NOT WORK SIMULTANEOUSLY WITHIN 15 FT ON BOTH SIDES OF AN OPEN TRAVELWAY, RAMP, OR LOOP WITHIN THE SAME LOCATION UNLESS PROTECTED WITH GUARDRAIL OR BARRIER.

PAVEMENT EDGE DROP OFF REQUIREMENTS

- F) BACKFILL AT A 6:1 SLOPE UP TO THE EDGE AND ELEVATION OF EXISTING PAVEMENT IN AREAS ADJACENT TO AN OPENED TRAVEL LANE THAT HAS AN EDGE OF PAVEMENT DROP-OFF AS FOLLOWS:

BACKFILL DROP-OFFS THAT EXCEED 2 INCHES ON ROADWAYS WITH POSTED SPEED LIMITS OF 45 MPH OR GREATER.

BACKFILL DROP-OFFS THAT EXCEED 3 INCHES ON ROADWAYS WITH POSTED SPEED LIMITS LESS THAN 45 MPH.

BACKFILL WITH SUITABLE COMPACTED MATERIAL, AS APPROVED BY THE ENGINEER, AT NO EXPENSE TO THE DEPARTMENT.

- G) DO NOT EXCEED A DIFFERENCE OF 2 INCHES IN ELEVATION BETWEEN OPEN LANES OF TRAFFIC FOR NOMINAL LIFTS OF 1.5 INCHES. INSTALL ADVANCE WARNING "UNEVEN LANES" SIGNS (W8-11) IN ADVANCE AND A MINIMUM OF EVERY HALF MILE THROUGHOUT THE UNEVEN AREA.

SIGNING

- H) INSTALL ADVANCE WORK ZONE WARNING SIGNS WHEN WORK IS WITHIN 40 FT FROM THE EDGE OF TRAVEL LANE AND NO MORE THAN THREE (3) DAYS PRIOR TO THE BEGINNING OF CONSTRUCTION.
- I) PROVIDE SIGNING AND DEVICES REQUIRED TO CLOSE THE ROAD ACCORDING TO THE ROADWAY STANDARD DRAWINGS AND TRAFFIC CONTROL PLANS.
PROVIDE SIGNING REQUIRED FOR THE OFF-SITE DETOUR ROUTE AS SHOWN IN THE TRAFFIC CONTROL PLANS.
- J) COVER OR REMOVE ALL SIGNS AND DEVICES REQUIRED TO CLOSE THE ROAD WHEN ROAD CLOSURE IS NOT IN OPERATION.
COVER OR REMOVE ALL SIGNS REQUIRED FOR THE OFF-SITE DETOUR WHEN THE DETOUR IS NOT IN OPERATION.
- K) ENSURE ALL NECESSARY SIGNING IS IN PLACE PRIOR TO ALTERING ANY TRAFFIC PATTERN.

TRAFFIC CONTROL DEVICES

- L) WHEN LANE CLOSURES ARE NOT IN EFFECT SPACE CHANNELIZING DEVICES IN WORK AREAS NO GREATER IN FEET THAN TWICE THE POSTED SPEED LIMIT (MPH) EXCEPT, 10 FT ON-CENTER IN RADII, AND 3 FT OFF THE EDGE OF AN OPEN TRAVELWAY. REFER TO STANDARD SPECIFICATIONS FOR ROADS AND STRUCTURES SECTIONS 1130 (DRUMS), 1135 (CONES) AND 1180 (SKINNY DRUMS) FOR ADDITIONAL REQUIREMENTS.

MANAGEMENT STRATEGIES



- CONSTRUCT CONNECTION FOR CITY OF BURLINGTON LIFT STATION WITH FLAGGERS.
- CLOSE SR 1148 (ANTHONY RD) AND DETOUR TRAFFIC OFF SITE.

LOCAL NOTES

- 1 - NOTIFY THE ENGINEER THIRTY (30) CALENDAR DAYS PRIOR TO ANY TRAFFIC PATTERN ALTERATION.
- 2 - THE NCDOT RESIDENT ENGINEER WILL NOTIFY THE ALAMANCE COUNTY EMERGENCY MANAGEMENT SERVICES DIRECTOR (336.570.6796) OF THE BRIDGE REMOVAL 30 DAYS PRIOR TO ROAD CLOSURE.
- 3 - THE NCDOT RESIDENT ENGINEER WILL NOTIFY THE ALAMANCE COUNTY SCHOOLS TRANSPORTATION DIRECTOR (336.570.6480) OF THE BRIDGE REMOVAL 30 DAYS PRIOR TO ROAD CLOSURE.

PHASING

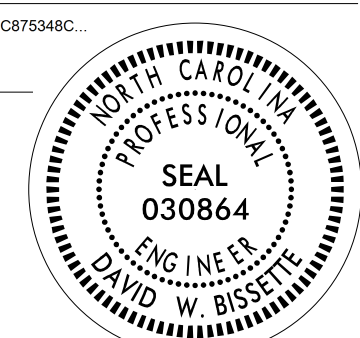
- STEP 1 - INSTALL ALL WORK ZONE ADVANCE WARNING SIGNS. SEE RSD 1101.01.
- STEP 2 - USING RSD 1101.02, SHEET 1 OF 15, CONSTRUCT PROPOSED ACCESS TO LIFT STATION FROM -L- 15+30+/- TO 15+60+/- (LEFT) AS SHOWN ON TMP-3.
- STEP 3 - USING RSD 1101.03, SHEETS 1 AND 2 OF 9, CLOSE SR 1148 (ANTHONY RD) AS SHOWN ON TMP-3 AND DETOUR TRAFFIC AS SHOWN ON TMP-4.
- STEP 4 - REMOVE EXISTING BRIDGE.
- STEP 5 - CONSTRUCT PROPOSED STRUCTURE AND ROADWAY.
- STEP 6 - OPEN SR 1148 (ANTHONY RD) TO TRAFFIC AND REMOVE ALL TRAFFIC CONTROL DEVICES.

APPROVED: <i>David Bisette</i> <small>ECDC980807546C...</small> DATE: 8/27/2015 SEAL			TRANSPORTATION OPERATIONS PLAN
---	---	---	---

SIGN NUMBER: WORK ZONE TYPE: STATIONARY QUANTITY: SEE PLANS SIGN WIDTH: 3'-6" HEIGHT: 1'-0" TOTAL AREA: 3.5 Sq.Ft. BORDER TYPE: INSET RECESS: 0.38" WIDTH: 0.44" RADII: 1.5" NO. Z BARS: LENGTH:	BACKG COLOR: Fluorescent Orange COPY COLOR: Black <table border="1"> <thead> <tr> <th>SYMBOL</th> <th>X</th> <th>Y</th> <th>WID</th> <th>HT</th> </tr> </thead> <tbody> <tr><td> </td><td> </td><td> </td><td> </td><td> </td></tr> <tr><td> </td><td> </td><td> </td><td> </td><td> </td></tr> <tr><td> </td><td> </td><td> </td><td> </td><td> </td></tr> <tr><td> </td><td> </td><td> </td><td> </td><td> </td></tr> <tr><td> </td><td> </td><td> </td><td> </td><td> </td></tr> <tr><td> </td><td> </td><td> </td><td> </td><td> </td></tr> <tr><td> </td><td> </td><td> </td><td> </td><td> </td></tr> <tr><td> </td><td> </td><td> </td><td> </td><td> </td></tr> <tr><td> </td><td> </td><td> </td><td> </td><td> </td></tr> </tbody> </table> MAT'L: 0.125" (3.2 mm) ALUMINUM	SYMBOL	X	Y	WID	HT																																														DESIGN BY: A. Kidd PROJECT ID: B-5342	CHECKED BY: R. Roach LOCATION: Alamance County	JUL 13, 2015 DIV: 7
	SYMBOL	X	Y	WID	HT																																																	
<p style="text-align: center;">3'-6"</p> <p style="text-align: center;">1'-0"</p> <p style="text-align: center;">3.5"</p> <p style="text-align: center;">5" C</p> <p style="text-align: center;">3.5"</p> <p style="text-align: center;">3.45" 35.3" 3.45"</p> <p style="text-align: center;">BORDER R=1.5" TH=0.44" IN=0.38"</p>																																																						
USE NOTES: 1,2 1. Legend and border shall be direct applied black non-reflective sheeting. 2. Background shall be NC Grade B fluorescent orange retroreflective sheeting.																																																						
Spacing Factor is 1 unless specified otherwise																																																						

LETTER POSITIONS

Letter spacings are to start of next letter													Series/Size	
A	N	T	H	O	N	Y	R	D					Text Length	
3.4	3.9	3.5	3.3	3.8	3.9	3.5	3.2	3.8	3.6	2.8	3.3			C 2000
														35.3

FILENAME: WZTC_SignDesign_AnthonyRd

NORTH CAROLINA D.O.T. SIGN DETAIL

8/13/2015 R:\TIP\Projects-B\B5342\TrafficControl\TCP\B5342_TC_TWP02_sign_dsn.dgn User:derlchardson

APPROVED *Ron King*
13E7A7FB8A4448
 DATE: 8/13/2015

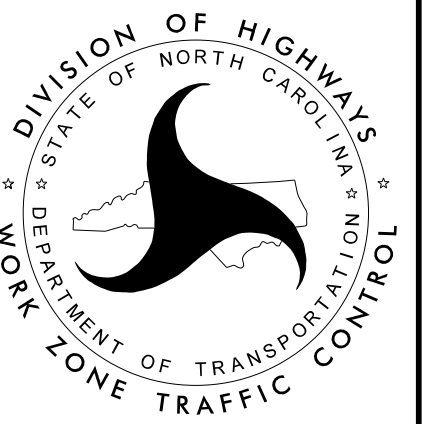

SPECIAL SIGN DESIGN

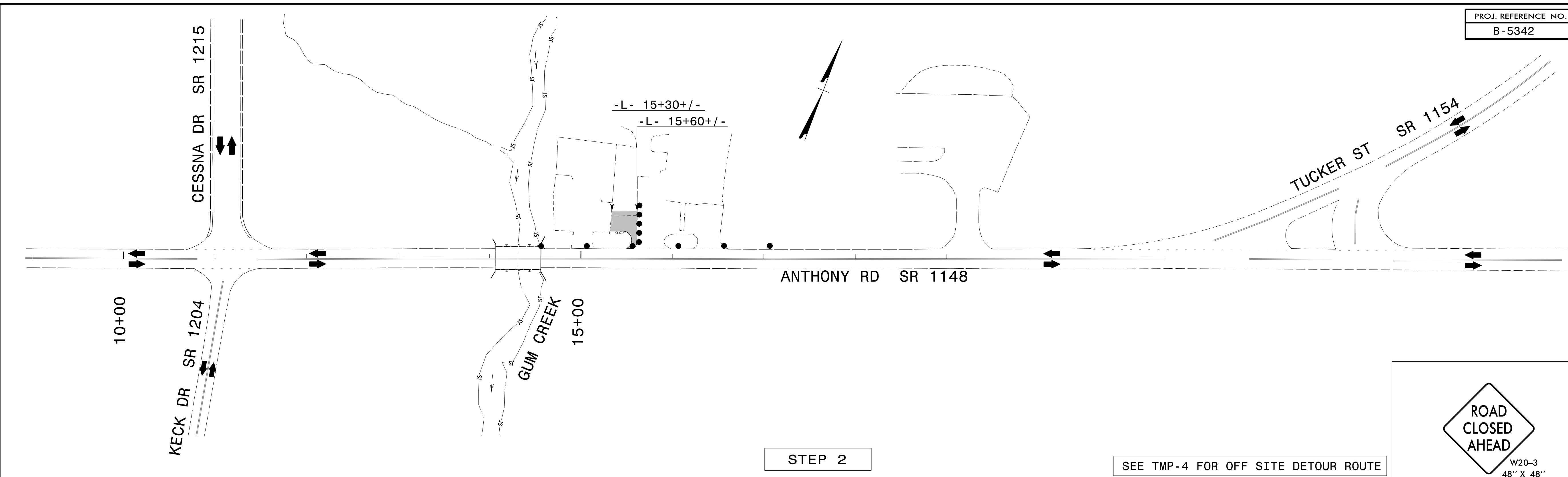

STEP 2

SEE TMP-4 FOR OFF SITE DETOUR ROUTE

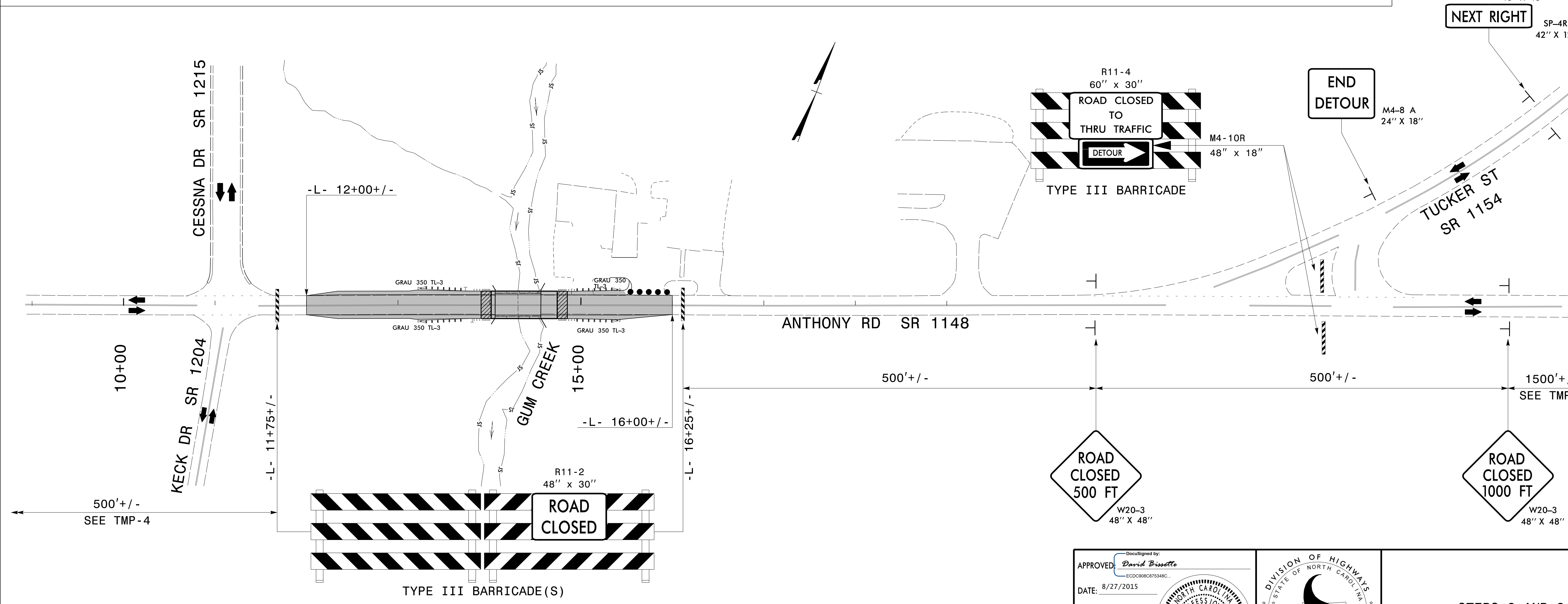

STEP 3

APPROVED: *David Bisette*
EDCD908C87534BC
 DATE: 8/27/2015

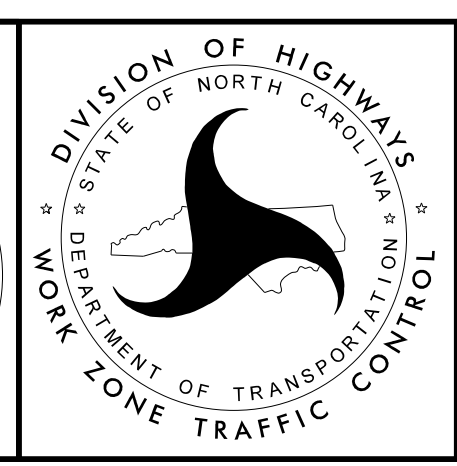
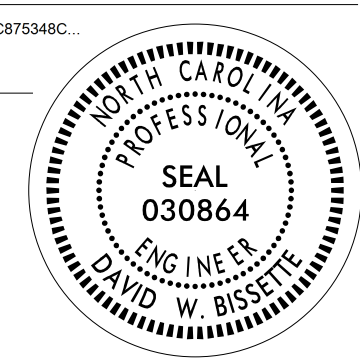

STEPS 2 AND 3

8/20/2015
 R:\TIP\Projects-B\B5342\TrafficControl\TCP\B5342_TC_TMP03_details.dgn
 User:dercharlson

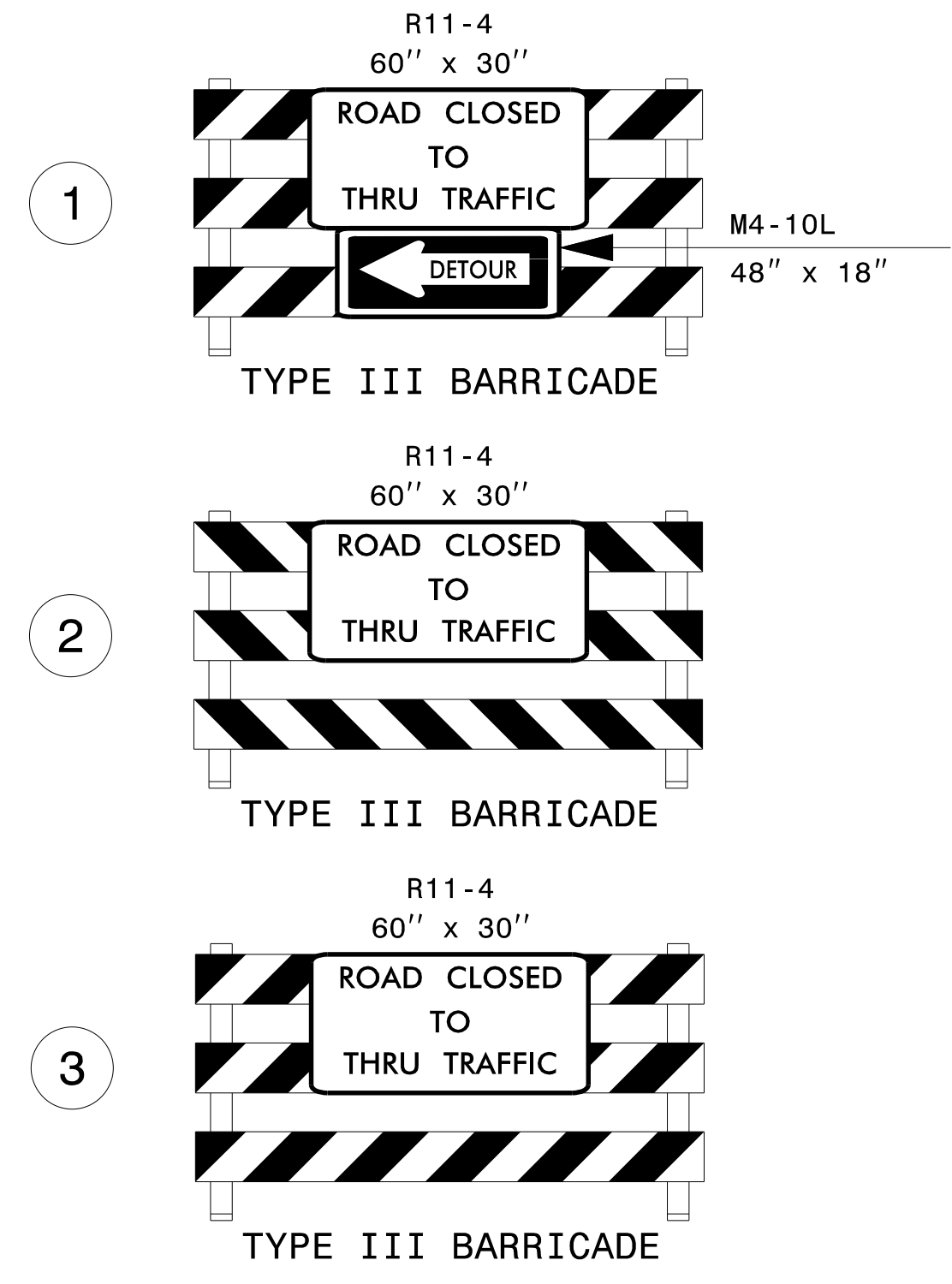
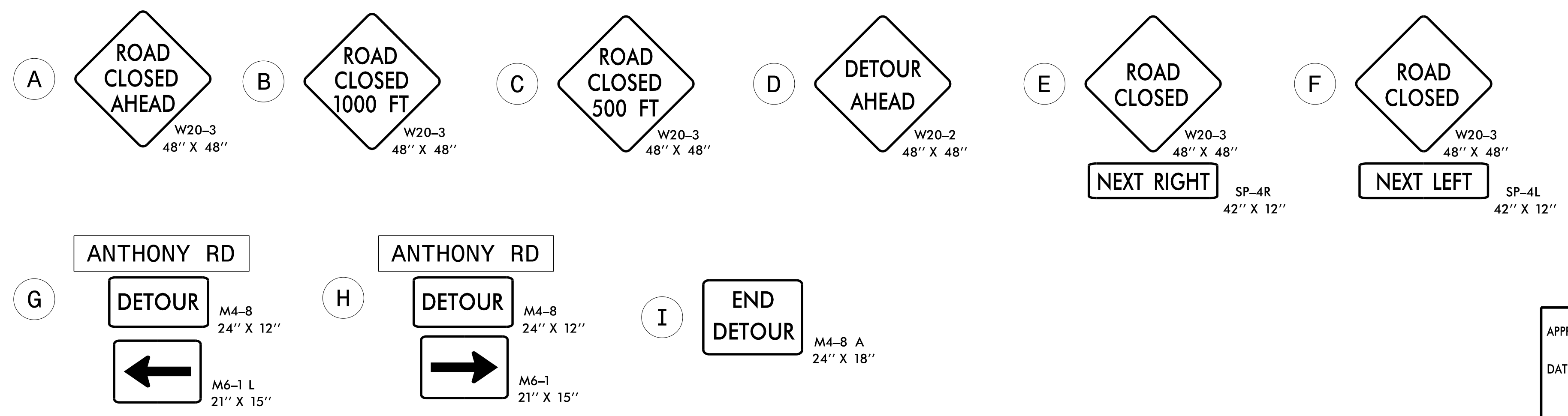
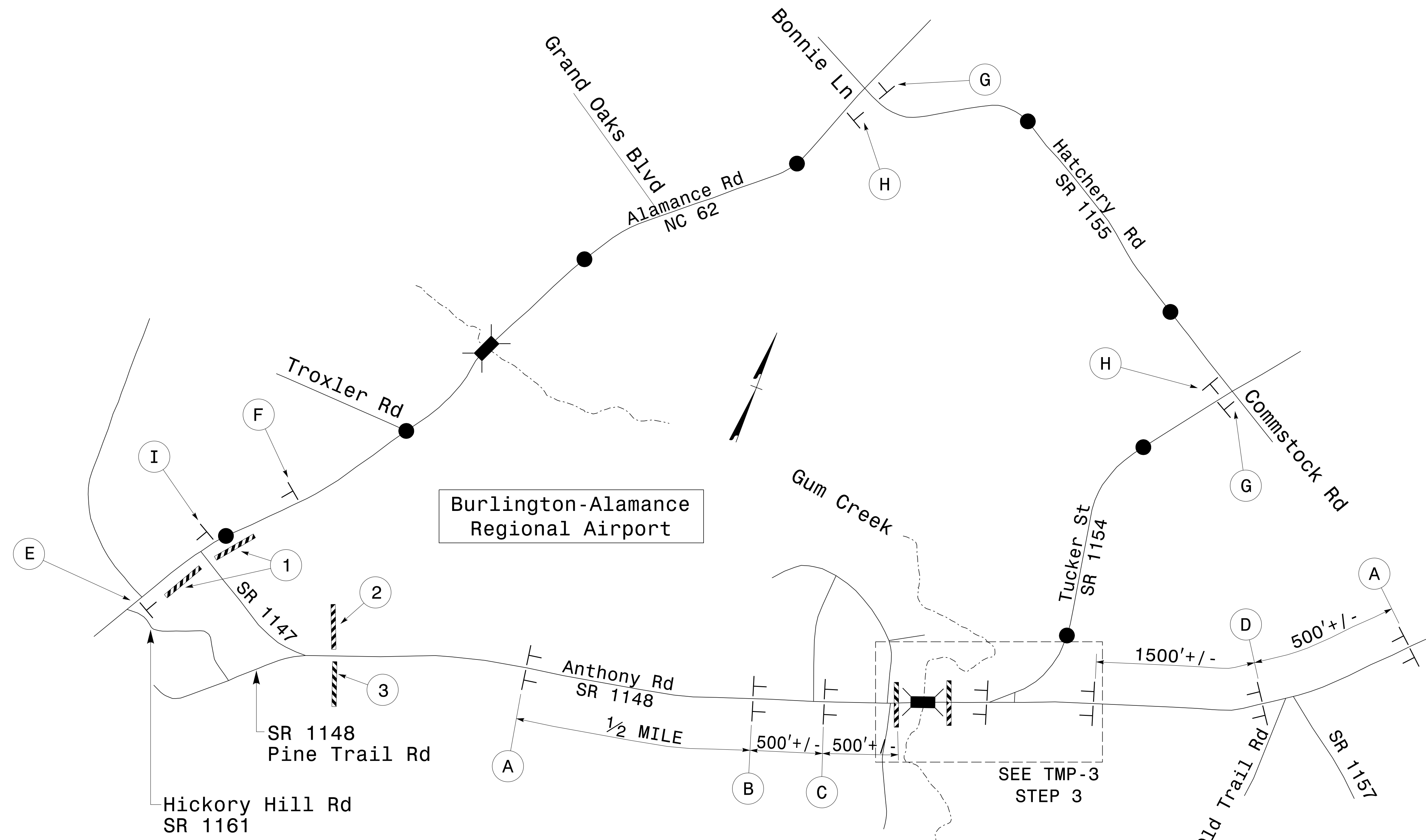

APPROVED: <i>David Bisette</i> DATE: 8/27/2015 PROFESSIONAL SEAL 030864 DAVID W. BISSETTE ENGINEER	DIVISION OF HIGHWAYS STATE OF NORTH CAROLINA DEPARTMENT OF TRANSPORTATION WORK ZONE TRAFFIC CONTROL	OFF SITE DETOUR ROUTE
--	--	------------------------------

8/27/2015
 R:\Tpp\Projects-B\B5342\TrafficControl\TCP\B5342_TC_TMP04_detour_route.dgn
 User:derichardson