

6/2/09

PROJECT REFERENCE NO. <b>B-5342</b>	SHEET NO. <b>2A-1</b>
ROADWAY DESIGN ENGINEER SEAL 014571 James Speer	PAVEMENT DESIGN ENGINEER SEAL 022896 Clark Morrison
9/17/2015	9/17/2015

PAVEMENT SCHEDULE	
C1	PROP. APPROX. 3" ASPHALT CONCRETE SURFACE COURSE, TYPE S9.5B, AT AN AVERAGE RATE OF 168 LBS. PER SQ. YD. IN EACH OF TWO LAYERS.
C2	PROP. VAR. DEPTH ASPHALT CONCRETE SURFACE COURSE, TYPE S9.5B, AT AN AVERAGE RATE OF 112 LBS. PER SQ. YD. PER 1" DEPTH. TO BE PLACED IN LAYERS NOT TO EXCEED 2" IN DEPTH.
D1	PROP. APPROX. 3" ASPHALT CONCRETE INTERMEDIATE COURSE, TYPE I19.0B, AT AN AVERAGE RATE OF 342 LBS. PER SQ. YD.
D2	PROP. VAR. DEPTH ASPHALT CONCRETE INTERMEDIATE COURSE, TYPE I19.0B, AT AN AVERAGE RATE OF 114 LBS. PER SQ. YD. PER 1" DEPTH. TO BE PLACED IN LAYERS NOT LESS THAN 2½" IN DEPTH OR GREATER THAN 4" IN DEPTH.
E1	PROP. APPROX. 4" ASPHALT CONCRETE BASE COURSE, TYPE B25.0B, AT AN AVERAGE RATE OF 456 LBS. PER SQ. YD.
E2	PROP. VAR. DEPTH ASPHALT CONCRETE BASE COURSE, TYPE B25.0B, AT AN AVERAGE RATE OF 114 LBS. PER SQ. YD. PER 1" DEPTH. TO BE PLACED IN LAYERS NOT LESS THAN 3" IN DEPTH OR GREATER THAN 5½" IN DEPTH.
R1	SHOULDER BERM GUTTER (SEE DETAIL ON THIS SHEET)
T	EARTH MATERIAL.
U	EXISTING PAVEMENT.
W	VARIABLE DEPTH ASPHALT PAVEMENT (SEE STANDARD WEDGING DETAIL)

NOTE: PAVEMENT EDGE SLOPES ARE 1:1 UNLESS SHOWN OTHERWISE.

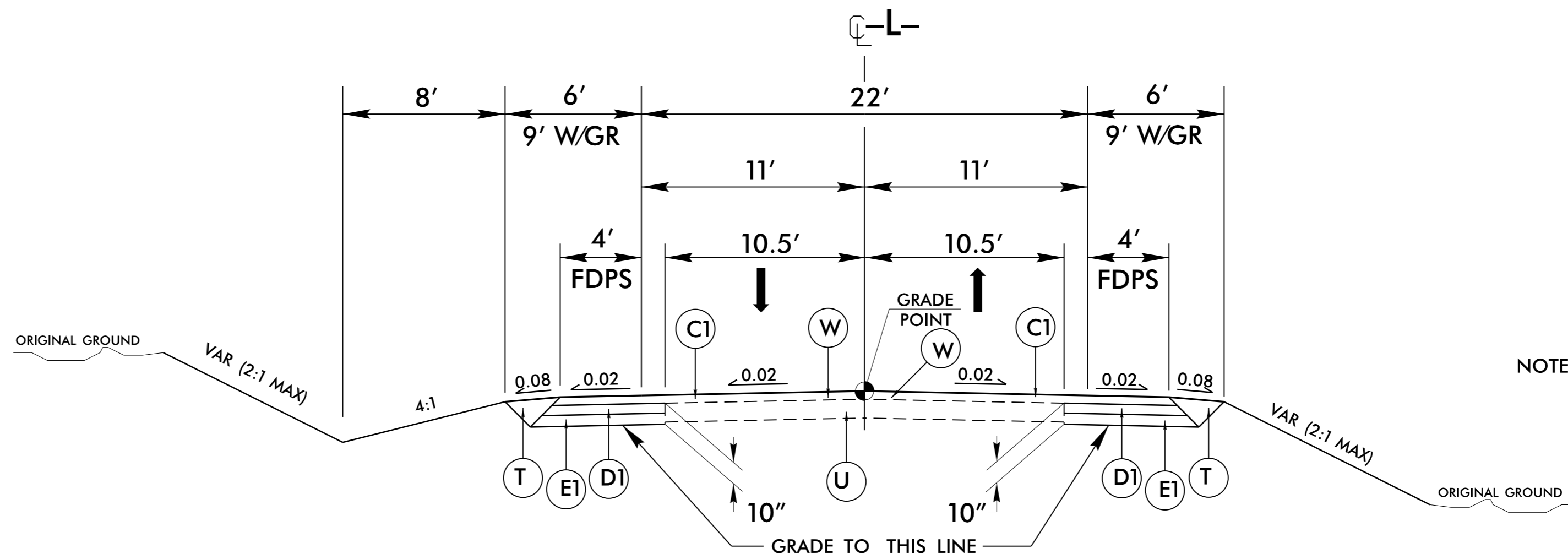

**TYPICAL SECTION NO. 1**

NOTE: TRANSITION FROM EXISTING TO TYPICAL SECTION NO. 1  
 -L- STA. 12+00.00 TO -L- STA. 12+34.00  
 -L- STA. 15+50.00 TO -L- STA. 16+00.00

USE TYPICAL SECTION NO. 1  
 -L- STA. 15+16.00 TO -L- STA. 15+50.00

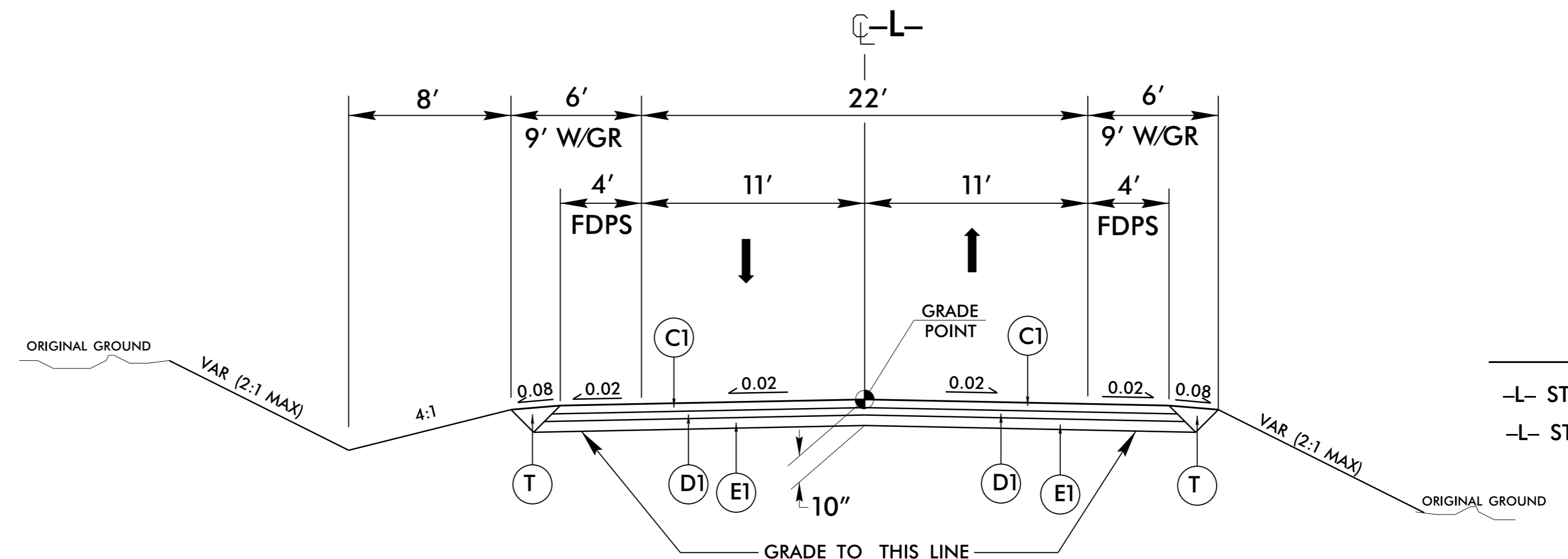

**TYPICAL SECTION NO. 2**

USE TYPICAL SECTION NO. 2  
 -L- STA. 12+34.00 TO STA. 14+01.88 (BEGIN BRIDGE)  
 -L- STA. 14+74.13 (END BRIDGE) TO -L- STA. 15+16.00

SR 1148 (ANTHONY RD.) IS INCLUDED ON THE NC MULTIMODAL INVESTMENT NETWORK (NCMIN) AND IS AN ALTERNATE ROUTE /CONNECTOR ON THE BURLINGTON-GRAHAM MPO BIKE ROUTES

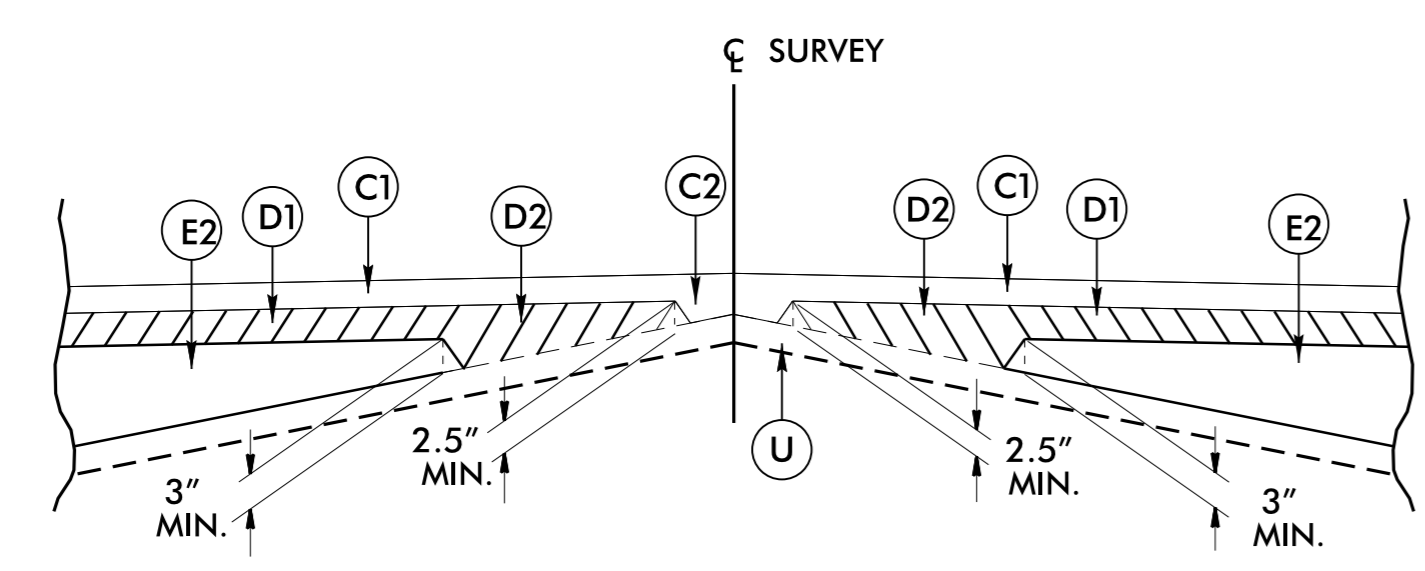

**Detail Showing Method of Wedging**

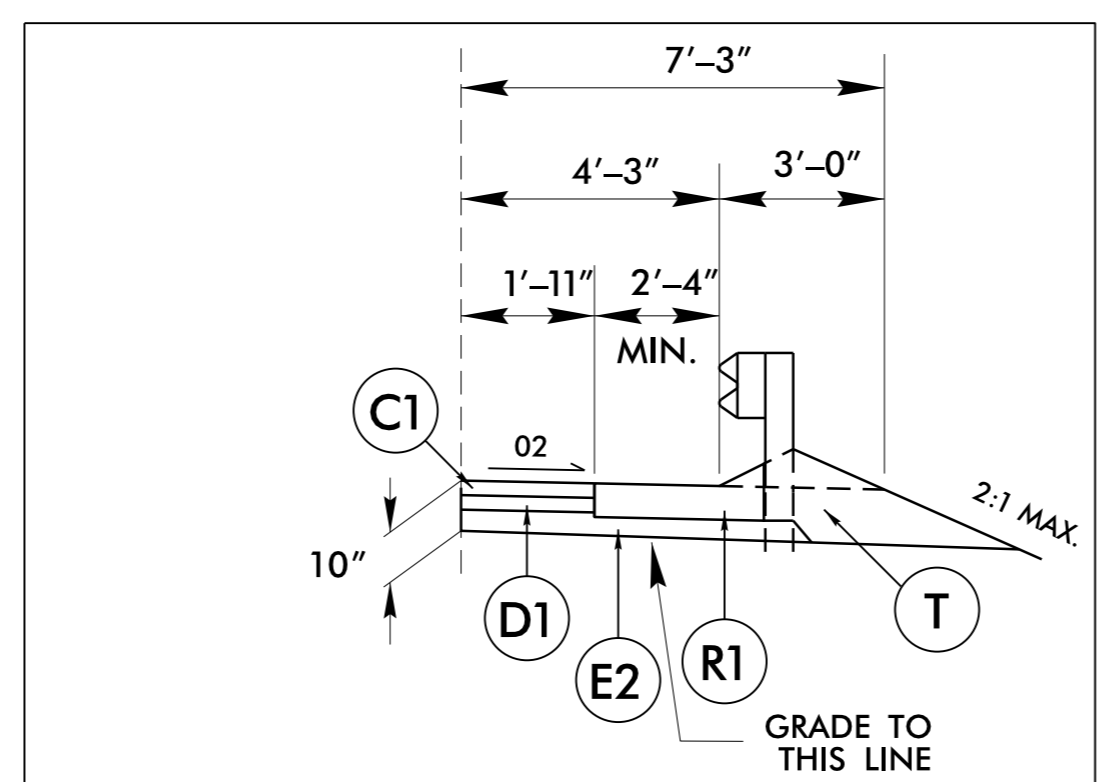

**DETAIL SHOWING SHOULDER BERM GUTTER (SBG)**

USE WITH TYPICAL SECTION NO. 2  
 INSTALL SHOULDER BERM GUTTER (SBG) AS FOLLOWS:  
 -L- STA 13+72.00 RT TO END APPR. SLAB  
 -L- STA 13+72.00 LT TO END APPR. SLAB

05 SEP 2015 09:23 B5342\_Rdy\_tup.dgn