

UTILITIES BY OTHERS

NOTE:
ALL PROPOSED UTILITY WORK SHOWN ON THIS SHEET WILL BE DONE BY OTHERS. NO PAYMENT WILL BE MADE TO THE CONTRACTOR FOR PROPOSED UTILITY WORK SHOWN ON THIS SHEET.

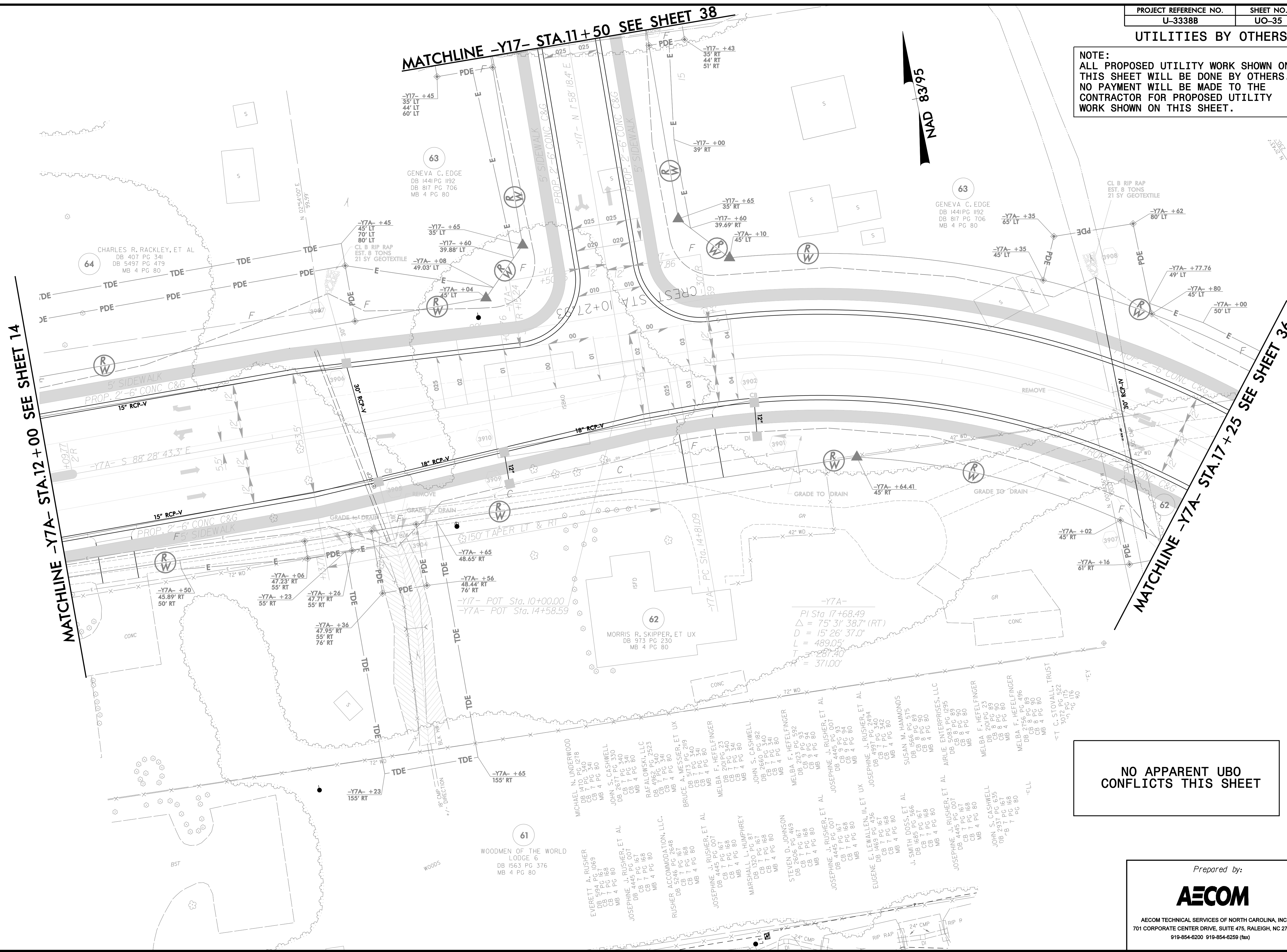

MATCHLINE -Y7A- STA.12+00 SEE SHEET 14

MATCHLINE -Y7A- STA.17+25 SEE SHEET 36

NAD 83/95

NO APPARENT UBO CONFLICTS THIS SHEET

Prepared by:
AECOM
AECOM TECHNICAL SERVICES OF NORTH CAROLINA, INC.
701 CORPORATE CENTER DRIVE, SUITE 475, RALEIGH, NC 27607
919-854-6200 919-854-6259 (fax)

DATE: 1/24/2016
DRAWN: U3338B_UO-35.dgn

MATCHLINE -Y17- STA.11+50 SEE SHEET 38

CHARLES R. RACKLEY, ET AL
DB 407 PG 341
DB 5497 PG 479
MB 4 PG 80

GENEVA C. EDGE
DB 1441 PG 1192
DB 817 PG 706
MB 4 PG 80

GENEVA C. EDGE
DB 1441 PG 1192
DB 817 PG 706
MB 4 PG 80

MORRIS R. SKIPPER, ET UX
DB 973 PG 230
MB 4 PG 80

WOODMEN OF THE WORLD
LODGE 6
DB 1563 PG 376
MB 4 PG 80

- MICHAEL N. UNDERWOOD
DB 1470 PG 1218
CB 7 PG 341
MB 4 PG 80
- JOHN S. CASHWELL
DB 2677 PG 340
CB 7 PG 341
MB 4 PG 80
- RAFAŁOWSKI, LLC
DB 6962 PG 2523
CB 7 PG 340
MB 4 PG 80
- BRUCE A. MESSIER, ET UX
DB 5123 PG 219
CB 7 PG 341
MB 4 PG 80
- MELBA F. HEFFELFINGER
DB 201 PG 23
CB 7 PG 340
MB 4 PG 80
- JOHN S. CASHWELL
DB 2660 PG 342
CB 7 PG 341
MB 4 PG 80
- MELBA F. HEFFELFINGER
DB 202 PG 93
CB 7 PG 340
MB 4 PG 80
- JOSEPHINE J. RUSHER, ET AL
DB 4445 PG 907
CB 9 PG 93
MB 4 PG 80
- JOSEPHINE J. RUSHER, ET AL
DB 4997 PG 2494
CB 7 PG 342
MB 4 PG 80
- SUSAN M. HAMMONDS
DB 1566 PG 89
CB 8 PG 90
MB 4 PG 80
- AIRUE ENTERPRISES, LLC
DB 5083 PG 89
CB 8 PG 90
MB 4 PG 80
- MELBA F. HEFFELFINGER
DB 200 PG 23
CB 8 PG 90
MB 4 PG 80
- MELBA F. HEFFELFINGER
DB 2756 PG 496
CB 8 PG 90
MB 4 PG 80
- C. STONALL, TRUST
DB 3072 PG 522
CB 9 PG 116
MB 4 PG 80
- EVERETT A. RUSHER
DB 594 PG 1063
CB 7 PG 168
MB 4 PG 80
- JOSEPHINE J. RUSHER, ET AL
DB 4445 PG 907
CB 7 PG 168
MB 4 PG 80
- RUSHER ACCOMMODATION, LLC
DB 5246 PG 2646
CB 7 PG 168
MB 4 PG 80
- JOSEPHINE J. RUSHER, ET AL
DB 445 PG 007
CB 7 PG 167
MB 4 PG 80
- MARSHALL L. HUMPHREY
DB 1320 PG 81
CB 7 PG 168
MB 4 PG 80
- STEVEN D. JOHNSON
DB 2606 PG 469
CB 7 PG 167
MB 4 PG 80
- JOSEPHINE J. RUSHER, ET AL
DB 445 PG 007
CB 7 PG 167
MB 4 PG 80
- EUGENE E. LEWALLEN, III, ET UX
DB 1487 PG 436
CB 7 PG 167
MB 4 PG 80
- J. SMITH DOSS, ET AL
DB 169 PG 167
CB 7 PG 168
MB 4 PG 80
- JOSEPHINE J. RUSHER, ET AL
DB 4445 PG 907
CB 7 PG 167
MB 4 PG 80
- JOHN S. CASHWELL
DB 2937 PG 639
CB 7 PG 168
MB 4 PG 80

-Y7A-
PI Sta 17+68.49
Δ = 75° 31' 38.7" (RT)
D = 15' 26' 37.0"
L = 489.05'
T = 287.40'
R = 371.00'