

PROJECT REFERENCE NO.	SHEET NO.
U-3338B	EC-58/CONST.21
RW SHEET NO.	
ROADWAY DESIGN ENGINEER	HYDRAULICS ENGINEER

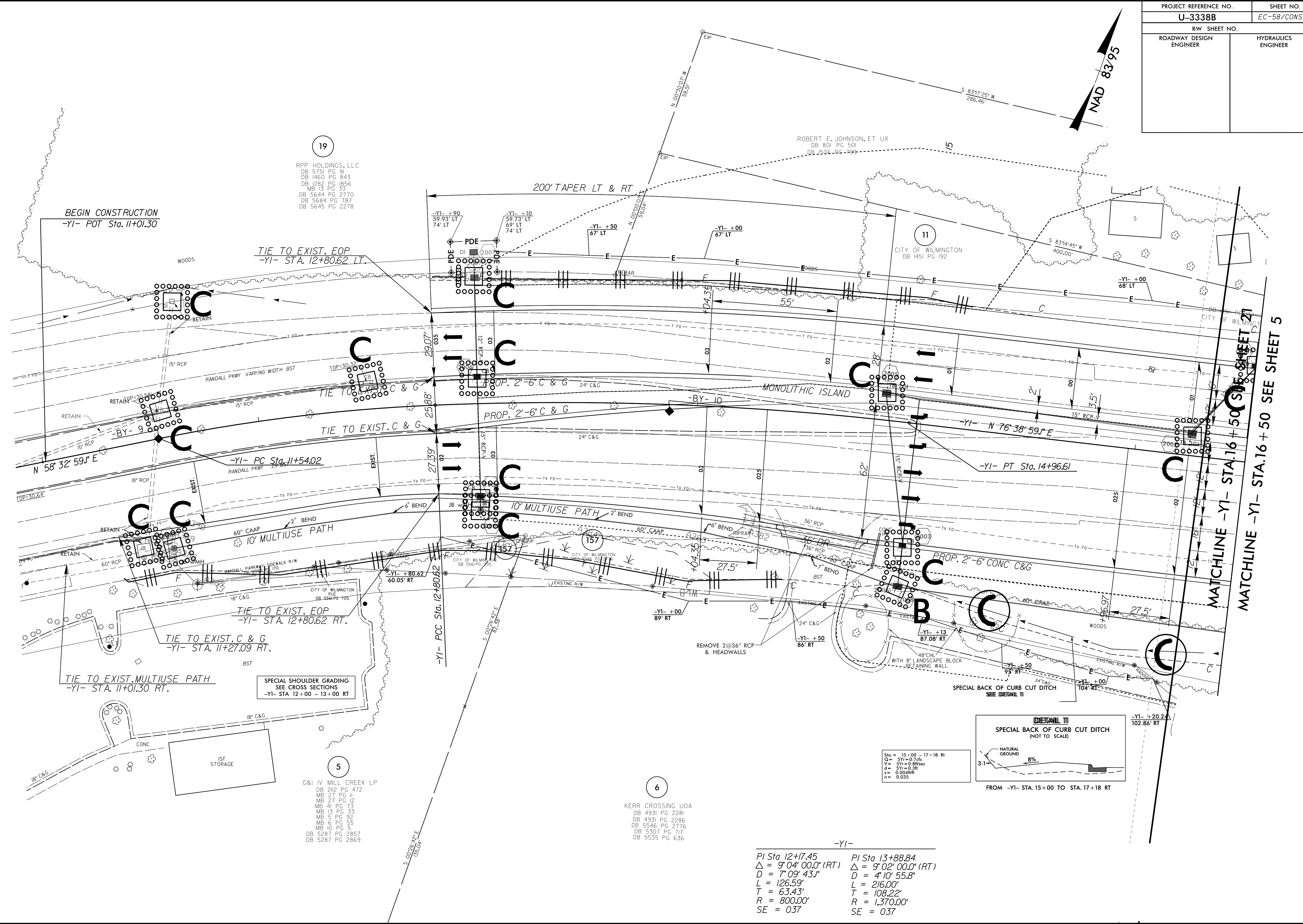
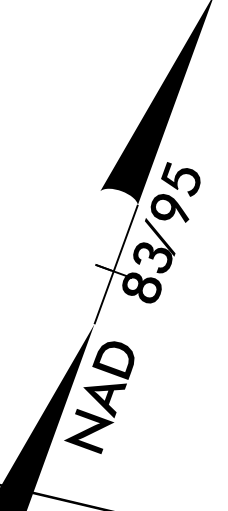

19  
RPP HOLDINGS, LLC  
DB 5751 PG 31  
DB 1460 PG 843  
DB 1282 PG 1856  
MB 15 PG 33  
DB 5644 PG 2170  
DB 5684 PG 787  
DB 5645 PG 2278

ROBERT E. JOHNSON, ET UX  
DB 801 PG 501  
DB 1506 PG 799

11  
CITY OF WILMINGTON  
DB 1451 PG 192

5  
C&I IV MILL CREEK LP  
DB 212 PG 472  
MB 27 PG 11  
MB 27 PG 12  
MB 41 PG 73  
MB 13 PG 33  
MB 5 PG 92  
MB 6 PG 95  
MB 10 PG 5  
DB 5287 PG 2857  
DB 5287 PG 2869

6  
KERR CROSSING UOA  
DB 4931 PG 2281  
DB 4931 PG 2286  
DB 5546 PG 2776  
DB 5307 PG 717  
DB 5535 PG 636

-YI-  
PI Sta 12+17.45      PI Sta 13+88.84  
Δ = 9° 04' 00.0" (RT)      Δ = 9° 02' 00.0" (RT)  
D = 7° 09' 43.1"      D = 4° 10' 55.8"  
L = 126.59'      L = 216.00'  
T = 63.43'      T = 108.22'  
R = 800.00'      R = 1,370.00'  
SE = 037      SE = 037

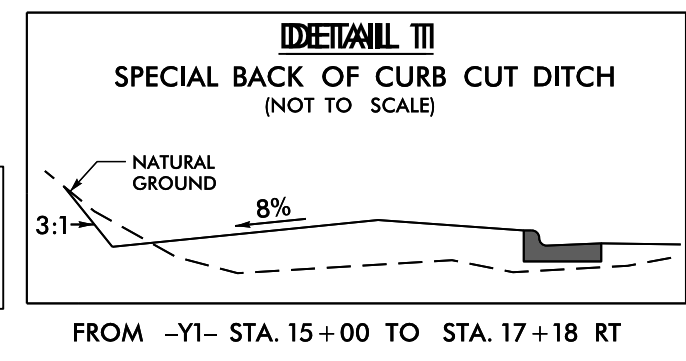

8/17/99  
9/21/AN-2015 15:33  
R:\LEWIS\1000\U-3338b-EC.upsh.s20.dgn  
A:\LEWIS\1000\U-3338b-EC.upsh.s20.dgn