

PROJECT REFERENCE NO.	SHEET NO.
U-3338B	EC-49/CONST.II
RW SHEET NO.	
ROADWAY DESIGN ENGINEER	HYDRAULICS ENGINEER

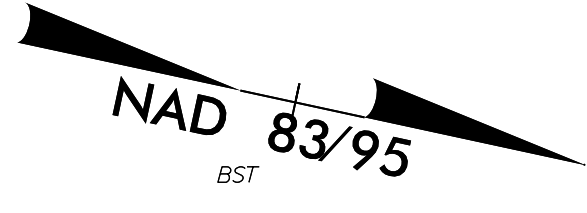

NOTE 1:
PLUG AND FILL FULL
WITH FLOWABLE FILL

47
CLI HOLDINGS, LLC
DB 5269 PG 2858
DB 5374 PG 421
MB 51 PG 390

45
68 SOUTH KERR, LLC
DB 5256 PG 563

46
MARKET PLAZA CENTER, LLC.
DB 5364 PG 1777
DB 791 PG 112
DB 815 PG 411
DB 790 PG 352
DB 789 PG 131
DB 1637 PG 1944
DB 1913 PG 406

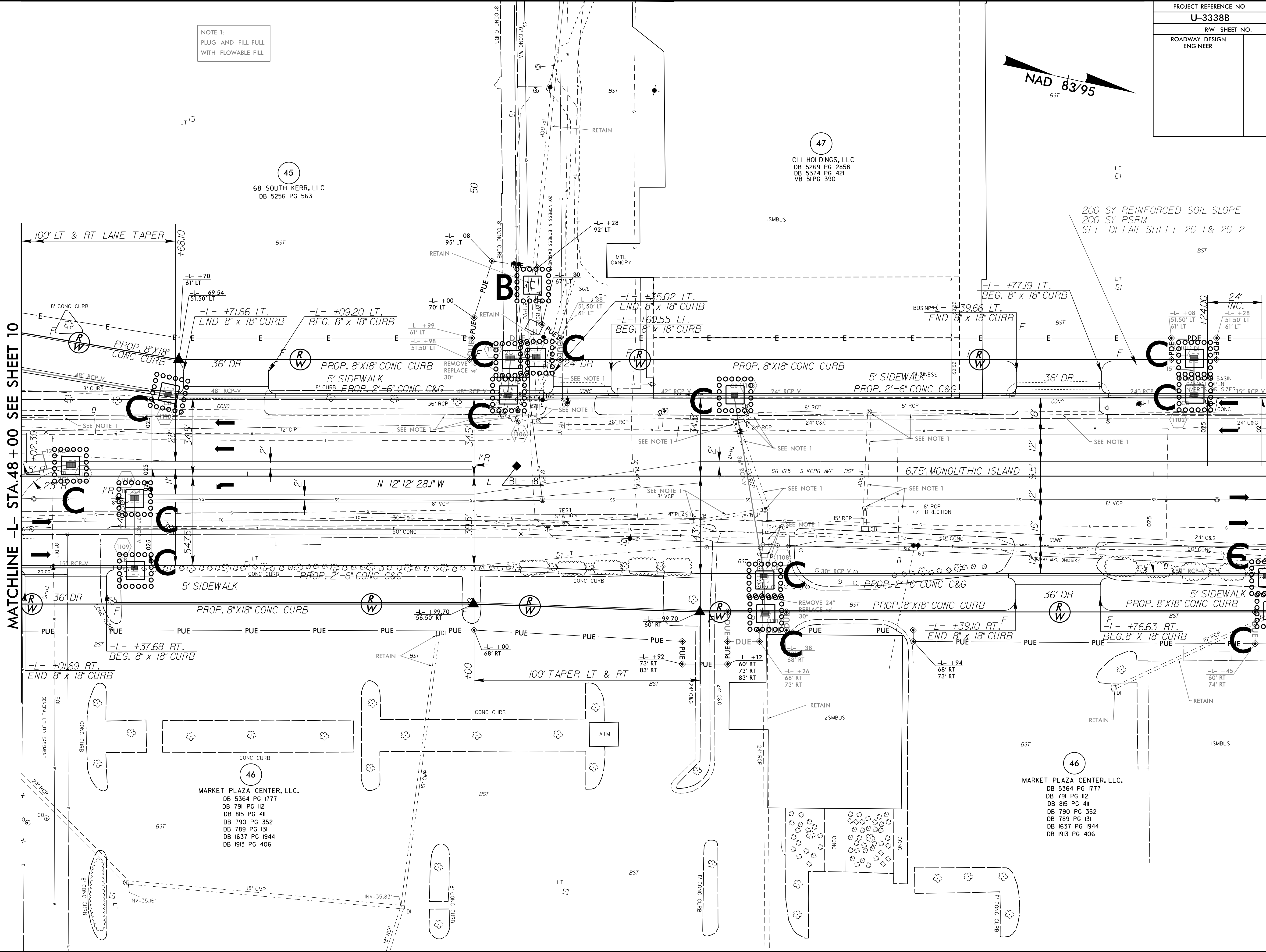

MATCHLINE -L- STA. 48+00 SEE SHEET 10

MATCHLINE -L- STA. 53+50 SEE SHEET 12

8/17/99
9/21/2015 14:42
R:\enviroment\U-3338b-EC.upsh.s11.dgn
MARKET PLAZA CENTER, LLC