

PROJECT REFERENCE NO. U-3338B	SHEET NO. 16
RW SHEET NO.	
ROADWAY DESIGN ENGINEER RAY D. LIVINGOOD Professional Seal 024641	HYDRAULICS ENGINEER RAY D. LIVINGOOD Professional Seal 019775

MATCHLINE -Y10- STA.12+00 SEE SHEET 39

MATCHLINE -L- STA. 75+50 SEE SHEET 15

MATCHLINE -L- STA. 81+00 SEE SHEET 17

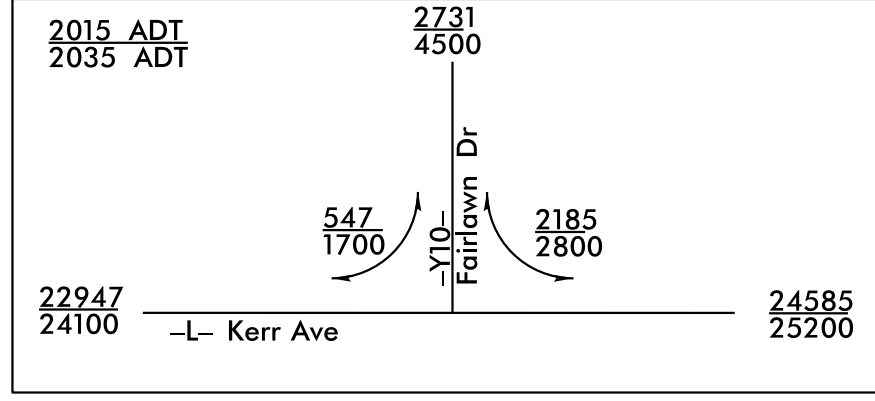
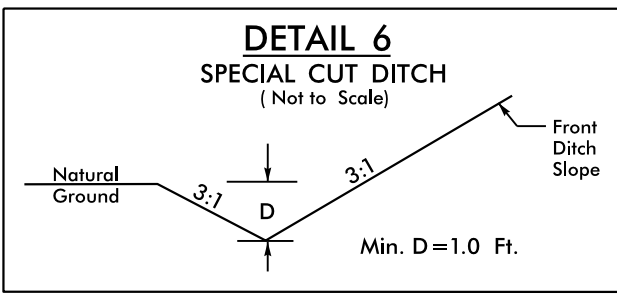
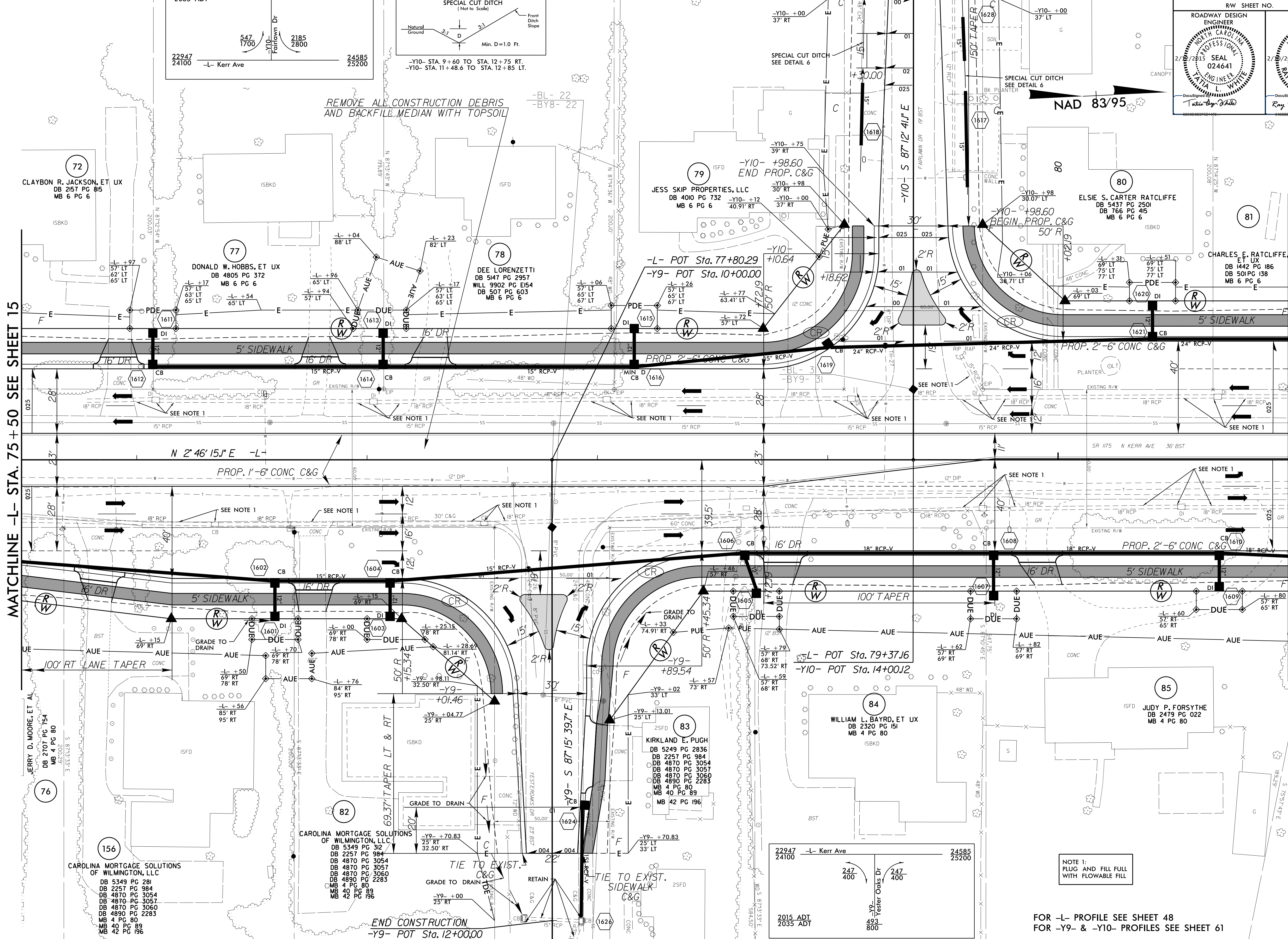

REMOVE ALL CONSTRUCTION DEBRIS AND BACKFILL MEDIAN WITH TOPSOIL

NAD 83/95

NOTE 1:
PLUG AND FILL FULL WITH FLOWABLE FILL

FOR -L- PROFILE SEE SHEET 48
FOR -Y9- & -Y10- PROFILES SEE SHEET 61

REVISIONS

8/17/99
 20 JAN-2015 08:45 33338B.rdw.psh.sfg.dgn
 33338B.DWG

72
CLAYBON R. JACKSON, ET UX
DB 2157 PG 815
MB 6 PG 6

77
DONALD W. HOBBS, ET UX
DB 4805 PG 372
MB 6 PG 6

78
DEE LORENZETTI
DB 5147 PG 2957
WILL 9902 PG E154
DB 507 PG 603
MB 6 PG 6

79
JESS SKIP PROPERTIES, LLC
DB 4010 PG 732
MB 6 PG 6

80
ELSIE S. CARTER RATLIFF
DB 5437 PG 2501
DB 766 PG 415
MB 6 PG 6

81
CHARLES E. RATLIFF, ET UX
DB 1442 PG 186
DB 501 PG 138
MB 6 PG 6

76
LERRY D. MOORE, ET AL
DB 2707 PG 754
MB 4 PG 80

156
CAROLINA MORTGAGE SOLUTIONS OF WILMINGTON, LLC
DB 5349 PG 281
DB 2257 PG 984
DB 4870 PG 3054
DB 4870 PG 3057
DB 4870 PG 3060
DB 4890 PG 2283
MB 4 PG 80
MB 40 PG 89
MB 42 PG 196

82
CAROLINA MORTGAGE SOLUTIONS OF WILMINGTON, LLC
DB 5349 PG 312
DB 2257 PG 984
DB 4870 PG 3054
DB 4870 PG 3057
DB 4870 PG 3060
DB 4890 PG 2283
MB 4 PG 80
MB 40 PG 89
MB 42 PG 196

83
KIRKLAND E. PUGH
DB 5249 PG 2836
DB 2257 PG 984
DB 4870 PG 3054
DB 4870 PG 3057
DB 4870 PG 3060
DB 4890 PG 2283
MB 4 PG 80
MB 40 PG 89
MB 42 PG 196

84
WILLIAM L. BAYRD, ET UX
DB 2320 PG 151
MB 4 PG 80

85
JUDY P. FORSYTHE
DB 2479 PG 022
MB 4 PG 80

