

### PHASING

- STEP 1: - INSTALL OFF-SITE DETOUR ROUTE SIGNS AND ASSEMBLIES FOR THE CLOSING OF SR 1849 (DELCO PROSPER RD., -L-).
- USING ROADWAY STANDARD DRAWING NO. 1101.03, SHEET 1 OF 9, CLOSE SR 1849 (DELCO PROSPER RD., -L-) TO THRU TRAFFIC.
- STEP 2: - REMOVE THE EXISTING BRIDGE AND CONSTRUCT THE PROPOSED BRIDGE AND APPROACHES UP TO AND INCLUDING THE FINAL LAYER OF SURFACE COURSE AND PLACE FINAL PAVEMENT MARKINGS AND MARKERS ON SR 1849 (DELCO PROSPER RD., -L-). (SEE CONSTRUCTION PLANS AND PAVEMENT MARKING PLANS).
- STEP 3: - REMOVE ALL TRAFFIC CONTROL DEVICES, SIGNING AND DETOUR ROUTE SIGNING.
- OPEN TO FINAL TRAFFIC PATTERN.

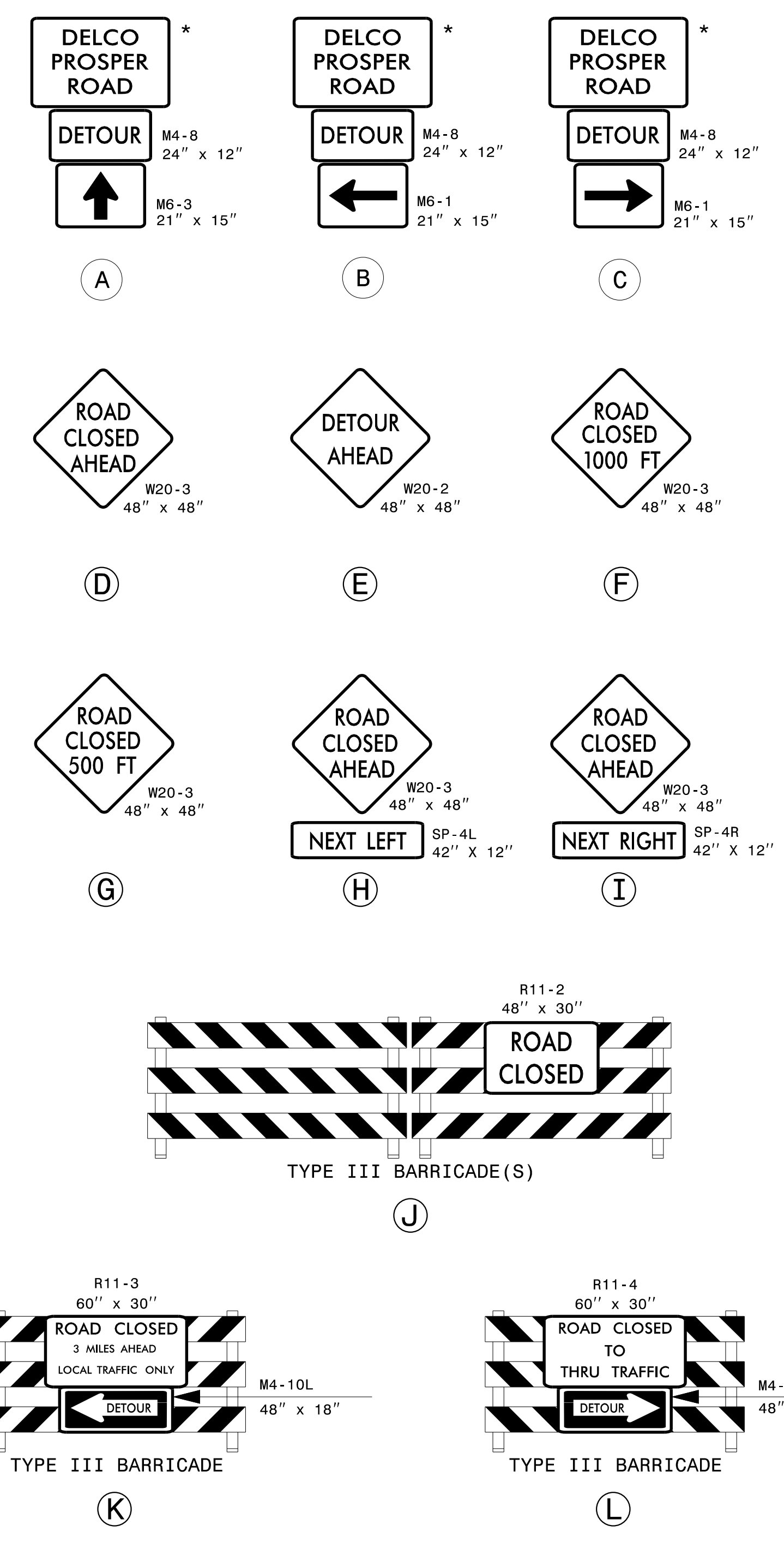

NOTES:  
 - ALL DETOUR SIGN ASSEMBLIES ARE APPROXIMATE.  
 - ALL DETOUR SIGNS ARE BLACK ON ORANGE UNLESS OTHERWISE NOTED.  
 \* SEE TMP-2 FOR SIGN DESIGN.

7/27/2015  
 P:\TIP\Projects-B\B5331\TrafficControl\TCP\B5331\_LC\_TMP\_03.dgn  
 User: sngreen

APPROVED: <i>Steve Kite</i> DATE: 7/29/2015 		<p style="text-align: center;"><b>TEMPORARY TRAFFIC CONTROL DETOUR AND PHASING</b></p>
--	--	--