

SURVEY CONTROL SHEET B-4780

FINAL

LOCALIZED PROJECT COORDINATES
 -L- STA. 12+00.00 BEGIN TIP PROJECT B-4780
 N = 548824.3120
 E = 1680178.8320

LOCALIZED PROJECT COORDINATES
 -L- STA. 18+00.00 END TIP PROJECT B-4780
 N = 549361.5266
 E = 1679911.6738

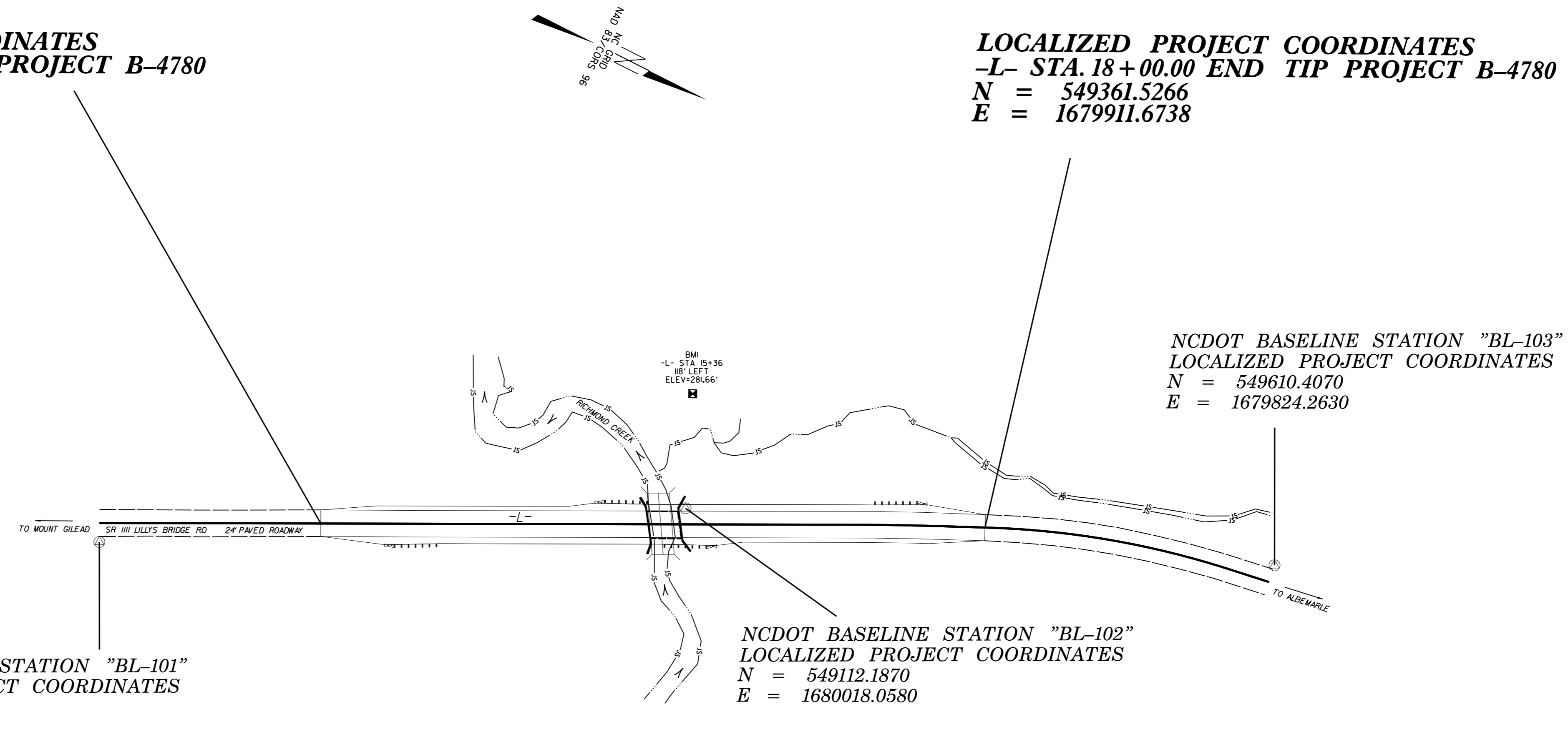

BL POINT	DESC.	NORTH	EAST	ELEVATION	L STATION	OFFSET
101	BL-101	548653.2260	1680283.8900	301.16	OUTSIDE PROJECT LIMITS	
102	BL-102	549112.1870	1680018.0580	287.86	15+29.41	14.53 LT
103	BL-103	549610.4070	1679824.2630	296.88	OUTSIDE PROJECT LIMITS	

.....
 BM1 ELEVATION = 281.66
 N 549071 E 1679923
 L STATION 15+36.00 118 LEFT
 RR-SPIKE IN BASE OF 8IN ELM TREE

TYPE	STATION	NORTH	EAST
POT	10+00.00	548645.5695	1680268.5600
PC	16+80.46	549253.7052	1679963.2782
PT	17+62.90	549327.9010	1679927.3593
PC	18+03.16	549364.3904	1679910.3380
PT	20+24.41	549575.2966	1679845.9080
POT	20+62.22	549612.6485	1679840.0140

ALIGN	STATION	OFFSET	NORTH	EAST
L	12+25.00	-30.00	548833.1956	1680140.8046
L	12+50.00	-60.00	548842.0792	1680102.7772
L	14+75.00	-30.00	549056.6237	1680028.6445
L	14+75.00	30.00	549083.5421	1680082.2673
L	14+75.00	-60.00	549043.1645	1680001.8332
L	14+75.00	60.00	549097.0013	1680109.0787
L	15+30.00	-30.00	549105.7779	1680003.9693
L	15+30.00	-50.00	549096.8051	1679986.0951
L	15+30.00	-60.00	549092.3187	1679977.1579
L	15+40.00	30.00	549141.6334	1680053.1057
L	15+40.00	60.00	549155.0926	1680079.9170
L	15+50.00	-50.00	549114.6793	1679977.1223
L	17+50.00	-45.00	549297.0197	1679892.1419
L	18+00.00	-30.00	549348.8444	1679884.4863

NOTES:

- THE CONTROL DATA FOR THIS PROJECT CAN BE FOUND ELECTRONICALLY BY SELECTING PROJECT CONTROL DATA AT:
[HTTPS://CONNECT.NCDOT.GOV/RESOURCES/LOCATION/](https://connect.ncdot.gov/resources/location/)
 THE FILES TO BE FOUND ARE AS FOLLOWS:
 B4780_LS_CONTROL.TXT
 SITE CALIBRATION INFORMATION HAS NOT BEEN PROVIDED FOR THIS PROJECT. IF FURTHER INFORMATION IS NEEDED, PLEASE CONTACT THE LOCATION AND SURVEYS UNIT.
- INDICATES GEODETIC CONTROL MONUMENTS USED OR SET FOR HORIZONTAL PROJECT CONTROL BY THE NCDOT LOCATION AND SURVEYS UNIT.
 PROJECT CONTROL ESTABLISHED USING GLOBAL POSITIONING SYSTEM.
 NETWORK ESTABLISHED FROM NGS ONLINE POSITIONING SERVICE (OPUS)

NOTE: DRAWING NOT TO SCALE

6/2/99

06_AUG-2015 15:47 164780_1s_1c_1.dgn
 11:50:00
 11:50:00
 11:50:00

DATUM DESCRIPTION

THE LOCALIZED COORDINATE SYSTEM DEVELOPED FOR THIS PROJECT IS BASED ON THE STATE PLANE COORDINATES ESTABLISHED BY NCDOT FOR MONUMENT "B4780-1"

WITH NAD 83/CORS96 STATE PLANE GRID COORDINATES OF
 NORTHING: 546982.4100(±) EASTING: 1680398.8900(±)
 ELEVATION: 312.070(±)

THE AVERAGE COMBINED GRID FACTOR USED ON THIS PROJECT (GROUND TO GRID) IS: 0.9998620950

THE N.C. LAMBERT GRID BEARING AND LOCALIZED HORIZONTAL GROUND DISTANCE FROM "B4780-1" TO -L- STATION 12+00.00 IS
 N 6°48'46.9" W 1855.00'

ALL LINEAR DIMENSIONS ARE LOCALIZED HORIZONTAL DISTANCES
 VERTICAL DATUM USED IS NAVD 88