

RING 10

| LEGEND | |
|--------|----------------------------|
| | RING ROUTE |
| | LOCATION OF SIGNAL ON RING |
| | LOCATION OF CCTV ON RING |

ATKINS 1616 EAST MILLBROOK ROAD, SUITE 310
 RALEIGH, NORTH CAROLINA 27609
 (919) 876-6888 NCBEES #F-0326

04-JUN-2015 15:33
 T:\Product\Tops\TIS\NC\DOT\100037777 - High Point Sig Sys\Comms and ITS\Fiber Splicing\Cable Schematics\FS 2.17.dgn
 SLOC3653 AT LUS291201

| | | |
|--|---|------|
| | High Point Signal System Fiber-Optic Ring Schematics | |
| | Division 7 Guilford County High Point | |
| PLAN DATE: June 2015 REVIEWED BY: HA Badgett | | |
| PREPARED BY: BJ Slocum REVIEWED BY: SG Haynie | | |
| REVISIONS | INIT. | DATE |
| | | |
| | | |
| | | |
| DocuSigned by: | 6/5/2015 | DATE |
| CADD Filename: FS 2.17.dgn | | |

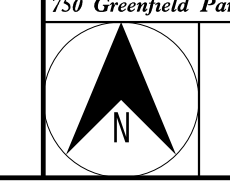

SCALE
 NTS