

THE EXISTING NCDOT FO WILL NOT BE REUSED AFTER CABLE IS SPLICED AT S9-7. ABANDON NCDOT FO IN PLACE.

MATCHLINE - SHEET CRP-6.142

MATCHLINE - SHEET CRP-6.140

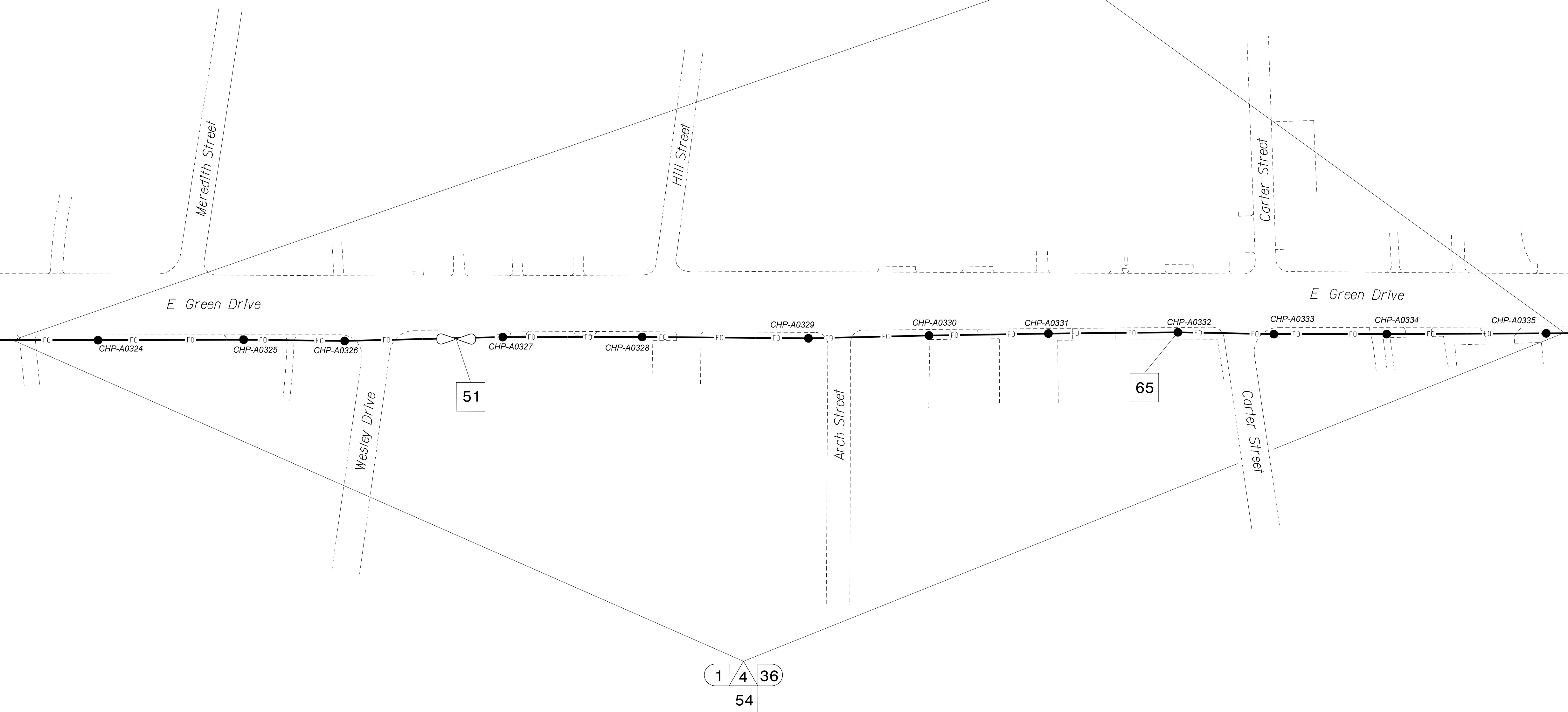

NOTES:

- 1. UNLESS OTHERWISE NOTED:
- OVERLASH NEW FIBER OPTIC CABLE TO EXISTING COMMUNICATIONS CABLE.
- ATTACH NEW MESSENGER CABLE 40" BELOW POWER.
- ATTACH ON FRONT SIDE (FS) OF POLE.
2. SEAL ALL CONDUIT ENDS WITH DUCT AND CONDUIT SEALER, AT ALL JUNCTION BOX / CABINET ENTRANCES.

Table with 7 columns and 7 rows of callout numbers and descriptions for various cable and equipment installation tasks.

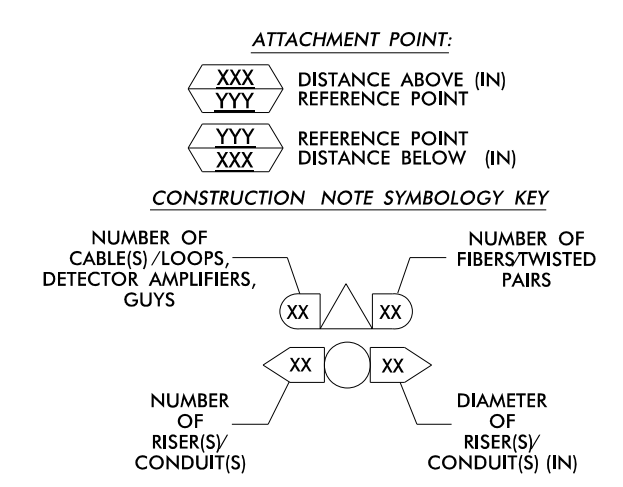

ATKINS 1616 EAST MILLBROOK ROAD, SUITE 310 RALEIGH, NORTH CAROLINA 27609 (919) 876-6888 NCBES #F-0326

Project information block including 'High Point Signal System Cable Routing Plans', 'Division 7 Guilford County High Point', dates, names (NM Chapman, LM Moon), and a professional seal for Melissa B. Toth.

05-JUN-2015 10:53 D:\projects\atkins\proj\c\cur\100037777 - High Point Sig_Sys\CL-141.dgn WILE2054 AT_DUS290140