

ROUTE COMPOSITE CABLE ALONG EXISTING ROUTE TO CCTV 30 THROUGH METAL POLE

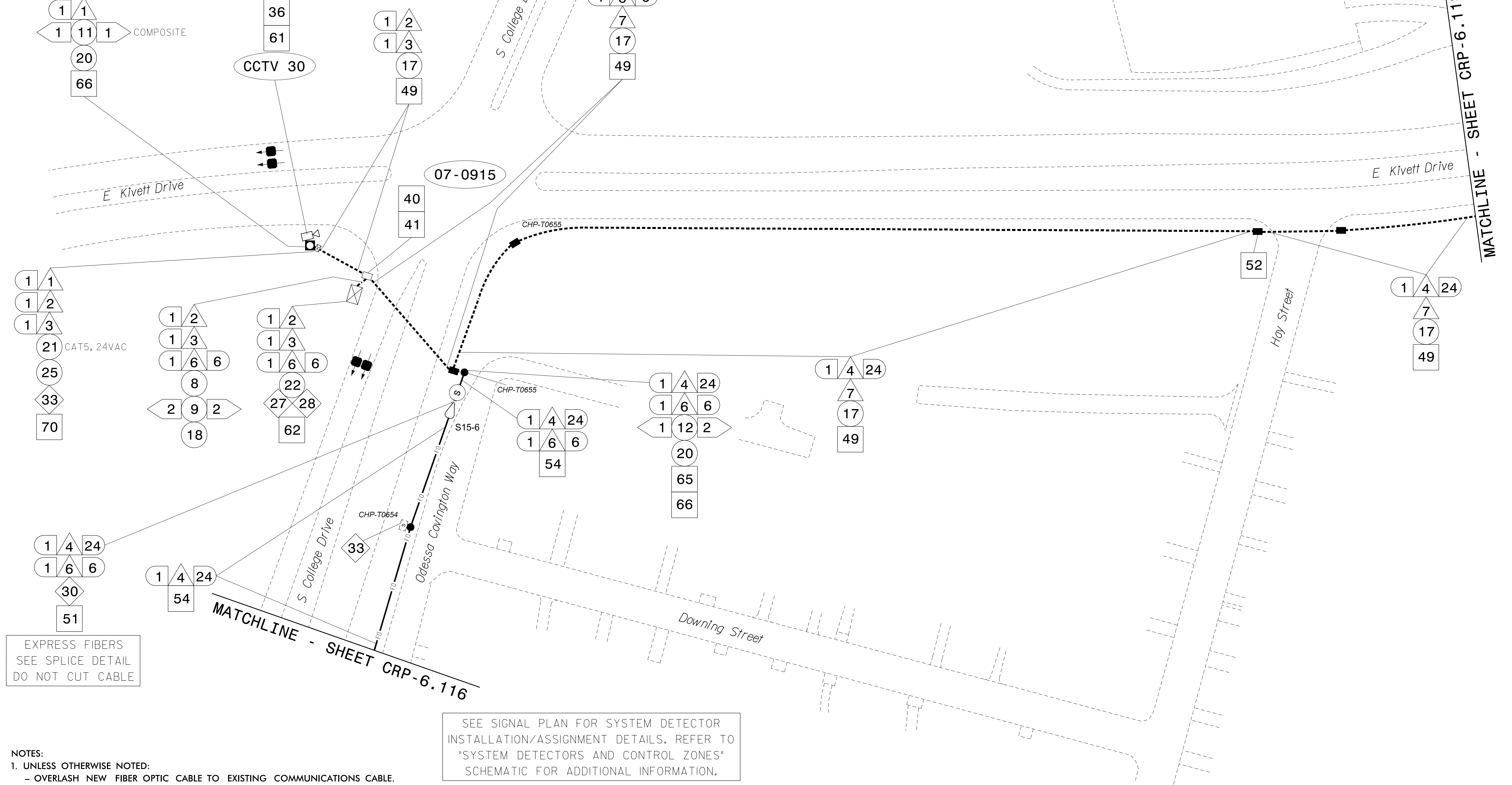

EXPRESS FIBERS SEE SPlice DETAIL DO NOT CUT CABLE

SEE SIGNAL PLAN FOR SYSTEM DETECTOR INSTALLATION/ASSIGNMENT DETAILS. REFER TO "SYSTEM DETECTORS AND CONTROL ZONES" SCHEMATIC FOR ADDITIONAL INFORMATION.

NOTES:

- 1. UNLESS OTHERWISE NOTED: - OVERLASH NEW FIBER OPTIC CABLE TO EXISTING COMMUNICATIONS CABLE. - ATTACH NEW MESSENGER CABLE 40" BELOW POWER. - ATTACH ON FRONT SIDE (FS) OF POLE. 2. SEAL ALL CONDUIT ENDS WITH DUCT AND CONDUIT SEALER, AT ALL JUNCTION BOX / CABINET ENTRANCES.

Table with 7 columns and 70 rows of callout numbers and descriptions for cable installation tasks, such as 'INSTALL COMPOSITE CCTV CABLE', 'INSTALL HEAT SHRINK TUBING RETROFIT KIT', 'INSTALL AERIAL GUY ASSEMBLY', etc.

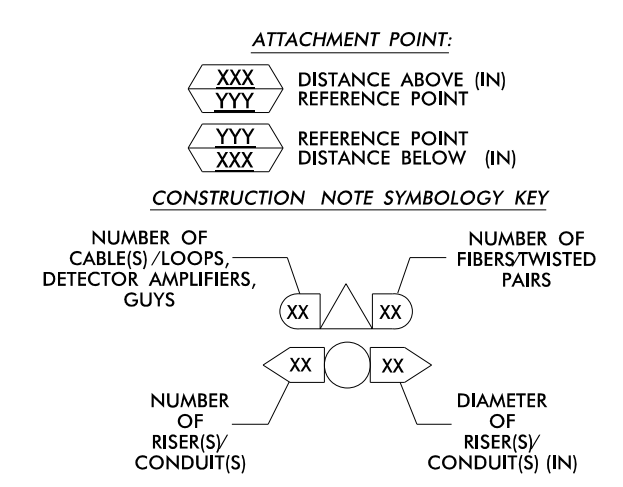

ATKINS 1616 EAST MILLBROOK ROAD, SUITE 310 RALEIGH, NORTH CAROLINA 27609 (919) 876-6888 NCBEES #F-0326

Project information block including 'High Point Signal System Cable Routing Plans', 'Division 7 Guilford County High Point', dates, names (SM ROULEAU, MB Toth, LM Moon), and a professional seal for Melissa B. Toth, Engineer.

05-JUN-2015 10:53 D:\projects\atkins\proj\c\crp\100037777 - High Point Sig_Sys\CL-117.dgn WILE2054 AT DUS290140