

PHASING DIAGRAM

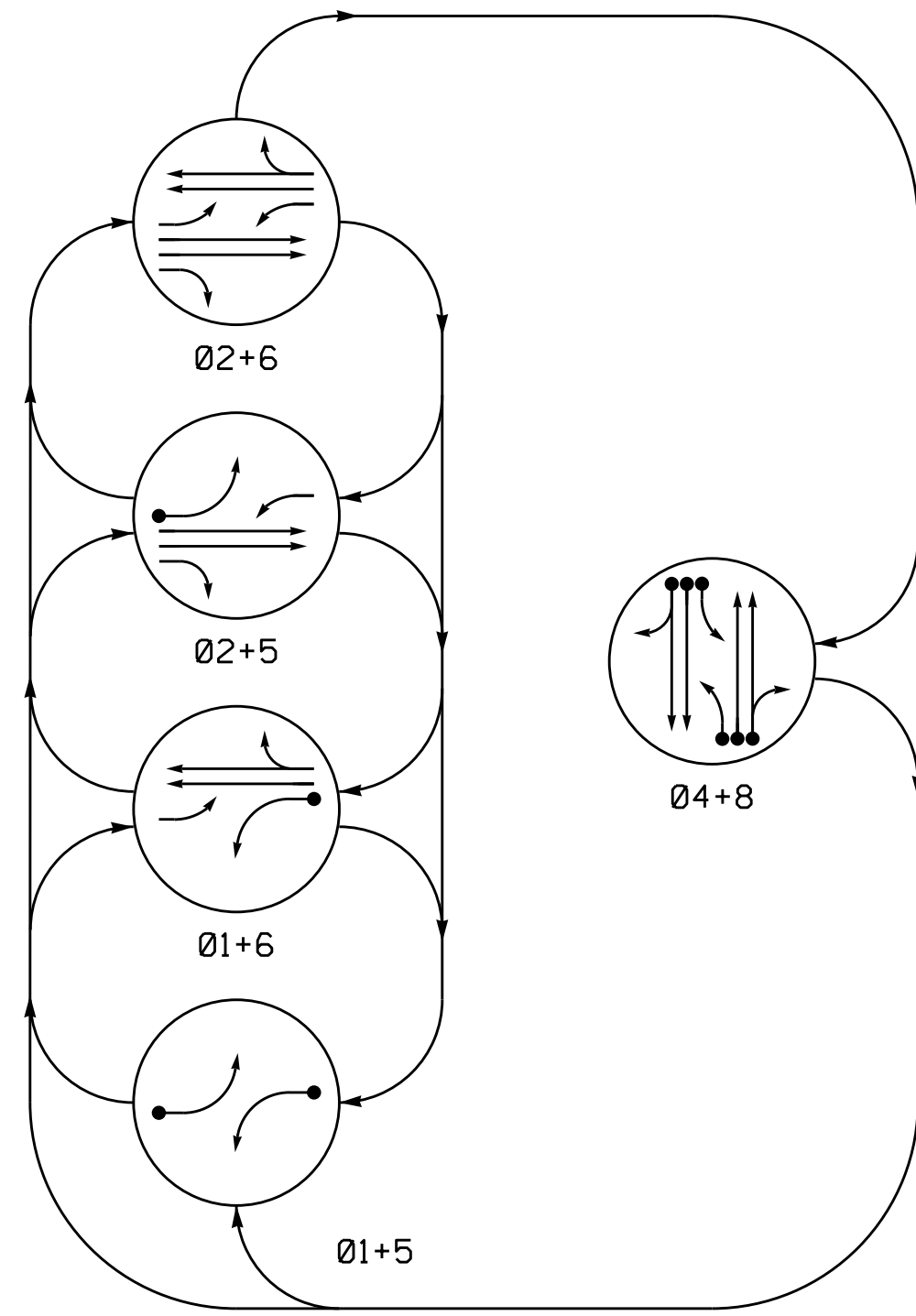

TABLE OF OPERATION

SIGNAL FACE	PHASE					
	01+5	01+6	02+5	02+6	04+8	01+5
11	—	—	—	—	—	—
22, 23, 24	R	R	G	G	R	Y
41, 42, 43	R	R	R	R	G	R
51	—	—	—	—	—	—
61, 62	R	G	R	G	R	Y
81, 82, 83	R	R	R	R	G	R

PHASING DIAGRAM DETECTION LEGEND

- DETECTED MOVEMENT
- UNDETECTED MOVEMENT (OVERLAP)
- UNSIGNALIZED MOVEMENT
- PEDESTRIAN MOVEMENT

OASIS 2070 LOOP & DETECTOR INSTALLATION CHART

LOOP	SIZE (FT)	DISTANCE FROM STOPBAR (FT)	TURNS	NEW LOOP	DETECTOR PROGRAMMING				LOOP SYSTEM	NEW CARD			
					PHASE	CALLING	EXTENSION	FULL TIME DELAY			STRETCH TIME	DELAY TIME	
1A	6X40	0	2-4-2	-	1	Y	Y	-	-	15	-	Y	
4A, 8A	6X40	+5/0	2-4-2	-	4/8	Y	Y	-	-	3	-	Y	
4B	6X40	0	2-4-2	-	4	Y	Y	-	-	-	-	Y	
4C	6X40	0	2-4-2	-	4	Y	Y	-	-	10	-	Y	
5A	6X40	0	2-4-2	Y	5	Y	Y	-	-	15	-	Y	
8B	6X40	0	2-4-2	-	8	Y	Y	-	-	-	-	Y	
8C	6X40	0	2-4-2	-	8	Y	Y	-	-	10	-	Y	
S1	6X6	+180	EXIST	-	-	-	-	-	-	-	-	Y	Y
S2	6X6	+180	EXIST	-	-	-	-	-	-	-	-	Y	Y

SIGNAL FACE I.D.

- All Heads L.E.D.
- (FY) = Bimodal Section
- 11: 11, 51
- 22, 23, 24: 22, 23, 24, 41, 42, 43, 61, 62, 81, 82, 83

5 Phase Semi-Actuated (High Point Signal System)

NOTES

- Refer to "Roadway Standard Drawings NCDOT" dated January 2012 and "Standard Specifications for Roads and Structures" dated January 2012.
- Do not program signal for late night flashing operation unless otherwise directed by the Engineer.
- Phase 1 and/or phase 5 may be lagged.
- Set all detector units to presence mode.
- Locate new cabinet so as not to obstruct sight distance of vehicles turning right on red.
- Existing lane control signs may be removed at the direction of the Engineer.
- Pavement markings are existing.
- Maximum times shown in timing chart are for free-run operation only. Coordinated signal system timing values supersede these values.

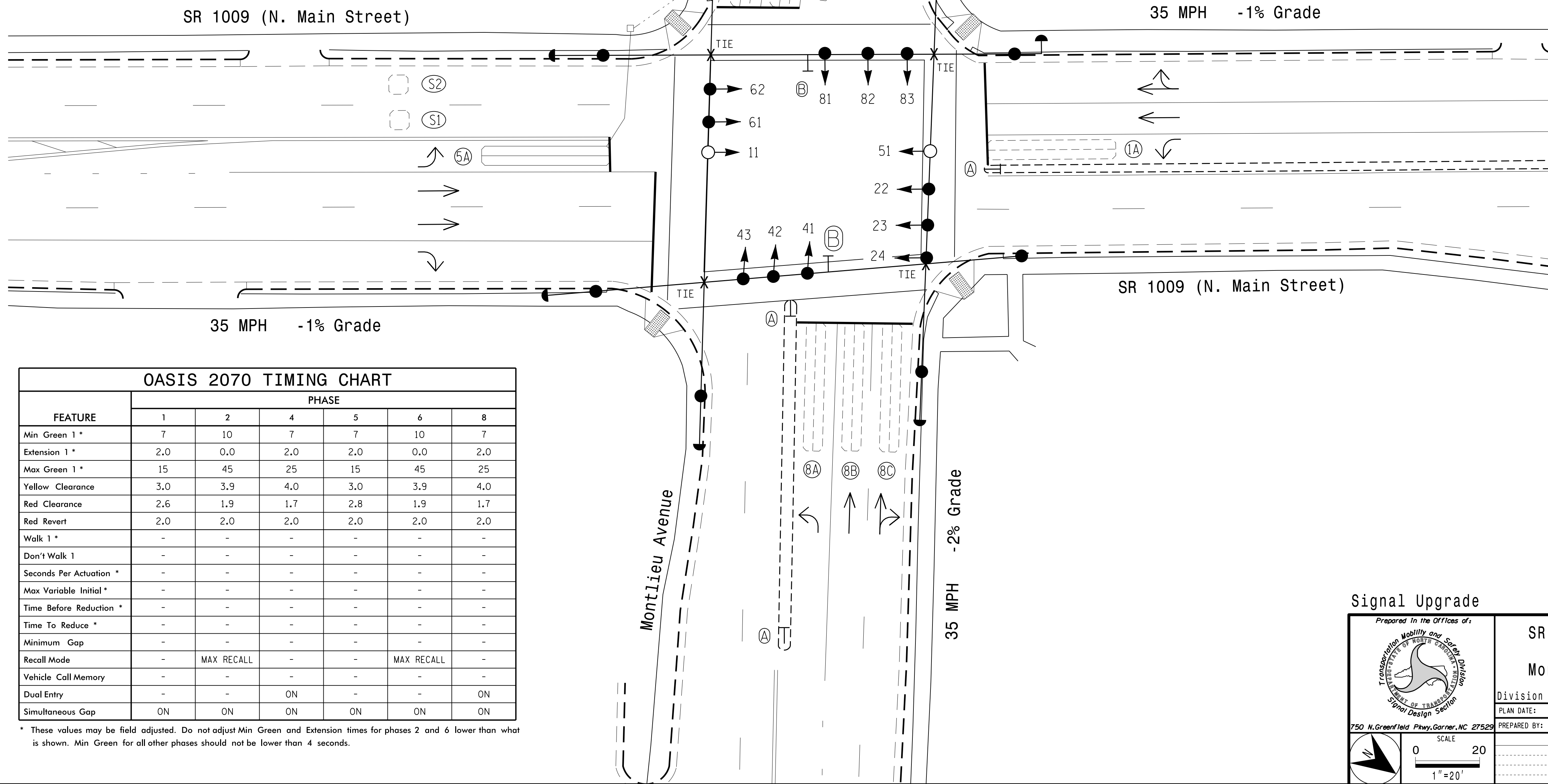

OASIS 2070 TIMING CHART

FEATURE	PHASE					
	1	2	4	5	6	8
Min Green 1 *	7	10	7	7	10	7
Extension 1 *	2.0	0.0	2.0	2.0	0.0	2.0
Max Green 1 *	15	45	25	15	45	25
Yellow Clearance	3.0	3.9	4.0	3.0	3.9	4.0
Red Clearance	2.6	1.9	1.7	2.8	1.9	1.7
Red Revert	2.0	2.0	2.0	2.0	2.0	2.0
Walk 1 *	-	-	-	-	-	-
Don't Walk 1	-	-	-	-	-	-
Seconds Per Actuation *	-	-	-	-	-	-
Max Variable Initial *	-	-	-	-	-	-
Time Before Reduction *	-	-	-	-	-	-
Time To Reduce *	-	-	-	-	-	-
Minimum Gap	-	-	-	-	-	-
Recall Mode	-	MAX RECALL	-	-	MAX RECALL	-
Vehicle Call Memory	-	-	-	-	-	-
Dual Entry	-	-	ON	-	-	ON
Simultaneous Gap	ON	ON	ON	ON	ON	ON

* These values may be field adjusted. Do not adjust Min Green and Extension times for phases 2 and 6 lower than what is shown. Min Green for all other phases should not be lower than 4 seconds.

LEGEND

- | | | | |
|--|---|--|--|
| | PROPOSED Traffic Signal Head | | EXISTING Traffic Signal Head |
| | PROPOSED Modified Signal Head | | EXISTING Modified Signal Head |
| | PROPOSED Pedestrian Signal Head With Push Button & Sign | | EXISTING Pedestrian Signal Head |
| | PROPOSED Signal Pole with Guy | | EXISTING Signal Pole with Guy |
| | PROPOSED Signal Pole with Sidewalk Guy | | EXISTING Signal Pole with Sidewalk Guy |
| | PROPOSED Inductive Loop Detector | | EXISTING Inductive Loop Detector |
| | PROPOSED Controller & Cabinet | | EXISTING Controller & Cabinet |
| | PROPOSED Junction Box | | EXISTING Junction Box |
| | PROPOSED 2-in Underground Conduit | | EXISTING 2-in Underground Conduit |
| | PROPOSED Right of Way | | EXISTING Right of Way |
| | PROPOSED Directional Arrow | | EXISTING Directional Arrow |
| | PROPOSED Curb Ramp | | EXISTING Curb Ramp |
| | PROPOSED No U-Turn Sign (R3-4) | | EXISTING No U-Turn Sign (R3-4) |
| | PROPOSED Left Arrow "ONLY" Sign (R3-5L) | | EXISTING Left Arrow "ONLY" Sign (R3-5L) |
| | PROPOSED Through Arrow "ONLY" Sign (R3-5A) | | EXISTING Through Arrow "ONLY" Sign (R3-5A) |
| | PROPOSED Combined Through and Right Arrow Sign (R3-6R) | | EXISTING Combined Through and Right Arrow Sign (R3-6R) |

Signal Upgrade

SR 1009 (N. Main Street) at Montlieu Ave./Sunset Dr.

Division 7 Guilford County High Point

PLAN DATE: August 2014 PREPARED BY: R.N. Zinser

PREPARED BY: Jeff Spence REVIEWED BY:

SEAL

ROBERT J. ZINSER

ENGINEER

026486

750 N. Greenfield Pkwy, Garner, NC 27529

SCALE 0 20 1"=20'

REVISIONS: _____ INIT. DATE

4/23/2015

SIG. INVENTORY NO. 07-0763

23-APR-2015 11:17 S:\MT\5558\15_Signal\Signal Design\Section\Central Region\01v_Tac-5558_High Point\Signal Plans\07-0763\070763_Sig.dsn_20150423.dgn RZ:terbo