

PHASING DIAGRAM

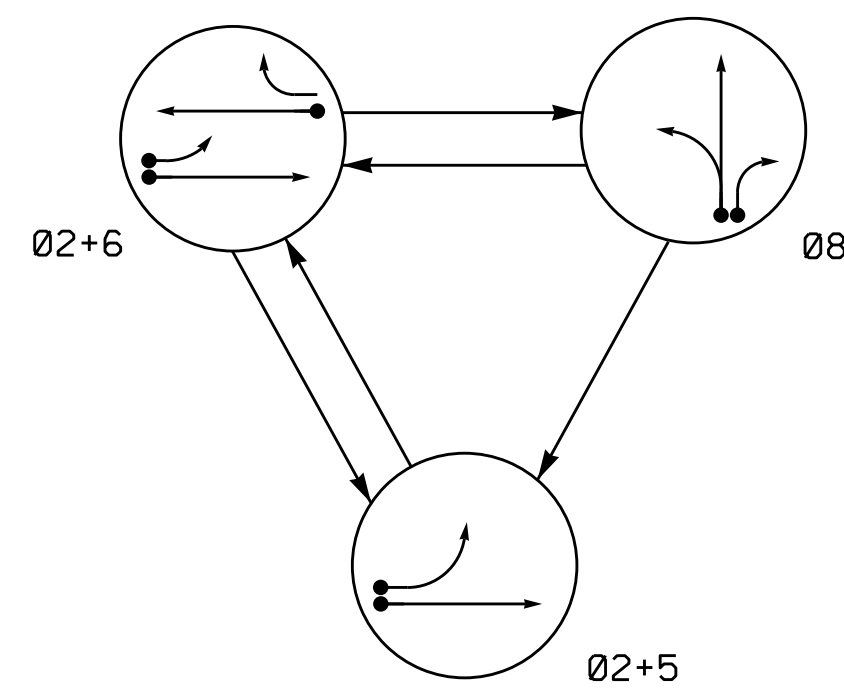

PHASING DIAGRAM DETECTION LEGEND

- ←●→ DETECTED MOVEMENT
- ←○→ UNDETECTED MOVEMENT (OVERLAP)
- UNSIGNALIZED MOVEMENT
- ←- - -> PEDESTRIAN MOVEMENT

SIGNAL FACE	PHASE			
	02+5	02+6	08	F.L.O.P.F.
21, 22	G	G	R	Y
51	-	F	R	Y
61, 62	R	G	R	Y
81, 82	R	R	G	R

OASIS 2070 LOOP & DETECTOR INSTALLATION CHART												
LOOP	SIZE (FT)	DISTANCE FROM STOPBAR (FT)	TURNS	NEW LOOP	DETECTOR PROGRAMMING						SYSTEM LOOP	NEW CARD
					PHASE	CALLING	EXTENSION	FULL TIME DELAY	STRETCH TIME	DELAY TIME		
1B	6X40	0	2-4-2	-	8	Y	Y	-	-	15	-	-
2A	6X6	70	4	-	2	Y	Y	-	-	-	-	-
5A	6X40	0	2-4-2	Y	5	Y	Y	-	-	15	-	-
6A	6X6	70	4	-	6	Y	Y	-	-	-	-	-
8A	6X40	0	2-4-2	-	8	Y	Y	-	-	-	-	-

3 Phase Fully Actuated (Lexington NC 8 CLS)

NOTES

- Refer to "Roadway Standard Drawings NCDOT" dated January 2012 and "Standard Specifications for Roads and Structures" dated January 2012.
- Do not program signal for late night flashing operation unless otherwise directed by the Engineer.
- Reconnect and unbag signal head 51.
- Remove existing signal head 11.
- Phase 5 may be lagged.
- Set all detector units to presence mode.
- Maximum times shown in timing chart are for free-run operation only. Coordinated signal system timing values supersede these values.
- Closed loop system data: Controller Asset #: 0735.

SIGNAL FACE I.D.

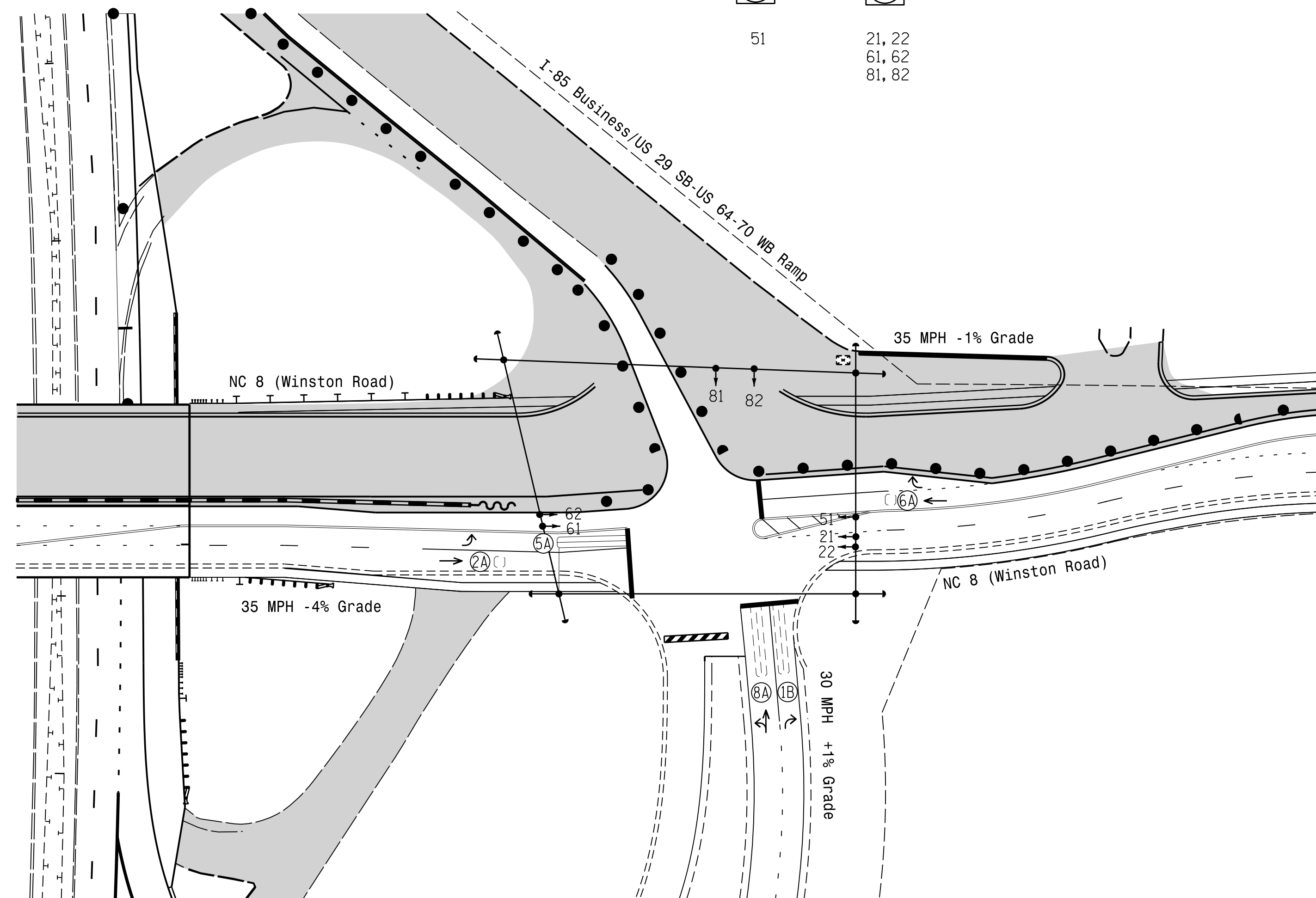
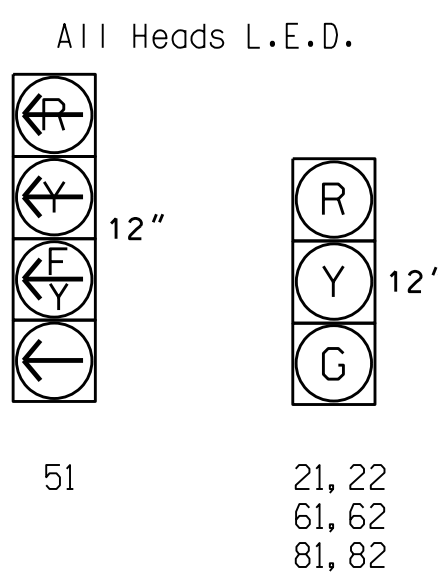

FEATURE	PHASE			
	2	5	6	8
Min Green 1 *	10	7	10	7
Extension 1 *	3.0	2.0	3.0	2.0
Max Green 1 *	50	25	50	25
Yellow Clearance	4.1	3.0	4.1	3.8
Red Clearance	1.9	1.8	1.9	1.6
Walk 1 *	-	-	-	-
Don't Walk 1	-	-	-	-
Seconds Per Actuation *	-	-	-	-
Max Variable Initial *	-	-	-	-
Time Before Reduction *	-	-	-	-
Time To Reduce *	-	-	-	-
Minimum Gap	-	-	-	-
Recall Mode	MIN RECALL	-	MIN RECALL	-
Vehicle Call Memory	YELLOW	-	YELLOW	-
Dual Entry	-	-	-	-
Simultaneous Gap	ON	ON	ON	ON

\* These values may be field adjusted. Do not adjust Min Green and Extension times for phases 2 and 6 lower than what is shown. Min Green for all other phases should not be lower than 4 seconds.

LEGEND

- | PROPOSED   | EXISTING   |
|--|--|
| ○ → Traffic Signal Head                          | ● → N/A  |
| ○ → Modified Signal Head                         | ○ → N/A  |
| ⊥ Sign   | ⊥ Sign   |
| ⊥ Pedestrian Signal Head With Push Button & Sign | ⊥ Pedestrian Signal Head With Push Button & Sign |
| ○ Signal Pole with Guy                           | ○ Signal Pole with Guy                           |
| ○ Signal Pole with Sidewalk Guy                  | ○ Signal Pole with Sidewalk Guy                  |
| ⊠ Inductive Loop Detector                        | ⊠ Inductive Loop Detector                        |
| □ Controller & Cabinet                           | □ Controller & Cabinet                           |
| □ Junction Box                                   | □ Junction Box                                   |
| --- 2-in Underground Conduit                     | --- 2-in Underground Conduit                     |
| N/A Right of Way                                 | --- Right of Way                                 |
| → Directional Arrow                              | → Directional Arrow                              |
| ● Construction Zone Drums                        | ● Construction Zone Drums                        |
| ■ Construction Zone                              | ■ Construction Zone                              |
| N/A Guardrail                                    | --- Guardrail                                    |

Signal Upgrade - Temporary Design 3 (TMP Phase III)

	<p>NC 8 (Winston Road) at I-85 Bus./US 29 SB-US 64-70 WB Ramp</p>		<p>SEAL</p>
	<p>Division 9 Davidson County Lexington</p>		
<p>PLAN DATE: May 2015</p>		<p>REVIEWED BY:</p>	
<p>PREPARED BY: I. O. Umzurike</p>		<p>REVIEWED BY:</p>	
<p>REVISIONS</p>		<p>INIT. DATE</p>	
<p>SCALE 0 50 1"=50'</p>		<p>7/1/2015</p>	
<p>SIG. INVENTORY NO. 09-073513</p>		<p>DATE</p>	