

REFERENCE: B-2500AB

PROJECT: 32635

STATE OF NORTH CAROLINA
DEPARTMENT OF TRANSPORTATION
DIVISION OF HIGHWAYS
GEOTECHNICAL ENGINEERING UNIT

STATE	STATE PROJECT REFERENCE NO.	SHEET NO.	TOTAL SHEETS
N.C.	B-2500AB	1	4

CONTENTS

<u>SHEET NO.</u>	<u>DESCRIPTION</u>
1	TITLE SHEET
2	LEGEND
3	SITE PLAN
4	WALL ENVELOPE

STRUCTURE
SUBSURFACE INVESTIGATION

COUNTY DARE

PROJECT DESCRIPTION PHASE II, NC-12 SHORT-TERM IMPROVEMENTS AT PEA ISLAND

SITE DESCRIPTION WALL 4 AT -L- STA. 3182 + 54.52, 20.75' RT

CAUTION NOTICE

THE SUBSURFACE INFORMATION AND THE SUBSURFACE INVESTIGATION ON WHICH IT IS BASED WERE MADE FOR THE PURPOSE OF STUDY, PLANNING AND DESIGN, AND NOT FOR CONSTRUCTION OR PAY PURPOSES. THE VARIOUS FIELD BORING LOGS, ROCK CORES AND SOIL TEST DATA AVAILABLE MAY BE REVIEWED OR INSPECTED BY CONTACTING THE N. C. DEPARTMENT OF TRANSPORTATION, GEOTECHNICAL ENGINEERING UNIT AT 1919 TOT-6850. THE SUBSURFACE PLANS AND REPORTS, FIELD BORING LOGS, ROCK CORES AND SOIL TEST DATA ARE NOT PART OF THE CONTRACT.

GENERAL SOIL AND ROCK STRATA DESCRIPTIONS AND INDICATED BOUNDARIES ARE BASED ON A GEOTECHNICAL INTERPRETATION OF ALL AVAILABLE SUBSURFACE DATA AND MAY NOT NECESSARILY REFLECT THE ACTUAL SUBSURFACE CONDITIONS BETWEEN BORINGS OR BETWEEN SAMPLED STRATA WITHIN THE BOREHOLE. THE LABORATORY SAMPLE DATA AND THE IN SITU (IN-PLACE) TEST DATA CAN BE RELIED ON ONLY TO THE DEGREE OF RELIABILITY INHERENT IN THE STANDARD TEST METHOD. THE OBSERVED WATER LEVELS OR SOIL MOISTURE CONDITIONS INDICATED IN THE SUBSURFACE INVESTIGATIONS ARE AS RECORDED AT THE TIME OF THE INVESTIGATION. THESE WATER LEVELS OR SOIL MOISTURE CONDITIONS MAY VARY CONSIDERABLY WITH TIME ACCORDING TO CLIMATIC CONDITIONS INCLUDING TEMPERATURES, PRECIPITATION AND WIND, AS WELL AS OTHER NON-CLIMATIC FACTORS.

THE BIDDER OR CONTRACTOR IS CAUTIONED THAT DETAILS SHOWN ON THE SUBSURFACE PLANS ARE PRELIMINARY ONLY AND IN MANY CASES THE FINAL DESIGN DETAILS ARE DIFFERENT. FOR BIDDING AND CONSTRUCTION PURPOSES, REFER TO THE CONSTRUCTION PLANS AND DOCUMENTS FOR FINAL DESIGN INFORMATION ON THIS PROJECT. THE DEPARTMENT DOES NOT WARRANT OR GUARANTEE THE SUFFICIENCY OR ACCURACY OF THE INVESTIGATION MADE, NOR THE INTERPRETATIONS MADE, OR OPINION OF THE DEPARTMENT AS TO THE TYPE OF MATERIALS AND CONDITIONS TO BE ENCOUNTERED. THE BIDDER OR CONTRACTOR IS CAUTIONED TO MAKE SUCH INDEPENDENT SUBSURFACE INVESTIGATIONS AS HE DEEMS NECESSARY TO SATISFY HIMSELF AS TO CONDITIONS TO BE ENCOUNTERED ON THE PROJECT. THE CONTRACTOR SHALL HAVE NO CLAIM FOR ADDITIONAL COMPENSATION OR FOR AN EXTENSION OF TIME FOR ANY REASON RESULTING FROM THE ACTUAL CONDITIONS ENCOUNTERED AT THE SITE DIFFERING FROM THOSE INDICATED IN THE SUBSURFACE INFORMATION.

NOTES:
1. THE INFORMATION CONTAINED HEREIN IS NOT IMPLIED OR GUARANTEED BY THE N. C. DEPARTMENT OF TRANSPORTATION AS ACCURATE NOR IS IT CONSIDERED PART OF THE PLANS, SPECIFICATIONS OR CONTRACT FOR THE PROJECT.
2. BY HAVING REQUESTED THIS INFORMATION, THE CONTRACTOR SPECIFICALLY WAIVES ANY CLAIMS FOR INCREASED COMPENSATION OR EXTENSION OF TIME BASED ON DIFFERENCES BETWEEN THE CONDITIONS INDICATED HEREIN AND THE ACTUAL CONDITIONS AT THE PROJECT SITE.

PERSONNEL

CATLIN

INVESTIGATED BY J.L. STONE

DRAWN BY C.P. TURNER

CHECKED BY D.N. ARGENBRIGHT

SUBMITTED BY D.N. ARGENBRIGHT

DATE JULY 2015



DocuSigned by:
Lee Stone 7/31/2015

SIGNATURE DATE

NORTH CAROLINA DEPARTMENT OF TRANSPORTATION
DIVISION OF HIGHWAYS
GEOTECHNICAL ENGINEERING UNIT
SUBSURFACE INVESTIGATION
SOIL AND ROCK LEGEND, TERMS, SYMBOLS, AND ABBREVIATIONS

SOIL DESCRIPTION
GRADATION
ROCK DESCRIPTION
TERMS AND DEFINITIONS
SOIL LEGEND AND AASHTO CLASSIFICATION
CONSISTENCY OR DENSENESS
TEXTURE OR GRAIN SIZE
SOIL MOISTURE - CORRELATION OF TERMS
PLASTICITY
COLOR
MISCELLANEOUS SYMBOLS
RECOMMENDATION SYMBOLS
ABBREVIATIONS
EQUIPMENT USED ON SUBJECT PROJECT
FRACTURE SPACING
BEDDING
INDURATION

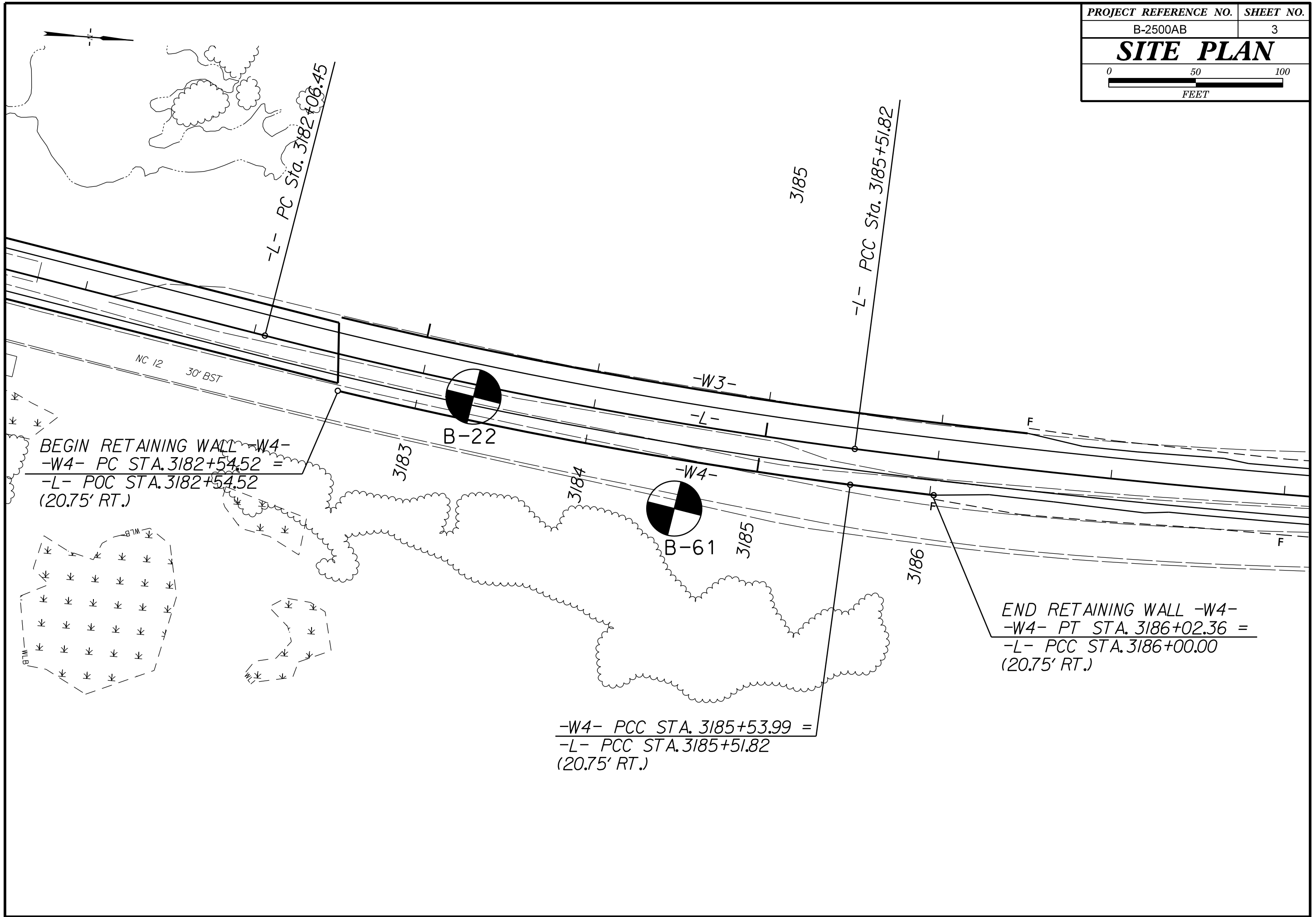

BEGIN RETAINING WALL -W4-
 -W4- PC STA. 3182+54.52 =
 -L- POC STA. 3182+54.52
 (20.75' RT.)

END RETAINING WALL -W4-
 -W4- PT STA. 3186+02.36 =
 -L- PCC STA. 3186+00.00
 (20.75' RT.)

-W4- PCC STA. 3185+53.99 =
 -L- PCC STA. 3185+51.82
 (20.75' RT.)

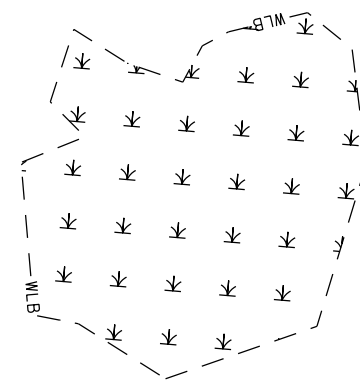

WALL 4 -W4-

B-22 **B-61**
3183+31 **3184+56**
14' LT **28' RT**

BEGIN RETAINING WALL -W4-
-W4- PC STA. 3182+54.52 =
-L- POC STA. 3182+54.52 =
(20.75' RT.)

END RETAINING WALL -W4-
-W4- PT. STA. 3186+02.36 =
-L- POC STA. 3186+00.00 =
(20.75' RT.)

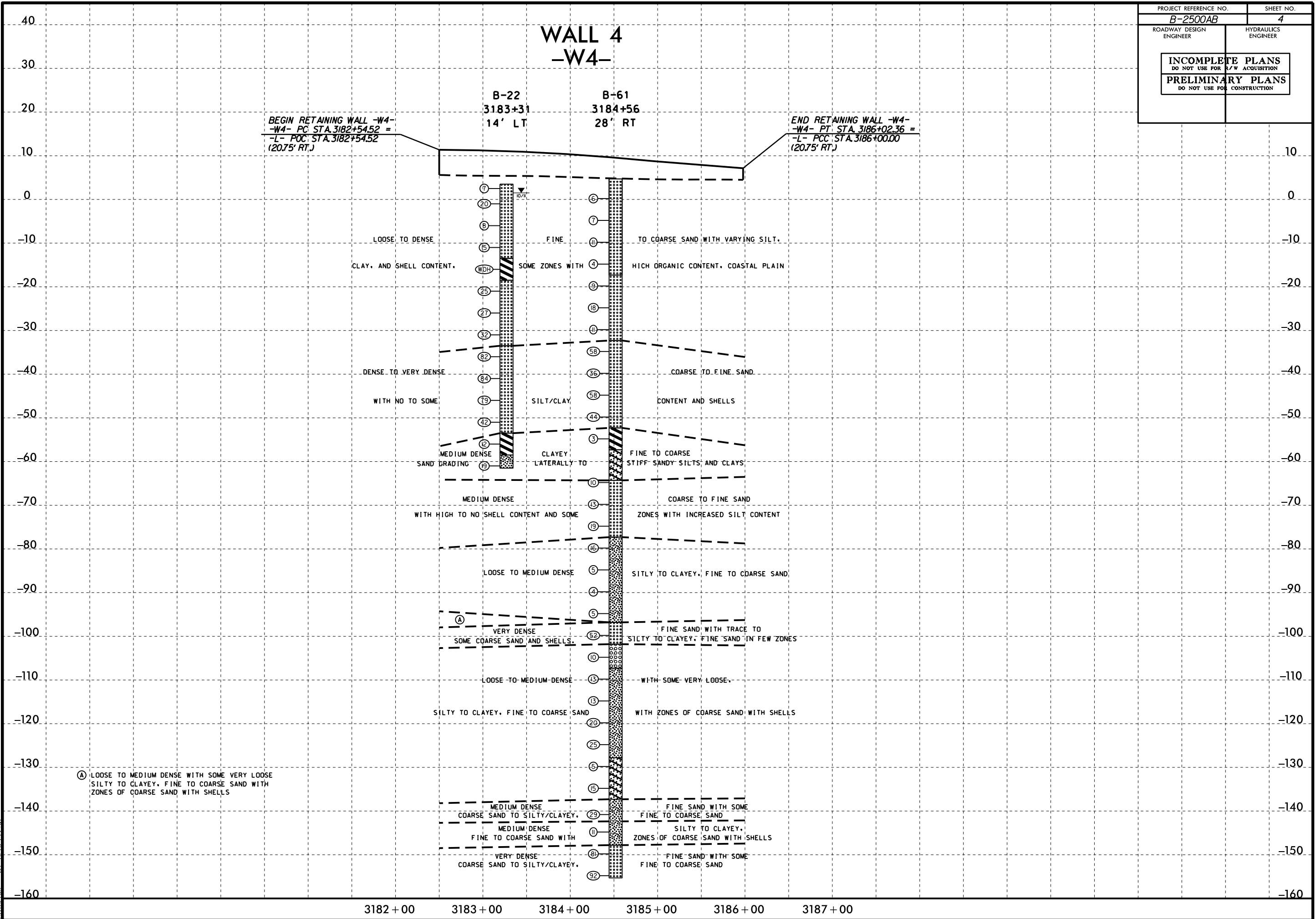

Ⓐ LOOSE TO MEDIUM DENSE WITH SOME VERY LOOSE SILTY TO CLAYEY, FINE TO COARSE SAND WITH ZONES OF COARSE SAND WITH SHELLS

5/14/99
 30-JUL-2015 10:17
 L:\ERD\Greenville_Inv\Investigation\TIP\B2500AB_GEO_RWAL4\CADD_GEO\TECH\Site&Sub\B2500AB_GEO.pfl_WALL_4.dgn
 Author: AT