

SIGNAL FACE	INTERVAL	
	1	2
21, 22	ON	OFF
41	ON	OFF
61, 62	OFF	ON
81, 82	ON	OFF

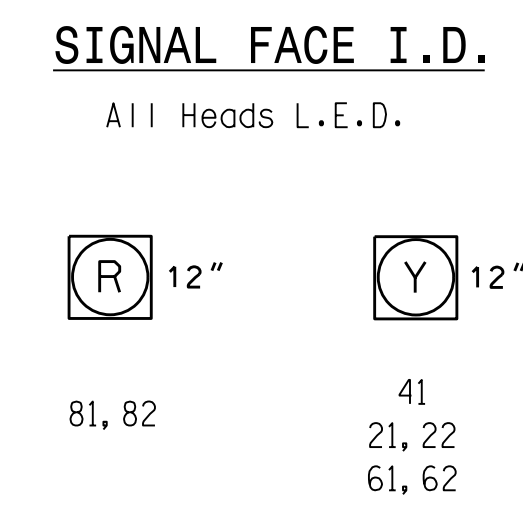

**OASIS 2070 LOOP & DETECTOR INSTALLATION CHART**

LOOP	SIZE (FT)	DISTANCE FROM STOPBAR (FT)	TURNS	NEW LOOP	DETECTOR PROGRAMMING				STRETCH TIME	DELAY TIME	SYSTEM LOOP	NEW CARD
					PHASE	CALLING EXTENSION	FULL TIME DELAY	PRESENCE MODE				
2A	6X40	+5	2-4-2	Y	2	Y	Y	-	-	-	-	-
2B	6X40	+5	2-4-2	Y	2	Y	Y	-	-	-	-	-
4A	6X6	* 240	6	-	4	Y	Y	-	4	-	-	-
8A	6X6	240	3	-	8	Y	Y	-	4	-	-	-
8B	6X40	+5	2-4-2	Y	8	Y	Y	-	-	-	-	-
8C	6X6	0	3	Y	8	Y	Y	-	-	-	-	-

\* See Plans

Actuated Flasher

**NOTES**

1. Refer to "Roadway Standard Drawings NCDOT" dated January 2012 and "Standard Specifications for Roads and Structures" dated January 2012.
2. Set all detector units to presence mode.
3. Flash beacons 21, 22, 61, 62, 81, and 82 when actuated by loops 8A, 8B, and/or 8C.
4. Flash beacons 21, 22, 61, and 62 when actuated by loops 2A and/or 2B.

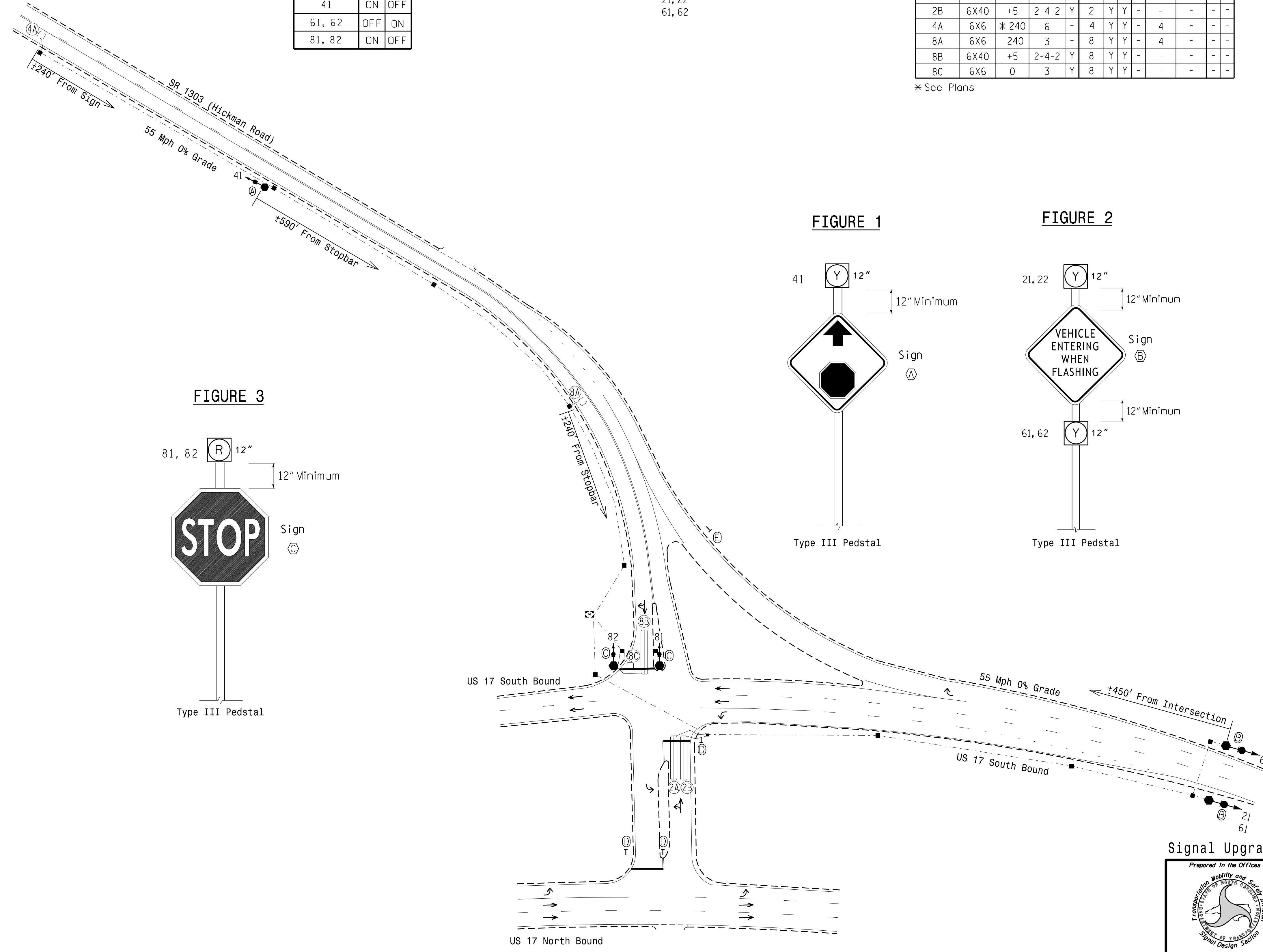

**FIGURE 1**

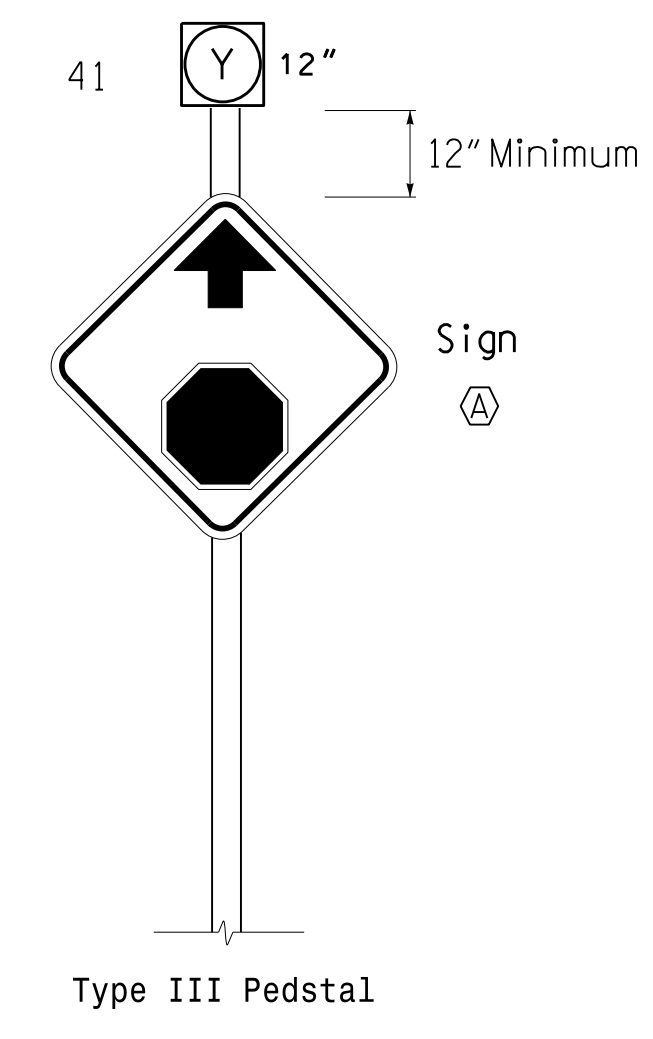

**FIGURE 2**

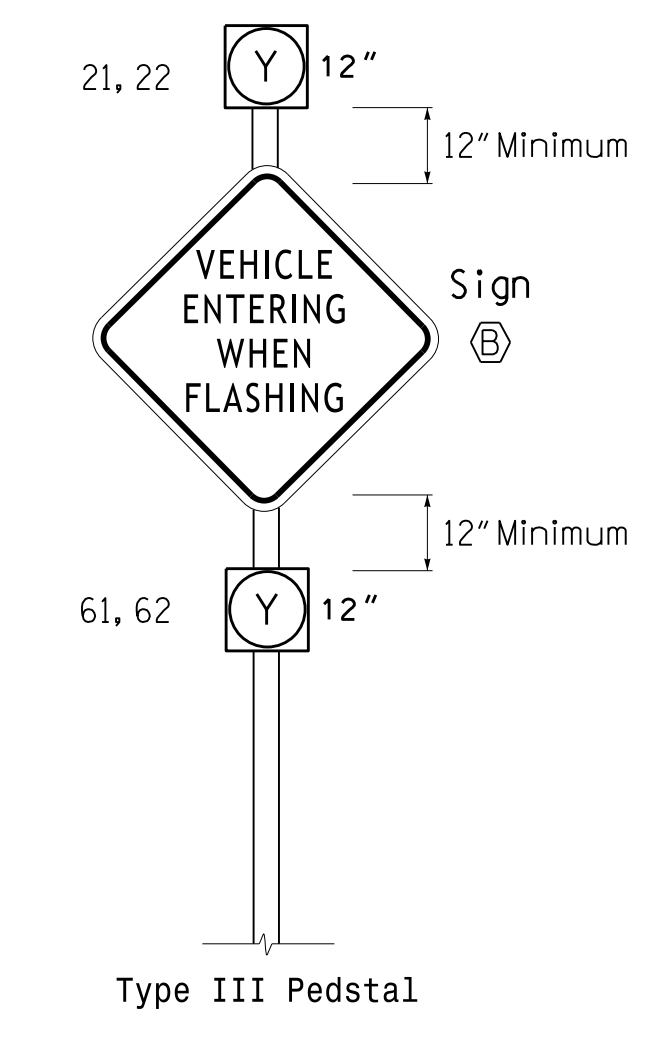

**FIGURE 3**

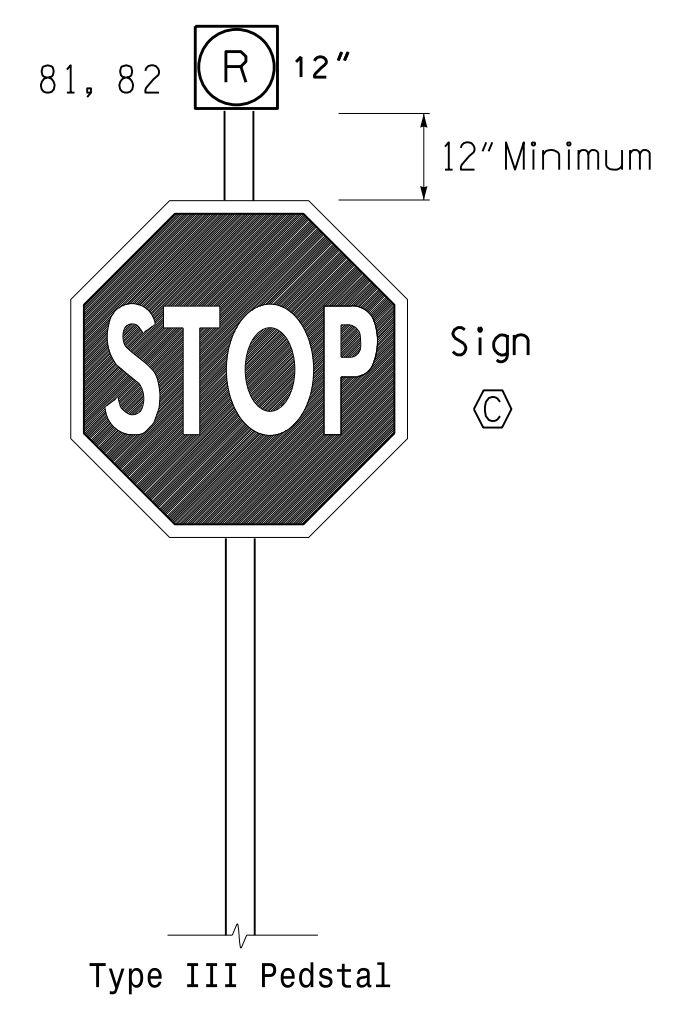

**LEGEND**

PROPOSED	EXISTING

**Signal Upgrade**

Prepared In the Offices of:

**US 17 at SR 1303 (Hickman Road)**

Division 3 Brunswick County Carolina Shores

PLAN DATE: July 2012 REVIEWED BY:

PREPARED BY: IOU/PLA REVIEWED BY:

REVISIONS

1. Install loops

SCALE 0 50 1"=50'

DATE 7/16/2015

SEAL

PAULELLA L. ALEXANDER

SIG. INVENTORY NO. 03-1067

16-JUL-2015 11:59  
 S:\Projects\15\_Signal\Signal Design Section\Eastern Region\03-1067\03-1067\_Sig.dwg  
 paalexander