

PHASING DIAGRAM

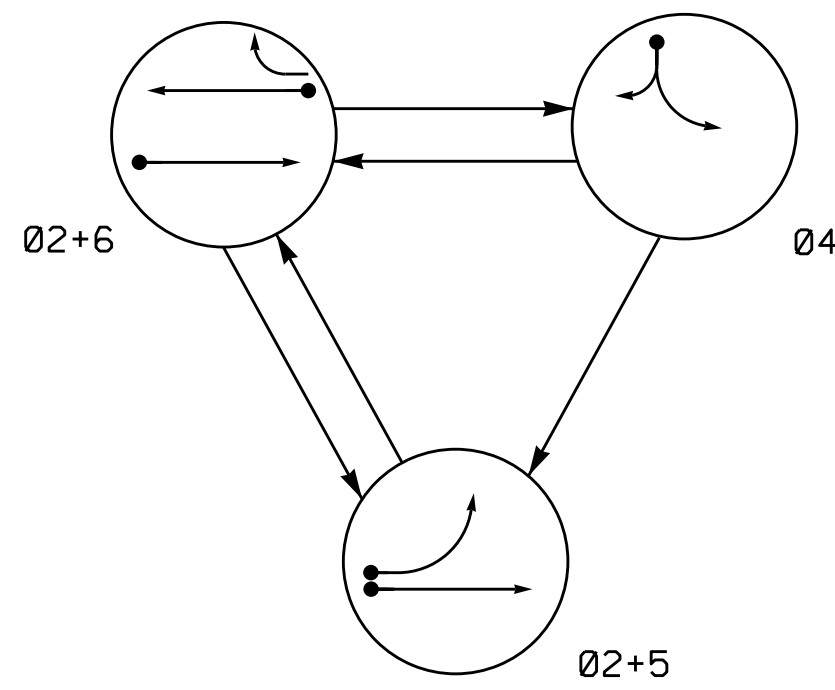

PHASING DIAGRAM DETECTION LEGEND

- ←●→ DETECTED MOVEMENT
- ←○→ UNDETECTED MOVEMENT (OVERLAP)
- ←- - -> UNSIGNALIZED MOVEMENT
- ←- - -> PEDESTRIAN MOVEMENT

SIGNAL FACE	PHASE			
	Ø 2 + 5	Ø 2 + 6	Ø 4	FLASH
21,22	G	G	R	Y
41,42	R	R	G	R
51	-	R	R	Y
62,63	R	G	R	Y

SIGNAL FACE I.D.

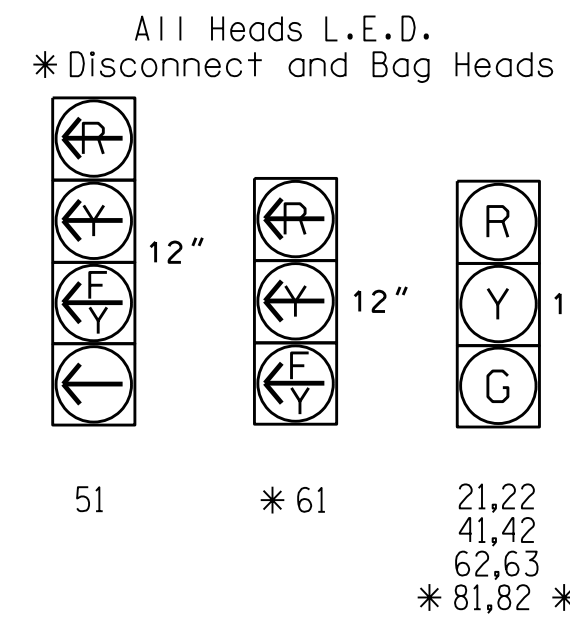

LOOP	SIZE (FT)	DISTANCE FROM STOPBAR (FT)	TURNS	NEW LOOP	DETECTOR PROGRAMMING					SYSTEM LOOP	NEW CARD	
					PHASE	CALLING	EXTENSION	FULL TIME DELAY	STRETCH TIME			DELAY TIME
2A	6X6	420	*	*	2	Y	Y	-	-	-	-	-
2B	6X40	0	*	*	2	Y	Y	Y	2.0	5	-	-
4A	6X40	0	*	*	4	Y	Y	-	-	5	-	-
5A	6X40	0	*	*	5	Y	Y	-	-	-	-	-
6A	6X6	420	*	*	6	Y	Y	-	-	-	-	-
6B	6X40	0	*	*	6	Y	Y	Y	2.0	5	-	-

* Video Detection Zone

3 Phase Fully Actuated Isolated

NOTES

1. Refer to "Roadway Standard Drawings NCDOT" dated January 2012 and "Standard Specifications for Roads and Structures" dated January 2012.
2. Do not program signal for late night flashing operation unless otherwise directed by the Engineer.
3. Phase 5 may be lagged.
4. Reposition existing signal heads numbered 61, 62, 63, 81 and 82.
5. Set all detector units to presence mode.
6. Locate new cabinet so as not to obstruct sight distance of vehicles turning right on red.
7. Pavement markings are existing.
8. Disconnect and bag signal heads 81 and 82.

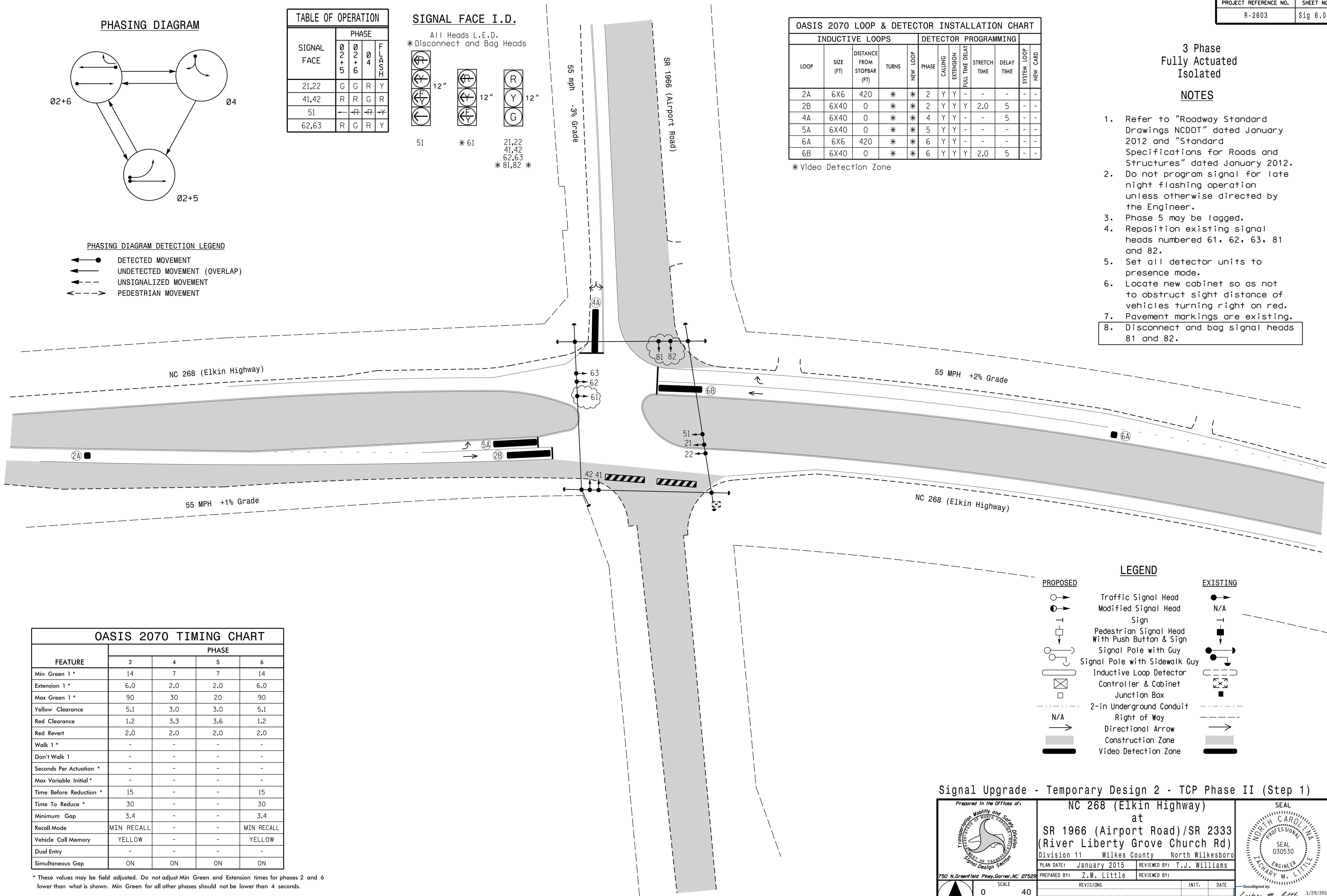

FEATURE	PHASE			
	2	4	5	6
Min Green 1 *	14	7	7	14
Extension 1 *	6.0	2.0	2.0	6.0
Max Green 1 *	90	30	20	90
Yellow Clearance	5.1	3.0	3.0	5.1
Red Clearance	1.2	3.3	3.6	1.2
Red Revert	2.0	2.0	2.0	2.0
Walk 1 *	-	-	-	-
Don't Walk 1	-	-	-	-
Seconds Per Actuation *	-	-	-	-
Max Variable Initial *	-	-	-	-
Time Before Reduction *	15	-	-	15
Time To Reduce *	30	-	-	30
Minimum Gap	3.4	-	-	3.4
Recall Mode	MIN RECALL	-	-	MIN RECALL
Vehicle Call Memory	YELLOW	-	-	YELLOW
Dual Entry	-	-	-	-
Simultaneous Gap	ON	ON	ON	ON

* These values may be field adjusted. Do not adjust Min Green and Extension times for phases 2 and 6 lower than what is shown. Min Green for all other phases should not be lower than 4 seconds.

PROPOSED		EXISTING	
	Traffic Signal Head		Traffic Signal Head
	Modified Signal Head		N/A
	Sign		N/A
	Pedestrian Signal Head With Push Button & Sign		N/A
	Signal Pole with Guy		Signal Pole with Guy
	Signal Pole with Sidewalk Guy		Signal Pole with Sidewalk Guy
	Inductive Loop Detector		Inductive Loop Detector
	Controller & Cabinet		Controller & Cabinet
	Junction Box		Junction Box
	2-in Underground Conduit		2-in Underground Conduit
	Right of Way		Right of Way
	Directional Arrow		Directional Arrow
	Construction Zone		Construction Zone
	Video Detection Zone		Video Detection Zone

Signal Upgrade - Temporary Design 2 - TCP Phase II (Step 1)

Prepared In the Offices of:

750 N. Greenfield Pkwy, Garner, NC 27529

NC 268 (Elkin Highway) at SR 1966 (Airport Road)/SR 2333 (River Liberty Grove Church Rd)

Division 11 Wilkes County North Wilkesboro

PLAN DATE: January 2015 REVIEWED BY: T.J. Williams

PREPARED BY: Z.M. Little REVIEWED BY:

REVISIONS: _____ INIT. DATE

SCALE: 1"=40'

SEAL: Z. CHARLY M. LITTLE, ENGINEER, 030530

DATE: 1/29/2015

SIG. INVENTORY NO. II-0085 T2

2015-01-29 15:45
 R:\Projects\11-0085\11-0085-1\11-0085-1.dgn
 2015/01/29 15:45